

PINNACLE HOMES SABLE CREEK

S-I-G SLATER
HANIFAN
GROUP
CONSULTING ENGINEERS & PLANNERS
5740 S ARVILLE STREET #216, LAS VEGAS, NV 89118
PHONE (702) 284-5300 FAX (702) 284-5399

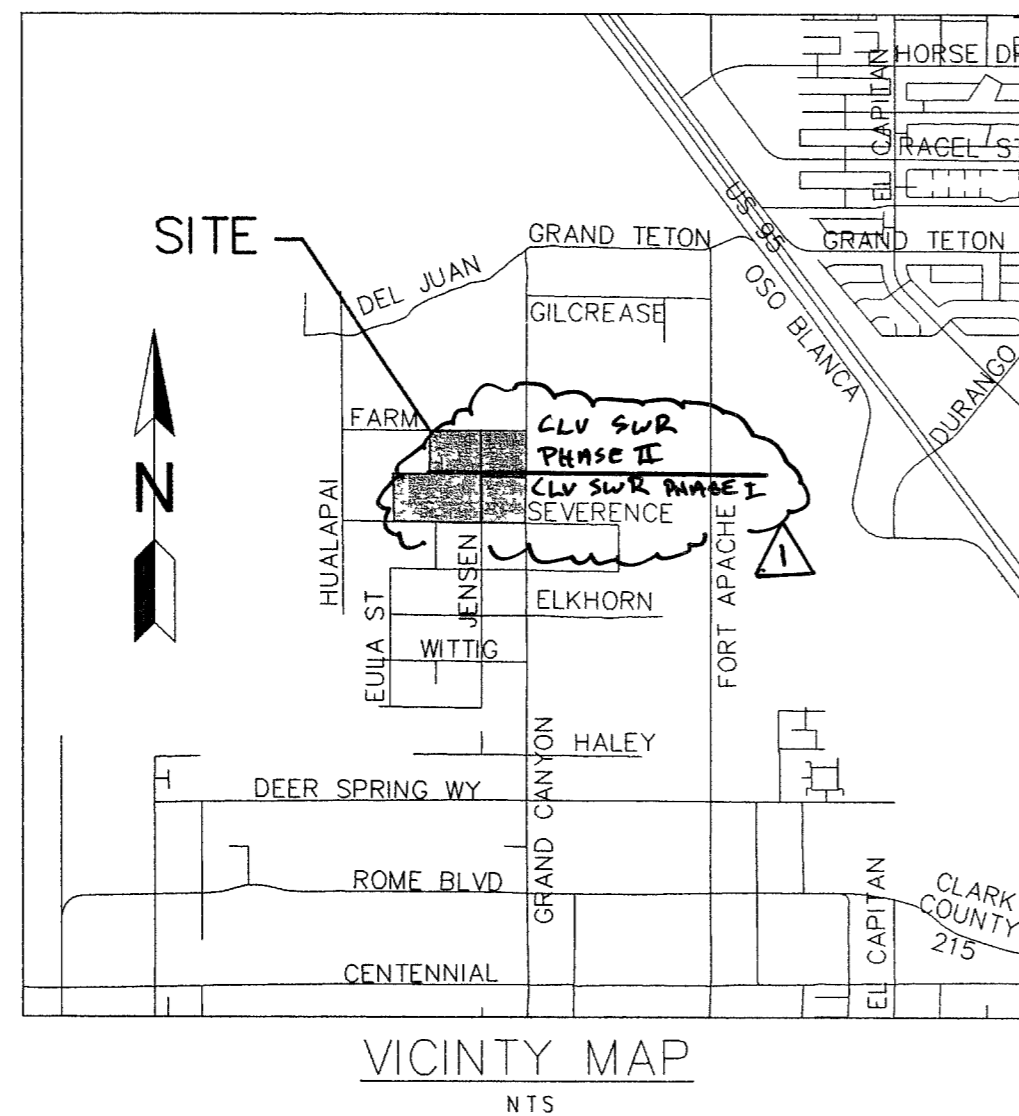

"The affixed Sprint Nevada approval does not assume or guarantee liability for known or unknown conflicts with existing or proposed improvements. Resolution of any conflict will be accomplished pursuant to Local Ordinances, Nevada Revised Statutes or Public Utility Commission rules and regulations."

OWNER/DEVELOPER
PINNACLE HOMES
8080 W SAHARA AVENUE, SUITE B
LAS VEGAS, NV 89117
PH (702) 228-0720
FX (702) 228-5895
APN # 125-18-301-005
APN # 125-18-301-006
APN # 125-18-301-007
APN # 125-18-301-008
APN # 125-18-301-009
APN # 125-18-301-011
APN # 125-18-301-012
APN # 125-18-301-015
APN # 125-18-301-016
APN # 125-18-301-017
APN # 125-18-301-018
APN # 125-18-301-019
APN # 125-18-301-020
APN # 125-18-301-021
APN # 125-18-301-022

OWNER
HARRIS, CONNIE L
9670 VIA PROVENZA AVENUE
LAS VEGAS, NV 89149
APN # 125-18-301-010

NOTE
A PRE-DEVELOPMENT MEETING WITH THE DEPARTMENT OF DEVELOPMENT SERVICES, CIVIL ENGINEERING DIVISION, OFF-SITE INSPECTOR IS REQUIRED. PLEASE CONTACT THE CIVIL ENGINEERING INSPECTOR AT 455-4610

APPROVALS	
<i>Charles Karkowski</i> CITY ENGINEER-CHARLES KARKOWSKI, JR., PE #4784 CITY OF LAS VEGAS (SEWER AND CLV ROW IMPROVEMENTS)	7-15-2005 DATE
APPROVAL OF THESE PLANS BY THE CITY ENGINEER IS LIMITED TO THOSE IMPROVEMENTS CONSTRUCTED IN THE DEDICATION OF RIGHT-OF-WAY, AND/OR CONSTRUCTION OF ANY IMPROVEMENTS THAT DEVIATE FROM ADOPTED STANDARDS AND/OR SPECIFICATIONS EXCEPT THOSE SPECIALLY LISTED UNDER DEVIATIONS FROM STANDARDS. THE ENGINEER SHALL RESOLVE ANY DEVIATION OTHER THAN THOSE LISTED IN DEVIATIONS FROM STANDARDS IN FAVOR OF THE UNIFORM STANDARD DRAWINGS AND SPECIFICATIONS CLARK COUNTY AREA NEVADA	
<i>John Gahan</i> LAS VEGAS VALLEY WATER DISTRICT-PROJECT #H108887 SHITS 1-7, 15, 16, 19, 22-26, 30, 38 & 40	7-11-05 DATE
APPROVAL BY THE FIRE DEPARTMENT HAVING JURISDICTION IS REQUIRED PRIOR TO OBTAINING FINAL APPROVAL FROM LAS VEGAS VALLEY WATER DISTRICT	
<i>James Baums</i> NEVADA POWER COMPANY	6/28/05 DATE
NEVADA POWER COMPANY ACKNOWLEDGES THAT WE HAVE RECEIVED YOUR PLANS AND WILL PROVIDE SERVICE TO ALL ELECTRICAL NEEDS ASSOCIATED WITH THIS PROJECT. NEVADA POWER COMPANY RESERVES THE RIGHT TO ADDRESS ANY EXISTING OR FUTURE CONFLICTS ONCE THE FINAL DESIGN IS COMPLETED. THE NEW SERVICE AND THE RESOLUTION OF ANY CONFLICTS WILL BE ACCOMPLISHED PURSUANT TO THE NEVADA PUBLIC UTILITY COMMISSION'S RULES AND REGULATIONS.	
<i>John Hanifan</i> CLARK COUNTY FIRE DEPARTMENT	7/7/05 DATE
APPROVAL OF THESE PLANS SHALL NOT BE CONSIDERED TO BE A PERMIT FOR, OR AN APPROVAL OF, ANY VIOLATION OF ANY OF THE PROVISIONS OF THE STATE, COUNTY LAWS AND/OR SPECIFICATIONS	
<i>Israel Gonzalez</i> COMMUNICATIONS LAS VEGAS, INC	6/27/05 DATE
<i>Helen M. Berry</i> SPRINT	6-27-05 DATE
PROJECT INFORMATION	
ACREAGE: 51.11	
NO OF LOTS: 100	
LOTS PER ACRE: 1.96	
LOCATION: CLARK COUNTY, NV	
APN # 125-18-301-005, -006, -007, -008, -009, -010, -011, -012	
APN # 125-18-301-015, -016, -017, -018, -019, -020, -021, -022	

INDEX OF DRAWINGS		
1	C-1	COVER SHEET
2	C-2	GENERAL NOTES AND QUANTITIES
3	U-1	UTILITY PLAN I
4	U-2	UTILITY PLAN II
5	U-3	UTILITY PLAN III
6	U-4	UTILITY PLAN IV
7	U-5	UTILITY PLAN V
8	T-1	TRAFFIC AND STREET LIGHT PLAN I
9	T-2	TRAFFIC AND STREET LIGHT PLAN II
10	T-3	TRAFFIC AND STREET LIGHT PLAN III
11	T-4	TRAFFIC AND STREET LIGHT PLAN IV
12	T-5	TRAFFIC AND STREET LIGHT PLAN V
13	T-6	TRAFFIC PLAN VI, NOTES AND DETAILS
14	PP-1	RAMON VALLEY AVE PLAN AND PROFILE STA 2+00 TO STA 10+50
15	PP-2	RAMON VALLEY AVE PLAN AND PROFILE STA 10+50 TO STA 16+00 UNIVERSITY RIDGE AVE. PLAN AND PROFILE STA 2+50 TO 9+00 UNIVERSITY RIDGE AVE. PLAN AND PROFILE STA 9+00 TO STA 16+00
16	PP-3	FAIRBURN CREEK ST PLAN AND PROFILE
17	PP-4	CATHEDRAL PINES AVE PLAN AND PROFILE STA 2+50 TO STA 10+00 SYCAMORE VALLEY ST PLAN AND PROFILE
18	PP-5	CATHEDRAL PINES PLAN AND PROFILE STA 10+00 TO STA 16+00
19	PP-6	AMADOR RANCH AVE PLAN AND PROFILE STA 2+50 TO STA 11+50 AMADOR RANCH AVE PLAN AND PROFILE STA 11+50 TO STA 22+00
20	PP-7	FARM RD PLAN AND PROFILE STA 2+00 TO STA 11+00 FARM RD PLAN AND PROFILE STA 11+00 TO STA 18+00 SEVERENCE LANE PLAN AND PROFILE STA -0+50 TO 2+50
21	PP-8	GRAND CANYON DR PLAN AND PROFILE STA 2+00 TO STA 11+50
22	PP-9	GRAND CANYON DR PLAN AND PROFILE STA 11+50 TO STA 17+50
23	PP-10	SEVERENCE LN PLAN AND PROFILE STA 2+50 TO STA 13+50
24	PP-11	SEVERENCE LN. PLAN AND PROFILE STA 13+50 TO STA 24+00
25	PP-12	DRAINAGE CHANNEL PLAN + PROFILE AND DRAINAGE SECTIONS
26	PP-13	SD LATERALS 1, 3, 4, 5 AND 2 + 6 PLAN AND PROFILE
27	PP-14	DORVILLE AVE. PLAN AND PROFILE DORVILLE AVE. PLAN AND PROFILE
28	PP-15	GRADING PLAN I
29	PP-16	GRADING PLAN II
30	PP-17	GRADING PLAN III
31	PP-18	GRADING PLAN IV
32	G-1	CROSS SECTIONS AND DETAILS
33	G-2	DRAINAGE CHANNEL SECTIONS AND DETAILS
34	G-3	DRAINAGE CHANNEL SECTIONS AND DETAILS
35	G-4	DRAINAGE CHANNEL SECTIONS AND DETAILS
36	G-5	DRAINAGE CHANNEL SECTIONS AND DETAILS
37	D-1	DROP INLET DETAILS
38	D-2	CROSS SECTIONS AND DETAILS
39	D-3	CROSS SECTIONS AND DETAILS
40	D-4	CROSS SECTIONS AND DETAILS
41	D-5	CROSS SECTIONS AND DETAILS
42	D-6	CROSS SECTIONS AND DETAILS
43	S-1	GENERAL STRUCTURAL NOTES AND DETAILS
44	S-2	DRAINAGE CHANNEL SECTIONS

SLATER HANIFAN GROUP
CONSULTING ENGINEERS & PLANNERS
5740 S. ARVILLE STREET #216, LAS VEGAS, NV 89118
PHONE (702) 284-5300 FAX (702) 284-5399

CLARK COUNTY, NEVADA
SECTION 18
TOWNSHIP 18 SOUTH
RANGE 60 EAST, N.D.M.

PINNACLE HOMES
SABLE CREEK
COVER SHEET

DATE: 06/20/05
DRAFTER: DMB
DESIGNER: DMB
CHECKED: TJS
PROJECT NO. PIN0402-001

C-1
SHEET 1 OF 44
CLV DWG # 3074930
CC HTE# 05-7995

AVOID HITTING OVERHEAD POWER LINES. IT'S COSTLY.
CALL BEFORE YOU DIG OVERHEAD
1-702-227-2929

AVOID CUTTING UNDERGROUND UTILITY LINES. IT'S COSTLY.
Call before you Dig UnderGround
1-702-455-7511
1-800-227-2600
UNDERGROUND SERVICE (USA)

File: J:\PIN0402-001\Drawings\PH0402-CV06.dwg