

PINNACLE HOMES SABLE CREEK

S-I-G SLATER
HANIFAN
GROUP
CONSULTING ENGINEERS & PLANNERS
5740 S. ARVILLE STREET #216, LAS VEGAS, NV 89118
PHONE (702) 284-5300 FAX (702) 284-5399

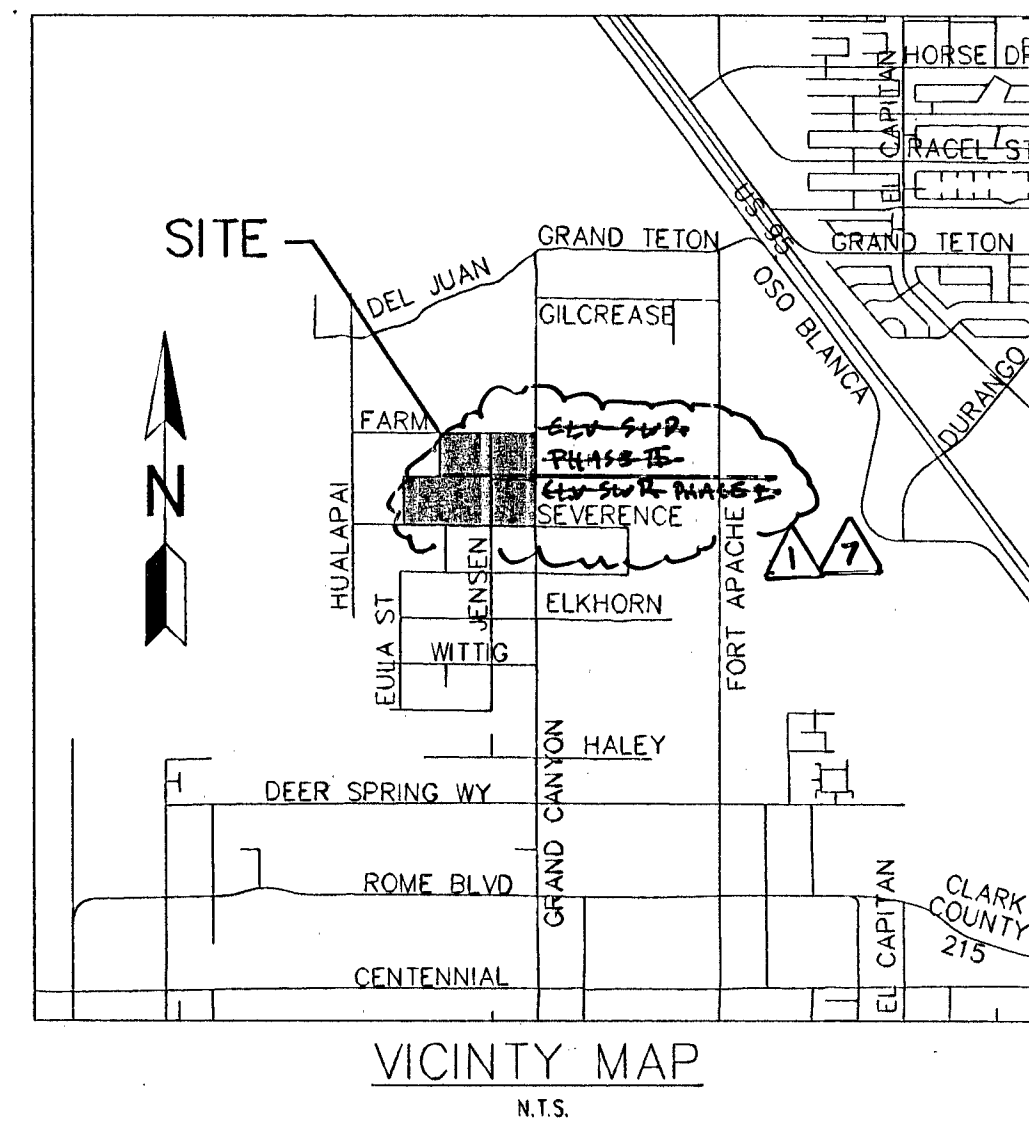

APPROVALS

Charles Kajkowski, Jr. 7-15-2005
CITY ENGINEER - CHARLES KAJKOWSKI, JR.: PE #4784 DATE
CITY OF LAS VEGAS (SEWER AND CLV R.O.W. IMPROVEMENTS)

APPROVAL OF THESE PLANS BY THE CITY ENGINEER IS LIMITED TO THOSE IMPROVEMENTS CONSTRUCTED IN THE DEDICATION OF RIGHT-OF-WAY, AND/OR CONSTRUCTION OF ANY IMPROVEMENTS THAT DEVIATE FROM ADOPTED STANDARDS AND/OR SPECIFICATIONS EXCEPT THOSE SPECIALLY LISTED UNDER DEVIATIONS FROM STANDARDS. THE ENGINEER SHALL RESOLVE ANY DEVIATION OTHER THAN THOSE LISTED IN DEVIATIONS FROM STANDARDS IN FAVOR OF THE UNIFORM STANDARD DRAWINGS AND SPECIFICATIONS CLARK COUNTY AREA NEVADA.

Las Vegas Valley Water District 7-11-05
LAS VEGAS VALLEY WATER DISTRICT-PROJECT #H108887 DATE
SHTS. 1-7, 15, 16, 19, 22-26, 30, 38 & 40

APPROVAL BY THE FIRE DEPARTMENT HAVING JURISDICTION IS REQUIRED PRIOR TO OBTAINING FINAL APPROVAL FROM LAS VEGAS VALLEY WATER DISTRICT.

Nevada Power Company 6/28/05
NEVADA POWER COMPANY DATE

NEVADA POWER COMPANY ACKNOWLEDGES THAT WE HAVE RECEIVED YOUR PLANS AND WILL PROVIDE SERVICE TO ALL ELECTRICAL NEEDS ASSOCIATED WITH THIS PROJECT. NEVADA POWER COMPANY RESERVES THE RIGHT TO ADDRESS ANY EXISTING OR FUTURE CONFLICTS ONCE THE FINAL DESIGN IS COMPLETED. THE NEW SERVICE AND THE RESOLUTION OF ANY CONFLICTS WILL BE ACCOMPLISHED PURSUANT TO THE NEVADA PUBLIC UTILITY COMMISSION'S RULES AND REGULATIONS.

CLARK COUNTY
FIRE DEPARTMENT

James Gonzalez 7/2/05
DATE

APPROVAL OF THESE PLANS SHALL NOT BE CONSTRUED TO BE A PERMIT FOR OR AN APPROVAL OF ANY VIOLATION OF ANY OF THE PROVISIONS OF THE STATE, COUNTY LAWS AND/OR SPECIFICATIONS.

2250 G.P.M. 20 P.S.I.

Steve Gonzalez 6/27/05
CO COMMUNICATIONS (LAS VEGAS, NV) DATE

Halle M. Bandy 6-27-05
SPRINT DATE

PROJECT INFORMATION

ACREAGE: 51.11
NO. OF LOTS: (residential) 150
LOTS PER ACRE: 2.94

LOCATION: CLARK COUNTY, NV

APN # 125-18-301-005, -006, -007, -008, -009, -010, -011, -012
APN # 125-18-301-015, -016, -017, -018, -019, -020, -021, -022

*The affixed Sprint Nevada approval does not assume or guarantee liability for known or unknown conflicts with existing or proposed improvements. Resolution of any conflict will be accomplished pursuant to Local Ordinances, Nevada Revised Statutes and/or Public Utility Commission Rules and Regulations.

OWNER/DEVELOPER
PINNACLE HOMES
8080 W. SAHARA AVENUE, SUITE B
LAS VEGAS, NV 89117
PH: (702) 228-0720
FX: (702) 228-5895

APN # 125-18-301-005
APN # 125-18-301-006
APN # 125-18-301-007
APN # 125-18-301-008
APN # 125-18-301-009
APN # 125-18-301-011
APN # 125-18-301-012
APN # 125-18-301-015
APN # 125-18-301-016
APN # 125-18-301-017
APN # 125-18-301-018
APN # 125-18-301-019
APN # 125-18-301-020
APN # 125-18-301-021
APN # 125-18-301-022

OWNER
HARRIS, CONNIE L.
9670 VIA PROVENZA AVENUE
LAS VEGAS, NV 89149
APN # 125-18-301-010

NOTE:
A PRE-DEVELOPMENT MEETING WITH THE DEPARTMENT OF DEVELOPMENT SERVICES, CIVIL ENGINEERING DIVISION, OFF-SITE INSPECTOR IS REQUIRED. PLEASE CONTACT THE CIVIL ENGINEERING INSPECTOR AT 455-4610.

INDEX OF DRAWINGS		
NO.	DESCRIPTION	DATE
1	C-1	COVER SHEET
2	C-2	GENERAL NOTES AND QUANTITIES
3	U-1	UTILITY PLAN I
4	U-2	UTILITY PLAN II
5	U-3	UTILITY PLAN III
6	U-4	UTILITY PLAN IV
7	U-5	UTILITY PLAN V
8	T-1	TRAFFIC AND STREET LIGHT PLAN I
9	T-2	TRAFFIC AND STREET LIGHT PLAN II
10	T-3	TRAFFIC AND STREET LIGHT PLAN III
11	T-4	TRAFFIC AND STREET LIGHT PLAN IV
12	T-5	TRAFFIC AND STREET LIGHT PLAN V
13	T-6	TRAFFIC PLAN VI, NOTES AND DETAILS
14	PP-1	RAMON VALLEY AVE PLAN AND PROFILE STA 2+00 TO STA 10+50
15	PP-2	RAMON VALLEY AVE PLAN AND PROFILE STA 10+50 TO STA 16+00
16	PP-3	UNIVERSITY RIDGE AVE... PLAN AND PROFILE STA 2+50 TO 9+00 UNIVERSITY RIDGE AVE PLAN AND PROFILE STA 9+00 TO STA 16+00
17	PP-4	FAIRBURN CREEK ST PLAN AND PROFILE
18	PP-5	CATHEDRAL PINES AVE PLAN AND PROFILE STA 2+50 TO STA 10+00 SYCAMORE VALLEY ST PLAN AND PROFILE CATHEDRAL PINES PLAN AND PROFILE STA 10+00 TO STA 16+00
19	PP-6	CATHEDRAL PINES PLAN AND PROFILE STA 10+00 TO STA 16+00
20	PP-7	DORAVILLE AVE... PLAN AND PROFILE DORAVILLE AVE PLAN AND PROFILE
21	PP-8	AMADOR RANCH AVE PLAN AND PROFILE STA 2+50 TO STA 11+50
22	PP-9	AMADOR RANCH AVE PLAN AND PROFILE STA 11+50 TO STA 22+00
23	PP-10	FARM RD PLAN AND PROFILE STA 2+00 TO STA 11+00
24	PP-11	FARM RD PLAN AND PROFILE STA 11+00 TO STA 18+00 SEVERENCE LANE PLAN AND PROFILE STA -0+50 TO 2+50
25	PP-12	GRAND CANYON DR PLAN AND PROFILE STA 2+00 TO STA 11+50
26	PP-13	GRAND CANYON DR PLAN AND PROFILE STA 11+50 TO STA 17+50
27	PP-14	SEVERENCE LN PLAN AND PROFILE STA 2+50 TO STA 13+50
28	PP-15	SEVERENCE LN PLAN AND PROFILE STA 13+50 TO STA 24+00
29	PP-16	DRAINAGE CHANNEL PLAN + PROFILE AND DRAINAGE SECTIONS
30	PP-17	SD LATERALS 1, 3, 4, 5 AND 2 + 6 PLAN AND PROFILE
31	PP-18	DORAVILLE AVE... PLAN AND PROFILE DORAVILLE AVE... PLAN AND PROFILE
32	G-1	GRADING PLAN I
33	G-2	GRADING PLAN II
34	G-3	GRADING PLAN III
35	G-4	GRADING PLAN IV
36	G-5	GRADING PLAN V
37	D-1	CROSS SECTIONS AND DETAILS
38	D-2	DRAINAGE CHANNEL SECTIONS AND DETAILS
39	D-3	DRAINAGE CHANNEL SECTIONS AND DETAILS
40	D-4	DRAINAGE CHANNEL SECTIONS AND DETAILS
41	D-5	DROP INLET DETAILS
42	D-6	CROSS SECTIONS AND DETAILS
43	S-1	GENERAL STRUCTURAL NOTES AND DETAILS
44	S-2	DRAINAGE CHANNEL SECTIONS

SLATER HANIFAN GROUP
CONSULTING ENGINEERS & PLANNERS
5740 S. ARVILLE STREET #216, LAS VEGAS, NV 89118
PHONE (702) 284-5300 FAX (702) 284-5399

CLARK COUNTY, NEVADA
SECTION 18
TOWNSHIP 18 SOUTH
RANGE 60 EAST, W.D.M.

PINNACLE HOMES
SABLE CREEK
COVER SHEET

DATE: 06/20/05
DRAFTER: DMB
DESIGNER: DMB
CHECKED: TJS
PROJECT NO.
PIN0402-001

REGISTERED PROFESSIONAL ENGINEER - STATE OF NEVADA
TODD J. STEADHAM
Exp. 08/30/2008
CIVIL
No. 15292

C-1
SHEET 1 OF 44
CLV DWG # 20040950
CC RTE # 05-7995

REV. 7

AVOID HITTING OVERHEAD POWER LINES IT'S COSTLY
CALL BEFORE YOU DIG
1-702-227-2929

Call before you Dig
Underground
1-702-455-7511
1-702-229-6611

Call before you Dig
Underground
1-800-227-2600
UNDERGROUND SERVICE (USA)

REV #	REV. DESCRIPTION	SHEET(S)	APP. BY	APP. DATE
7	REMOVED CLV PHASE II SEWER	1-4, 14-17, 25, 26, 38, 39	EP	4/17/09

1620