

GENERAL NOTES

- 1. ALL CONSTRUCTION AND MATERIALS SHALL BE IN ACCORDANCE WITH THE "UNIFORM STANDARD SPECIFICATIONS FOR PUBLIC WORKS" CONSTRUCTION OFF-SITE IMPROVEMENTS, CLARK COUNTY AREA, NEVADA, LATEST ISSUE...

LEGEND

Table with 2 columns: Symbol and Description. Includes symbols for edge of exist. pavement, exist. gas line, exist. telephone conduit, etc.

- 11. CURB & GUTTER WITH A GRADE OF LESS THAN FOUR TENTHS OF ONE PERCENT SHALL BE CONSTRUCTED BY FORMING. EACH JOINT SHALL BE CHECKED FOR GRADE PRIOR TO CONSTRUCTION AND WATER TESTED AS SOON AS POSSIBLE AFTER CONSTRUCTION...

Table with 2 columns: Symbol and Description. Includes symbols for B/C BACK OF CURB, B/B BACK OF CURB TO BACK OF CURB, etc.

LAS VEGAS VALLEY WATER DISTRICT NOTES

- 1. NO WORK SHALL BEGIN ON THE WATER PLANS UNTIL THEY HAVE BEEN RELEASED FOR CONSTRUCTION BY THE LVVWD. FOLLOWING APPROVAL OF THE PLANS, NOTICE SHALL BE GIVEN TO THE LVVWD CUSTOMER SERVICE DEPARTMENT (870-4194), 48 HOURS PRIOR TO ACTUAL CONSTRUCTION AND 24 HOURS PRIOR TO AN INSPECTION...

- 11. ALL WATER MAINS SHALL BE PRESSURE TESTED AT 200 PSI FOR A CONTINUOUS TWO HOUR PERIOD, IN ACCORDANCE WITH DISTRICT STANDARDS...

CITY OF LAS VEGAS FIRE DEPARTMENT NOTES

- 1. ALL WORK SHALL BE DONE IN STRICT ACCORDANCE WITH THE CITY OF LAS VEGAS FIRE DEPARTMENT "HYDRANT SPECIFICATIONS", "HYDRANT INSTALLATION SPECIFICATIONS" AND ORDINANCE #3545...

CITY OF LAS VEGAS STREET LIGHT NOTES

- 1. ALL STREET LIGHTING INSTALLATIONS SHALL CONFORM TO THE LATEST ISSUE OF THE STANDARD DETAIL AND SPECIFICATIONS OF THE CITY OF LAS VEGAS, AND SHALL ALSO CONFORM TO THE UNIFORM STANDARD SPECIFICATIONS FOR PUBLIC WORKS' CONSTRUCTION OFF-SITE IMPROVEMENTS, CLARK COUNTY AREA, LATEST EDITION...

BENCHMARK

ALUM. PLATE IN SE. COR. OF BASE OF FIRE HYDRANT, 200' EAST OF BUFFALO DRIVE ON THE NORTH SIDE OF SAHARA AVENUE. ELEVATION: 2514.177'

SHEET INDEX

- 1. COVER SHEET
2. SHEET INDEX, GENERAL NOTES
2A. DETAIL SHEET
2B. HORIZONTAL CONTROL SHEET
2C. HORIZONTAL CONTROL SHEET
Q-1 SUMMARY OF ESTIMATED QUANTITIES
Q-2 SUMMARY OF ESTIMATED QUANTITIES
3. STREET & SEWER PLAN & PROFILE - (STA. 0+00 TO 4+00)

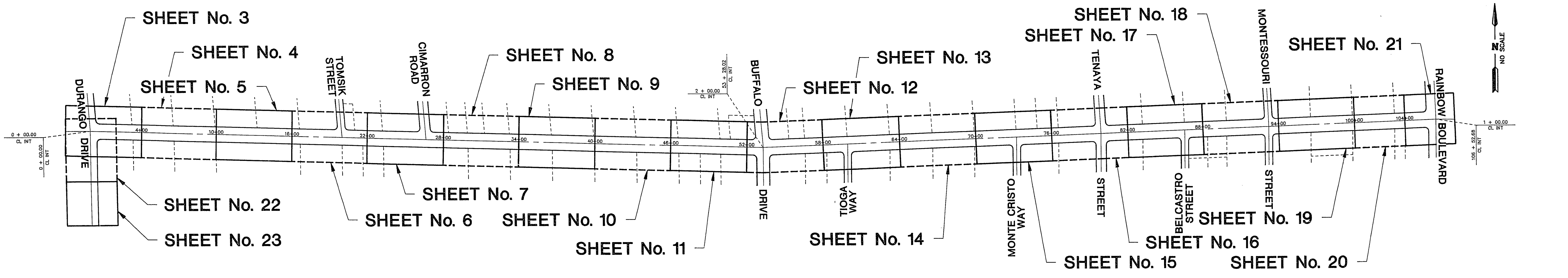

SAHARA AVENUE

Professional Engineer's Seal for E.S. MILLERS & ASSOCIATES, INC. with project details and signature.

SHEET INDEX, GENERAL NOTES. S.I.D. No. 1427 - SAHARA AVENUE (DURANGO DRIVE TO RAINBOW BOULEVARD)

Table with 2 columns: Field and Value. W.O. #: 9520, BY: DSR, DATE: OCT 1991, SCALE: NO SCALE

CLV DRAWING No. 107-V-2038 with a large number 2/43.