

LOT 1
1,588,412 sq. ft.
36.46 acres

NOTE: FOR VICINITY MAP, LEGEND, GENERAL NOTES, DETAILS, ETC. SEE SHEET # 2B.

NOTE: ALL INTERIOR STREETS ARE 5' WIDE UNLESS OTHERWISE NOTED.

INSTALL BARRIAD PER C.L.V. STD.

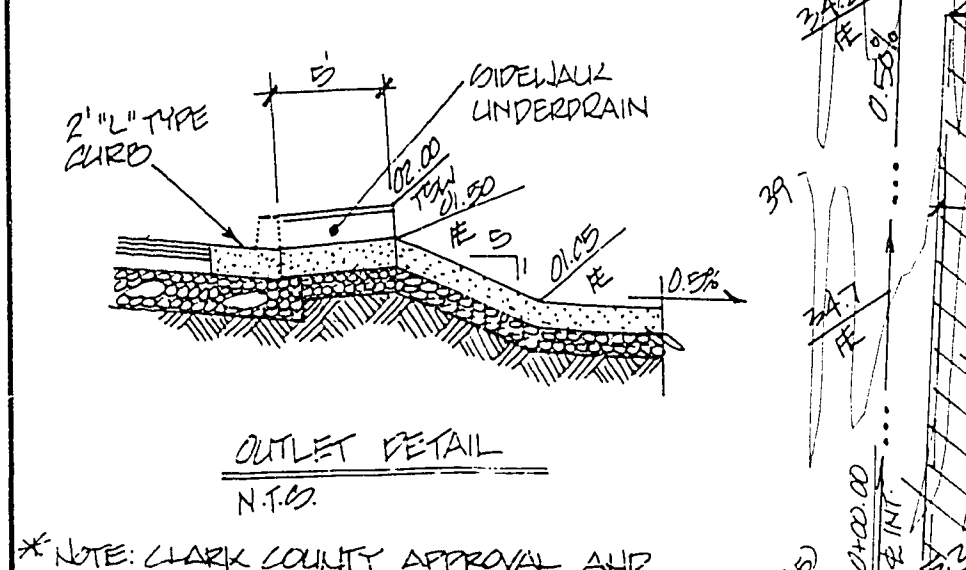
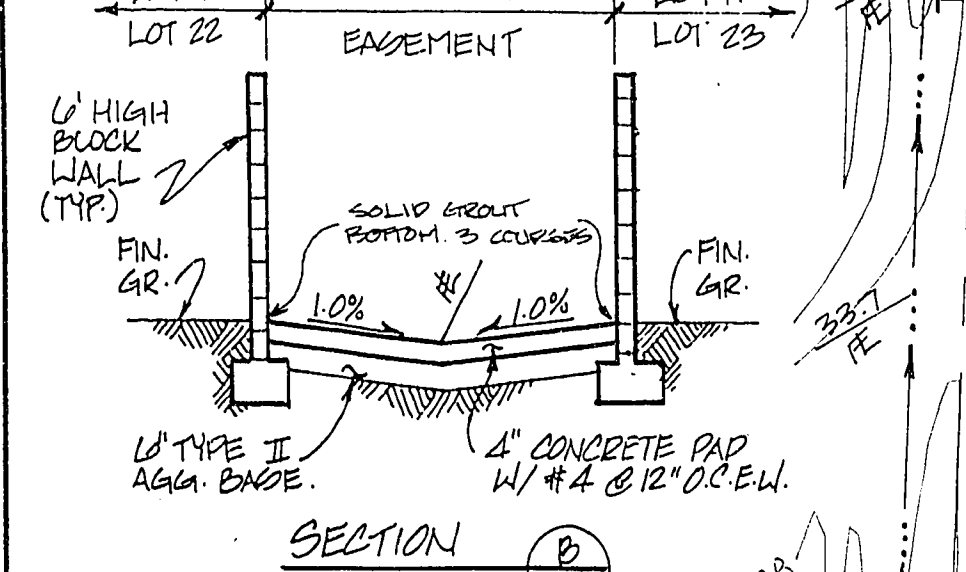
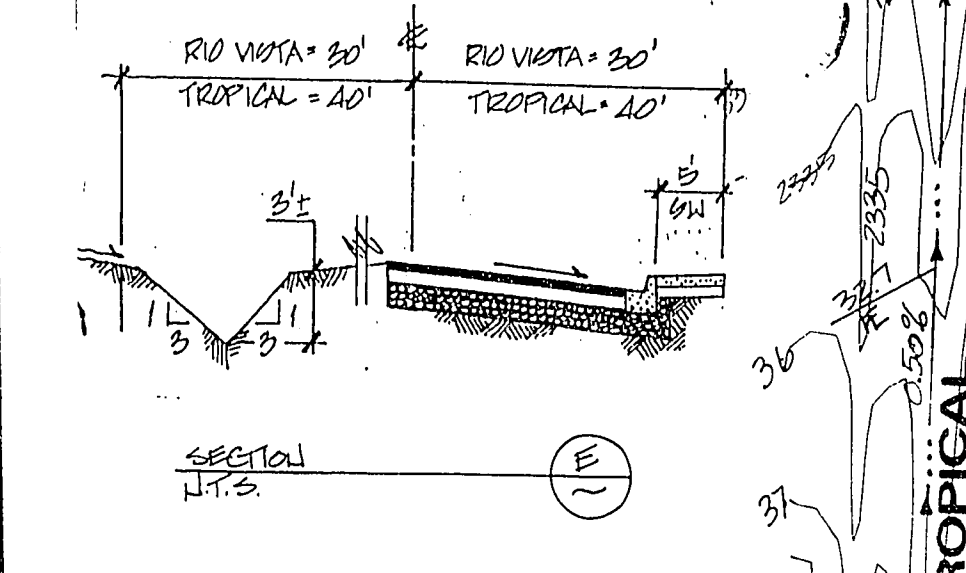
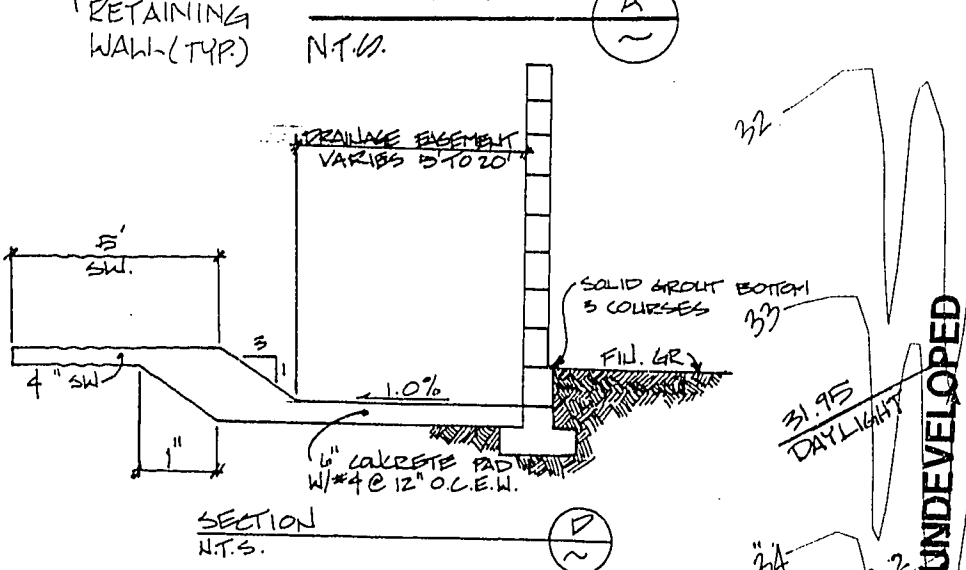
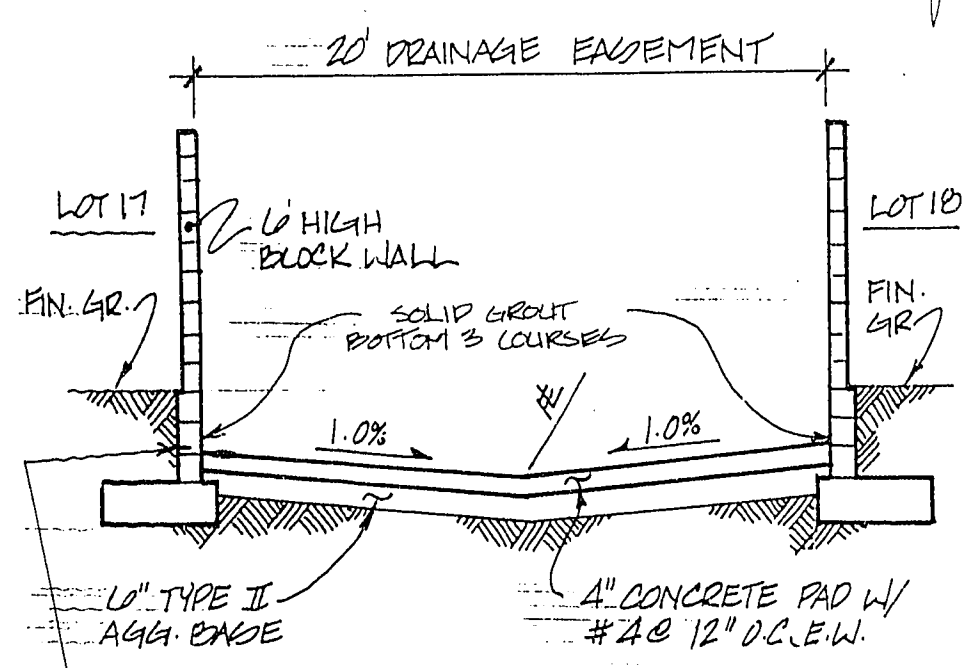

*NOTE: CLARK COUNTY APPROVAL AND PERMITS ARE REQUIRED FOR ANY CONSTRUCTION PROPOSED IN THE COUNTY.

DATE	BY	REVISION
4-17-93	D.H.	CONVERTED TO 1/4\"/>
4-19-93	TEH	REVISION TO DRAWING # 2013 @ BACK LANE GRADING, D.E.'S

U.S. HOME CITY OF LAS VEGAS, NEVADA

CONSULTING ENGINEERS • PLANNERS • LAND SURVEYORS
2727 SOUTH RAINBOW BOULEVARD
LAS VEGAS, NEVADA 89102-5148 PHONE (702) 873-7550 FAX (702) 362-2597

VTM nevada

OVERALL ROUGH GRADING PLAN

RIO VISTA ESTATES
UNIT 1

TITLE PROJECT

DATE	BY	SCALE
9/93	TEH, WJR	1/4\"/>
9/20/93		
NO. NO. 1		
DATE	BY	SCALE
9/93	TEH, WJR	1/4\"/>
9/20/93		
NO. NO. 1		

SEAL

Thomas J. Harper

9/20/93

NO. NO. 1

DATE

BY

SCALE

SHEET

2A OF 18 SHEETS

1074-4321-1

11-13-200