

IMPROVEMENT PLANS

FOR

REI TRUCK DOCK

BOCA PARK AT

PECCOLE RANCH TOWN CENTER

CITY OF LAS VEGAS, STATE OF NEVADA

A.P.N. 138-32-312-007
A.P.N. 138-32-312-008

BY TRIPLE FIVE NV DEVL. CORP
OWNER/DEVELOPER

TRIPLE FIVE NEVADA DEVL. CP.
9440 W. SAHARA AVE., SUITE 240
LAS VEGAS, NEVADA 89117
PH# (702) 430-5300

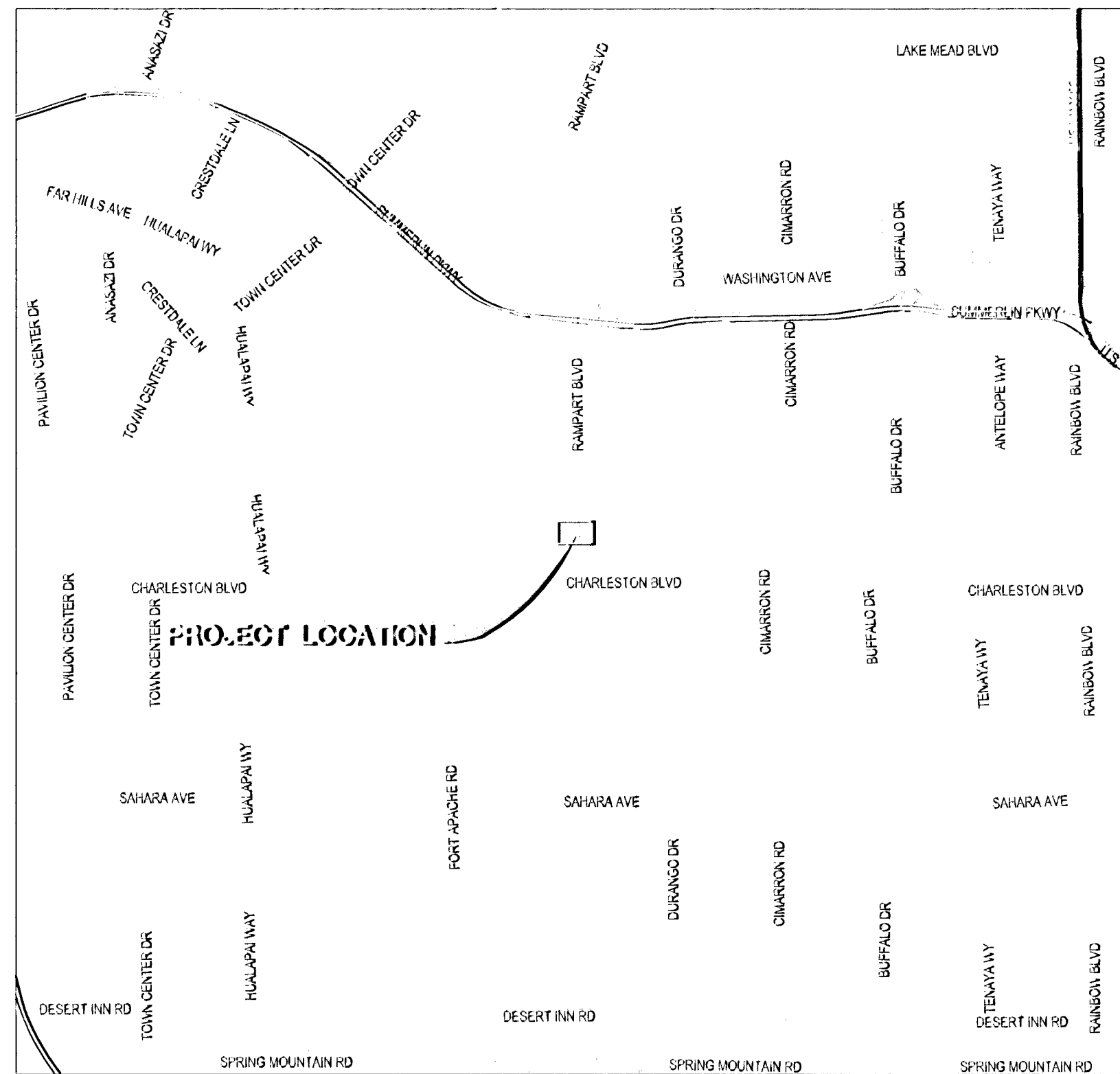

VICINITY MAP

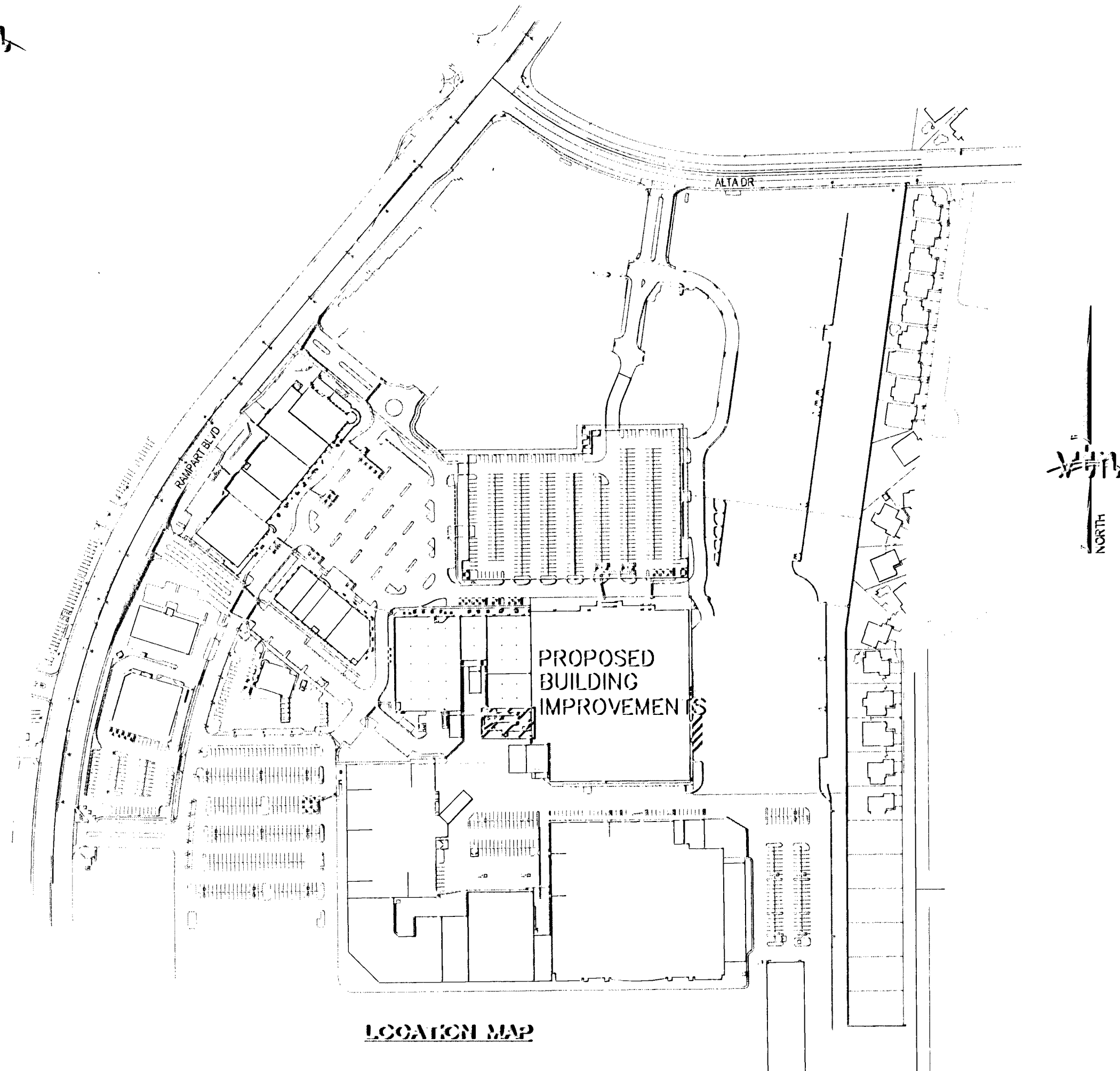

LOCATION MAP

BASIS OF BEARINGS

SOUTH 89°28'21" WEST, BEING THE BEARING OF THE SOUTH LINE OF THE SOUTHWEST QUARTER (SW 1/4) OF SECTION 32, TOWNSHIP 20 SOUTH, RANGE 60 EAST, M.D.M., CITY OF LAS VEGAS, CLARK COUNTY, NEVADA, AS SHOWN ON THAT CERTAIN PARCEL MAP ON FILE IN THE OFFICE OF THE CLARK COUNTY RECORDER IN FILE 60 OF PARCEL MAPS, AT PAGE 18.

BENCHMARK

PROJECT DATUM: NAVD83
CITY OF LAS VEGAS BENCHMARK: OLVD0 3255E8
NAVD83 ELEVATION: 821.5617 METERS (2694.75 FEET)
RIVET AND PLATE IN TOP OF CURB, NORTHEAST CORNER OF CHARLESTON BLVD. & MERALDO LANE.

Call before you Dig
1-800-221-2800

Call before you Overhead
1-702-221-2323

Call before you Underground
1-702-455-1511
CLARK COUNTY TRAFFIC OPERATIONS
1-702-223-6811
FREEWAY AND MATERIAL SYSTEMS OF TRANSPORTATION

APPROVALS

Cheri Edelman 9/26/08
CITY ENGINEER CHERI EDELMAN, PE# 11514 DATE

Doug Rankin 9/26/08
CITY PLANNING DOUG RANKIN, AICP, PLANNING MANAGER DATE

Jeffrey Bell 9/26/08
CITY FIRE MARSHAL DATE

APPROVAL OF THESE PLANS BY THE CITY ENGINEER IS LIMITED TO THOSE IMPROVEMENTS CONSTRUCTED IN THE DEDICATED RIGHT-OF-WAY AND/OR DEDICATED EASEMENTS. THIS APPROVAL DOES NOT AUTHORIZE THE CONSTRUCTION OF ANY IMPROVEMENTS THAT DEVIATE FROM ADOPTED STANDARDS AND/OR SPECIFICATIONS EXCEPT THOSE SPECIFICALLY LISTED UNDER DEVIATIONS FROM STANDARD. THE ENGINEER SHALL RESOLVE ANY DEVIATION OTHER THAN THOSE LISTED IN DEVIATIONS FROM STANDARDS IN FAVOR OF THE UNIFORM STANDARD DRAWINGS AND SPECIFICATIONS CLARK COUNTY AREA NEVADA.

SHEET INDEX

1. CV COVER SHEET
2. NT GENERAL NOTES
3. DM1 DEMO PLAN
4. GR1 GRADING PLAN
5. FA1 FIRE ACCESS PLAN

These plans and the design criteria contained within these plans are based upon the information presently known by the engineer and intended solely as a general guideline for construction. All construction shall be in conformance with all applicable local, state and federal statutes, laws, codes, regulations and ordinances, including but not limited to the Federal Fair Housing Amendments Act, Americans With Disabilities Act, the Architectural Barriers Act and any applicable uniform standards, specifications or drawings. The person or entity performing the construction shall be solely responsible to make sure construction is in conformance with all local, state and federal statutes, laws, codes, regulations, standards, guidelines and ordinances and further, is in conformance with any applicable design criteria, including but not limited to soils reports, traffic studies, geotechnical reports, architectural plans and specifications, drainage plans or studies and any other criteria, standards or requirements listed in the plans or the general notes related to these plans or provided by anyone in reference to this project.

113688

CIVIL#10715114

TRIPLE FIVE NEVADA DEVEL. CORP. 5640 W. SAHARA AVE., SUITE 240 LAS VEGAS, NEVADA 89117 PH# (702) 430-5300		CITY OF LAS VEGAS, NEVADA 2727 SOUTH RANSON BOULEVARD LAS VEGAS, NEVADA 89146-5146 PH: (702) 573-7500 FAX (702) 362-2537 WEB WWW.LVNV.COM CONSULTING ENGINEERS & PLANNERS & LAND SURVEYORS	
COVER SHEET		REI TRUCK DOCK BOCA PARK AT PECCOLE RANCH TOWN CENTER	
DRAWN BY: JAB	08/13/08	CHECKED BY:	HORIZ. VERT.
DESIGNED BY:		PROJECT NO:	SCALE: NA
		7100	NA
		EXPIRES 08-30-09	
		SHEET CV 1 OF 5 SHEETS	
		DRAWING NO. H#29702	