

NOTES:

1. NOTIFY HUNSAKER & ASSOCIATES IMMEDIATELY OF ANY DISCREPANCIES IN THE PLANS OR CONDITIONS IN THE FIELD.
2. PRIOR TO CONSTRUCTION THE CONTRACTOR SHALL LOCATE AND VERIFY SIZE, MATERIAL, DEPTH, CONDITION, PRESSURE, AND LOCATION OF ALL EXISTING UTILITY LINES WITHIN THE CONSTRUCTION AREA. HUNSAKER & ASSOCIATES SHALL BE CONTACTED ONCE THE UTILITY LINE IS LOCATED.
3. PLANS MAY NOT INDICATE ALL EXISTING UTILITY LINES. CONTRACTOR IS TO EXERCISE EXTREME CAUTION DURING EXCAVATION IN ORDER TO AVOID DAMAGING ANY EXISTING UTILITY LINES. IF THE UTILITY LINES ARE DAMAGED BY THE CONTRACTOR, SUCH DAMAGE SHALL BE REPAIRED TO THE SATISFACTION OF THE OWNER AT THE CONTRACTOR'S EXPENSE.
4. CONTRACTOR TO SAWCUT AND REMOVE EXISTING ASPHALT AND CONCRETE AS NECESSARY FOR UTILITY TRENCHES. BACKFILL AND PATCH ALL TRENCHES ACCORDING TO C.L.V. STANDARDS.
5. ALL WATER SERVICE LINES AND METERS SHALL BE INSTALLED PER L.V.C.R.D.
6. CONTRACTOR TO FIELD VERIFY LOCATION AND INSET OF MANHOLE RISER TO CONSTRUCTION. HUNSAKER & ASSOCIATES SHALL BE CONTACTED ONCE THIS INFORMATION HAS BEEN OBTAINED.
7. ALL ON-SITE SEWERMAINS ARE PRIVATE AND SHALL BE PRIVATELY OWNED AND MAINTAINED.

LAS VEGAS FIRE DEPARTMENT

FIRE FLOW REQUIREMENT IS 2,500 GALLONS PER MINUTE AT 20 POUNDS PER SQUARE INCH RESIDUAL.

BASED ON:

- SQUARE FOOTAGE: 33,000 square feet
- LARGEST AREA BETWEEN 4 HOUR AREA SEPARATION WALLS: square feet
- BUILDING HEIGHT: feet
- NUMBER OF STORIES: feet
- TYPE OF CONSTRUCTION: V-M
- OCCUPANCY:
- FULL AUTOMATIC FIRE: YES (ALL BUILDINGS ARE SPRINKLERED) SPRINKLER SYSTEM

REVIEWED BY: *[Signature]*
DATE: 4-2-96

QUANTITY ESTIMATE (SHEETS 7&8)

WATER IMPROVEMENTS	AMOUNT	UNIT
12" WATER MAIN	800	LF
8" WATER MAIN	4,300	LF
6" WATER MAIN	230	LF
FIRE HYDRANT ASSEMBLY		
1/4" 8" TEE, GATE VALVE	14	EA
8" x 3" FNCT W/ 8" RPPA	2	EA
12" VALVE	2	EA
8" VALVE	13	EA
8" TO 6" REDUCER	2	EA
12" TO 8" REDUCER	1	EA
8" x 8" TEE	4	EA
12" x 8" TEE	1	EA
12" x 6" TEE	1	EA
12" 90° ELBOW	1	EA
8" 90° ELBOW	8	EA
8" 90° ELBOW	1	EA
8" 11 1/4" ELBOW	10	EA
2" SERVICE LINE	200	LF
3/4" SERVICE LINE	303	LF

SEWER IMPROVEMENTS	AMOUNT	UNIT
8" SEWER MAIN	3,400	LF
6" SEWER MAIN	401	LF
6" SEWER CLEANOUT	1	EA
SEWER MANHOLES < 8"	7	EA
SEWER MANHOLES > 8"	8	EA

INSTALLATION OF METER AND VAULT 2'-6" X 3'

THE METERS AND VAULTS WITH NON-TRAFFIC BEARING COVERS SHALL BE INSTALLED IN ACCORDANCE WITH THE LEADS PLATE NO. 100 AND 100B STANDARD VAULT DRAWING C-175, LATEST REVISION.

METERS MUST BE SET IN A HORIZONTAL POSITION AT LEAST 6" (6) DIAMETERS OF STRAIGHT PIPE ARE REQUIRED AT THE METER END.

REDUCED PRESSURE PRINCIPLE ASSEMBLY

APPROVED REDUCED PRESSURE PRINCIPLE ASSEMBLY SHALL BE INSTALLED PER THE LEADS STANDARD PLATE NO. 118. NO WATER SHALL BE TAKEN FROM A SERVICE REQUIREING PRESSURE PREVENTION UNTIL THE REDUCED PRESSURE PRINCIPLE ASSEMBLY HAS BEEN SUCCESSFULLY TESTED BY THE OWNER.

SANITARY SEWER LATERAL NOTE

UNLESS SHOWN OTHERWISE ALL SANITARY SEWER LATERALS SHALL BE INSTALLED AT 2% MINIMUM SLOPE FROM THE SANITARY SEWER MAIN.

APPROVALS:

[Signature] 4-2-96
CLV FIRE DEPARTMENT DATE

[Signature] 4-15-96
L.V.C.R.D. DATE

NEVADA POWER COMPANY DATE

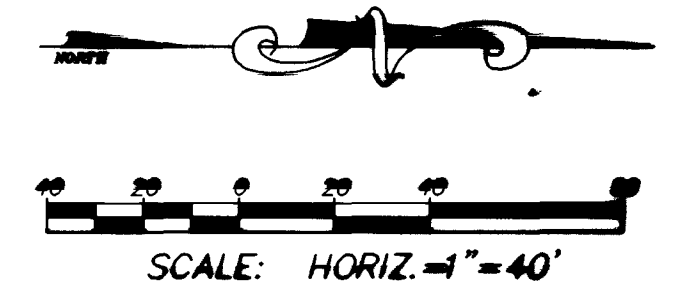

- LEGEND:**
- CONSTRUCT PVC SEWER MAIN WITH 4' MANHOLE
 - INSTALL PVC WATER MAIN, FIRE HYDRANT, AND GATE VALVE
 - INSTALL 1/2 PULL BOX
 - INSTALL 4" SEWER SERVICE LATERAL
 - INSTALL WATER SERVICE LATERAL WITH METER AND GATE VALVE
 - INSTALL 200 H.P.S. STREET LIGHT
 - EXISTING SEWER MAIN AND MANHOLE
 - EXISTING WATER MAIN, FIRE HYDRANT, AND GATE VALVE
 - INSTALL 3" INTERCONNECT CONDUIT
 - INSTALL 1 1/4" ST. LT. CONDUIT

ABANDONED VALVE, GATE AND CAP ALL VALVES TO BE ABANDONED IN THE CLOSED POSITION UNLESS OTHERWISE BY REMOVING A MINIMUM OF THE TOP 12 INCHES OF THE VALVE BOX AND THEN FILLING THE STRENGTH OF AT LEAST 2000 P.S.I. CONCRETE HAVING A COMPRESSIVE STRENGTH OF AT LEAST 2000 P.S.I. THE CONTRACTOR SHALL CUT THE EXISTING PIPE 3' BEYOND THE ABANDONED VALVE AND SHALL BE RESPONSIBLE FOR THE REMOVAL OF THE EXISTING PIPE AND THE INSTALLATION OF A CONCRETE THURST BLOCK AT THE DISTRICT APPROVAL. THE CONTRACTOR SHALL INSTALL A CONCRETE THURST BLOCK AT ALL CAP AND GATE LOCATIONS. THE CONTRACTOR SHALL INSTALL A CONCRETE THURST BLOCK AT ALL CAP AND GATE LOCATIONS.

NOTE: NO WORK SHALL BE PERFORMED IN THIS AREA WITHOUT A NDOT ENCROACHMENT PERMIT.

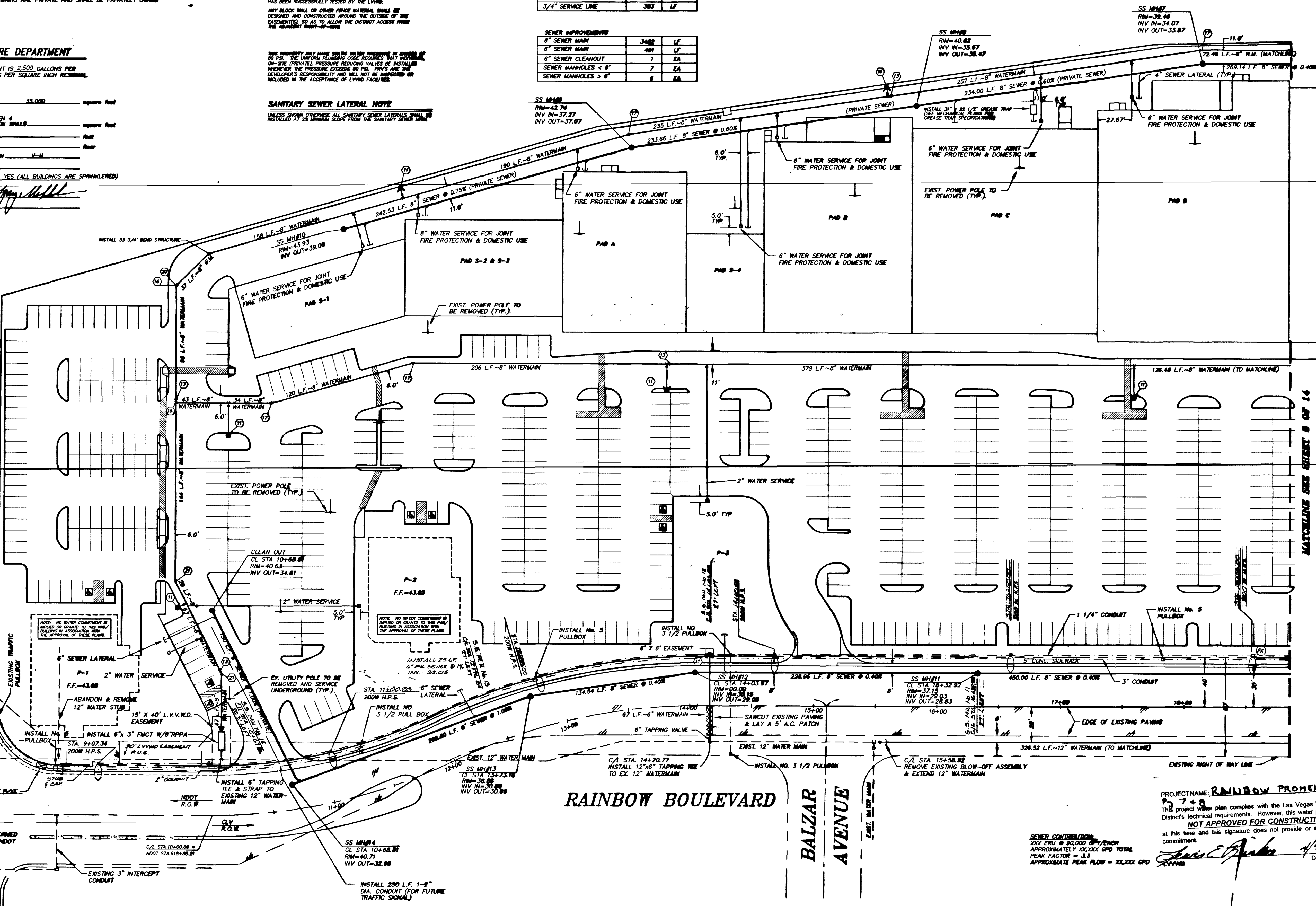

KEY NOTES:

1. INSTALL FIRE HYDRANT ASSEMBLY PER LD & CS NO. 1
2. INSTALL 6" GATE VALVE
3. INSTALL 8" GATE VALVE
4. INSTALL 12" GATE VALVE
5. INSTALL 8" x 8" TEE
6. INSTALL 8" 90° ELBOW
7. INSTALL 8" 11 1/4" ELBOW
8. INSTALL 8" x 6" REDUCER
9. INSTALL 6" 90° ELBOW
10. INSTALL 8" 45° BEND
11. INSTALL 8" 22 1/2° BEND

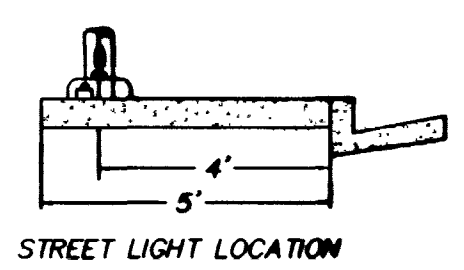

STREET LIGHT NOTE: ALL HAND HOLE COVERS MUST BE INSTALLED, POLE CAPS POURED, AND PULL BOX LIDS BOLTED DOWN PRIOR TO ENERGIZING CIRCUIT. ALL WIRE MUST HAVE THW INSULATION.

NOTE: THE 1 1/4" STREET LIGHT CONDUIT IS BEING SHOWN AT THE BACK OF SIDEWALK FOR CLARITY PURPOSES ONLY. BOTH THE 1 1/4" & 3" CONDUITS ARE TO BE INSTALLED UNDER SIDEWALK.

Avoid cutting underground utility lines. It's costly.
Call before you Dig
1-800-227-2000
UNDERGROUND SERVICE (USA)

PROJECT NAME: RAINBOW PROMENADE

DESIGN NO. 7-7-96
This project water plan complies with the Las Vegas Valley Water District's technical requirements. However, this water plan is NOT APPROVED FOR CONSTRUCTION.

NOT APPROVED FOR CONSTRUCTION
at this time and this signature does not provide or imply a water commitment.

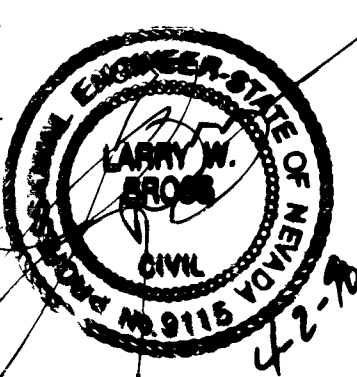

SEWER CONTRIBUTION:
300 ERU @ 90,000 GPD EACH
APPROXIMATELY 30,000 GPD TOTAL
PEAK FACTOR = 3.3
APPROXIMATE PEAK FLOW = 300,000 GPD

NO.	DESCRIPTION	BY	DATE	APPROVED

PREPARED BY: *[Signature]*
Hunsaker & Associates
Engineering + Planning
1000 W. Sahara Ave., Suite 100
Las Vegas, NV 89102
Las Vegas • San Bernardino • San Diego • Irvine

RAINBOW PROMENADE
LAS VEGAS, NEVADA

UTILITY PLAN

PROJECT NO. 1636-2
SHEET 7 OF 14

8370 11-28-70 307Y-4448

- 1. GENERAL NOTES
- 2. EXISTING CONDITIONS
- 3. PROPOSED CONDITIONS
- 4. FINISHES
- 5. MATERIALS
- 6. CONSTRUCTION METHODS
- 7. UTILITIES
- 8. EROSION CONTROL
- 9. LANDSCAPE
- 10. SIGNAGE
- 11. LIGHTING
- 12. FURNITURE
- 13. ACCESSIBILITY
- 14. SAFETY
- 15. ENVIRONMENTAL
- 16. HISTORIC PRESERVATION
- 17. TRANSPORTATION
- 18. UTILITIES
- 19. CONSTRUCTION METHODS
- 20. FINISHES
- 21. MATERIALS
- 22. CONSTRUCTION METHODS
- 23. FINISHES
- 24. MATERIALS
- 25. CONSTRUCTION METHODS
- 26. FINISHES
- 27. MATERIALS
- 28. CONSTRUCTION METHODS
- 29. FINISHES
- 30. MATERIALS

GENERAL NOTES:
 1. ALL WORK SHALL BE IN ACCORDANCE WITH THE LATEST EDITIONS OF THE INTERNATIONAL BUILDING CODE (IBC) AND THE CALIFORNIA BUILDING CODE (CBC).
 2. THE CONTRACTOR SHALL BE RESPONSIBLE FOR OBTAINING ALL NECESSARY PERMITS AND APPROVALS FROM THE LOCAL JURISDICTIONS.
 3. THE CONTRACTOR SHALL MAINTAIN ACCESS TO ALL ADJACENT PROPERTIES AND UTILITIES AT ALL TIMES.
 4. ALL MATERIALS AND WORKMANSHIP SHALL BE SUBJECT TO INSPECTION AND APPROVAL BY THE LOCAL BUILDING DEPARTMENT.
 5. THE CONTRACTOR SHALL BE RESPONSIBLE FOR PROTECTING ALL EXISTING UTILITIES AND STRUCTURES.
 6. ALL CONSTRUCTION SHALL BE COMPLETED WITHIN THE SPECIFIED TIME FRAME.
 7. THE CONTRACTOR SHALL MAINTAIN A NEAT AND SAFE WORK SITE AT ALL TIMES.
 8. ALL WASTE SHALL BE PROPERLY DISPOSED OF AT THE END OF EACH WORK DAY.
 9. THE CONTRACTOR SHALL BE RESPONSIBLE FOR OBTAINING ALL NECESSARY INSURANCE COVERAGE.
 10. ALL WORK SHALL BE COMPLETED IN ACCORDANCE WITH THE SPECIFICATIONS AND NOTES.

NO.	DESCRIPTION	QTY	UNIT
1	CONCRETE	100	YD
2	STEEL	50	TON
3	BRICK	200	THOUSAND
4	GLASS	100	SQ FT
5	PAINT	50	GAL
6	ROOFING	100	SQ FT
7	MECHANICAL	100	HR
8	ELECTRICAL	100	HR
9	PLUMBING	100	HR
10	LANDSCAPE	100	HR
11	CONSTRUCTION	100	HR
12	UTILITIES	100	HR
13	ENVIRONMENTAL	100	HR
14	HISTORIC PRESERVATION	100	HR
15	TRANSPORTATION	100	HR
16	UTILITIES	100	HR
17	CONSTRUCTION METHODS	100	HR
18	FINISHES	100	HR
19	MATERIALS	100	HR
20	CONSTRUCTION METHODS	100	HR
21	FINISHES	100	HR
22	MATERIALS	100	HR
23	CONSTRUCTION METHODS	100	HR
24	FINISHES	100	HR
25	MATERIALS	100	HR
26	CONSTRUCTION METHODS	100	HR
27	FINISHES	100	HR
28	MATERIALS	100	HR
29	CONSTRUCTION METHODS	100	HR
30	FINISHES	100	HR

DATE: 11-29-20
 DRAWN BY: [Signature]
 CHECKED BY: [Signature]



- 1. FINISHES
- 2. MATERIALS
- 3. CONSTRUCTION METHODS
- 4. UTILITIES
- 5. ENVIRONMENTAL
- 6. HISTORIC PRESERVATION
- 7. TRANSPORTATION
- 8. UTILITIES
- 9. CONSTRUCTION METHODS
- 10. FINISHES
- 11. MATERIALS
- 12. CONSTRUCTION METHODS
- 13. FINISHES
- 14. MATERIALS
- 15. CONSTRUCTION METHODS
- 16. FINISHES
- 17. MATERIALS
- 18. CONSTRUCTION METHODS
- 19. FINISHES
- 20. MATERIALS
- 21. CONSTRUCTION METHODS
- 22. FINISHES
- 23. MATERIALS
- 24. CONSTRUCTION METHODS
- 25. FINISHES
- 26. MATERIALS
- 27. CONSTRUCTION METHODS
- 28. FINISHES
- 29. MATERIALS
- 30. CONSTRUCTION METHODS

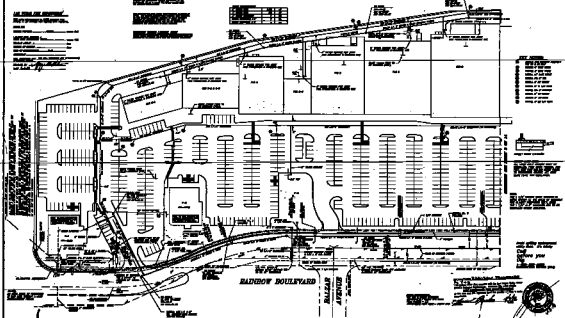

- 1. FINISHES
- 2. MATERIALS
- 3. CONSTRUCTION METHODS
- 4. UTILITIES
- 5. ENVIRONMENTAL
- 6. HISTORIC PRESERVATION
- 7. TRANSPORTATION
- 8. UTILITIES
- 9. CONSTRUCTION METHODS
- 10. FINISHES
- 11. MATERIALS
- 12. CONSTRUCTION METHODS
- 13. FINISHES
- 14. MATERIALS
- 15. CONSTRUCTION METHODS
- 16. FINISHES
- 17. MATERIALS
- 18. CONSTRUCTION METHODS
- 19. FINISHES
- 20. MATERIALS
- 21. CONSTRUCTION METHODS
- 22. FINISHES
- 23. MATERIALS
- 24. CONSTRUCTION METHODS
- 25. FINISHES
- 26. MATERIALS
- 27. CONSTRUCTION METHODS
- 28. FINISHES
- 29. MATERIALS
- 30. CONSTRUCTION METHODS



DATE: 11-29-20
 DRAWN BY: [Signature]
 CHECKED BY: [Signature]

- 1. FINISHES
- 2. MATERIALS
- 3. CONSTRUCTION METHODS
- 4. UTILITIES
- 5. ENVIRONMENTAL
- 6. HISTORIC PRESERVATION
- 7. TRANSPORTATION
- 8. UTILITIES
- 9. CONSTRUCTION METHODS
- 10. FINISHES
- 11. MATERIALS
- 12. CONSTRUCTION METHODS
- 13. FINISHES
- 14. MATERIALS
- 15. CONSTRUCTION METHODS
- 16. FINISHES
- 17. MATERIALS
- 18. CONSTRUCTION METHODS
- 19. FINISHES
- 20. MATERIALS
- 21. CONSTRUCTION METHODS
- 22. FINISHES
- 23. MATERIALS
- 24. CONSTRUCTION METHODS
- 25. FINISHES
- 26. MATERIALS
- 27. CONSTRUCTION METHODS
- 28. FINISHES
- 29. MATERIALS
- 30. CONSTRUCTION METHODS