

NAME: P:\W7X70800\700CADD\702CIVIL\702DWG\70800-sd02.DWG DATE: JAN 13, 2004 TIME: 12:06 PM

40' 20' 0 40' 80'
SCALE: 1" = 40'

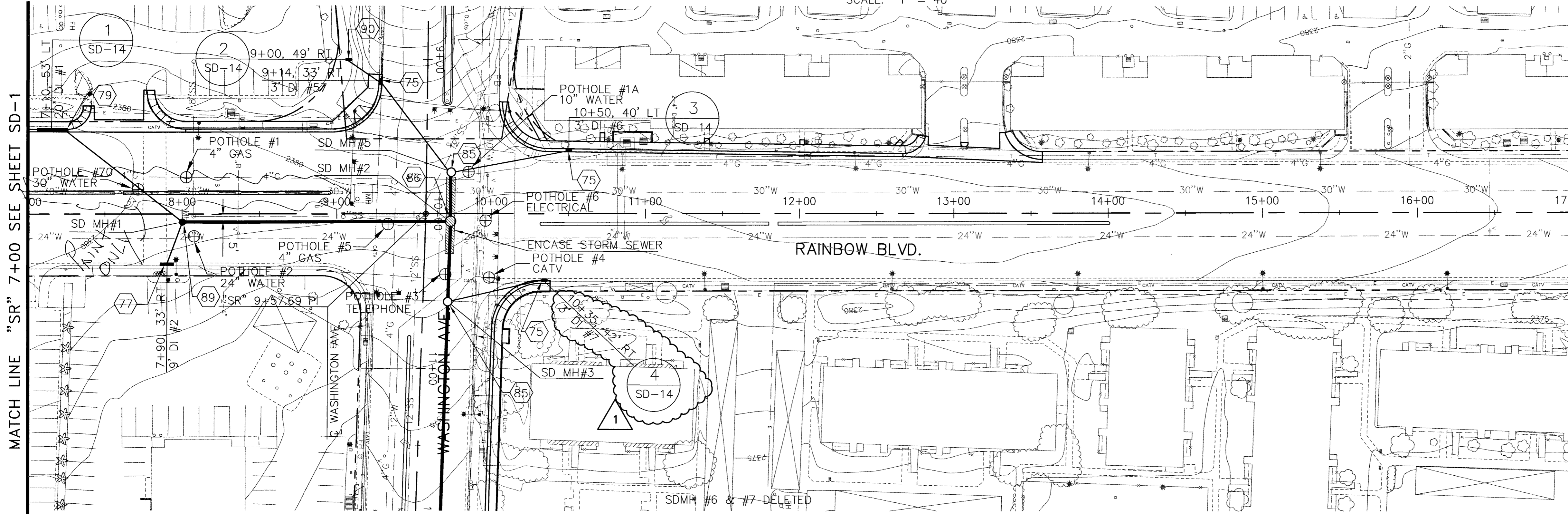
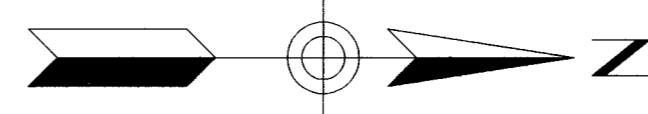

MATCH LINE "SR" 7+00 SEE SHEET SD-1

MATCH LINE "SR" 17+00 SEE SHEET SD-3

SEE SHEET SD-11

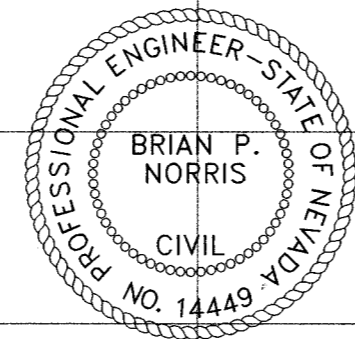

NOTE: FOR REVISION 1 ONLY

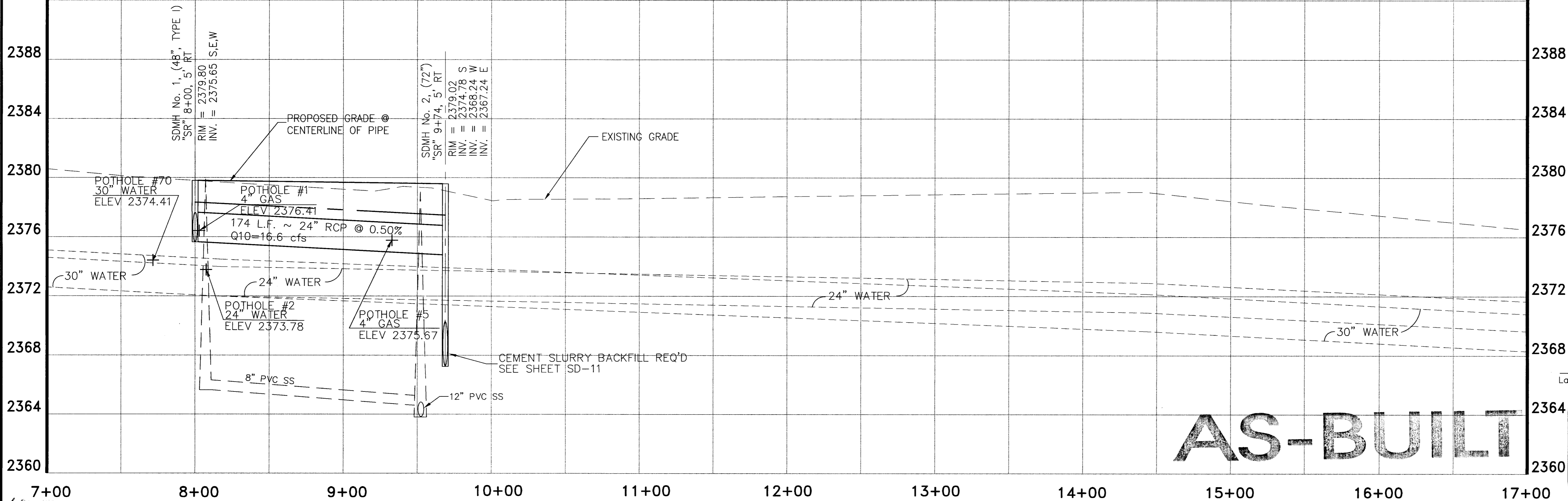

AS-BUILT

NOTES:

- 75 CONSTRUCT 3' TYPE PC1 DROP INLET (REFER TO SHEET SD-20)
- 77 CONSTRUCT 9' TYPE PC3 DROP INLET (REFER TO SHEET SD-20)
- 78 CONSTRUCT 20' TYPE "DM2" DROP INLET (REFER TO SHEET SD-19)
- 85 CONSTRUCT TYPE III MANHOLE, 60"
- 86 CONSTRUCT 72" MANHOLE (REFER TO SHEET SD-22)
- 89 CONSTRUCT TYPE I MANHOLE, 48"
- 90 CONSTRUCT NDOT HEADWALL, DWG R-2.5.1 (REFER TO SHEET SD-22)

BASIS OF BEARINGS
 NORTH 00°05'50" WEST, BEING THE BEARING OF THE WEST LINE OF THE SOUTHWEST QUARTER (SW 1/4) OF SECTION 23, T. 20 S., R. 60 E., M.D.M., CLARK COUNTY, NEVADA, AS SHOWN ON FILE 80 OF PARCEL MAPS, AT PAGE 46.

BENCHMARK
 CITY OF LAS VEGAS BENCHMARK: 1LV00 26W4 RIVET AND PLATE IN TOP OF CURB, NORTHEAST RETURN OF RAINBOW BLVD AND WASHINGTON AVE. ELEV. = 724.7549 METERS (PUBLISHED NAVD'88) ELEV. = 2377.80 U.S. SURVEY FEET (CALCULATED NAVD'88)

CITY OF LAS VEGAS BENCHMARK: 0LV00 14SWS RIVET AND PLATE IN TOP OF CURB, NORTHEAST RETURN OF SMOKE RANCH RD AND LORENZI BLVD. ELEV. = 708.7363 METERS (PUBLISHED NAVD'88) ELEV. = 2325.25 U.S. SURVEY FEET (CALCULATED NAVD'88)

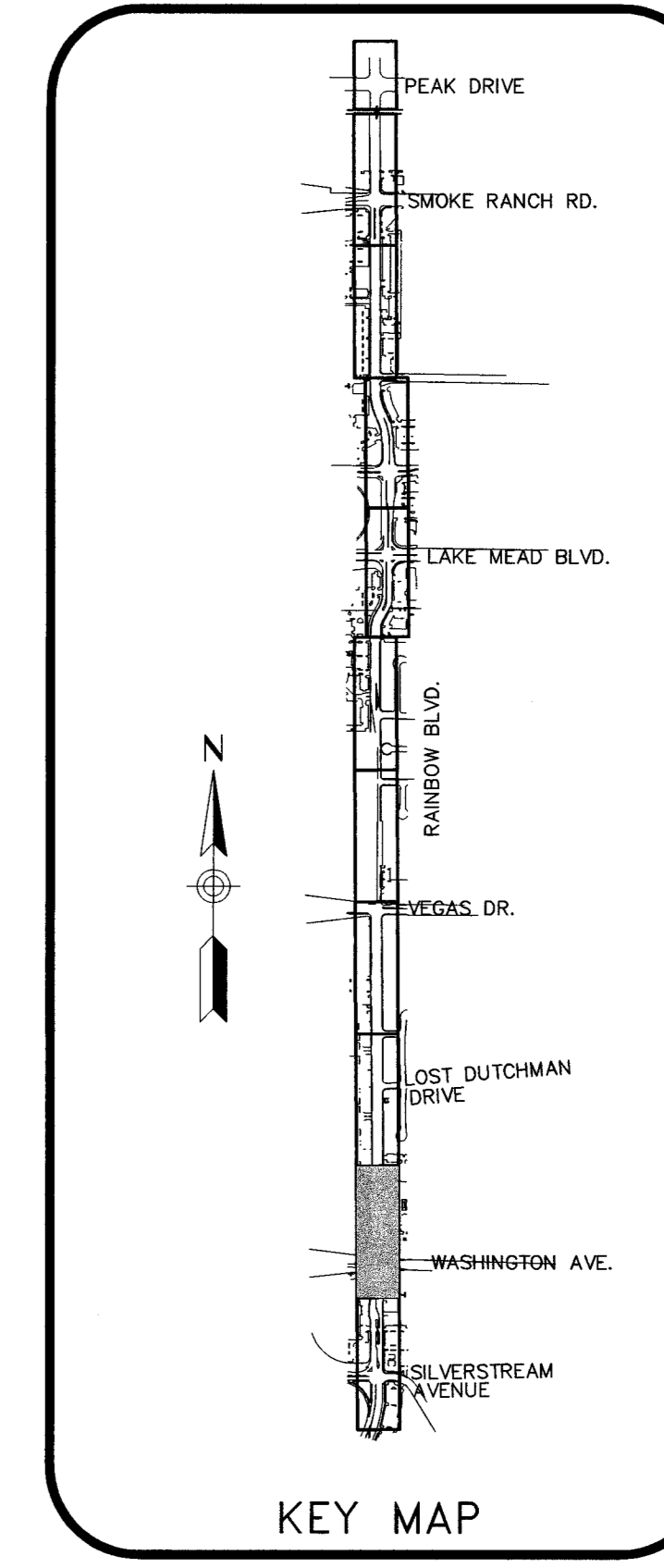

KEY MAP

Las Vegas Valley Water District Date

Call before you Dig.
 1-800-227-2600
 UNDERGROUND SERVICE (USA)
 AND
 CLARK COUNTY TRAFFIC MANAGEMENT OPERATIONS UNIT (702) 455-7544



PROJECT NO.	W7X70800
DESIGN:	DEP
DATE:	2/14/2002
SCALE:	1:40
CADFILE:	70800-402
PROJ. NO.	W7X70800
DESIGN:	DEP
DATE:	2/14/2002
SCALE:	1:40
CADFILE:	70800-402
STAMP DATE:	
PROF. NO.	14449
STATE	NEVADA
DISCIPLINE	CIVIL
NAME	BRIAN P. NORRIS

Sverdrup CIVIL, INC.

**Rainbow Boulevard
 Silverstream Ave. to Smoke Ranch Road
 Storm Drain Plan & Profile
 "SR" 7+00 to "SR" 17+00**

SHEET **SD-2**
 66 OF 110 SHEETS
 DRAWING NO. 107-V3519