

NAME: P:\W7X70800\700CADD\702DVG\702DVG\70800-rd21.DWG DATE: FEB 25, 2002 TIME: 9:33 AM

45825

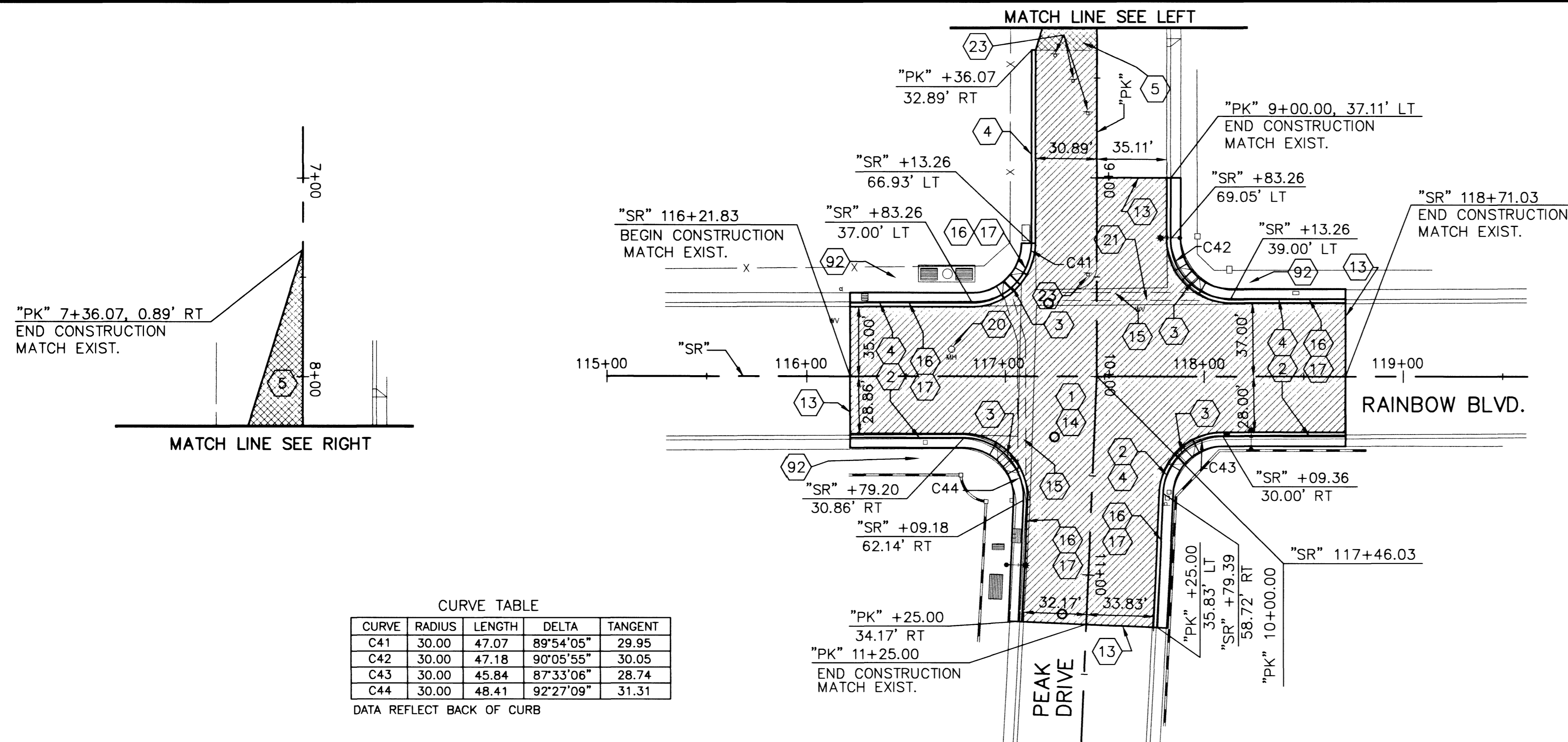

DATA REFLECT BACK OF CURB

CURVE	RADIUS	LENGTH	DELTA	TANGENT
C41	30.00	47.07	89°54'05"	29.95
C42	30.00	47.18	90°05'55"	30.05
C43	30.00	45.84	87°33'06"	28.74
C44	30.00	48.41	92°27'09"	31.31

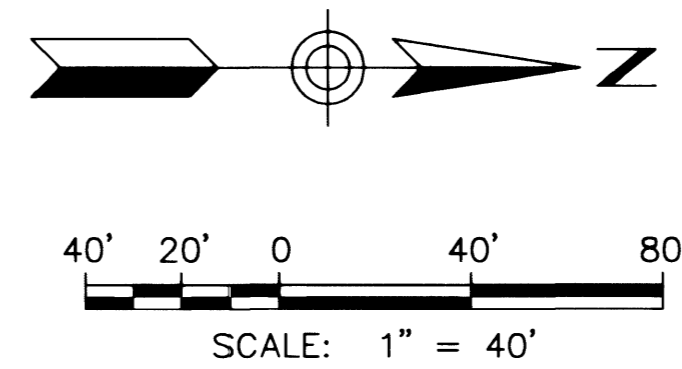

SEE SHEET SD-13 FOR DRAINAGE PLAN

SEE SHEET S-21 FOR INTERSECTION GRADING PLAN

LEGEND
 FULL DEPTH PAVEMENT SECTION
 PAVEMENT PER USD. DWG. NO. 210

NOTES:

- CONSTRUCT ASPHALT PAVEMENT WITH TYPE II AGGREGATE BASE (REFER TO TYPICAL SECTIONS FOR PAVEMENT DESIGN)
- CONSTRUCT CONCRETE SIDEWALK (USD. DWG. NO. 234)
- CONSTRUCT SIDEWALK RAMP, CASE 1 (USD. DWG. NO. 235)
- CONSTRUCT "L" TYPE CURB & GUTTER (USD. DWG. NO. 216)
- CONSTRUCT PAVEMENT PER USD. DWG. NO. 210
- SAWCUT
- REMOVE ASPHALT PAVEMENT
- REMOVE CROSS GUTTER
- REMOVE CURB AND GUTTER
- REMOVE SIDEWALK
- ADJUST MANHOLE TO GRADE (USD. DWG. NO. 408)
- ADJUST WATER VALVE BOX TO FINISHED GRADE PER UDACS PLATE NO. 8 (VALVE SHALL BE ACCESSIBLE AT ALL TIMES)
- REMOVE SIGN(S) AND POST
- RESTORE LANDSCAPING AND IRRIGATION TO MATCH EXISTING (REPLACE IN KIND)

BASIS OF BEARINGS
 NORTH 00°05'50" WEST, BEING THE BEARING OF THE WEST LINE OF THE SOUTHWEST QUARTER (SW 1/4) OF THE SOUTHWEST QUARTER (SW 1/4) OF SECTION 23, T. 20 S., R. 60 E., M.D.M., CLARK COUNTY, NEVADA, AS SHOWN ON FILE 80 OF PARCEL MAPS, AT PAGE 46.

BENCHMARK
 CITY OF LAS VEGAS BENCHMARK: 1LV00 26W4 RIVET AND PLATE IN TOP OF CURB, NORTHEAST RETURN OF RAINBOW BLVD AND WASHINGTON AVE. ELEV. = 724.7549 METERS (PUBLISHED NAVD'88) ELEV. = 2377.80 U.S. SURVEY FEET (CALCULATED NAVD'88)
 CITY OF LAS VEGAS BENCHMARK: 0LV00 14SW5 RIVET AND PLATE IN TOP OF CURB, NORTHEAST RETURN OF SMOKE RANCH RD AND LORENZI BLVD. ELEV. = 708.7363 METERS (PUBLISHED NAVD'88) ELEV. = 2325.25 U.S. SURVEY FEET (CALCULATED NAVD'88)

REV.	DATE	DESCRIPTION	DATE	APP.	DATE	APPROVER

PROJ NO: W7X70800
 DESIGN: DEP
 DATE: 2/14/2002
 SCALE: 1:40
 CADFILE:

STAMP DATE: 2/29/02

3450 W. SMOKER AVE., SUITE 500
 LAS VEGAS, NV 89102-1948
 PHONE: (702) 890-2939
 FAX: (702) 890-1731

Sverdrup
 CIVIL, INC.

RAINBOW BOULEVARD
 SILVERSTREAM AVE. TO SMOKE RANCH ROAD
 ROADWAY PLAN & PROFILE
 "SR" 116+21.83 TO "SR" 118+71.03

SHEET
S-11
 34 OF 110 SHEETS
 DRAWING NO.
 107-V3519

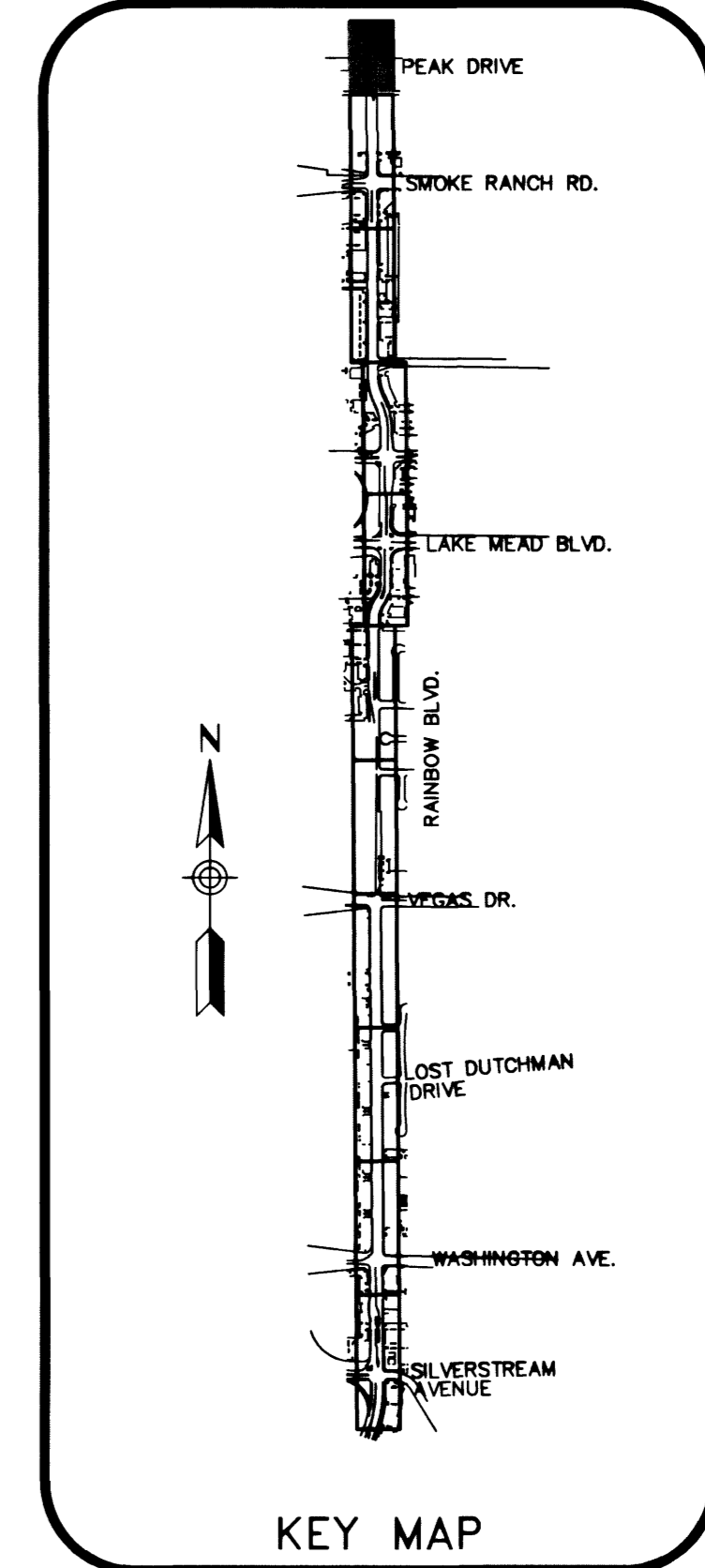
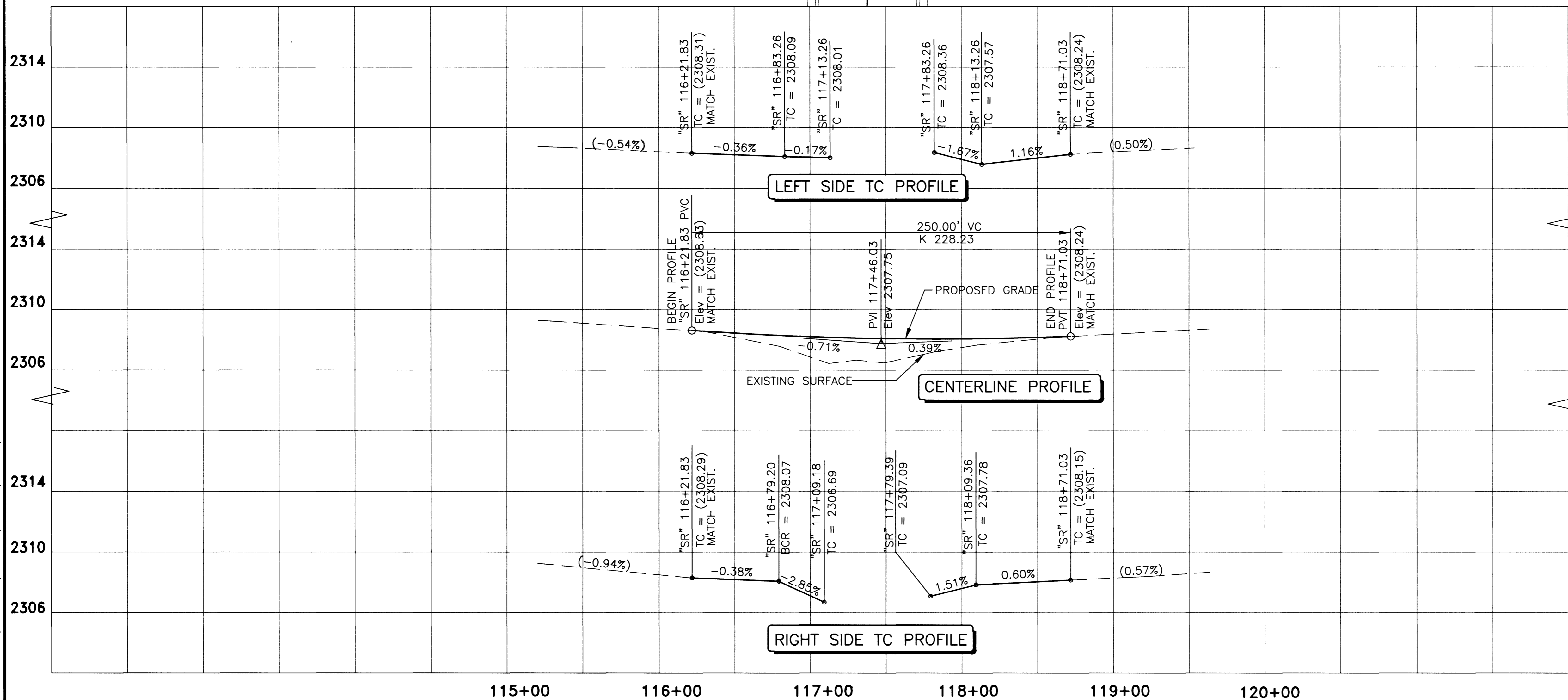

M. G. G. 2/29/02
 Las Vegas Valley Water District Date

Call before you Dlg.
 1-800-227-2600
 UNDERGROUND SERVICE (USA)
 CLARK COUNTY TRAFFIC MANAGEMENT AND OPERATIONS UNIT (702) 455-7544

