

KEY MAP
N.T.S.

GRAPHIC SCALE
0 20 40 80
1" = 40'

PROFILE SCALES:
HORZ. = 1"=40'
VERT. = 1"=4'

NOTE
1. FOR DETAILS AND SECTIONS SEE SHEET DTI

HC RAMP DATA

NO.	A'	B'	CASE
1	B	B	

CONSTRUCTION NOTES
 (A) CONSTRUCT 30" "ROLL" TYPE CURB & GUTTER PER STD. DWG. NO. 217A
 (F) CONSTRUCT WHEEL CHAIR RAMP PER STD. DWG. NO. 235 CASE 1

CONTRACTOR NOTE:
 CONTRACTOR SHALL VERIFY HORIZONTAL AND VERTICAL LOCATION OF EXISTING IMPROVEMENTS UTILITIES AND NOTIFY THE DESIGN ENGINEER IMMEDIATELY OF ANY DISCREPANCIES PRIOR TO CONSTRUCTION.

PRIVATE STREET NOTE:
 PRIVATE STREETS ARE P.U.E.S. C.L.V. PUBLIC SEWER EASEMENTS, AND PUBLIC DRAINAGE EASEMENT ARE TO BE PRIVATELY MAINTAINED.

Avoid overhead power line contact. It's costly.
Call before you Overhead
 1-702-227-2828

Avoid cutting underground utility lines. It's costly.
Call before you Dig
 1-800-227-2800

Call before you Underground
 1-702-455-7511
 CLARK COUNTY TRAFFIC OPERATIONS AND
 1-702-228-6811
 LAS VEGAS AREA COMPUTERIZED TRAFFIC SYSTEM

BENCHMARKS
 PROJECT DATUM: NORTH AMERICAN VERTICAL DATUM OF 1988 (NAV088)
 CLARK COUNTY BENCHMARK: BLV90-14N66
 NAV088 ELEVATION: 720.144 METERS (2362.67 FEET)
 CITY OF LAS VEGAS RIVET AND ROUND PLATE IN CONCRETE PAD. ±120' EAST OF MAVERICK ST. NEAR 6181 GRAND TETON DR.

BASIS OF BEARINGS
 THE BASIS OF BEARINGS FOR THIS PROJECT IS SOUTH 88°09'45" EAST, BEING THE NORTH LINE OF THE SOUTHWEST QUARTER (SW 1/4) OF SECTION 11, TOWNSHIP 19 SOUTH, RANGE 60 EAST, M.D.M., CLARK COUNTY, NEVADA, AS SHOWN ON A RECORD OF SURVEY ON FILE IN THE CLARK COUNTY, NEVADA, RECORDER'S OFFICE, IN FILE 73 AT PAGE 14.

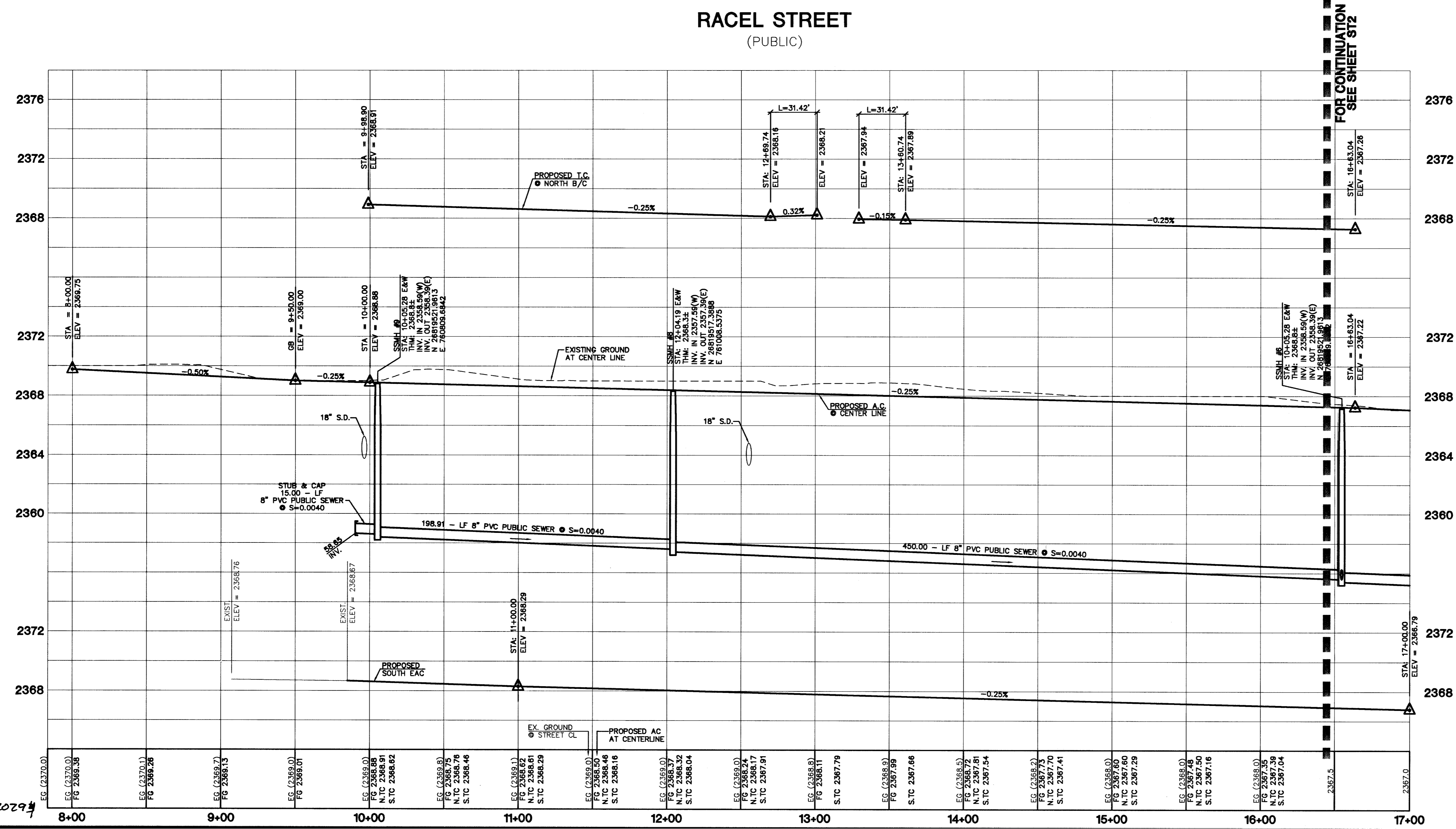

2022

STERLING S. DEVELOPMENT
 CITY OF LAS VEGAS, NEVADA
 2727 SOUTH RAINBOW BOULEVARD LAS VEGAS, NEVADA 89146-5148
 5365 S. CAMERON STE. # 200 PH. (702) 873-7550 FAX (702) 362-2597
 LAS VEGAS, NEVADA 89119
 (702) 871-0556

STERLING S. DEVELOPMENT
 STREET / SEWER PLAN AND PROFILE
 RACEL STREET
 QUARTERHORSE ESTATES
 UNIT 1

PROFESSIONAL ENGINEER
 CHRISTOPHER GAUBER
 CIVIL
 No. 13956 (NVT)

EXPIRES 06-30-05

DRAWN BY: TP 3/1/04
 DESIGNED BY: CEG 3/1/04
 CHECKED BY: CRG 3/1/04
 PROJECT NO: 2224
 SCALE: 1"=40' HORIZ.
 1"=4' VERT.

SHEET
17
 13 OF 17 SHEETS
 DRAWING NO.
 1074621