

**ABANDONED VALVES**

ALL ABANDONED VALVES SHALL BE ABANDONED IN THE CLOSED POSITION UNLESS SHOWN OTHERWISE, BY REMOVING A MINIMUM OF THE TOP 12 INCHES OF THE VALVE BOX AND FILLING THE REMAINING PORTION OF THE VALVE BOX WITH CONCRETE HAVING A COMPRESSIVE STRENGTH AT LEAST 2,000 PSI.

**\*NOTE**

FOR LOCATION & LENGTH OF EXISTING 12" WATER LINE SEE "3205 ZONE NORTH PHASE I & DISCHARGE PIPELINE" CONTRACT NO. 796 BY G.C. WALLACE.

- 8" 90° BEND 1 EA.
- 8" PVC 19.19 L.F.
- REMOVE EXIST. 12" CAP 1 EA.
- 12"X8" REDUCER 1 EA.

- 8" GATE VALVE 2 EA.
- 8"X8" TEE 1 EA.

- 8" PVC 10 L.F.
- CAP END OF 8" WATER LINE 1 EA.
- 2" B.O. VALVE 1 EA.

FUTURE MANHOLE & 8" SEWER (PER CYPRESS POINT-PHASE I BY CARTER BURGESS ENGINEERING.)

**\* NOTE**

THE PARK LANDSCAPING WILL CONSIST OF GRASS WITH NO TREES OR STRUCTURES WITHIN THE LVWD UTILITY EASEMENT.

THIS PROPERTY MAY HAVE STATIC PRESSURE IN EXCESS OF 80 PSI. THE UNIFORM PLUMBING CODE REQUIRES THAT INDIVIDUAL, ON-SITE (PRIVATE), PRESSURE REDUCING VALVES BE INSTALLED WHENEVER THE PRESSURE EXCEEDS 80 PSI. PRVs ARE THE DEVELOPER'S RESPONSIBILITY AND WILL NOT BE INSPECTED OR INCLUDED IN THE ACCEPTANCE OF LVWD FACILITIES.

ALL UNDERGROUND IMPROVEMENTS BEING INSTALLED WITH CYPRESS POINT MUST BE CONSTRUCTED PRIOR TO OAK HILLS SURFACE IMPROVEMENTS.

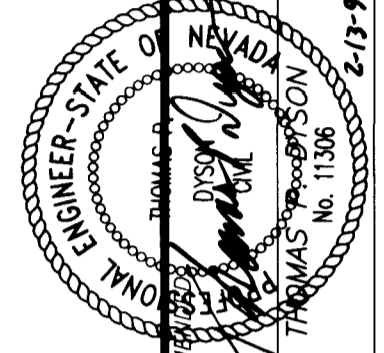
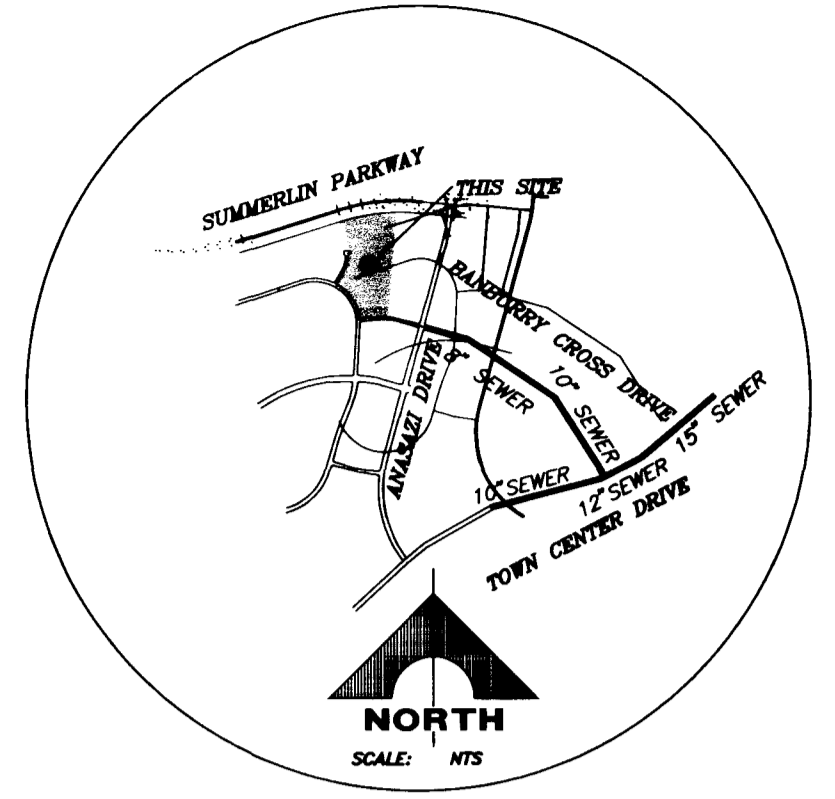
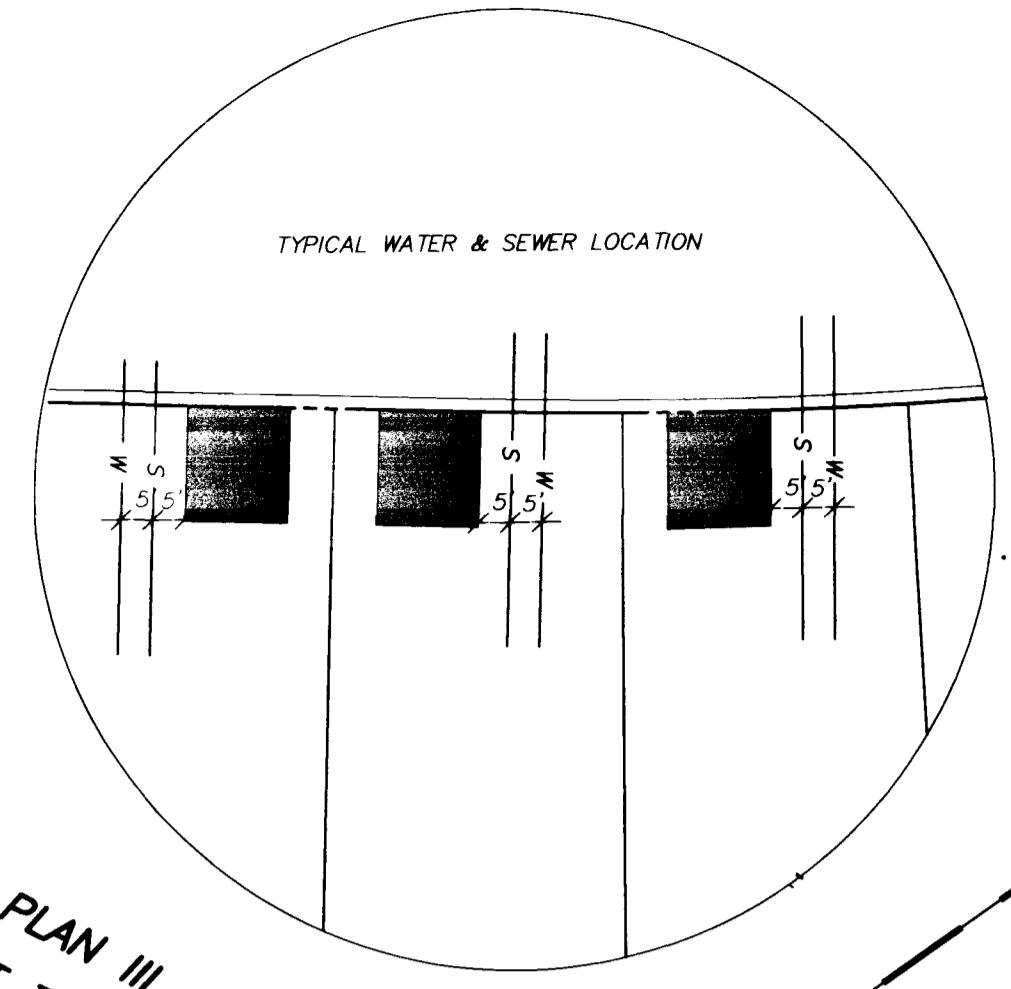
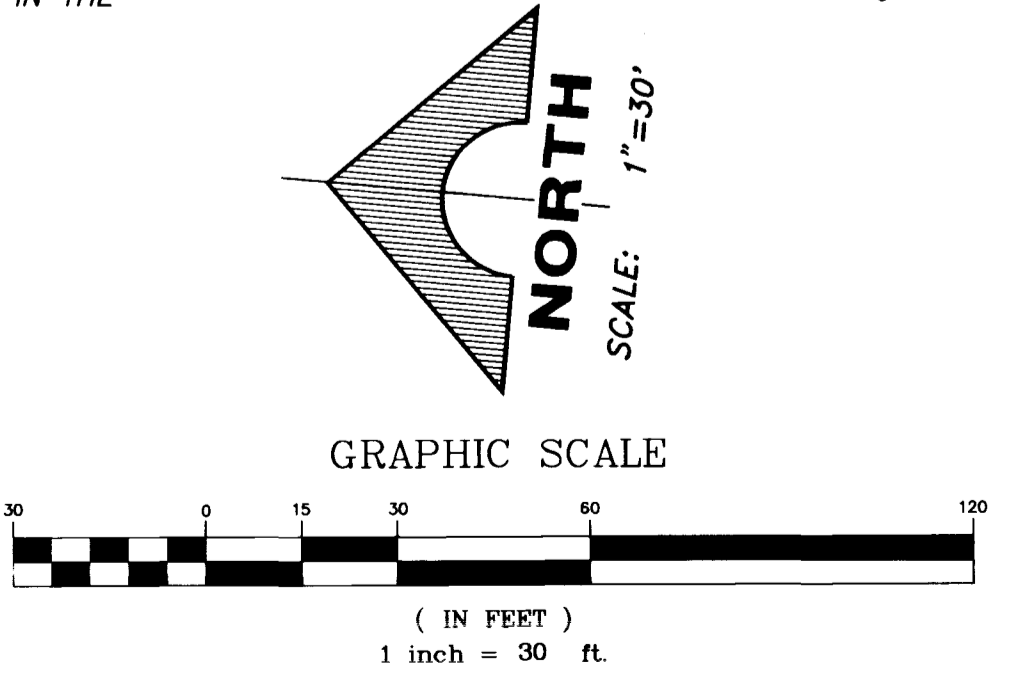
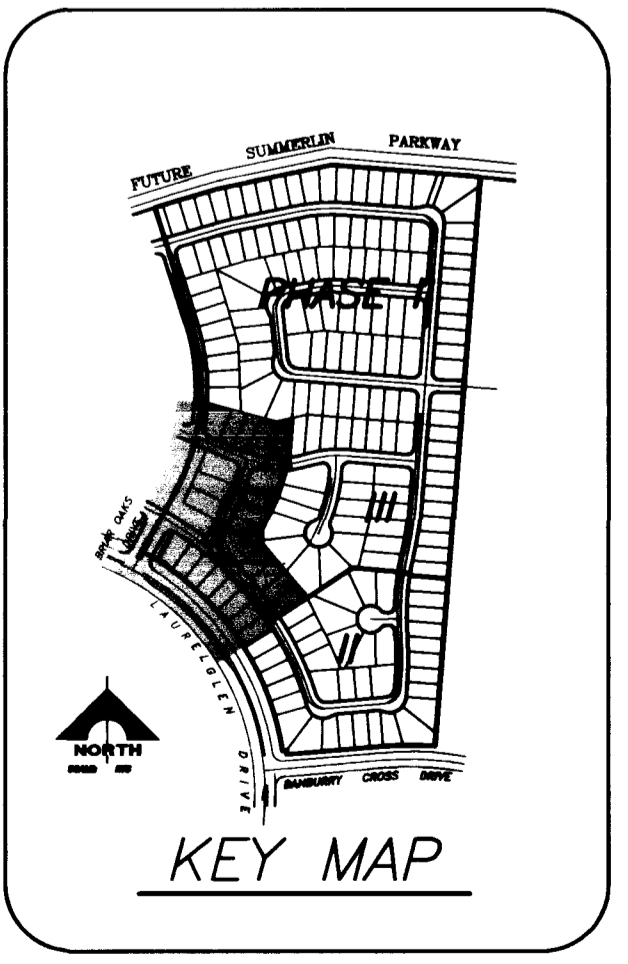

REV.	DATE	DESCRIPTION	CLY.	DATE

RECOMMENDED BY: **G.C. WALLACE, INC.**  
 Engineering/Architecture  
 1555 SOUTH RAINBOW BLVD./LAS VEGAS, NEVADA 89102

**COLEMAN HOMES**  
**OAK HILLS AT SUMMERLIN**  
**UTILITY PLAN I - PHASE I**

SHEET  
**5**  
 OF 24 SHEETS

NOTE:  
 ALL SEWER MAINS SHOWN ON THIS SHEET ARE PUBLIC SEWER MAINS.

APPROVED FOR CONSTRUCTION  
  
 LAS VEGAS VALLEY WATER DISTRICT DATE 2-28-97

APPROVED FOR CONSTRUCTION  
  
 CITY OF LAS VEGAS FIRE DEPARTMENT DATE 2-13-97

