

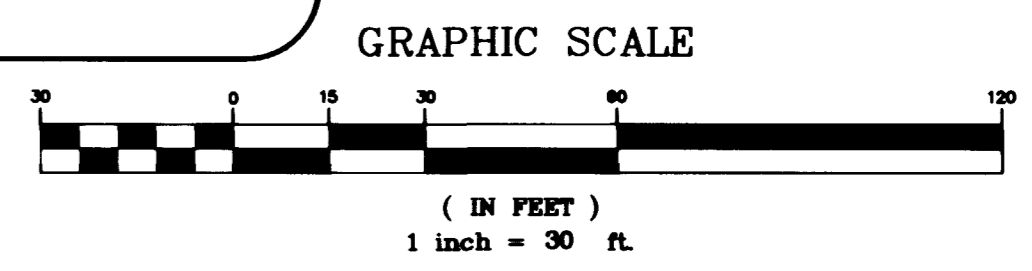

Call before you Dig  
1-800-227-2600  
UNDERGROUND SERVICE (US)

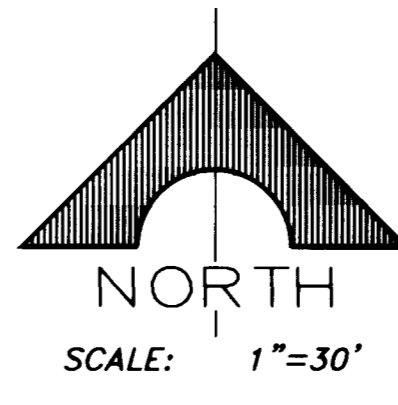

**BENCHMARK**

ID. #	DESC.	NGVD 29	NAVD 88	SUMMERLIN DATUM
01.000 1954	RIVET & PLATE IN TOP OF CURB NW SIDE OF TOWN CENTER DRIVE & SOUTH CIRCLE ISLAND.	2725.923	2728.37 (831.6074 M)	2726.19

SUMMERLIN DATUM USED FOR THIS PROJECT

**BASIS OF BEARING**

NORTH 15°23'46" EAST, BEING THE BEARING OF THE CENTERLINE OF ANASAZI DRIVE AS SHOWN BY MAP THEREOF ON FILE IN BOOK 63, PAGE 92 OF PLATS IN THE CLARK COUNTY NEVADA RECORDERS OFFICE.

**CONSTRUCTION NOTES**

- CONSTRUCTION SURVEY:  
GRADES ARE GIVEN FROM TOP OF STAKES OR NAILS. THE CONTRACTORS ARE CAUTIONED TO OBSERVE THE FOLLOWING RULES IN USING THE GRADE STAKES GIVEN BY THIS OFFICE - THREE (3) CONSECUTIVE POINTS THAT ARE SHOWN TO BE ON THE SAME RATE OF SLOPE MUST BE USED IN COMMON IN ORDER THAT ANY VARIATION OUT OF A PERFECT STRAIGHT GRADE MAY BE DETECTED IN CASE ANY SUCH DISCREPANCY IS FOUND, THE SAME MUST BE REPORTED. OTHERWISE THIS OFFICE WILL NOT BE RESPONSIBLE FOR ANY ANY ERROR IN THE GRADE OF THE FINISHED WORK.
- THESE PLANS SHALL BE ON THE JOBSITE AT ALL TIMES.

**LEGEND**

(1)	LOT NUMBER	—	GRADE BREAK
(1)	BLOCK NUMBER	54.10	SPOT ELEVATION
PAD = 14.5 F.F. = 14.5	PAD ELEVATION FINISH FLOOR ELEVATION	59.33	FUTURE ELEVATION
XX.XX	EXISTING PAD ELEVATION	56.22 TC OR FG	FINISHED GRADE ELEVATION
2:1	SCARP	(56.22)	PROPOSED ELEVATION
—	DITCH OR SWALE	—	EXISTING ELEVATION
45.10	EXISTING CONTOUR (5' INTERVAL)	—	RETAINING WALL
—	EXISTING CONTOUR (1' INTERVAL)	—	KNEE WALL
—	MATCHLINE	—	ROW LINE
		—	PROPERTY LINE
		—	SIDEWALK

**WALL NOTES**

- APPROVAL OF THESE PLANS BY THE CITY ENGINEER DOES NOT PERTAIN TO CONSTRUCTION OF NEW WALLS (RETAINING OR NON-RETAINING) OR MODIFICATIONS TO EXISTING WALLS.
- ALL WALLS, NEW OR EXISTING, ARE REVIEWED BY THE CITY ENGINEER FOR GRADING RELATIONSHIPS ONLY.
- ALL WALLS, RETAINING AND NON-RETAINING, MUST BE APPROVED AND A PERMIT OBTAINED FROM THE DEPARTMENT OF BUILDING AND SAFETY.
- FOR SIGHT DISTANCE REQUIREMENTS AT INTERSECTIONS SEE SUMMERLIN STD. DWG. NO. DC-3.

**NOTES**

- FINISH FLOOR ELEVATIONS SHOWN ARE A MINIMUM ELEVATION.
- DIMENSIONS SHOWN ON THIS PLAN ARE FOR INFORMATION ONLY AND SHALL NOT BE USED AS A SALES TOOL BY SALES PERSONNEL OR PROSPECTIVE PURCHASERS.
- REFER TO FINAL RECORDED MAP FOR ALL LOT DIMENSIONS.

**FLOOD CERTIFICATION**

I CERTIFY THAT THIS GRADING PLAN IS IN CONFORMANCE WITH THE APPROVED FLOOD STUDY ON FILE AT THE CITY OF LAS VEGAS FOR THIS PROJECT.

THOMAS P. DYSON  
CIVIL ENGINEER  
STATE OF NEVADA  
No. 11306

SIGNATURE: *Thomas P. Dyson* DATE: 2-24-99

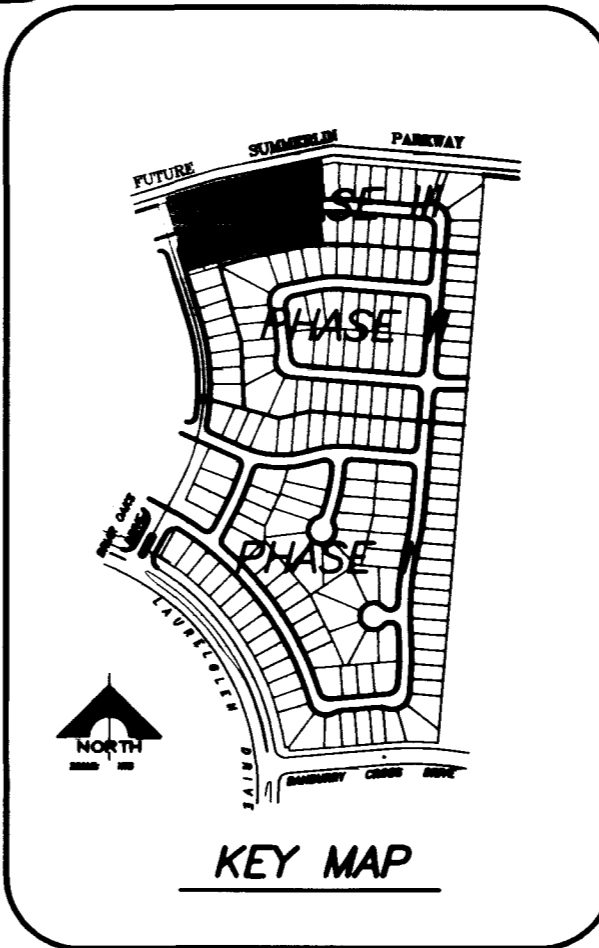

REVISION

REV	DATE	BY

COLEMAN HOMES

G.C. WALLACE, INC.  
Engineering/Architecture  
1555 SOUTH RAINBOW BLVD./LAS VEGAS, NEVADA 89102  
(702) 363-1200

GRADING PLAN II

OAK HILLS AT SUMMERLIN - PHASE III

SHEET TITLE

DRAWN BY: GCV  
DESIGNED BY: GCV  
CHECKED BY:

PROJECT NO.: 743-162

SCALE: 1" = 30' HOR. VERT. N/A

SEAL

THOMAS P. DYSON  
CIVIL ENGINEER  
STATE OF NEVADA  
No. 11306

1-13-99

SHEET G-2  
7 OF 13 SHEETS

DRAWING NO. 107Y-4506-3

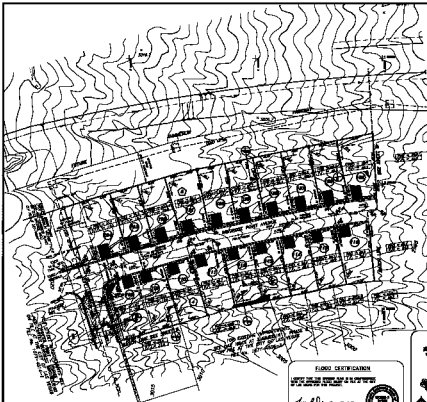

REVISIONS  
Call before Dig  
1-800-327-5847

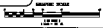

**REVISIONS**

No.	Date	By	For

REVISIONS TO BE MADE BY THE OWNER

**BASE OF BERMING**

BASE OF BERMING: THE AREA OF BERMING IS THE EXTENSION OF THE BERMING AS SHOWN ON THIS PLAN OR ANY OTHER PLAN OF THIS PROJECT. THE BERMING SHALL BE MAINTAINED AS SHOWN ON THIS PLAN OR ANY OTHER PLAN OF THIS PROJECT. THE BERMING SHALL BE MAINTAINED AS SHOWN ON THIS PLAN OR ANY OTHER PLAN OF THIS PROJECT.

**CONSTRUCTION NOTES**

1. EXISTING UTILITIES
2. EXISTING UTILITIES
3. EXISTING UTILITIES
4. EXISTING UTILITIES
5. EXISTING UTILITIES
6. EXISTING UTILITIES
7. EXISTING UTILITIES
8. EXISTING UTILITIES
9. EXISTING UTILITIES
10. EXISTING UTILITIES
11. EXISTING UTILITIES
12. EXISTING UTILITIES
13. EXISTING UTILITIES
14. EXISTING UTILITIES
15. EXISTING UTILITIES
16. EXISTING UTILITIES
17. EXISTING UTILITIES
18. EXISTING UTILITIES
19. EXISTING UTILITIES
20. EXISTING UTILITIES

**LEGEND**

(1)	EXISTING UTILITIES	---	EXISTING UTILITIES
(2)	EXISTING UTILITIES	---	EXISTING UTILITIES
(3)	EXISTING UTILITIES	---	EXISTING UTILITIES
(4)	EXISTING UTILITIES	---	EXISTING UTILITIES
(5)	EXISTING UTILITIES	---	EXISTING UTILITIES
(6)	EXISTING UTILITIES	---	EXISTING UTILITIES
(7)	EXISTING UTILITIES	---	EXISTING UTILITIES
(8)	EXISTING UTILITIES	---	EXISTING UTILITIES
(9)	EXISTING UTILITIES	---	EXISTING UTILITIES
(10)	EXISTING UTILITIES	---	EXISTING UTILITIES
(11)	EXISTING UTILITIES	---	EXISTING UTILITIES
(12)	EXISTING UTILITIES	---	EXISTING UTILITIES
(13)	EXISTING UTILITIES	---	EXISTING UTILITIES
(14)	EXISTING UTILITIES	---	EXISTING UTILITIES
(15)	EXISTING UTILITIES	---	EXISTING UTILITIES
(16)	EXISTING UTILITIES	---	EXISTING UTILITIES
(17)	EXISTING UTILITIES	---	EXISTING UTILITIES
(18)	EXISTING UTILITIES	---	EXISTING UTILITIES
(19)	EXISTING UTILITIES	---	EXISTING UTILITIES
(20)	EXISTING UTILITIES	---	EXISTING UTILITIES

**WELL NOTES**

1. EXISTING UTILITIES
2. EXISTING UTILITIES
3. EXISTING UTILITIES
4. EXISTING UTILITIES
5. EXISTING UTILITIES
6. EXISTING UTILITIES
7. EXISTING UTILITIES
8. EXISTING UTILITIES
9. EXISTING UTILITIES
10. EXISTING UTILITIES
11. EXISTING UTILITIES
12. EXISTING UTILITIES
13. EXISTING UTILITIES
14. EXISTING UTILITIES
15. EXISTING UTILITIES
16. EXISTING UTILITIES
17. EXISTING UTILITIES
18. EXISTING UTILITIES
19. EXISTING UTILITIES
20. EXISTING UTILITIES

**NOTES**

1. EXISTING UTILITIES
2. EXISTING UTILITIES
3. EXISTING UTILITIES
4. EXISTING UTILITIES
5. EXISTING UTILITIES
6. EXISTING UTILITIES
7. EXISTING UTILITIES
8. EXISTING UTILITIES
9. EXISTING UTILITIES
10. EXISTING UTILITIES
11. EXISTING UTILITIES
12. EXISTING UTILITIES
13. EXISTING UTILITIES
14. EXISTING UTILITIES
15. EXISTING UTILITIES
16. EXISTING UTILITIES
17. EXISTING UTILITIES
18. EXISTING UTILITIES
19. EXISTING UTILITIES
20. EXISTING UTILITIES

**FLOOD CERTIFICATION**

THIS PLAN IS IN FULL COMPLIANCE WITH THE FLOOD CERTIFICATION ACT OF 1954 AND THE FLOOD CERTIFICATION ACT OF 1954.

*John L. Day* Engineer



COLLEEN HICKMAN  
 GARY L. WALLACE, INC.  
 1000 W. 10th St., Suite 100  
 Grand Rapids, MI 49503  
 (616) 941-1111  
 FAX (616) 941-1112  
 WWW.GARYLWALLACE.COM

