

NAPA HILLS BY LEWIS HOMES UNIT NO. 1
PER CLV DWG# 107Y-4560-2

NAPA HILLS BY LEWIS HOMES UNIT NO. 2
PER CLV DWG# 107Y-4560-2

BENCHMARKS
 G.C. WALLACE PROJECT BENCHMARK NO. 107, A 2" BRASS DISK IN CONCRETE, LYING SOUTH 44°00'38" EAST, 641.6' FROM THE INTERSECTION OF HUALAPAI WAY AND TOWN CENTER DRIVE. ELEVATION = 2877.96
 CITY OF LAS VEGAS BENCHMARK OL0001954 RIVET & PLATE IN TOP OF CURB NW SIDE OF TOWN CENTER DR. AND SOUTH CIRCLE ISLAND.
 2725.923 NGVD 1929 DATUM
 2728.37 NAVD 1988 DATUM (831.6074 M)
 2726.19 SUMMERLIN DATUM * PROJ. DATUM

BASIS OF BEARINGS
 SOUTH 11°16'20" EAST, BEING THE BEARING OF THE CENTERLINE OF PAVILION CENTER DRIVE AS SHOWN BY "THE ARBORS AT SUMMERLIN VILLAGE 11/12 UNIT 2A" ON FILE IN BOOK 75, PAGE 75 OF PLATS IN THE CLARK COUNTY RECORDER'S OFFICE CLARK COUNTY, NEVADA.

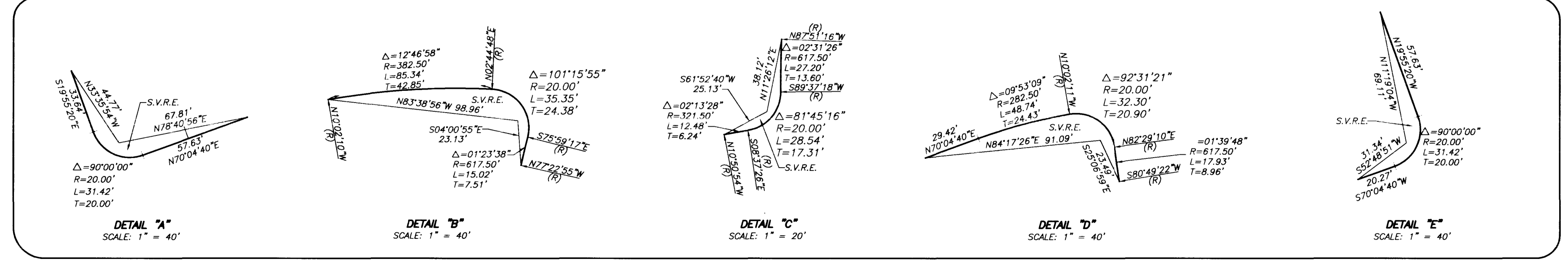

Call before you Dig.
 1-800-227-2600
 UNDERGROUND SERVICE (USA)

I certify that this grading plan conforms to the approved drainage study for this site on file at the City of Las Vegas
 Milo L. Terzich (DATE) 7/2/98
 MILO L. TERZICH, P.E. Lic. No. 12846

REV.	DATE	DESCRIPTION

RECOMMENDED: MILO L. TERZICH, P.E. Lic. No. 12846, 7/2/98

G.C. WALLACE, INC.
 Engineering/Architecture
 1555 SOUTH RANNEY BLVD., LAS VEGAS, NEVADA 89102

NAPA HILLS BY LEWIS HOMES UNIT 3 GRADING PLAN II SHEET 11 OF 12 SHEETS

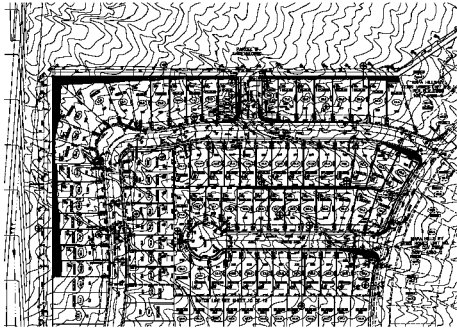

REMARKS:
 1. ALL POINTS SHOWN ON THIS MAP ARE
 2. CONTROL POINTS FOR THE CONTROL
 3. POINTS ARE ON THE GRID AND
 4. ARE NOT TO BE USED FOR
 5. ANY OTHER PURPOSES.
 6. THE POINTS ARE TO BE USED FOR
 7. THE CONTROL POINTS ARE TO BE USED FOR
 8. THE CONTROL POINTS ARE TO BE USED FOR
 9. THE CONTROL POINTS ARE TO BE USED FOR
 10. THE CONTROL POINTS ARE TO BE USED FOR



NOTES:
 1. THIS MAP IS A REPRODUCTION OF THE ORIGINAL
 2. MAP AND IS NOT TO BE USED FOR ANY OTHER
 3. PURPOSES.
 4. THE POINTS ARE TO BE USED FOR
 5. THE CONTROL POINTS ARE TO BE USED FOR
 6. THE CONTROL POINTS ARE TO BE USED FOR
 7. THE CONTROL POINTS ARE TO BE USED FOR
 8. THE CONTROL POINTS ARE TO BE USED FOR
 9. THE CONTROL POINTS ARE TO BE USED FOR
 10. THE CONTROL POINTS ARE TO BE USED FOR

1. THIS MAP IS A REPRODUCTION OF THE ORIGINAL
 2. MAP AND IS NOT TO BE USED FOR ANY OTHER
 3. PURPOSES.
 4. THE POINTS ARE TO BE USED FOR
 5. THE CONTROL POINTS ARE TO BE USED FOR
 6. THE CONTROL POINTS ARE TO BE USED FOR
 7. THE CONTROL POINTS ARE TO BE USED FOR
 8. THE CONTROL POINTS ARE TO BE USED FOR
 9. THE CONTROL POINTS ARE TO BE USED FOR
 10. THE CONTROL POINTS ARE TO BE USED FOR

1. THIS MAP IS A REPRODUCTION OF THE ORIGINAL
 2. MAP AND IS NOT TO BE USED FOR ANY OTHER
 3. PURPOSES.
 4. THE POINTS ARE TO BE USED FOR
 5. THE CONTROL POINTS ARE TO BE USED FOR
 6. THE CONTROL POINTS ARE TO BE USED FOR
 7. THE CONTROL POINTS ARE TO BE USED FOR
 8. THE CONTROL POINTS ARE TO BE USED FOR
 9. THE CONTROL POINTS ARE TO BE USED FOR
 10. THE CONTROL POINTS ARE TO BE USED FOR

U.S. WALLACE, INC.
 1000 WALLACE DRIVE
 WASHINGTON, D.C. 20004

MAPS, PLANS, AND DRAWINGS
 1000 WALLACE DRIVE
 WASHINGTON, D.C. 20004

1000 WALLACE DRIVE
 WASHINGTON, D.C. 20004