

**Sonoma Creek Curve Table**

No.	Radius	Delta	Length	Tangent
(C1)	278.50'	07°26'58"	36.21'	18.13'
(C2)	321.50'	05°43'08"	32.09'	16.08'
(C3)	321.50'	05°34'46"	31.31'	15.67'
(C4)	278.50'	02°26'11"	11.84'	5.92'
(C5)	15.50'	06°37'44"	1.79'	0.90'
(C6)	15.50'	42°49'47"	11.59'	6.08'
(C7)	44.50'	37°56'34"	29.47'	15.30'
(C8)	19.50'	34°50'05"	11.86'	6.12'
(C9)	19.50'	14°37'25"	4.98'	2.50'
(C10)	40.50'	50°09'57"	35.46'	18.98'
(C11)	40.50'	52°46'53"	37.31'	20.10'
(C12)	40.50'	39°05'14"	27.63'	14.38'
(C13)	44.50'	37°48'04"	29.36'	15.24'
(C14)	44.50'	61°08'19"	47.48'	26.29'

**Sonoma Creek Bearing Table**

No.	Bearing	Distance
LI	N 70°04'40" E	2.90'

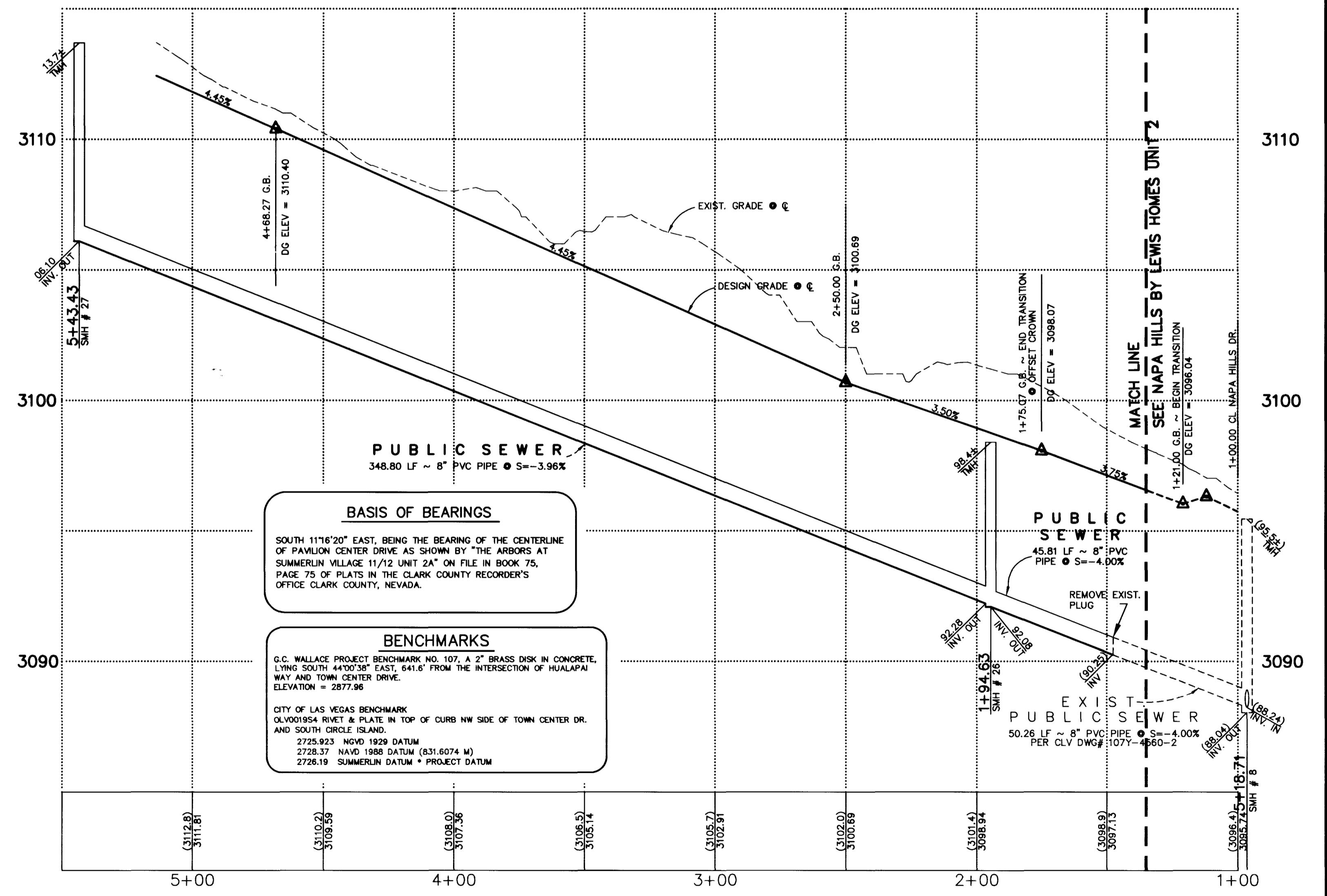

**BASIS OF BEARINGS**

SOUTH 11°16'20" EAST, BEING THE BEARING OF THE CENTERLINE OF PAVILION CENTER DRIVE AS SHOWN BY THE ARBORS AT SUMMERLIN VILLAGE 11/12 UNIT 2A ON FILE IN BOOK 75, PAGE 75 OF PLATS IN THE CLARK COUNTY RECORDER'S OFFICE CLARK COUNTY, NEVADA.

**BENCHMARKS**

G.C. WALLACE PROJECT BENCHMARK NO. 107, A 2" BRASS DISK IN CONCRETE, LYING SOUTH 44°00'38" EAST, 641.6' FROM THE INTERSECTION OF HUALAPAI WAY AND TOWN CENTER DRIVE. ELEVATION = 2877.96

CITY OF LAS VEGAS BENCHMARK  
040001954 RIVET & PLATE IN TOP OF CURB NW SIDE OF TOWN CENTER DR. AND SOUTH CIRCLE ISLAND.  
2725.923 NOVD 1929 DATUM  
2728.37 NAVD 1988 DATUM (831.6074 M)  
2726.19 SUMMERLIN DATUM + PROJECT DATUM

Call before you Dig.  
1-800-227-2600  
UNDERGROUND SERVICE (USA)

JOB NO. 5543.921

**G. C. WALLACE, INC.**  
Engineering/Architecture  
1555 SOUTH RAINBOW BLVD., LAS VEGAS, NEVADA 89102

**RECOMMENDED**

REV	DATE	DESCRIPTION
1	7/18/98	12846

MILO L. TERZICH  
12846  
P.E. NEV.

UNIT 3  
NAPA HILLS BY LEWIS HOMES  
SONOMA CREEK CT. & NAPA HILLS DR.

SHEET **8**

OF 12 SHEETS

a185

1074-4560-3

