

**BENCHMARKS**  
 G.C. WALLACE PROJECT BENCHMARK NO. 107, A 2" BRASS DISK IN CONCRETE, LYING SOUTH 44°00'38" EAST, 641.6' FROM THE INTERSECTION OF HUALAPAI WAY AND TOWN CENTER DRIVE.  
 ELEVATION = 2877.96  
 CITY OF LAS VEGAS BENCHMARK  
 OL0001954 RIVET & PLATE IN TOP OF CURB NW SIDE OF TOWN CENTER DR. AND SOUTH CIRCLE ISLAND.  
 2725.923 NAD 83 DATUM  
 2728.37 NAVD 1988 DATUM (831.6074 M)  
 2726.19 SUMMERLIN DATUM \* PROJECT DATUM  
 SUMMERLIN DATUM = NAVD - 2.18'

**BASIS OF BEARINGS**  
 SOUTH 11°16'20" EAST, BEING THE BEARING OF THE CENTERLINE OF PAVILION CENTER DRIVE AS SHOWN BY "THE ARBORS AT SUMMERLIN VILLAGE 11/12 UNIT 2A" ON FILE IN BOOK 75, PAGE 75 OF PLATS IN THE CLARK COUNTY RECORDER'S OFFICE CLARK COUNTY, NEVADA.

I certify that this grading plan conforms to the approved drainage study for this site on file at the City of Las Vegas  
 \_\_\_\_\_ (DATE)  
 MILO L. TERZICH, P.E. Lic. No. 12846

AVOID CUTTING UNDERGROUND UTILITY LINES. IT'S COSTLY.  
**Call before you Dig.**  
 1-800-227-2600  
 UNDERGROUND SERVICE (USA)

	RECOMMENDED	DATE	DATE	DATE	DATE
	5/2/98				
<b>G.C. WALLACE, INC.</b> Engineering/Architecture 1535 SOUTH SANDY BLVD., LAS VEGAS, NEVADA 89102 PHONE: (702) 883-1200	REV. NO.	DESCRIPTION	DATE	DATE	DATE
	1	REV. LOT LINES FOR LOTS 128 THROUGH 139 REV. STREET NAMES & S.V.R.E. DESCRIPTION			
<b>NAPA HILLS BY LEWIS HOMES UNIT NO. 2</b> <b>GRADING PLAN 11</b>					
SHEET <b>11</b> OF 14 SHEETS					

JOB NO. 5543.921

8506

107Y-4560-2

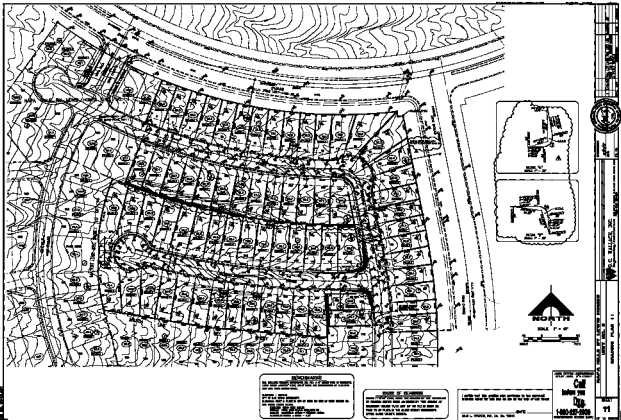

**DISCLAIMER**  
 THIS PLAN IS FOR INFORMATIONAL PURPOSES ONLY AND DOES NOT CONSTITUTE AN OFFER OF INSURANCE. THE PLAN IS NOT TO BE USED AS A BASIS FOR ANY INVESTMENT DECISION. THE PLAN IS NOT TO BE USED AS A BASIS FOR ANY INVESTMENT DECISION. THE PLAN IS NOT TO BE USED AS A BASIS FOR ANY INVESTMENT DECISION.

**STATE OF CALIFORNIA**  
 I, \_\_\_\_\_, COUNTY CLERK OF THE COUNTY OF \_\_\_\_\_, DO HEREBY CERTIFY THAT THIS PLAN IS A TRUE AND CORRECT COPY OF THE ORIGINAL AS FILED IN MY OFFICE ON \_\_\_\_\_, 20\_\_\_\_.

1. THIS PLAN IS FOR INFORMATIONAL PURPOSES ONLY AND DOES NOT CONSTITUTE AN OFFER OF INSURANCE. THE PLAN IS NOT TO BE USED AS A BASIS FOR ANY INVESTMENT DECISION. THE PLAN IS NOT TO BE USED AS A BASIS FOR ANY INVESTMENT DECISION.

**Call before you dig**  
 1-800-485-5149  
 11

C.C. WALLACE, INC.  
 1177-4400-7