

2360

2360

2350

2350

2340

2340

2330

2330

2320

2320

14+00 15+00 16+00 17+00 18+00 19+00 20+00 21+00 22+00 23+00



BCR & CURVE DATA AT BACK OF CURB

No.	RADIUS	DELTA	LENGTH	TANGENT
C1	1796.01	07°03'27"	221.22	110.75
C2	1796.01	07°01'38"	215.37	107.82
C3	1796.01	02°30'34"	78.66	39.34
C4	1796.01	02°26'50"	75.01	37.51
C5	1776.01	09°34'39"	298.88	148.79
C6	1756.01	02°16'58"	69.96	34.99
C7	1796.01	02°08'07"	66.94	33.47
C8	20.00	91°38'49"	31.98	20.57
C9	20.00	88°45'27"	31.33	19.92
C10	20.00	88°44'16"	30.98	19.56
C11	20.00	90°00'00"	31.42	20.00
C12	30.00	90°00'00"	47.12	30.00
C13	70.00	90°00'00"	109.96	70.00
C14	50.00	90°00'00"	78.54	50.00

QUANTITY ESTIMATES THIS SHEET

2" ASPHALTIC CONCRETE PAVEMENT	1,739 S.F.
30" ROLL-TYPE CURB & GUTTER	948 L.F.
SIDEWALK	3,787 S.F.
8" SEWER	322 L.F.

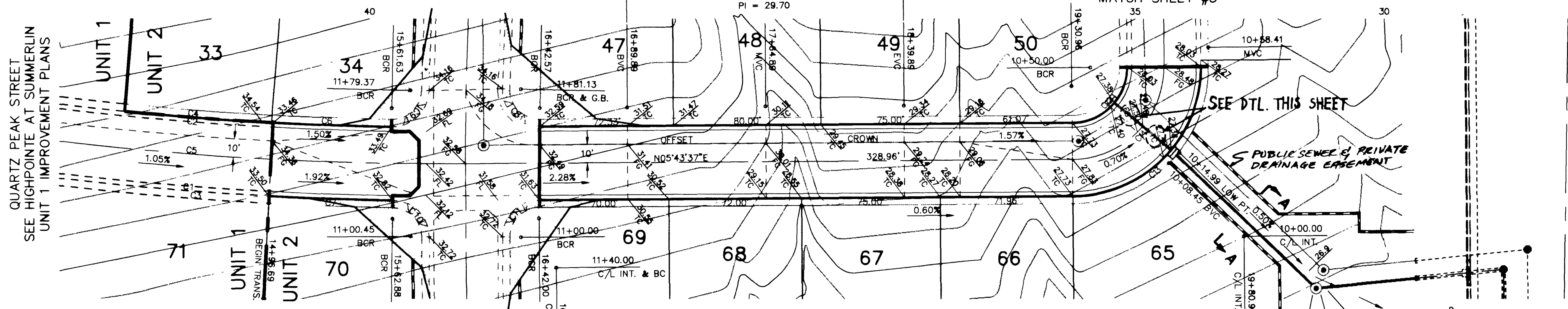

QUARTZ PEAK STREET (OFFSET CROWN SEE SUMMERLIN STD. DETAIL S-15)

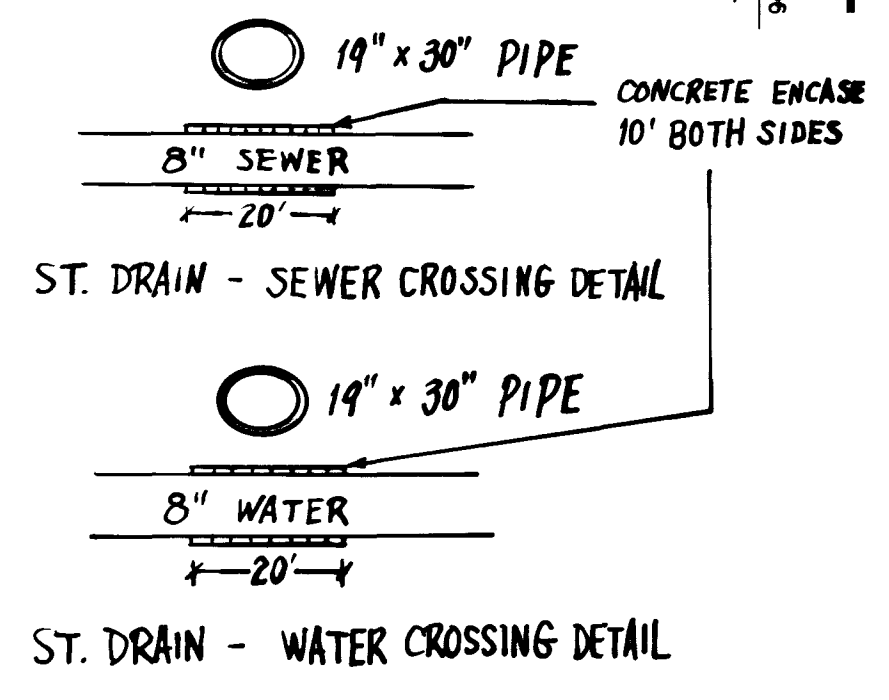

NOTICE
EXISTING UTILITIES ARE SHOWN ON PLANS FOR THE CONVEYANCE OF THE CONTRACTOR'S RESPONSIBILITY FOR THE PROTECTION OF ALL UTILITIES. THE ENGINEER BEARS NO RESPONSIBILITY FOR UTILITIES NOT SHOWN OR SHOWN INCORRECTLY.

Call Digs BEFORE YOU Dig
1-800-227-2800
UNLICENSED SERVICE (USA)

DATE: 12/14/94
BY: [Signature]
APPROVED: [Signature]
REVISION: X

STATE OF NEVADA
REGISTERED PROFESSIONAL ENGINEER
EDWARD J. TANEY, P.E.
NO. 10000
EXPIRES 12/31/98

ALPHA & ENGINEERING COMPANY
1000 W. WASHINGTON ST., SUITE 200
LAS VEGAS, NV 89102

PROJECT: STREET & SEWER PLAN & PROFILE
QUARTZ PEAK STREET
HIGHPOINT AT SUMMERLIN UNIT 2

JOB # N4-76-15
NAME: VERTREES/MRA
DATE: 12-14-94
SCALE: 1" = 40'
PAGE: 3

2058 11-18-98

107Y-4364-2

