

GENERAL NOTES:

1. FIRE PREEMPTION SHALL BE PHASES 2 & 6 OR PHASES 4 & 8.
2. PROTECT EXISTING INTERCONNECT CABLE DURING ALL WORK IN THIS AREA.
3. DETECTOR LOOPS IN OAKLEY BLVD THROUGH LANES SHALL BE 6' x 6', EXTENSION LOOPS SHALL BE 6'x6' PER C.C.A. STD. DWG 404.821
4. ALL LEFT TURN BAY LOOP DETECTORS SHALL BE INSTALLED PER C.C.A. STD. DWG. 404.827
5. REPLACE EXISTING BLOCK NUMBER AND INTERNALLY ILLUMINATED STREET NAME SIGN PANELS WITH NEW WIDE ANGLE PRISMATIC SHEETING PANELS. NEW LEGENDS SHALL BE PER CCA STD DWG 404.417
6. PHASE 4 AND 8 EXTENSION LOOPS SHALL HAVE SEPARATE HOME RUNS TO THE CONTROLLER.
7. INSTALL NEW MICROWAVE COMMUNICATIONS SYSTEM TO COMMUNICATE WITH CONTROLLERS AT BOTH TORREY PINES AND LINDELL
8. RETURN 2 SALVAGED M-2 HEADS TO ELETRIC SHOP AT 3100 E. BONANZA AVE.

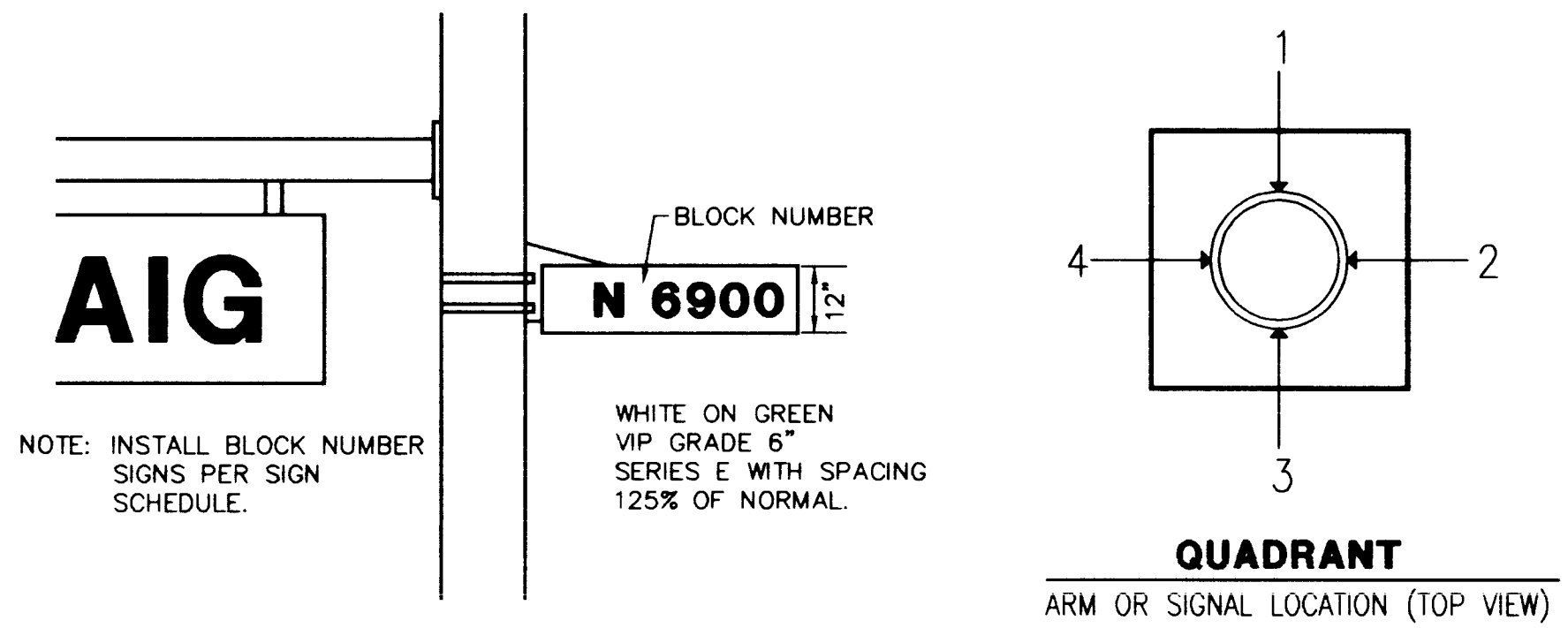
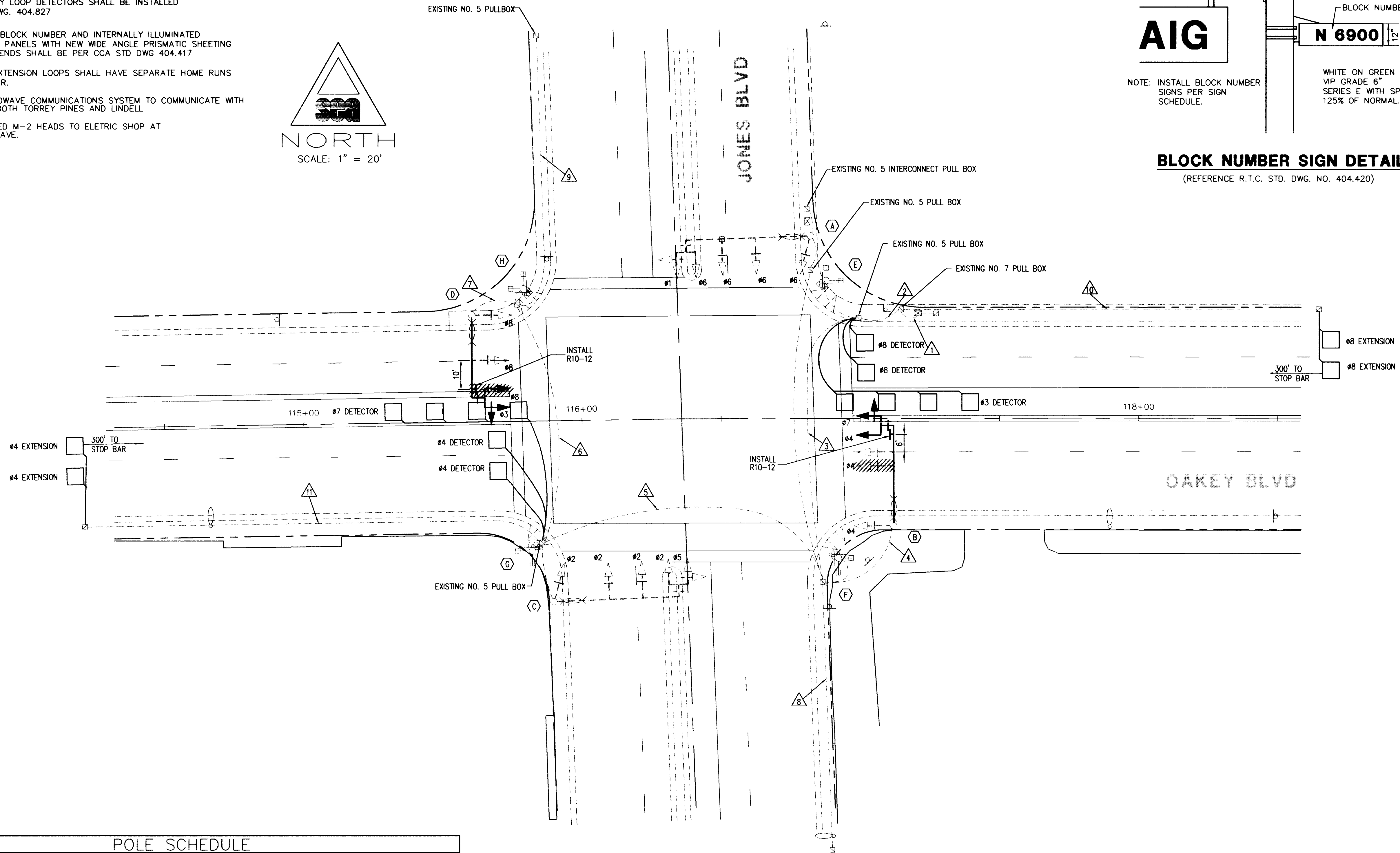
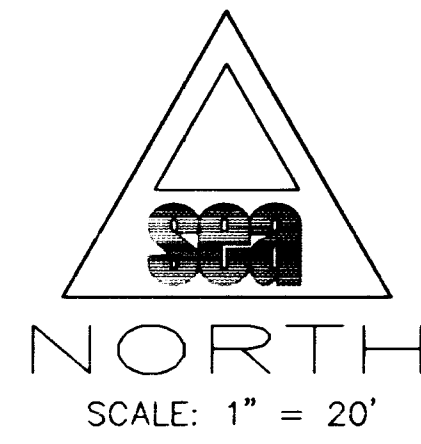

BLOCK NUMBER SIGN DETAIL
(REFERENCE R.T.C. STD. DWG. NO. 404.420)

POLE SCHEDULE										
POLE	POLE			SIGNALS VEHICULAR		SIGNALS PEDESTRIAN		PEDESTRIAN PUSH BUTTON		REMARKS
	LOCATION STATION	TYPE	SIG. QUAD.	ARM LNG.	LUM. QUAD.	ARM LNG.	TYPE	QUADRANT	TYPE	
(A)	EX.	XX								
(B)	EX.	XX	1	35"	(1)M-2	MAST ARM				REUSE EXISTING (1) M-2 SIGNAL HEAD
(C)	EX.	XX								
(D)	EX.	XX	3	25"	(1)M-2	MAST ARM				REUSE EXISTING (1) M-2 SIGNAL HEAD
(E)	EX.	A-1								
(F)	EX.	A-1								
(G)	EX.	A-1								
(H)	EX.	A-1								

* REPLACE EXISTING 30' MAST ARMS

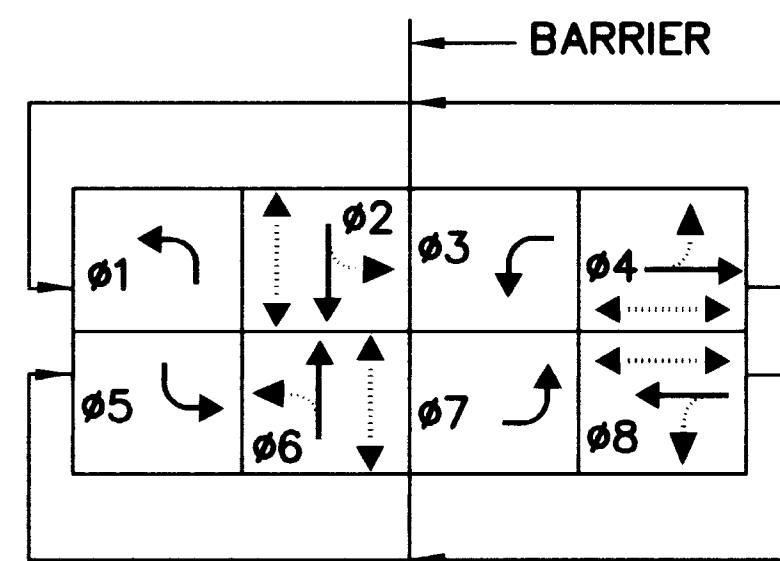

PHASING DIAGRAM
FLASHING OPERATION : ALL RED

TO BE PROVIDED AND INSTALLED BY OTHERS

SIGN SCHEDULE		
POLE	INTERNALLY ILLUMINATED STREET NAME SIGN (1) (DOUBLE FACED)	BLOCK NUMBER SIGN
(A)	OAKLEY	W 6000
(C)	JONES	S 1800
(E)	OAKLEY	W 6100
(G)	JONES	S 1700

- (1) PER DRAWINGS 404.416 & 404.417.
- (2) FRONTSIDE - SEEN BY ONCOMING TRAFFIC
- (3) BACKSIDE - OPPOSITE TO ONCOMING TRAFFIC.

CONDUIT AND CABLE SCHEDULE																				
WIRE & CABLE	FROM	TO	VIA CONDUIT																	
			1	2	3	4	5	6	7	8	9	10								
14 AWG 25 COND.	POLE D	CONTROLLER	X	X	X	X	X	X	X	X	X									
14 AWG 25 COND.	POLE B	CONTROLLER	X	X	X	X	X	X	X	X	X									
12 AWG 2 COND. TWISTED	#4 CALL LOOPS	CONTROLLER	X	X	X	X	X	X	X	X	X									
12 AWG 2 COND. TWISTED	#8 CALL LOOPS	CONTROLLER	X	X	X	X	X	X	X	X	X									
2-12 AWG 2 COND. TWISTED	#8 EXT. LOOP	CONTROLLER	X	X	X	X	X	X	X	X	X									
2-12 AWG 2 COND. TWISTED	#4 EXT. LOOP	CONTROLLER	X	X	X	X	X	X	X	X	X									
12 AWG 2 COND. TWISTED	#7 LT CALL LOOP	CONTROLLER	X	X	X	X	X	X	X	X	X									
12 AWG 2 COND. TWISTED	#3 LT CALL LOOP	CONTROLLER	X	X	X	X	X	X	X	X	X									
NUMBER OF CONDUITS			4	1	2	1	1	1	1	1	1	1	1	1	1	1	1	1	1	1
CONDUIT DIAMETER (INCHES)			(2)	(2)	(2)	(2)	(3)	(3)	(2)	(1)	(1)									

* FROM PLANS BY OTHERS

CLV DWG NO. 107-V2247

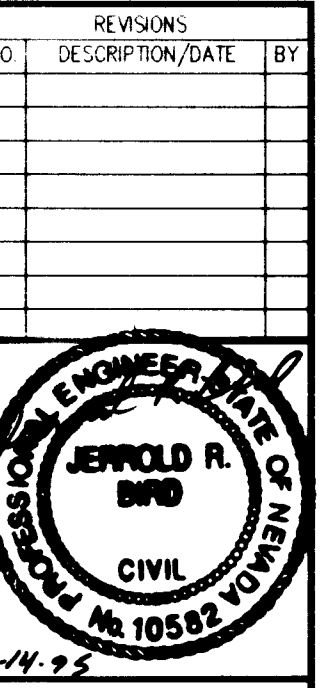

1100 GRIER DRIVE
LAS VEGAS, NEVADA 89119
PHONE (702) 361-9050
FAX (702) 361-0659

incorporated
303
CONSULTING ENGINEERS

TRAFFIC SIGNAL PLAN
JONES BLVD AND OAKLEY BLVD
OAKLEY BOULEVARD
RAINBOW BLVD. TO DECATUR BLVD.

JOB NO. 2-241-073
ACAD FILE: OAKTS03
DESIGNED: J.B.
DRAWN: T.H.
CHECKED: D.P.
DATE: JUNE 1995

TS3

- 1. ALL TRAFFIC SIGNALS TO BE PLACED IN A 20' BY 20' SQUARE IN A 20' BY 20' SQUARE.
- 2. PAVED DRIVE APPROXIMATELY 20' WIDE ALL OVER IN THE AREA.
- 3. EXISTING DRIVE TO BE MAINTAINED AS IS.
- 4. ALL UTILITIES TO BE MAINTAINED AS IS.
- 5. ALL UTILITIES TO BE MAINTAINED AS IS.
- 6. ALL UTILITIES TO BE MAINTAINED AS IS.
- 7. ALL UTILITIES TO BE MAINTAINED AS IS.
- 8. ALL UTILITIES TO BE MAINTAINED AS IS.
- 9. ALL UTILITIES TO BE MAINTAINED AS IS.
- 10. ALL UTILITIES TO BE MAINTAINED AS IS.

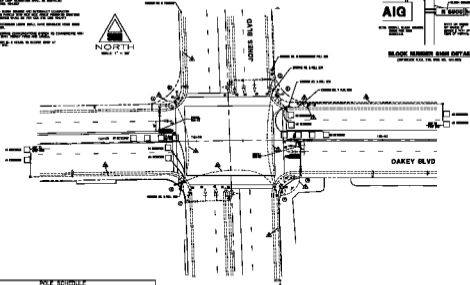
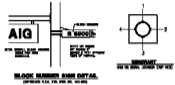

BLOCK SIGNING											
NO.	TYPE	TEXT	SIZE	MOUNTING	MATERIAL	COLOR	SPACING	INSTALLATION	REVISIONS	REMARKS	
										DATE	BY
1	AW	AW	12"	AW	AW	AW	AW	AW		AW	AW
2	AW	AW	12"	AW	AW	AW	AW	AW		AW	AW
3	AW	AW	12"	AW	AW	AW	AW	AW		AW	AW
4	AW	AW	12"	AW	AW	AW	AW	AW		AW	AW
5	AW	AW	12"	AW	AW	AW	AW	AW		AW	AW
6	AW	AW	12"	AW	AW	AW	AW	AW		AW	AW
7	AW	AW	12"	AW	AW	AW	AW	AW		AW	AW
8	AW	AW	12"	AW	AW	AW	AW	AW		AW	AW
9	AW	AW	12"	AW	AW	AW	AW	AW		AW	AW
10	AW	AW	12"	AW	AW	AW	AW	AW		AW	AW



TRAFFIC SIGNAL CABINET
BLOCK NUMBER 8388 DETAIL

- 1. ALL TRAFFIC SIGNALS TO BE PLACED IN A 20' BY 20' SQUARE IN A 20' BY 20' SQUARE.
- 2. PAVED DRIVE APPROXIMATELY 20' WIDE ALL OVER IN THE AREA.
- 3. EXISTING DRIVE TO BE MAINTAINED AS IS.
- 4. ALL UTILITIES TO BE MAINTAINED AS IS.
- 5. ALL UTILITIES TO BE MAINTAINED AS IS.
- 6. ALL UTILITIES TO BE MAINTAINED AS IS.
- 7. ALL UTILITIES TO BE MAINTAINED AS IS.
- 8. ALL UTILITIES TO BE MAINTAINED AS IS.
- 9. ALL UTILITIES TO BE MAINTAINED AS IS.
- 10. ALL UTILITIES TO BE MAINTAINED AS IS.

TRAFFIC SIGNAL CABINET											
NO.	TYPE	TEXT	SIZE	MOUNTING	MATERIAL	COLOR	SPACING	INSTALLATION	REVISIONS	REMARKS	
										DATE	BY
1	AW	AW	12"	AW	AW	AW	AW	AW		AW	AW
2	AW	AW	12"	AW	AW	AW	AW	AW		AW	AW
3	AW	AW	12"	AW	AW	AW	AW	AW		AW	AW
4	AW	AW	12"	AW	AW	AW	AW	AW		AW	AW
5	AW	AW	12"	AW	AW	AW	AW	AW		AW	AW
6	AW	AW	12"	AW	AW	AW	AW	AW		AW	AW
7	AW	AW	12"	AW	AW	AW	AW	AW		AW	AW
8	AW	AW	12"	AW	AW	AW	AW	AW		AW	AW
9	AW	AW	12"	AW	AW	AW	AW	AW		AW	AW
10	AW	AW	12"	AW	AW	AW	AW	AW		AW	AW

CLV DWG NO. 107-V2247



TRAFFIC SIGNAL PLAN
JONES BLVD AND OAKLEY BLVD
BLOCK NUMBER 8388 DETAIL

1978

T83

AS BUILT

11-2-81