

INSTALLATION OF DOUBLE CHECK DETECTOR ASSEMBLY (1) 4"
 THE DOUBLE CHECK DETECTOR ASSEMBLY SHALL BE INSTALLED IN ACCORDANCE WITH THE UDACS PLATE 20B.
 ANY BLOCK WALL OR OTHER FENCE MATERIAL SHALL BE DESIGNED AND CONSTRUCTED AROUND THE OUTSIDE OF THE EASEMENT(S) SO AS TO ALLOW THE DISTRICT DIRECT ACCESS FROM THE ADJACENT RIGHT-OF-WAY.

REDUCED PRESSURE PRINCIPLE ASSEMBLY (1) 1"
 APPROVED REDUCED PRESSURE PRINCIPLE ASSEMBLY(S) SHALL BE INSTALLED PER THE UDACS PLATE NO. 11A OR 11B. NO WATER SHALL BE TAKEN FROM A SERVICE REQUIRING BACKFLOW PREVENTION UNTIL THE REDUCED PRESSURE PRINCIPLE ASSEMBLY HAS BEEN SUCCESSFULLY TESTED BY THE LVWD.
 ANY BLOCK WALL OR OTHER FENCE MATERIAL SHALL BE DESIGNED AND CONSTRUCTED AROUND THE OUTSIDE OF THE EASEMENT(S) TO ALLOW THE DISTRICT DIRECT ACCESS FROM THE ADJACENT RIGHT-OF-WAY.

CLV FIRE NOTES

- ALL WORK SHALL BE DONE IN STRICT ACCORDANCE WITH THE CITY OF LAS VEGAS FIRE DEPARTMENT "HYDRANT SPECIFICATIONS", "HYDRANT INSTALLATION SPECIFICATIONS", AND ORDINANCE NO. 3944.
- AUTHORIZED HYDRANTS FOR THIS PROJECT ARE:
 - KENNEDY GUARDIAN
 - MUELLER A-423 CENTURIAN
 - CLOW MODEL 2546 MEDALLION
- ON ANY NEW HOME OR BUILDING INSTALLATION, ACCESSIBLE FIRE HYDRANTS SHALL BE INSTALLED BEFORE COMBUSTIBLE CONSTRUCTION COMMENCES AND SAID FIRE HYDRANTS SHALL BE IN GOOD WORKING ORDER WITH AN ADEQUATE WATER SUPPLY.
- CONTRACTOR SHALL PLACE A BLUE REFLECTIVE MARKER AT CENTERLINE OF STREET ADJACENT TO FIRE HYDRANT AS REQUIRED IN ORDINANCE NO. 3944 TO IDENTIFY FIRE HYDRANT LOCATIONS.
- CONTRACTOR SHALL CALL THE LAS VEGAS BUILDING DEPARTMENT AT 229-2071 FOR UNDERGROUND INSPECTION, PRESSURE AND FLUSH VERIFICATION OF ALL FIRE HYDRANTS AND FIRE LINES BEFORE BACK FILLING.
- PAINING OF THE CURBS AND HYDRANT AND ANY WORK NECESSARY FOR PROTECTION OF HYDRANTS FROM PHYSICAL DAMAGE, PER ORDINANCE NO. 3944 SHALL BE COMPLETED BEFORE APPROVAL BY THE CITY OF LAS VEGAS FIRE DEPARTMENT.
- A PERMIT IS REQUIRED FROM THE FIRE DEPARTMENT FOR ON-SITE WATER LINES AND FIRE HYDRANTS. THE PERMIT AND CONTRACTOR'S MATERIAL AND TEST CERTIFICATE FOR UNDERGROUND PIPING FORM SHALL BE OBTAINED FROM THE FIRE PROTECTION ENGINEER BEFORE TO ANY WORK BEGINNING.
- PRIVATE FIRE HYDRANTS SHALL BE PAINTED RED.
- A FLOW TEST MUST BE WITNESSED BY THE FIRE DEPARTMENT PRIOR TO OCCUPANCY FOR VERIFICATION OF REQUIRED ON-SITE WATER SUPPLY.
- ALL ON-SITE FIRE MAIN MATERIALS MUST BE U.L. LISTED AND A.W.W.A. APPROVED.
- FIRE HYDRANT SPACING:
 - RESIDENTIAL - 500 FEET UNSPRINKLERED; 1,000 FEET SPRINKLERED.
 - COMMERCIAL, INCLUDING MULTI-FAMILY - 300 FEET UNSPRINKLERED; 600 FEET SPRINKLERED.
- WHERE NEW WATER MAINS ARE EXTENDED ALONG STREETS, FIRE HYDRANTS SHALL BE SPACED AT MAXIMUM 1,000 FOOT SPACING TO PROVIDE FOR TRANSPORTATION HAZARDS.
- NO FIRE HYDRANT SHALL BE LOCATED WITHIN THE REQUIRED RADIUS OF A CUL-DE-SAC OR WITHIN TWENTY (20) FEET OF THE PERIMETER OF THE RADIUS OF THE CUL-DE-SAC.
- NO FIRE HYDRANT SHALL BE LOCATED WITHIN SIX FEET (6') FEET OF ANY CURB RETURN, DRIVEWAY, POWER POLE, STREET LIGHT OR ANY OTHER OBSTRUCTION.
- TWO SOURCES OF SUPPLY ARE REQUIRED WHENEVER THERE ARE FOUR (4) OR MORE FIRE HYDRANTS INSTALLED ON A SINGLE SYSTEM.
- NOT MORE THAN TWO (2) HYDRANTS CAN BE OUT OF SERVICE DUE TO A SINGLE MAIN BREAK.
- FIRE APPARATUS ACCESS ROADS SHALL HAVE AN UNOBSTRUCTED WIDTH OF NOT LESS THAN TWENTY FEET (20') PROVIDED NO PARKING IS ALLOWED, NOT LESS THAN TWENTY-EIGHT FEET (28') IF PARALLEL PARKING IS ALLOWED ON ONE SIDE, AND NOT LESS THAN THIRTY-SIX FEET (36') IF PARALLEL PARKING IS ALLOWED ON BOTH SIDES. VERTICAL CLEARANCE SHALL NOT BE LESS THAN THIRTEEN-FEET-SIX INCHES (13' 6").
- THE TURNING RADIUS FOR ANY FIRE APPARATUS ACCESS ROAD AND/OR FIRE LANE, PUBLIC OR PRIVATE SHALL BE NOT LESS THAN FORTY-FIVE FEET (45') OUTSIDE RADIUS AND TWENTY-TWO FEET (22') INSIDE RADIUS.
- A FIRE APPARATUS ROAD SHALL BE REQUIRED WHEN ANY PORTION OF AN EXTERIOR WALL OF THE FIRST STORY IS LOCATED MORE THAN ONE-HUNDRED FIFTY FEET (150') FROM A FIRE DEPARTMENT VEHICLE ACCESS (SEE EXCEPTIONS IN UFC 94, SECTION 902.2).
- ALL DEAD END FIRE APPARATUS ACCESS ROADS, AND/OR FIRE LANES, PUBLIC OR PRIVATE, IN EXCESS OF ONE-HUNDRED FIFTY FEET (150') IN LENGTH SHALL BE PROVIDED WITH AN APPROVED TURNAROUND AREA. SEE ORDINANCE NO. 3944.
- ACCESS ROADS SHALL BE MARKED BY PLACED APPROVED SIGNS AT THE START OF THE DESIGNATED FIRE LANE, ONE SIGN AT THE END OF THE FIRE LANE AND WITH SIGNS AT INTERVALS OF ONE-HUNDRED FEET (100') ALONG ALL DESIGNATED FIRE LANES. SIGNS TO BE PLACED ON BOTH SIDES OF AN ACCESS ROADWAY IF NEEDED TO PREVENT PARKING ON EITHER SIDE. SIGNS TO BE INSTALLED NO HIGHER THAN TEN FEET (10') OR LESS THAN SIX FEET (6') FROM ROADWAY LEVEL. THE CURBS ALONG OR ON THE PAVEMENT OR CURBENT IF CURB IS NOT PRESENT, SHALL BE PAINTED WITH A RED WEATHER RESISTANT PAINT IN ADDITION TO THE SIGNS.
- ELECTRICALLY CONTROLLED ACCESS GATES SHALL BE PROVIDED WITH AN APPROVED EMERGENCY VEHICLE DETECTOR/RECEIVER SYSTEM. SAID SYSTEM SHALL BE INSTALLED IN ACCORDANCE WITH THE CITY OF LAS VEGAS GUIDELINES FOR AUTOMATIC EMERGENCY VEHICLE ACCESS GATES.

LAS VEGAS VALLEY WATER DISTRICT STANDARD NOTES

- NO WORK SHALL BEGIN UNTIL THE WATER PLANS HAVE BEEN RELEASED FOR CONSTRUCTION BY THE LVWD. FOLLOWING WATER PLAN APPROVAL, 48 HOUR NOTICE SHALL BE GIVEN TO THE LVWD COMMUNICATION SUPPORT CENTER (258-7171) PRIOR TO THE START OF CONSTRUCTION. NOTICE MUST BE GIVEN BY 2:00 P.M. THE BUSINESS DAY PRIOR TO A LVWD INSPECTION.
- ALL WORK SHALL CONFORM TO THE LVWD'S STANDARD PLATES, DRAWINGS, AND SPECIFICATIONS AND THE UNIFORM DESIGN AND CONSTRUCTION STANDARDS FOR WATER DISTRIBUTION SYSTEMS (UDACS), LATEST EDITION.
- ALL WORK, EXCEPT AS MODIFIED BY THESE PLANS OR BY NOTE 2, SHALL BE DONE IN ACCORDANCE WITH THE MOST CURRENT DRAFT OR EDITION OF THE UNIFORM STANDARD SPECIFICATIONS FOR PUBLIC WORKS CONSTRUCTION OFFSITE IMPROVEMENT, CLARK COUNTY AREA.
- A SINGLE PIPE MATERIAL SHALL BE USED THROUGHOUT THE PROJECT UNLESS OTHERWISE APPROVED BY THE LVWD.
- ALL SERVICE LATERALS TWO (2) INCHES IN DIAMETER AND SMALLER SHALL BE COPPER TUBING WITH LVWD APPROVED SERVICE SADDLES.
- ALL WATER METER BOXES SHALL BE LOCATED OUTSIDE OF DRIVEWAY AREAS.
- ALL VALVES SHALL BE LOCATED OUTSIDE OF DRIVEWAYS, VALLEY AND CURB CUTTERS.
- THE FOLLOWING REQUIREMENTS MUST BE MET IN THE EVENT A WATER LINE AND SANITARY OR STORM SEWER LINE CROSS:
 - A MINIMUM EIGHTEEN (18) INCH VERTICAL SEPARATION (OUTSIDE TO OUTSIDE) MUST BE MAINTAINED WHEN THE WATER LINE IS INSTALLED OVER THE SANITARY OR STORM SEWER LINE. IF THE VERTICAL SEPARATION CANNOT BE MAINTAINED OR THE WATER LINE MUST BE PLACED UNDER THE SANITARY OR STORM SEWER LINE, THE SANITARY OR STORM SEWER LINE MUST BE CONSTRUCTED WITH ONE OF THE FOLLOWING OR, AS SHOWN ON THESE PLANS:
 - POTABLE WATER SUPPLY QUALITY MATERIAL.
 - ENCASEMENT, WITH FOUR (4) INCH CONCRETE (MINIMUM).
 - SLEEVING WITH POTABLE WATER SUPPLY QUALITY PIPE.
 - EACH PROVISION MUST EXTEND ALONG THE SANITARY OR STORM SEWER, ON EITHER SIDE OF THE MAIN, A MINIMUM 10 FOOT DISTANCE PERPENDICULAR TO THE WATER MAIN EXTERIOR.
- WARNING TAPE SHALL BE REQUIRED OVER ALL MAINS, ALL SIX (6) INCH DIAMETER AND LARGER SERVICE LATERALS, AND ANY SERVICE LATERAL NOT INSTALLED PERPENDICULAR TO THE MAIN IN ACCORDANCE WITH STANDARD PLATE NO. 27.
- ALL WATER FACILITIES SHALL BE FILLED, DISINFECTED, PRESSURE TESTED, FLUSHED, FILLED AND AN ACCEPTABLE WATER SAMPLE OBTAINED, PRIOR TO CONNECTION TO THE LVWD'S DISTRIBUTION SYSTEM.
- THE CONTRACTOR MUST OBTAIN ALL METERS TWO (2) INCHES AND SMALLER FROM LVWD CENTRAL STORES. TELEPHONE 258-3152 FORTY-EIGHT HOURS PRIOR TO PICKUP.
- CONSTRUCTION MAY INTERRUPT SERVICE, WITH AGENCY APPROVAL AND PROPER NOTIFICATION, BETWEEN THE HOURS OF 10 PM AND 8 AM, SUNDAY THROUGH THURSDAY. CIRCUMSTANCES MAY REQUIRE TEMPORARY SERVICE FEEDS BE INSTALLED, WITHOUT LVWD REIMBURSEMENT. ANY TEMPORARY SERVICE FEED MUST HAVE PRIOR LVWD APPROVAL.
- ALL WATER FACILITY CONSTRUCTION MATERIALS USED MUST BE AS LISTED ON THE LVWD'S PRE-APPROVED MATERIALS AND MANUFACTURERS LISTING FOR NEW FACILITIES, LATEST REVISION, OR SPECIALLY APPROVED ON THESE PLANS.

NEVADA DEPARTMENT OF TRANSPORTATION (INDOT) PERMIT REQUIRED. AN APPROVED INDOT OCCUPANCY PERMIT SHALL BE OBTAINED BEFORE ANY CONSTRUCTION WITHIN THE INDOT RIGHT-OF-WAY.

RAINBOW BOULEVARD SR-595

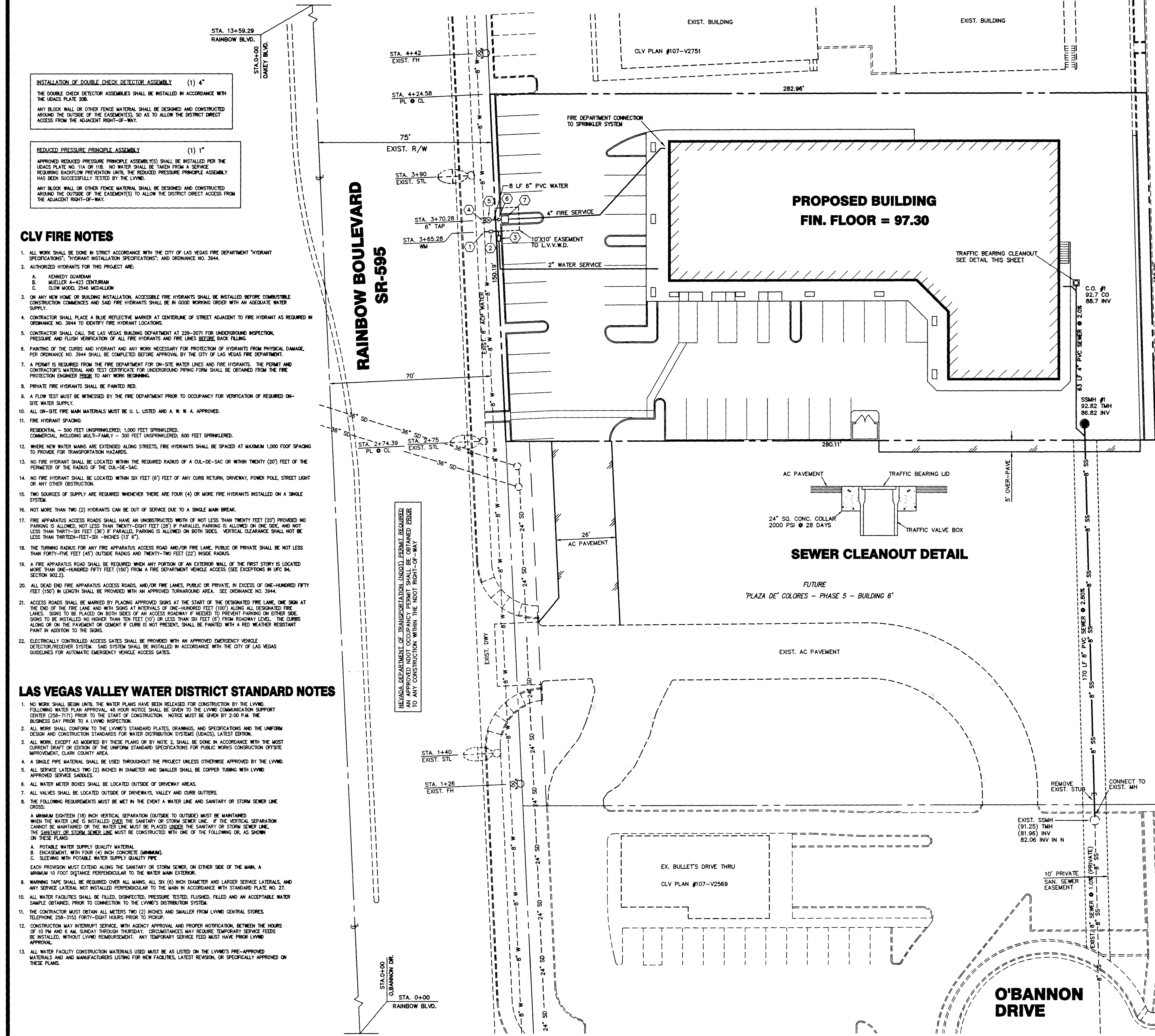

**PROPOSED BUILDING
FIN. FLOOR = 97.30**

SEWER CLEANOUT DETAIL

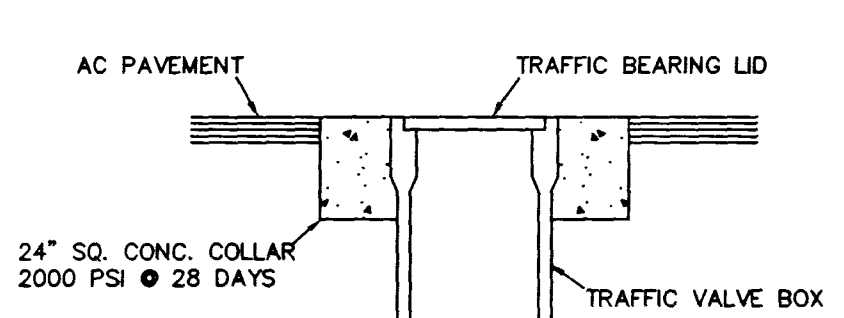

BENCHMARK

CITY OF LAS VEGAS BENCHMARK # 7C10-2M4
 RIVET & ALUM. PLATE AT THE NE RETURN
 OF RAINBOW BLVD. & OAKLEY BLVD.
 ELEV. = 2400.32 FT. = 731.619 M. (NAVD 88)

BASIS OF BEARINGS

N 02° 39' 23" W - BEING THE WEST LINE OF THE SW 1/4 OF SECTION 2,
 TOWNSHIP 21 SOUTH, RANGE 60 EAST, M.D.M. CLARK COUNTY, NEVADA
 PER FILE 16, PAGE 34 OF PARCEL MAPS, CLARK COUNTY RECORDER'S OFFICE

GRAPHIC SCALE

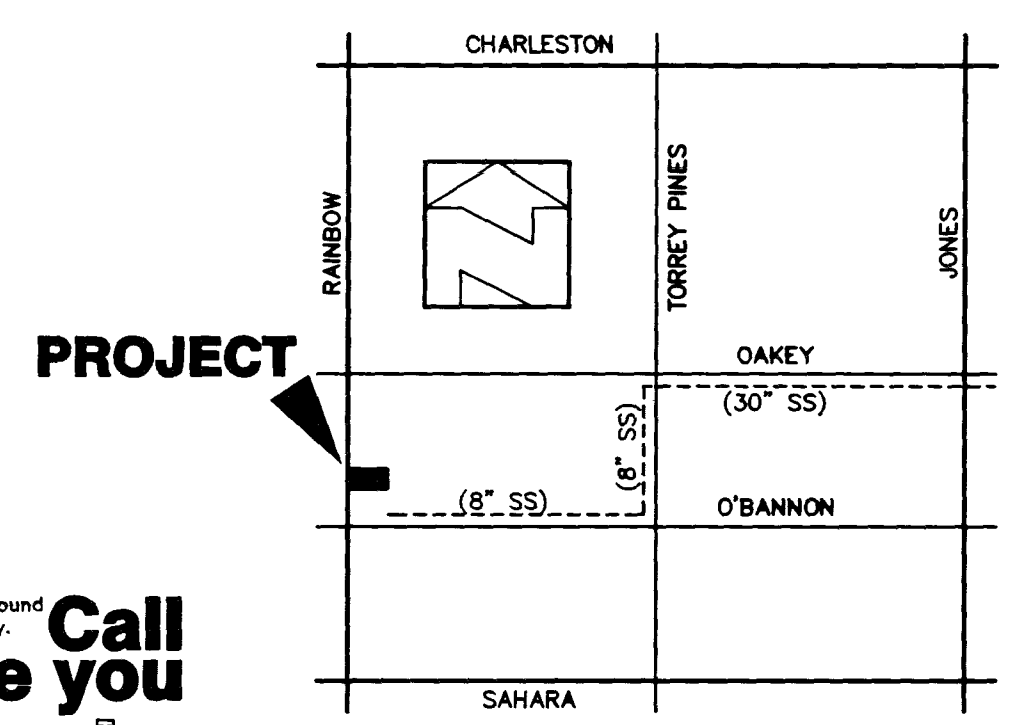
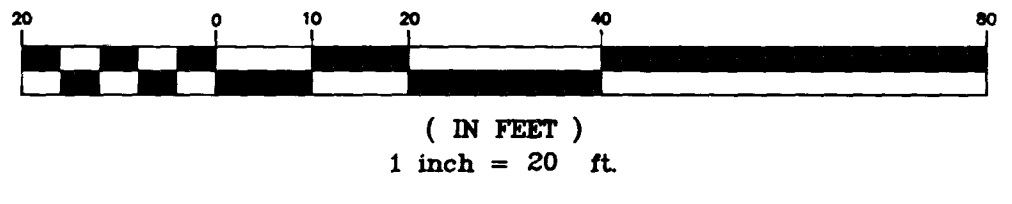

LOCATION

8" SEWER DISCHARGES INTO 30" SEWER AT OAKLEY & TORREY PINES. SEE LOCATION MAP.

Call before you Dig.
 1-800-227-2600

SEWER CONTRIBUTION

AVERAGE FLOW = 800 GPD
 PEAK FLOW = 2320 GPD

WATER QUANTITIES ESTIMATE (PRIVATE)

- | | |
|--|------|
| 1" SERVICE SADDLE | 1 EA |
| 1" WATER METER PER UDACS PLATE #1D | 1 EA |
| 1" R.P.P.A. | 1 EA |
| 8" x 6" TAPPING TEE | 1 EA |
| 6" TAPPING VALVE | 1 EA |
| 6" x 4" REDUCER | 1 EA |
| 4" D.C.D.A. FEBCO MODEL 876 "N" PATTERN PER UDACS PLATE #20B | 1 EA |
| 6" PVC | 8 LF |

APPROVALS

LAS VEGAS FIRE DEPARTMENT

FIRE FLOW REQUIREMENT IS: 1500 GALLONS PER MINUTE AT 20 PSI RESIDUAL PRESSURE
 BASED ON:
 SQUARE FOOTAGE: 12,500 SF
 LARGEST AREA BETWEEN 4-HOUR AREA SEPARATION WALLS:
 BUILDING HEIGHT: 21 FT. (MAX)
 NUMBER OF STORIES: 1 FLOOR
 TYPE OF CONSTRUCTION: V - N
 OCCUPANCY: B
 FULL AUTOMATIC FIRE SPRINKLER SYSTEM: YES

REVIEWED BY: *[Signature]*
 DATE: 12-15-98

[Signature] 12/15/98
LAS VEGAS VALLEY WATER DISTRICT DATE

NOTE:
 ALL DIMENSIONS TO UTILITIES ARE TO CENTERLINE OF PIPE UNLESS INDICATED OTHERWISE

CONTRACTOR SHALL VERIFY HORIZONTAL AND VERTICAL ALIGNMENT OF EXISTING UTILITIES AND TO NOTIFY THE DESIGN ENGINEER IMMEDIATELY ON ANY DISCREPANCIES PRIOR TO CONSTRUCTION.

REVISION BY DATE

SUN WEST
 2575 S. CIMARRON ROAD #200
 LAS VEGAS, NEVADA 89117
 (702) 363-8060

UTILITY PLAN

PLAZA DE COLORES PHASE 4 - BUILDING 5

ROBERT J. LANGAN
 ENGINEERING
 1000 W. LAS VEGAS BLVD. SUITE 202
 LAS VEGAS, NEVADA 89102
 (702) 221-4288

DRAWN BY: R. J. LANGAN 12/11/98
 DESIGNED BY: R. J. LANGAN 12/11/98
 CHECKED BY: R. J. LANGAN 12/11/98
 PROJECT NO.: SW98-002
 SCALE: 1" = 20' HOR.

SEAL
 LAS VEGAS VALLEY WATER DISTRICT

SHEET
C3
 3 OF 3 SHEETS
 DRAWING NO.
 107-V2961

APPROVED BY THE BOARD OF SUPERVISORS OF THE COUNTY OF LOS ANGELES, CALIFORNIA, ON 05/11/2010.

APPROVED BY THE BOARD OF SUPERVISORS OF THE COUNTY OF LOS ANGELES, CALIFORNIA, ON 05/11/2010.

SEE THE NOTES

- 1. ALL WORK SHALL BE IN ACCORDANCE WITH THE LATEST EDITIONS OF THE CALIFORNIA BUILDING CODE AND ALL APPLICABLE ORDINANCES.
- 2. ALL WORK SHALL BE IN ACCORDANCE WITH THE LATEST EDITIONS OF THE CALIFORNIA ELECTRICAL CODE AND ALL APPLICABLE ORDINANCES.
- 3. ALL WORK SHALL BE IN ACCORDANCE WITH THE LATEST EDITIONS OF THE CALIFORNIA MECHANICAL CODE AND ALL APPLICABLE ORDINANCES.
- 4. ALL WORK SHALL BE IN ACCORDANCE WITH THE LATEST EDITIONS OF THE CALIFORNIA PLUMBING CODE AND ALL APPLICABLE ORDINANCES.
- 5. ALL WORK SHALL BE IN ACCORDANCE WITH THE LATEST EDITIONS OF THE CALIFORNIA FIRE CODE AND ALL APPLICABLE ORDINANCES.
- 6. ALL WORK SHALL BE IN ACCORDANCE WITH THE LATEST EDITIONS OF THE CALIFORNIA SAFETY CODE AND ALL APPLICABLE ORDINANCES.
- 7. ALL WORK SHALL BE IN ACCORDANCE WITH THE LATEST EDITIONS OF THE CALIFORNIA ENVIRONMENTAL CODE AND ALL APPLICABLE ORDINANCES.
- 8. ALL WORK SHALL BE IN ACCORDANCE WITH THE LATEST EDITIONS OF THE CALIFORNIA LAND USE CODE AND ALL APPLICABLE ORDINANCES.
- 9. ALL WORK SHALL BE IN ACCORDANCE WITH THE LATEST EDITIONS OF THE CALIFORNIA ZONING CODE AND ALL APPLICABLE ORDINANCES.
- 10. ALL WORK SHALL BE IN ACCORDANCE WITH THE LATEST EDITIONS OF THE CALIFORNIA HEALTH CODE AND ALL APPLICABLE ORDINANCES.
- 11. ALL WORK SHALL BE IN ACCORDANCE WITH THE LATEST EDITIONS OF THE CALIFORNIA AGRICULTURE CODE AND ALL APPLICABLE ORDINANCES.
- 12. ALL WORK SHALL BE IN ACCORDANCE WITH THE LATEST EDITIONS OF THE CALIFORNIA LABOR CODE AND ALL APPLICABLE ORDINANCES.
- 13. ALL WORK SHALL BE IN ACCORDANCE WITH THE LATEST EDITIONS OF THE CALIFORNIA EDUCATION CODE AND ALL APPLICABLE ORDINANCES.
- 14. ALL WORK SHALL BE IN ACCORDANCE WITH THE LATEST EDITIONS OF THE CALIFORNIA PROFESSIONAL CODE AND ALL APPLICABLE ORDINANCES.
- 15. ALL WORK SHALL BE IN ACCORDANCE WITH THE LATEST EDITIONS OF THE CALIFORNIA BUSINESS AND PROFESSIONS CODE AND ALL APPLICABLE ORDINANCES.
- 16. ALL WORK SHALL BE IN ACCORDANCE WITH THE LATEST EDITIONS OF THE CALIFORNIA FINANCIAL CODE AND ALL APPLICABLE ORDINANCES.
- 17. ALL WORK SHALL BE IN ACCORDANCE WITH THE LATEST EDITIONS OF THE CALIFORNIA GOVERNMENT CODE AND ALL APPLICABLE ORDINANCES.
- 18. ALL WORK SHALL BE IN ACCORDANCE WITH THE LATEST EDITIONS OF THE CALIFORNIA JUDICIAL BRANCH CODE AND ALL APPLICABLE ORDINANCES.
- 19. ALL WORK SHALL BE IN ACCORDANCE WITH THE LATEST EDITIONS OF THE CALIFORNIA LEGISLATIVE BRANCH CODE AND ALL APPLICABLE ORDINANCES.
- 20. ALL WORK SHALL BE IN ACCORDANCE WITH THE LATEST EDITIONS OF THE CALIFORNIA EXECUTIVE BRANCH CODE AND ALL APPLICABLE ORDINANCES.

LAW TEXAS HILL BY WATER DISTRICT BOUNDARY

- 1. ALL WORK SHALL BE IN ACCORDANCE WITH THE LATEST EDITIONS OF THE CALIFORNIA BUILDING CODE AND ALL APPLICABLE ORDINANCES.
- 2. ALL WORK SHALL BE IN ACCORDANCE WITH THE LATEST EDITIONS OF THE CALIFORNIA ELECTRICAL CODE AND ALL APPLICABLE ORDINANCES.
- 3. ALL WORK SHALL BE IN ACCORDANCE WITH THE LATEST EDITIONS OF THE CALIFORNIA MECHANICAL CODE AND ALL APPLICABLE ORDINANCES.
- 4. ALL WORK SHALL BE IN ACCORDANCE WITH THE LATEST EDITIONS OF THE CALIFORNIA PLUMBING CODE AND ALL APPLICABLE ORDINANCES.
- 5. ALL WORK SHALL BE IN ACCORDANCE WITH THE LATEST EDITIONS OF THE CALIFORNIA FIRE CODE AND ALL APPLICABLE ORDINANCES.
- 6. ALL WORK SHALL BE IN ACCORDANCE WITH THE LATEST EDITIONS OF THE CALIFORNIA SAFETY CODE AND ALL APPLICABLE ORDINANCES.
- 7. ALL WORK SHALL BE IN ACCORDANCE WITH THE LATEST EDITIONS OF THE CALIFORNIA ENVIRONMENTAL CODE AND ALL APPLICABLE ORDINANCES.
- 8. ALL WORK SHALL BE IN ACCORDANCE WITH THE LATEST EDITIONS OF THE CALIFORNIA LAND USE CODE AND ALL APPLICABLE ORDINANCES.
- 9. ALL WORK SHALL BE IN ACCORDANCE WITH THE LATEST EDITIONS OF THE CALIFORNIA ZONING CODE AND ALL APPLICABLE ORDINANCES.
- 10. ALL WORK SHALL BE IN ACCORDANCE WITH THE LATEST EDITIONS OF THE CALIFORNIA HEALTH CODE AND ALL APPLICABLE ORDINANCES.
- 11. ALL WORK SHALL BE IN ACCORDANCE WITH THE LATEST EDITIONS OF THE CALIFORNIA AGRICULTURE CODE AND ALL APPLICABLE ORDINANCES.
- 12. ALL WORK SHALL BE IN ACCORDANCE WITH THE LATEST EDITIONS OF THE CALIFORNIA LABOR CODE AND ALL APPLICABLE ORDINANCES.
- 13. ALL WORK SHALL BE IN ACCORDANCE WITH THE LATEST EDITIONS OF THE CALIFORNIA EDUCATION CODE AND ALL APPLICABLE ORDINANCES.
- 14. ALL WORK SHALL BE IN ACCORDANCE WITH THE LATEST EDITIONS OF THE CALIFORNIA PROFESSIONAL CODE AND ALL APPLICABLE ORDINANCES.
- 15. ALL WORK SHALL BE IN ACCORDANCE WITH THE LATEST EDITIONS OF THE CALIFORNIA BUSINESS AND PROFESSIONS CODE AND ALL APPLICABLE ORDINANCES.
- 16. ALL WORK SHALL BE IN ACCORDANCE WITH THE LATEST EDITIONS OF THE CALIFORNIA FINANCIAL CODE AND ALL APPLICABLE ORDINANCES.
- 17. ALL WORK SHALL BE IN ACCORDANCE WITH THE LATEST EDITIONS OF THE CALIFORNIA GOVERNMENT CODE AND ALL APPLICABLE ORDINANCES.
- 18. ALL WORK SHALL BE IN ACCORDANCE WITH THE LATEST EDITIONS OF THE CALIFORNIA JUDICIAL BRANCH CODE AND ALL APPLICABLE ORDINANCES.
- 19. ALL WORK SHALL BE IN ACCORDANCE WITH THE LATEST EDITIONS OF THE CALIFORNIA LEGISLATIVE BRANCH CODE AND ALL APPLICABLE ORDINANCES.
- 20. ALL WORK SHALL BE IN ACCORDANCE WITH THE LATEST EDITIONS OF THE CALIFORNIA EXECUTIVE BRANCH CODE AND ALL APPLICABLE ORDINANCES.

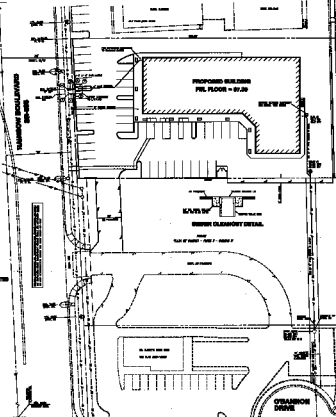

BOUNDARY
 ALL WORK SHALL BE IN ACCORDANCE WITH THE LATEST EDITIONS OF THE CALIFORNIA BUILDING CODE AND ALL APPLICABLE ORDINANCES.



FOR MORE INFORMATION
 CALL
 1-800-257-2510

SEWER CONTRIBUTION

SEWER QUANTITIES (GPM)	CONTRIBUTION
1" 1.00	1.00
2" 1.00	1.00
3" 1.00	1.00
4" 1.00	1.00
6" 1.00	1.00
8" 1.00	1.00
10" 1.00	1.00
12" 1.00	1.00
15" 1.00	1.00
18" 1.00	1.00
24" 1.00	1.00
30" 1.00	1.00
36" 1.00	1.00
42" 1.00	1.00
48" 1.00	1.00
54" 1.00	1.00
60" 1.00	1.00
72" 1.00	1.00
84" 1.00	1.00
96" 1.00	1.00
108" 1.00	1.00
120" 1.00	1.00
132" 1.00	1.00
144" 1.00	1.00
156" 1.00	1.00
168" 1.00	1.00
180" 1.00	1.00
192" 1.00	1.00
204" 1.00	1.00
216" 1.00	1.00
228" 1.00	1.00
240" 1.00	1.00
252" 1.00	1.00
264" 1.00	1.00
276" 1.00	1.00
288" 1.00	1.00
300" 1.00	1.00

APPROVALS

LAW TEXAS HILL DEPARTMENT
 2101 S. GARDEN ST. #100
 LOS ANGELES, CA 90007
 (213) 473-1000
 FAX (213) 473-1001
 WWW.LAWTEXAS.COM
 DATE: 05/11/2010
 DRAWN BY: [Signature]
 CHECKED BY: [Signature]
 APPROVED BY: [Signature]

NOTES
 1. ALL WORK SHALL BE IN ACCORDANCE WITH THE LATEST EDITIONS OF THE CALIFORNIA BUILDING CODE AND ALL APPLICABLE ORDINANCES.

UTILITY PLAN
 PLANS NO. 05-00000-01
 SHEET 4 OF 4

DATE: 05/11/2010
 DRAWN BY: [Signature]
 CHECKED BY: [Signature]
 APPROVED BY: [Signature]