

BENCHMARK

"7C10 25WMS": BEING A RIVET & PLATE IN TOP OF CURB, NE RETURN OF RAINBOW BLVD. AND O'BANNON AVE.
ELEV=2399.07 FEET
ELEV=731.2372 METERS (NAVD 88)

BASIS OF BEARING

N 02°39'55" W: BEING THE CENTERLINE OF ROSANNA STREET AS SHOWN ON PM 163-76, FILE 14, PAGE 11, IN THE OFFICE OF THE CLARK COUNTY, NEVADA, RECORDER.

CURVE TABLE

CURVE	RADIUS	LENGTH	TANGENT	DELTA
CL TBC	20.00'	31.03'	19.81'	88°52'50"

GRAPHIC SCALE

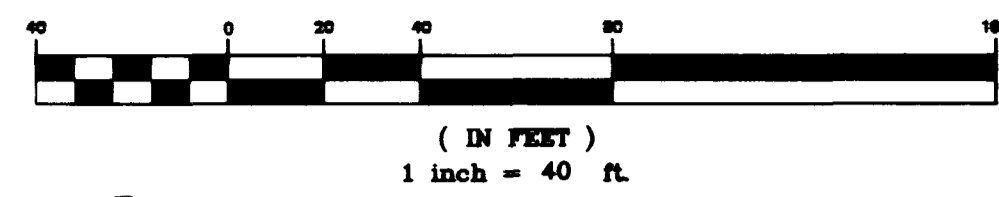

NOTE:

J.H.R. ASSOCIATES ASSUMES NO RESPONSIBILITY FOR EXISTING UTILITY LOCATIONS. THE UTILITIES SHOWN ON THIS DRAWING HAVE BEEN PLOTTED FROM THE BEST AVAILABLE INFORMATION. IT IS, HOWEVER, THE CONTRACTOR'S RESPONSIBILITY TO FIELD VERIFY THE LOCATION OF ALL UTILITIES PRIOR TO THE COMMENCEMENT OF ANY CONSTRUCTION. CONTRACTOR TO FIELD VERIFY ALL EXISTING SITE CONDITIONS PRIOR TO CONSTRUCTION. IF A CONFLICT EXISTS BETWEEN WHAT IS SHOWN ON THIS DRAWING AND WHAT EXISTS IN THE FIELD, CONTRACTOR IS TO NOTIFY THE ENGINEER IMMEDIATELY.

AVOID CUTTING UNDERGROUND UTILITY LINES. IT'S COSTLY.
Call before you Dig.
1-800-227-2600
(48 hrs. Advance Notice Required)

AVOID OVERHEAD POWER LINE CONTACT. IT'S COSTLY.
Call before you OVERHEAD
1-702-593-6111
NEVADA POWER ENVIRONMENT AND SAFETY SERVICES DEPARTMENT

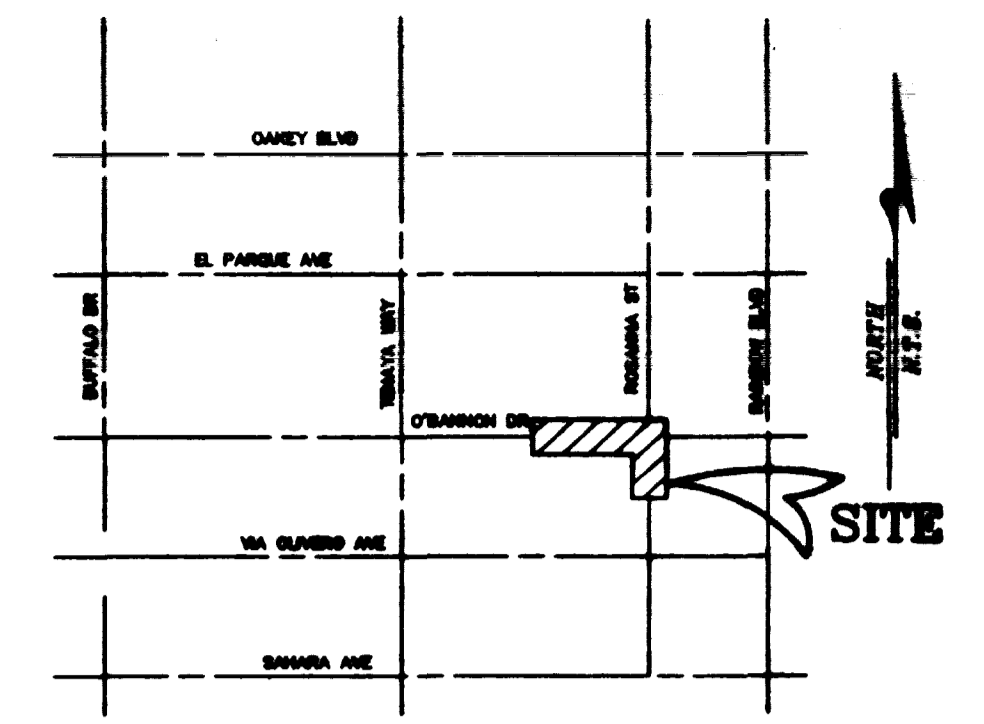

VICINITY MAP
NOT TO SCALE

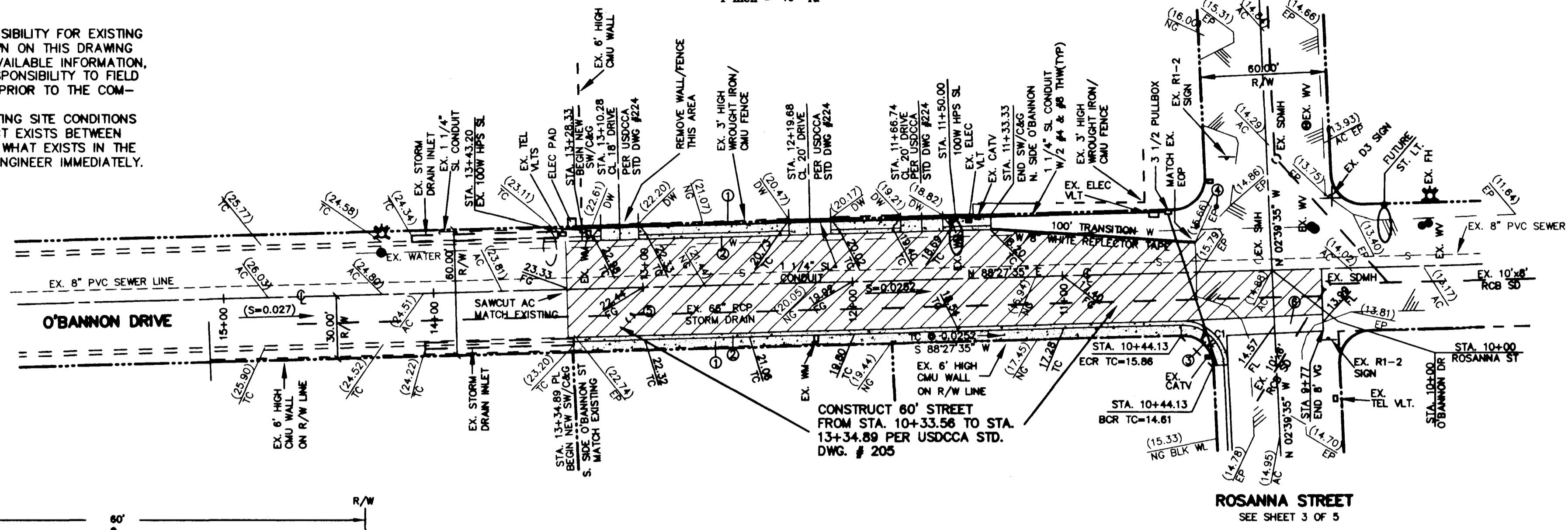

NORTH
1" = 40' HORIZ.
1" = 4' VERT.

LEGEND

- EXIST. EDGE OF PAVEMENT
- CENTERLINE STREET
- PROPERTY LINE
- PROPOSED CURB & GUTTER
- EXISTING CURB & GUTTER
- EXIST. SEWER
- EXISTING WATER LINE
- EXIST. STORM DRAIN
- EXISTING BLOCK WALL
- EX. FIRE HYDRANT ASSEMBLY
- STREET LIGHT AS SHOWN
- ASPHALTIC CONCRETE
- CABLE TV VAULT
- CURB & GUTTER
- CENTERLINE
- DRIVEWAY
- EDGE OF PAVEMENT
- FINISH FLOOR
- FINISH GRADE
- FIRE HYDRANT
- FLOW LINE
- NATURAL GROUND
- STORM DRAIN DROP INLET
- STORM DRAIN MANHOLE
- STREET LIGHT
- SEWER MANHOLE
- STATION
- SIDEWALK
- TOP OF CURB
- TOP OF MANHOLE
- VALLEY GUTTER
- WATER METER
- WATER VALVE
- PROPOSED GRADE
- EXISTING GRADE
- NEW AC PAVEMENT

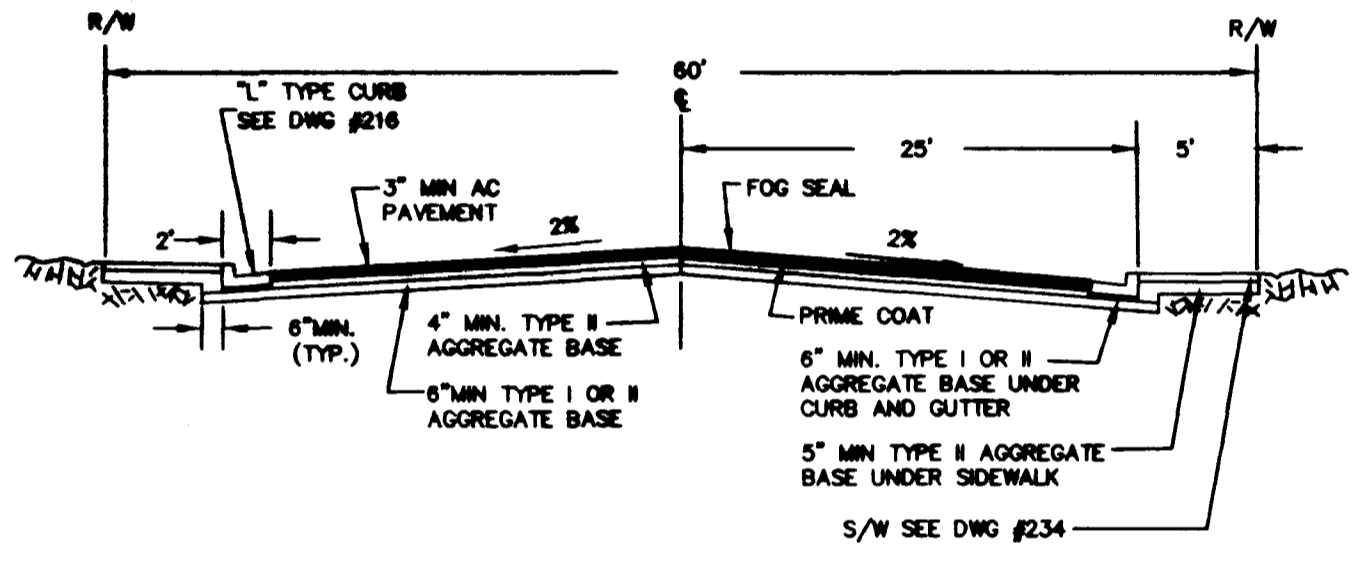

TYPICAL 60' STREET CROSS SECTION
UNIFORM STANDARD DRAWINGS CLARK COUNTY AREA
STD. DWG. # 205

CONSTRUCTION NOTES

1. INSTALL 5' SIDEWALK PER USDOCCA STD DWG #234
2. INSTALL 2" "L" TYPE C&G PER USDOCCA STD DWG #216
3. INSTALL HANDICAP RAMP PER USDOCCA STD DWG #235, CASE III. SEE TABLE SHEET #3
4. INSTALL 2 W-8 (CHEVRON)
5. ADJUST STORM DRAIN MANHOLE TO FINISH GRADE
6. INSTALL 8' CROSS GUTTER PER USDOCCA STD DWG #228

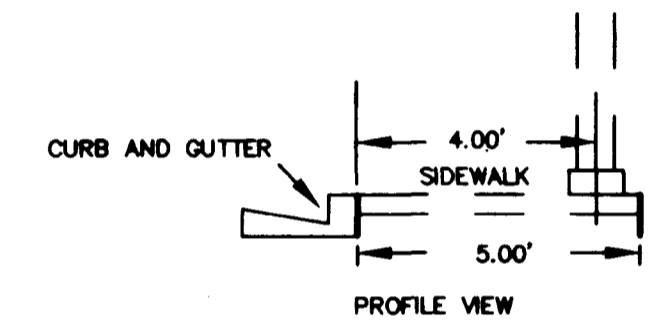

STREETLIGHT LOCATION AT BACK OF WALK (TYPICAL)

STREET LIGHT NOTE:
ALL HAND HOLE COVERS MUST BE INSTALLED. POLE CAPS POURED AND PULL BOX LIDS BOLTED DOWN PRIOR TO ENERGIZING CIRCUIT. ALL WIRE MUST HAVE THW INSULATION.

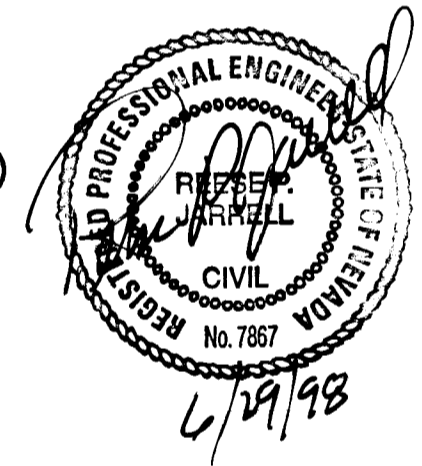

O'BANNON DRIVE

(PUBLIC STREET) 60' R/W

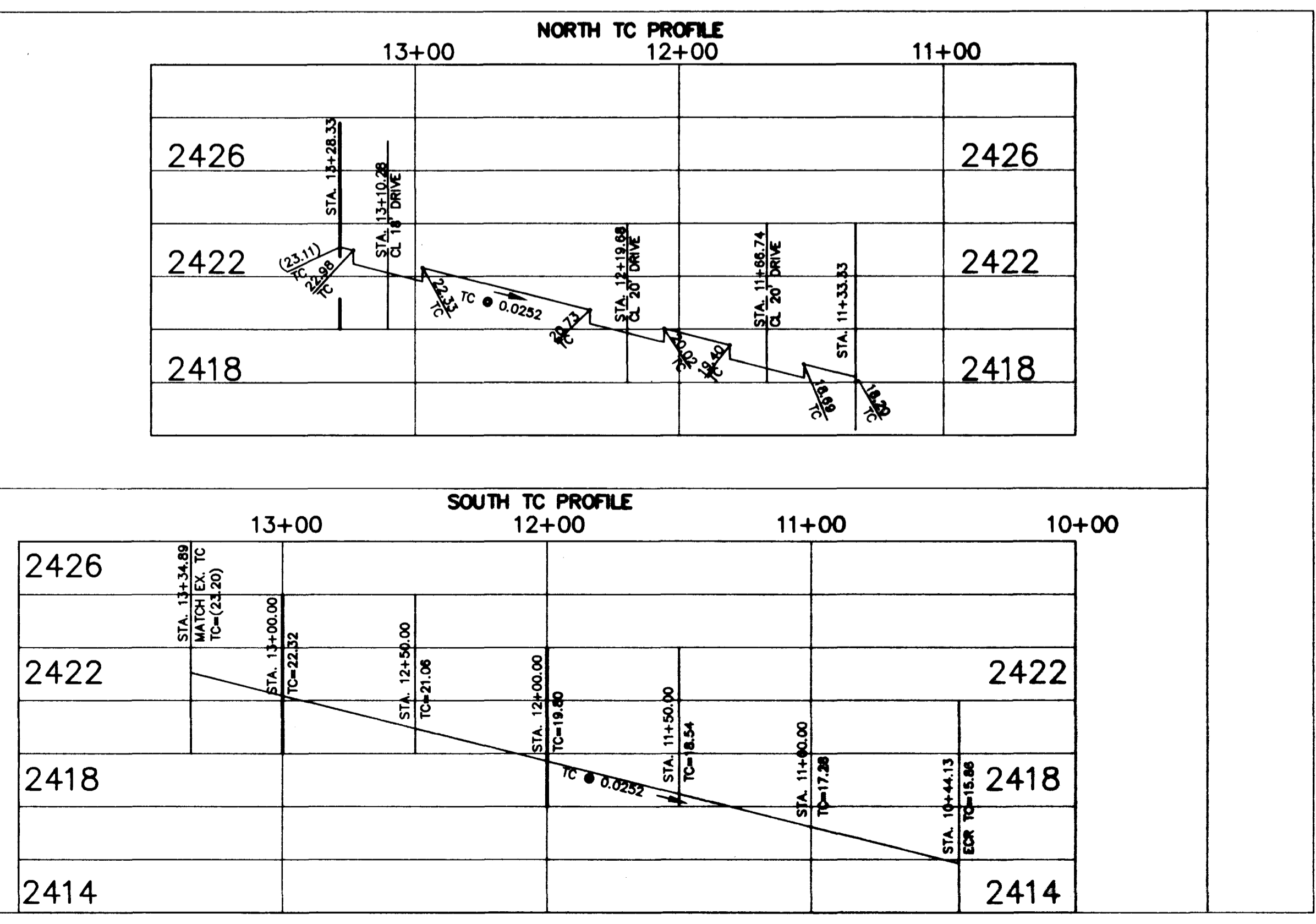
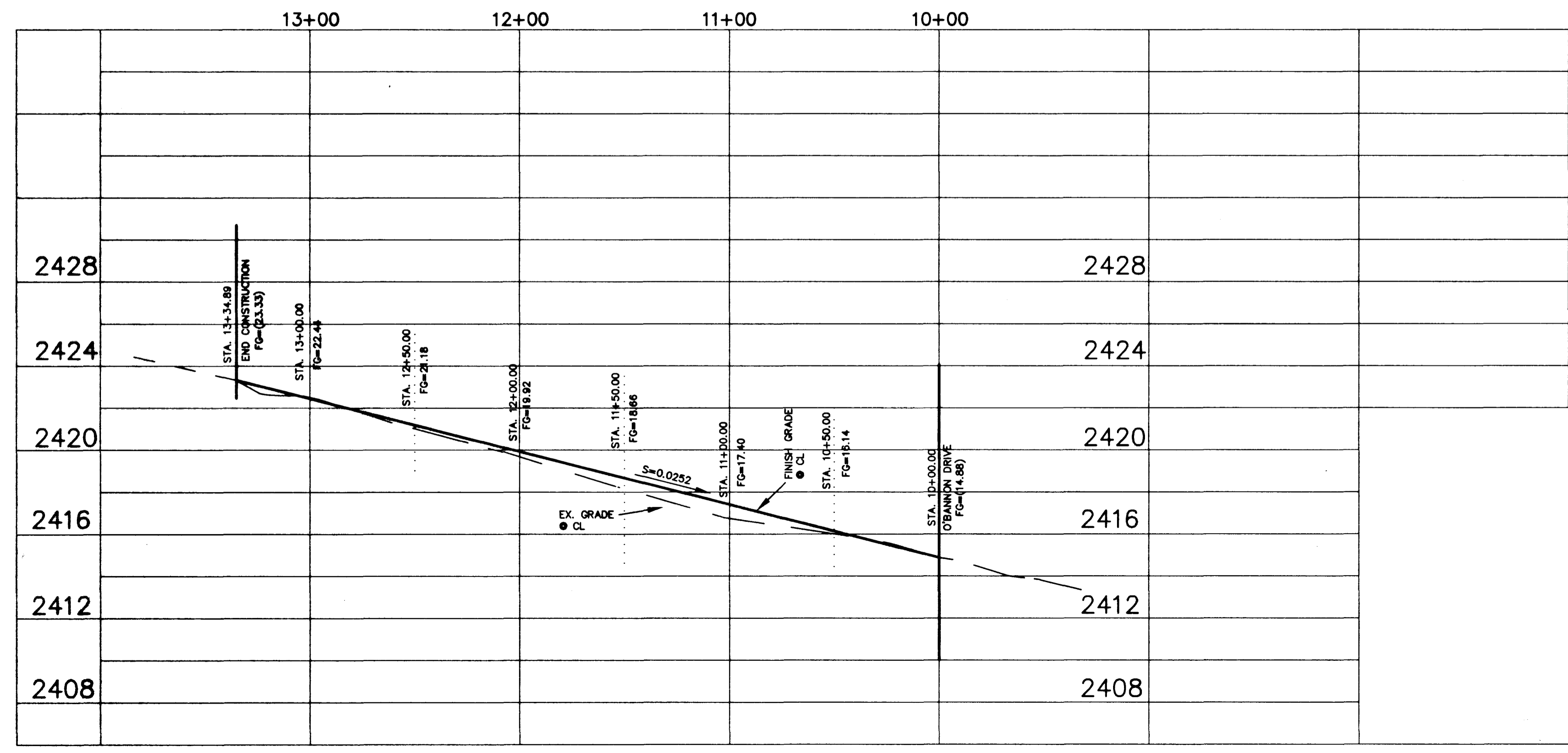

JHR ASSOCIATES LTD.
CONSULTING ENGINEERS & LAND SURVEYORS
P.O. BOX 24631
LAS VEGAS, NEVADA 89126
(702) 878-2341

PLAN & PROFILE
O'BANNON/ROSANNA STREET IMPROVEMENTS
STA. 10+00 TO STA. 13+34.89

DATE	BY	DESCRIPTION
07-17-97		

DRAWN: JHR
CHECKED: B.L.R.
APPROVED: R.P.L.
DATE: 07-17-97
JOB NUMBER: 102-97-333

SHEET **2**
OF 5 SHEETS

BENCHMARK
CLAY CITY MARK #1
 1000.00
 1000.00

BASIS OF HEARING
1985-1986 SURVEY

CURVE TABLE
 PC 1+00.00
 PT 1+00.00
 PVI 1+00.00
 ELEV 100.00

ADJUSTMENT
 before 10/15/85
 after 10/15/85

ADJUSTMENT
 before 10/15/85
 after 10/15/85



NOTE:
 ALL DIMENSIONS ARE IN FEET UNLESS OTHERWISE SPECIFIED.
 ALL DIMENSIONS ARE TO CENTERLINE UNLESS OTHERWISE SPECIFIED.
 ALL DIMENSIONS ARE TO CENTERLINE UNLESS OTHERWISE SPECIFIED.

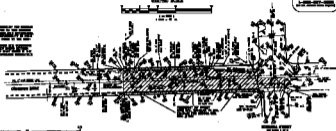

UTILITY
 1" = 40' SCALE
 FEET

UTILITY

NO.	DESCRIPTION	DATE	BY
1
2
3
4
5
6
7
8
9
10
11
12
13
14
15
16
17
18
19
20
21
22
23
24
25
26
27
28
29
30
31
32
33
34
35
36
37
38
39
40
41
42
43
44
45
46
47
48
49
50



TYPICAL 60' STREET CROSS SECTION
 UNIFORM STANDARD DRAINAGE CLAY COUNTY AREA
 STD. DET. # 200

- CONSTRUCTION NOTES**
- 1. ALL DIMENSIONS ARE IN FEET UNLESS OTHERWISE SPECIFIED.
 - 2. ALL DIMENSIONS ARE TO CENTERLINE UNLESS OTHERWISE SPECIFIED.
 - 3. ALL DIMENSIONS ARE TO CENTERLINE UNLESS OTHERWISE SPECIFIED.
 - 4. ALL DIMENSIONS ARE TO CENTERLINE UNLESS OTHERWISE SPECIFIED.
 - 5. ALL DIMENSIONS ARE TO CENTERLINE UNLESS OTHERWISE SPECIFIED.
 - 6. ALL DIMENSIONS ARE TO CENTERLINE UNLESS OTHERWISE SPECIFIED.
 - 7. ALL DIMENSIONS ARE TO CENTERLINE UNLESS OTHERWISE SPECIFIED.
 - 8. ALL DIMENSIONS ARE TO CENTERLINE UNLESS OTHERWISE SPECIFIED.
 - 9. ALL DIMENSIONS ARE TO CENTERLINE UNLESS OTHERWISE SPECIFIED.
 - 10. ALL DIMENSIONS ARE TO CENTERLINE UNLESS OTHERWISE SPECIFIED.



O'HANNON DRIVE
 1000.00

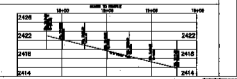
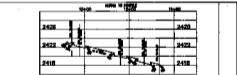
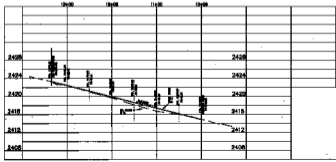

CLAY COUNTY ENGINEERS & SURVEYORS
O'HANNON DRIVE
 1000.00

CLAY COUNTY ENGINEERS & SURVEYORS
O'HANNON DRIVE
 1000.00

CLAY COUNTY ENGINEERS & SURVEYORS
O'HANNON DRIVE
 1000.00