

LEGEND AND QUANTITY ESTIMATE

Symbol	Description	Quantity	Notes
—	1 1/4" ST. LT. CONDUIT	270 LF.	PUBLIC
●	TCO TOP OF CLEAN OUT		
■	EX DROP INLET		
□	EX TRAFFIC SIGNAL HEAD		
○	STREET LIGHT 250 WATT HPS LUMINAIRE	1 EA.	
○	EX STREET LIGHT		
●	STD. FIRE HYDRANT ASSEMBLY PER UDACS STD. PLATE #7	2 EA.	
○	8" x 6" M.J. TAPPING TEE	2 EA.	
○	6" TAPPING VALVE	2 EA.	
○	AC PAVEMENT PATCH PER U.S.D. #504		
■	2" COPPER SERVICE CONNECTION & METER PER UDACS STD. PLATE #1D	1 EA.	
■	2" RPPA PER UDACS STD. PLATE #11A	1 EA.	
■	JENSEN 1000 GALLON GREASE INTERCEPTOR MODEL 1000EE W/CAST IRON FRAME AND COVER	1 EA.	
○	SEWER INVERT UNKNOWN—VERIFY PRIOR TO ANY CONSTRUCTION		
○	6" GATE VALVE	1 EA.	
○	6' x 6' LVVWD EASEMENT	2 EA.	
○	8" x 8" M.J. TAPPING TEE	1 EA.	
○	8" TAPPING VALVE	1 EA.	
○	8" CAP	3 EA.	
○	8" PVC WATER	74 LF	
○	6" PVC WATER	142 LF	
○	2" PVC WATER	66 LF	
○	2" COPPER WATER	5 LF	
○	6" PVC SEWER	283 LF	
○	4" PVC SEWER	169 LF	
○	6" SEWER CLEAN OUT w/ BOX, TRAFFIC RATED LID, & CONCRETE COLLAR	31 LF	
○	4" SEWER CLEAN OUT w/ BOX, TRAFFIC RATED LID, & CONCRETE COLLAR	4 EA.	
○	48" MANHOLE	2 EA.	
○	3" PVC WATER	200 LF	

FIRE FLOW CALCULATIONS

FIRE FLOW REQUIREMENT IS: 2000 gallons per minute at 20 psi residual pressure.

BASED ON:

- SQUARE FOOTAGE: 5,362 square feet
- LARGEST AREA BETWEEN 4-HOUR AREA SEPARATION WALLS: 5,362 square feet
- BUILDING HEIGHT: 36.5 feet
- NUMBER OF STORIES: 2 floor
- TYPE OF CONSTRUCTION: V-N
- OCCUPANCY: A-3
- FULL AUTOMATIC FIRE SPRINKLER SYSTEM: NO

Reviewed By: *Sam C. Dunnam*
 Date: 1st April 7/02/98
 LVVWD DATE: 7/02/98

SCALE IN FEET
 1" = 20'

REVISION

NO.	DATE	REVISION
1	07/17	REV. PER SW GAS CHK PRINT
2	11/20	move f.h. & meter
3	1/16	REV. LVVWD EASEMENT
4	5/11	REV. SEWER & WATER
5	5/20	SEWER / FIRE HYD. / WATER
6	6/10	REVISE BLDG / TRASH ENCLOSURE
7	6/10	REVISE PARKING/ADD WATER

DUNNAM CIVIL ENGINEERS
 3300 SPRING MOUNTAIN ROAD
 SUITE 82
 LAS VEGAS, NV 89102
 (702) 387-0688
 (702) 387-8146 FAX

PUTTERS II
 UTILITY PLAN

4 OF SEVEN

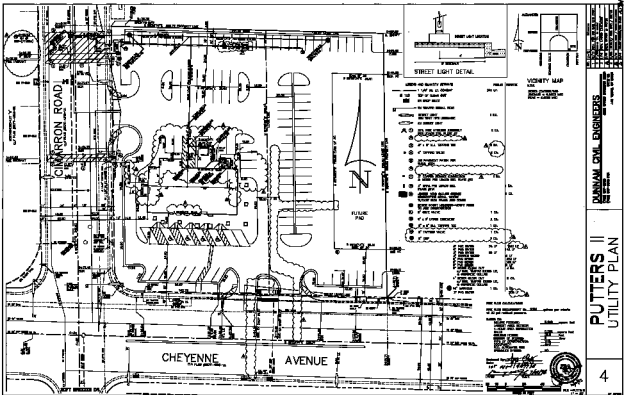

DUNNAN CIVIL ENGINEERS
 1000 W. 10TH ST. SUITE 100
 CHEYENNE, WY 82001
 (307) 632-1111

PUTTERS II
UTILITY PLAN