

LAS VEGAS VALLEY WATER DISTRICT STANDARD NOTES CONT.

- 7. ALL VALVES SHALL BE LOCATED OUTSIDE OF DRIVEWAYS, VALLEY AND CURB GUTTERS.
8. THE FOLLOWING REQUIREMENTS MUST BE MET IN THE EVENT OF A WATERLINE AND SANITARY OR STORM SEWER LINE CROSS:
A MINIMUM EIGHTEEN (18) INCH VERTICAL SEPARATION (OUTSIDE TO OUTSIDE) MUST BE MAINTAINED WHEN THE WATER LINE IS INSTALLED OVER THE SANITARY OR STORM SEWER LINE...

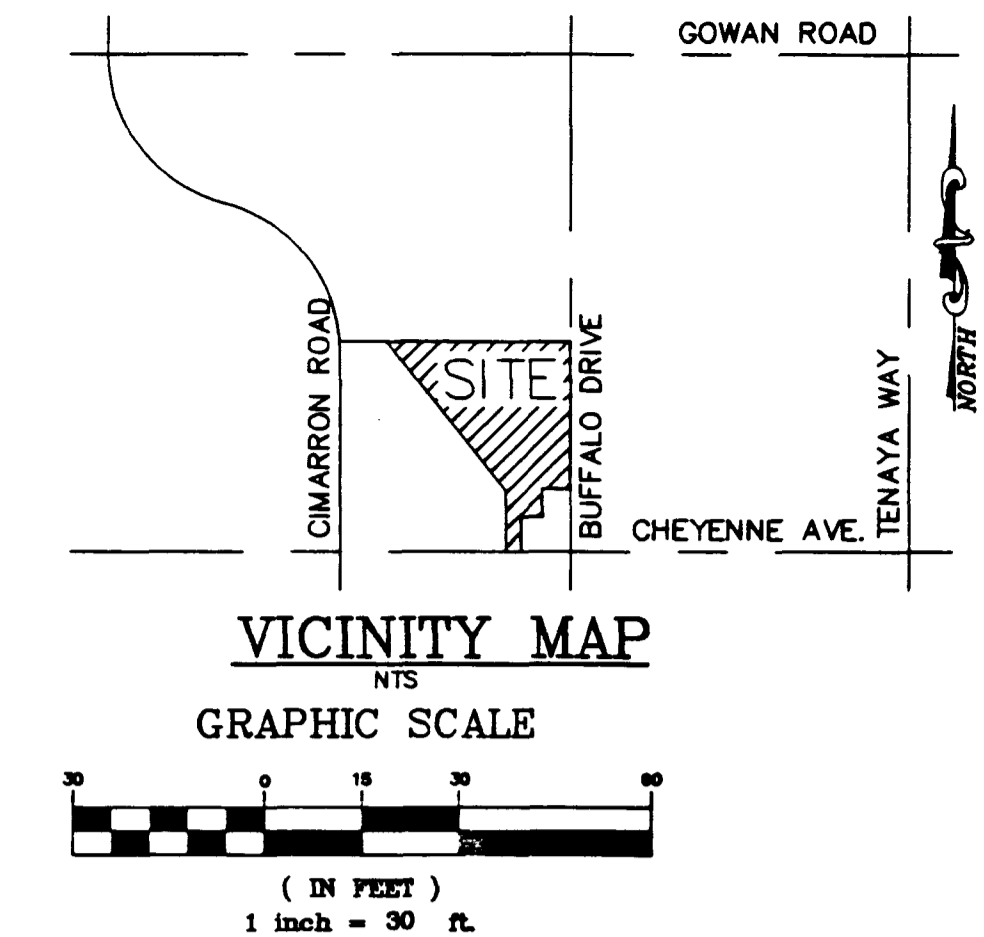

OWNER/DEVELOPER: CHEYENNE INVESTMENTS, LLC
6900 WESTCLIFF DRIVE, SUITE 505, B OF A BUILDING
LAS VEGAS, NEVADA 89128
PHONE: (702) 477-7777
FAX: (702) 656-2440

BENCHMARK: CLV BM# 01001814
SOUTH LINE SEC. 9, TOWNSHIP 20 SOUTH, RANGE 60 EAST, M.D.M. SAID BEARING BEING N 88°31'14" W, AS SHOWN ON "AMENDED PLAT OF NORTH SHORE, PHASE I", AS RECORDED IN BOOK 87, PAGE 89.

LEGAL DESCRIPTION: BEING A PORTION OF THE SOUTHEAST QUARTER (SE 1/4) OF THE SOUTHWEST QUARTER (SE 1/4) OF SECTION 9, TOWNSHIP 20 SOUTH, RANGE 60 EAST, M.D.M., IN THE CITY OF LAS VEGAS, CLARK COUNTY, NEVADA.

- CITY OF LAS VEGAS SEWER NOTES
1. ALL CONSTRUCTION AND MATERIALS SHALL BE IN ACCORDANCE WITH THE LATEST EDITION OF THE DESIGN AND CONSTRUCTION STANDARDS FOR WASTEWATER COLLECTION SYSTEMS AND THE UNIFORM STANDARD SPECIFICATIONS FOR PUBLIC WORKS' CONSTRUCTION OFF-SITE IMPROVEMENTS, CLARK COUNTY AREA, NEVADA, AS AMENDED. IN ALL CASES, THESE STANDARDS SHALL SUPERSEDE THE UNIFORM STANDARD SPECIFICATIONS. IT WILL BE THE RESPONSIBILITY OF THE CONTRACTOR TO BE AWARE OF THE CONTENTS OF THE ABOVE SPECIFICATION BOOKS.

- LAS VEGAS VALLEY WATER DISTRICT STANDARD NOTES
1. NO WORK SHALL BEGIN UNTIL THE WATER PLANS HAVE BEEN RELEASED FOR CONSTRUCTION BY LVVWD. FOLLOWING WATER PLAN APPROVAL, 48 HOUR NOTICE SHALL BE GIVEN TO THE LVVWD COMMUNICATION SUPPORT CENTER (258-7171) PRIOR TO THE START OF CONSTRUCTION. NOTICE MUST BE GIVEN BY 2:00 P.M. THE BUSINESS DAY PRIOR TO AN LVVWD INSPECTION.

CITY OF LAS VEGAS STREET LIGHT NOTE
ALL STREET LIGHT INSTALLATIONS SHALL CONFORM TO THE LATEST ISSUE OF THE STANDARD DETAIL AND SPECIFICATIONS OF THE CITY OF LAS VEGAS, AND SHALL ALSO CONFORM TO THE UNIFORM STANDARD SPECIFICATIONS FOR PUBLIC WORKS' CONSTRUCTION OF OFF-SITE IMPROVEMENTS, CLARK COUNTY AREA, LATEST EDITION, UNLESS OTHERWISE NOTED. ALL HAND HOLE COVERS MUST BE INSTALLED, POLE CAPS POLISHED AND PULL BOX LIDS BOLTED DOWN PRIOR TO ENERGIZING CIRCUIT. ALL WIRE MUST HAVE THW INSULATIONS.

APPROVALS
NEVADA POWER COMPANY DATE 8/19/97
LAS VEGAS VALLEY WATER DISTRICT DATE 6/23/97
CITY OF LAS VEGAS FIRE DEPARTMENT DATE 6/23/97

Call before you dig. 1-800-227-2600
CALL BEFORE YOU DIG OVERHEAD. CALL 1-702-593-6111

Standage & Truitt Engineering, Ltd.
CIVIL ENGINEERING AND SURVEYING
6855 W. CHARLESTON BOULEVARD
LAS VEGAS, NEVADA 89117
PHONE: (702) 255-2950
FAX: (702) 255-3090
REVISIONS:
UTILITY PLAN
NORTHSHORE PROFESSIONAL
OFFICE PLAZA
CITY OF LAS VEGAS
JOB NO.: L97L0009
FILE: 7121U05
DESIGNER: ANR
DRAWN BY: ANR
CHECKED BY: MAC
DATE: 4/30/97
SHEET NO. 7 OF 8
307Y-4534

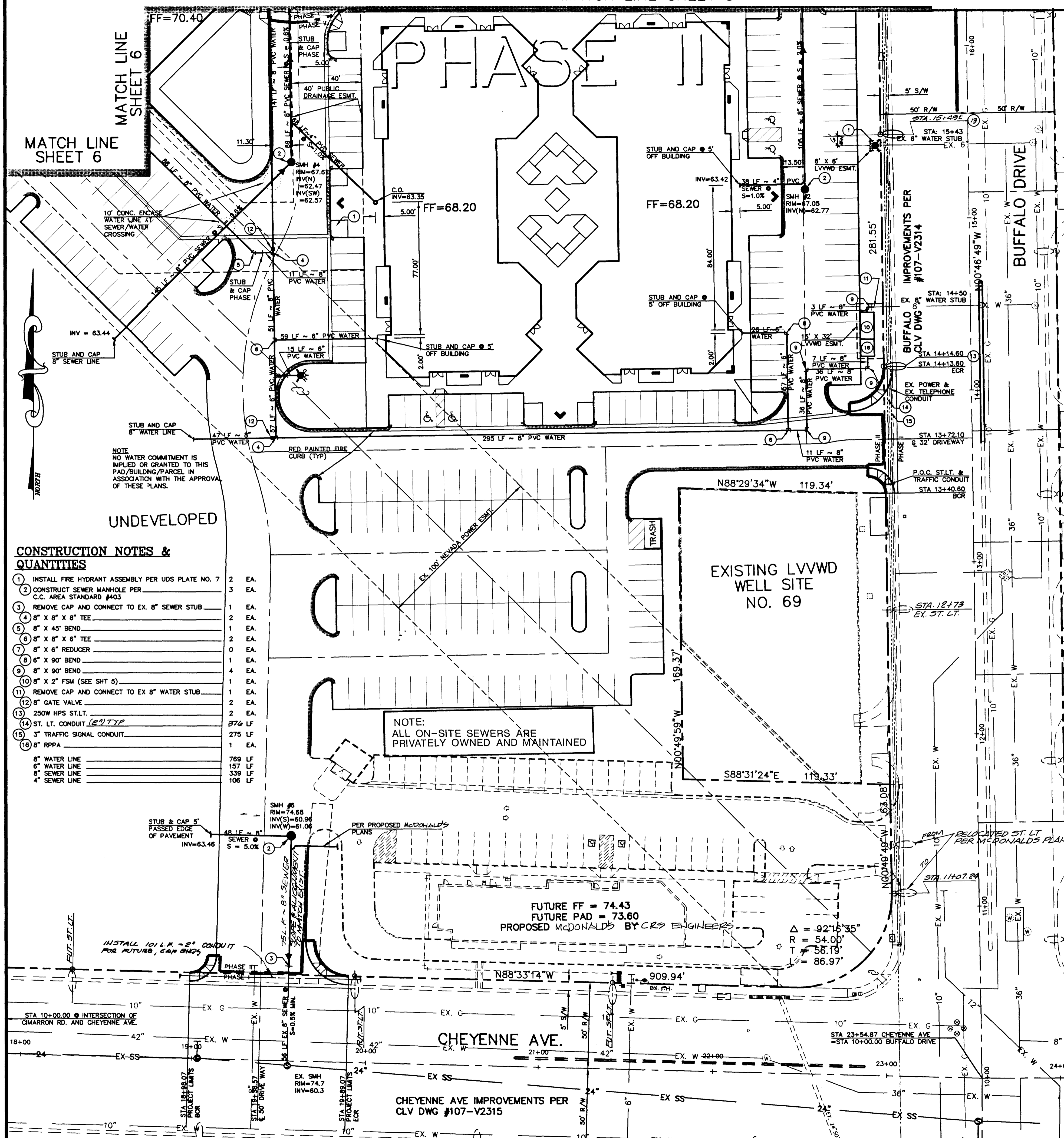

CONSTRUCTION NOTES & QUANTITIES
1. INSTALL FIRE HYDRANT ASSEMBLY PER UDS PLATE NO. 7 2 EA
2. CONSTRUCT SEWER MANHOLE PER C.C. AREA STANDARD #403 3 EA
3. REMOVE CAP AND CONNECT TO EX. 8" SEWER STUB 1 EA
4. 8" x 8" x 8" TEE 2 EA
5. 8" x 45" BEND 1 EA
6. 8" x 8" x 6" TEE 2 EA
7. 8" x 6" REDUCER 0 EA
8. 8" x 90" BEND 1 EA
9. 8" x 90" BEND 4 EA
10. 8" x 2" FSM (SEE SHT 5) 1 EA
11. REMOVE CAP AND CONNECT TO EX. 8" WATER STUB 1 EA
12. 8" GATE VALVE 2 EA
13. 250W HPS ST.L.T. 2 EA
14. ST. LT. CONDUIT (2) TYP 376 LF
15. 3" TRAFFIC SIGNAL CONDUIT 275 LF
16. 8" RPPA 1 EA

NOTE: NO WATER COMMITMENT IS IMPLIED OR GRANTED TO THIS PAD/BUILDING/PARCEL IN ASSOCIATION WITH THE APPROVAL OF THESE PLANS.
NOTE: ALL ON-SITE SEWERS ARE PRIVATELY OWNED AND MAINTAINED.

