

UNDEVELOPED  
 20' CLV PUPAK SEWER EASEMENT  
 20' CLV PUPAK SEWER EASEMENT  
 REMOVE PLUG & CONNECT TO EXIST. 8" WATER MAIN.  
 REMOVE PLUG & CONNECT TO EXIST. 8" WATER MAIN.  
 EX. 8" GV MUST BE IN CLOSED POSITION PRIOR TO REMOVING CAP.  
 NOTE: EXISTING SEWER MAINS INSTALLED WITH MIRA VISTA UNIT-2.

**ESTIMATE OF QUANTITIES**

<b>WATER</b>		
1) STD FIRE HYDRANT	10	EA.
2) 8" GATE VALVE	12	EA.
3) 8" TEE	5	EA.
4) 2" 90° BEND	2	EA.
5) 2" 45° BEND	5	EA.
6) 12" GATE VALVE	1	EA.
7) 2" B.O. ASSEMBLY	1	EA.
8) 1" IRRIGATION SERV. W/ 1" METER (W/PPA)	2	EA.
9) 3/4" WATER SERV. W/ 3/4" METER	140	EA.
12" WATER MAIN	400	LF.
8" WATER MAIN	4,210	LF.
<b>SEWER</b>		
STD. MANHOLE	7	EA.
4" SERVICE LATERALS	3,120	LF.
8" SEWER MAIN	2,705	LF.
WYES	105	EA.
<b>STREETLIGHTS</b>		
250 WATT LUMIN.	3	EA. (PUB. & C)
1 1/4" CONDUIT	4,570	LF.
120 WATT LUMIN.	21	EA. (PUB. & C)
STREET NAME SIGN	15	EA.
8 1/2" PULL BOX	4	EA.

**PROPOSED NORTHSIDE PHASE II**

250 WATT LUMIN.	3	EA. (PUB. & C)
1 1/4" CONDUIT	4,570	LF.
120 WATT LUMIN.	21	EA. (PUB. & C)
STREET NAME SIGN	15	EA.
8 1/2" PULL BOX	4	EA.

**SEWER LATERAL "AS-BUILT" CERTIFICATION**

STEPHEN P. GURLIDES, P.L.S.  
 NEVADA CERT. NO.: 9105

1-22-97

APR 23 1997

NOTE: ALL INTERIOR STREETS ARE PRIVATE STREETS, P.U.E.'S, AND CL.V. SEWER EASEMENTS.

NOTE: ALL INTERIOR STREET LIGHTS ARE PRIVATELY OWNED AND MAINTAINED.

**SEWER CONTRIBUTION**  
 AVERAGE = 21,250 G.P.D.  
 PEAK = 42,000 G.P.D.

**REDUCED PRESSURE PRINCIPLE ASSEMBLY**

Approved Reduced Pressure Principle Assembly shall be installed per the Standard Specification No. 11288. No water shall be taken from a service requiring backflow prevention until the reduced pressure principle assembly has been successfully tested by the LVVWD.

Any backflow or other fence material shall be designed and constructed around the outside of the nonresidential, so as to allow the closest direct access to the vaulted from the adjacent right-of-way.

\* Service laterals for lots 19-36, Block 4

will be topped on existing main by Owner's contractor under direction of the LVVWD.

This property may have static water pressure in excess of 80 psi. The Uniform Plumbing Code requires that individual, on-site pressure-reducing valves be installed whenever the pressure exceeds 80 psi. PRV's are the Developer's responsibility and will not be inspected or included in the acceptance of LVVWD facilities.

**WATER DISTRICT STANDARD NOTES**

- NO WORK SHALL BEGIN UNTIL THE WATER PLANS HAVE BEEN RELEASED FOR CONSTRUCTION BY THE LVVWD. FOLLOWING WATER PLAN APPROVAL, 48 HOUR NOTICE SHALL BE GIVEN TO THE LVVWD CUSTOMER SERVICE DEPARTMENT (870-4194) PRIOR TO THE START OF CONSTRUCTION. NOTICE MUST BE GIVEN BY 2:00 P.M. THE BUSINESS DAY PRIOR TO A LVVWD INSPECTION.
- ALL WORK SHALL CONFORM TO LVVWD STANDARD PLATES, DRAWINGS, AND SPECIFICATIONS, LATEST EDITION.
- ALL WORK, EXCEPT AS MODIFIED BY THESE PLANS OR BY NOTE 2, SHALL BE DONE IN ACCORDANCE WITH THE MOST CURRENT DRAFT OR EDITION OF THE UNIFORM STANDARD SPECIFICATIONS FOR PUBLIC WORKS CONSTRUCTION OFF-SITE IMPROVEMENTS, CLARK COUNTY AREA.
- A SINGLE PIPE MATERIAL SHALL BE USED THROUGHOUT THE PROJECT UNLESS OTHERWISE APPROVED BY THE LVVWD.
- ALL SERVICE LATERALS TWO (2) INCHES IN DIAMETER AND SMALLER SHALL BE COPPER TUBING WITH LVVWD APPROVED SERVICE SADDLES.
- ALL WATER METER BOXES SHALL BE LOCATED OUTSIDE OF DRIVEWAY AREAS.
- ALL VALVES SHALL BE LOCATED OUTSIDE OF DRIVEWAYS, VALLEY AND GUTTERS.
- THE FOLLOWING REQUIREMENTS MUST BE MET IN THE EVENT A WATER LINE AND A SANITARY OR STORM SEWER LINE CROSS:
  - A MINIMUM EIGHTEEN (18) INCH VERTICAL SEPARATION (OUTSIDE TO OUTSIDE) MUST BE MAINTAINED WHEN THE WATER LINE IS INSTALLED OVER THE SANITARY OR STORM SEWER LINE. IF THE VERTICAL SEPARATION CANNOT BE MAINTAINED OR THE WATER LINE MUST BE PLACED UNDER THE SANITARY OR STORM SEWER LINE, THE SANITARY OR STORM SEWER LINE MUST BE CONSTRUCTED WITH ONE OF THE FOLLOWING OR, AS SHOWN ON THESE PLANS:
    - POTABLE WATER SUPPLY QUALITY MATERIAL
    - ENCASEMENT, WITH FOUR (4) INCH CONCRETE (MINIMUM)
    - SLEEVING WITH POTABLE WATER SUPPLY QUALITY PIPE.
- WARNING TAPE SHALL BE REQUIRED OVER ALL MAINS, ALL SIX (6) INCH DIAMETER AND LARGER SERVICE LATERALS, AND ANY SERVICE LATERAL NOT INSTALLED PERPENDICULAR TO THE MAIN IN ACCORDANCE WITH STANDARD PLATE NO. 27.
- ALL WATER FACILITIES SHALL BE FILLED, DISINFECTED, PRESSURE TESTED, FLUSHED, FILLED AND AN ACCEPTABLE WATER SAMPLE OBTAINED PRIOR TO CONNECTION TO THE LVVWD'S DISTRIBUTION SYSTEM.
- THE CONTRACTOR MUST OBTAIN ALL METERS TWO (2) INCHES AND SMALLER FROM LVVWD CENTRAL STORES, TELEPHONE 258-3152 FORTY-EIGHT (48) HOURS PRIOR TO PICKUP.
- CONSTRUCTION MAY INTERRUPT SERVICE, WITH LVVWD APPROVAL AND PROPER NOTIFICATION, BETWEEN THE HOURS OF 10 PM AND 6 AM, SUNDAY THROUGH THURSDAY. CIRCUMSTANCES MAY REQUIRE TEMPORARY SERVICE FEES BE INSTALLED, WITHOUT LVVWD REIMBURSEMENT. ANY TEMPORARY SERVICE FEES MUST HAVE PRIOR LVVWD APPROVAL.
- ALL WATER FACILITY CONSTRUCTION MATERIALS USED MUST BE AS LISTED ON THE LVVWD'S APPROVED MATERIALS AND MANUFACTURERS LISTING FOR NEW FACILITIES, LATEST REVISION, OR SPECIFICALLY APPROVED ON THESE PLANS.

**CITY OF LAS VEGAS SEWER NOTES**

- ALL CONSTRUCTION AND MATERIALS SHALL BE IN ACCORDANCE WITH THE LATEST EDITION OF THE DESIGN AND CONSTRUCTION STANDARDS FOR WASTEWATER COLLECTION SYSTEMS AND THE UNIFORM STANDARD SPECIFICATIONS FOR PUBLIC WORKS CONSTRUCTION OFF-SITE IMPROVEMENTS, CLARK COUNTY AREA, NEVADA, AS AMENDED. IN ALL CASES, THESE STANDARDS SHALL SUPERSEDE THE UNIFORM STANDARD SPECIFICATIONS. IT WILL BE THE RESPONSIBILITY OF THE CONTRACTOR TO BE AWARE OF THE CONTENTS OF THE ABOVE SPECIFICATION BOOKS.
- IT SHALL BE THE CONTRACTOR'S RESPONSIBILITY TO PERFORM CONSTRUCTION AS PER PLANS. ANY ADDITIONS, DELETIONS, OR CHANGES SHALL FIRST MEET WITH THE APPROVAL OF THE CONTROLLING AGENCY UNDER THE CURB.
- CHISEL "S" OR "C" IN CURBS WHERE SEWER OR GAS LATERALS PASS UNDER THE CURB.
- POLYVINYL (PVC) SEWER PIPE SHALL MEET ASTM D-3034 SDR 35 SPECIFICATIONS, INSTALLED WITH SAND BEDDING AND BACKFILL OF TYPE II GRAVEL.
- ALL MANHOLES IN PAVED STREETS 80' R/W AND LARGER, SHALL HAVE CONCRETE COLLARS.
- TEE SADDLES SHALL BE USED TO CONNECT SEWER LATERALS TO EXISTING MAIN LINES UP TO 12" DIA. SIZE. CONNECTIONS TO 15" OR LARGER MAINS SHALL REQUIRE SPECIAL PROCEDURES.
- A SEWER MAIN CROSSING OVER A WATER MAIN OR LESS THAN 18" UNDER A WATER MAIN, MUST BE REINFORCED CONCRETE ENCASED FOR A DISTANCE NOT LESS THAN TEN FEET (10') TO EACH SIDE OF THE CENTERLINE OF THE WATER MAIN.
- ALL CONTRACTORS INSTALLING SEWER MAINS THAT WILL BE UNDER THE JURISDICTION OF THE CONTROLLING AGENCY MUST BE CLASS "A" CONTRACTORS.
- THE CITY OF LAS VEGAS WILL NOT ACCEPT ANY SEWER MAINS WHICH HAVE A VERTICAL DEFLECTION OF MORE THAN ONE TENTH (0.1) OF A FOOT FROM THE APPROVED CONSTRUCTION PLANS. SEWER MAINS FOUND TO EXCEED THIS TOLERANCE WILL HAVE TO BE REPAIRED OR REMOVED AND REPLACED TO THE SATISFACTION OF THE CITY ENGINEER PRIOR TO ACCEPTANCE BY THE CITY.

**LAS VEGAS FIRE DEPARTMENT**

FIRE FLOW REQUIREMENT IS 1500 GALLONS/MIN. AT 20 LBS./SQ. IN. RESIDUAL.

BASED ON:  
 SQUARE FOOTAGE: 1510  
 LARGEST AREA BETWEEN SEPARATION WALLS: N/A  
 HEIGHT: 2 STORY  
 TYPE OF CONSTRUCTION: I-NR  
 EXPOSURES: N/A  
 SPRINKLER SYSTEM: N/A  
 OCCUPANCY: SFR  
 ROOF CONSTRUCTION: CERAMIC TILE

REVIEWED BY:  
 DATE:  
 PROVIDE FIRE LANE IDENTIFICATION PER CITY ORD. 3677

APPROVAL:  
 LAS VEGAS VALLEY WATER DISTRICT  
 DATE: 4/25/94

CITY OF LAS VEGAS FIRE MARSHALL  
 DATE: 12-3-94

NEVADA POWER COMPANY  
 DATE: 12-1-94

NEVADA POWER COMPANY APPROVAL IS ONLY FOR THE PLACEMENT AND CLEARANCE OF STREET LIGHT AND SIGNAL LIGHT INSTALLATION.

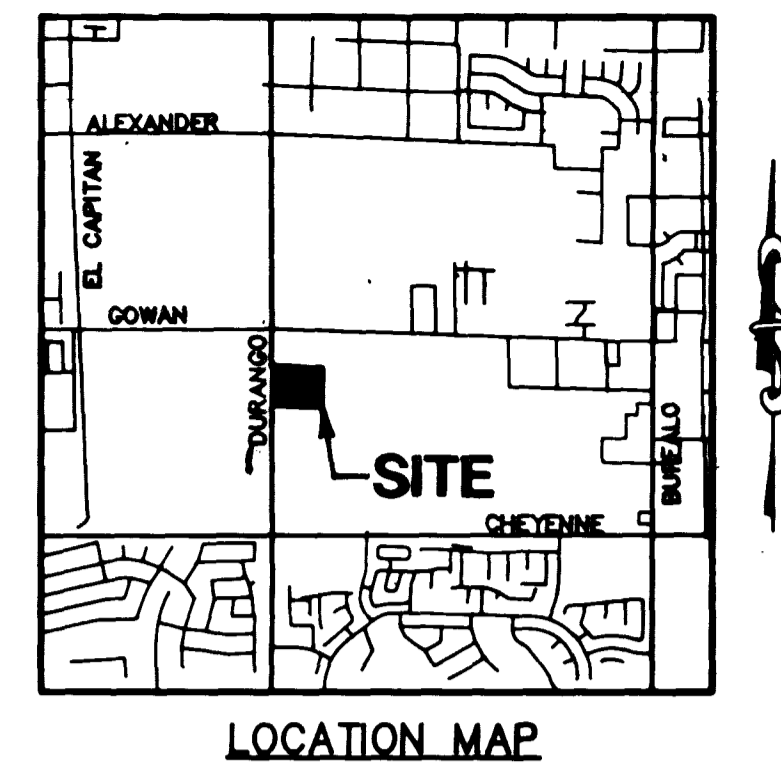

**COLLINS BROTHERS CORP.**  
 CITY OF LAS VEGAS  
 CONSULTING ENGINEERS • PLANNERS • LAND SURVEYORS  
 2727 SOUTH RAINBOW BOULEVARD  
 LAS VEGAS, NEVADA 89102-5148 PHONE (702) 873-7550 FAX (702) 362-2597

DATE: 4/20/94  
 BY: TCR  
 REVISION: CHANGED SHADON LAKE ST. TO RED AVENUE ST.

**SEWER LATERAL AS-BUILT**  
**MIRA VISTA**  
**UNIT 1**

PROFESSIONAL ENGINEER  
 DARRIN PETERSEN  
 CIVIL  
 No. 10651  
 State of Nevada

NO. 4630-1  
 BY: DLEWJR  
 DATE: 11/94  
 SCALE: T=40'  
 SHEET: 4 OF 8 SHEETS

**BENCHMARK**  
 CLV BM # 0LV0017NES  
 RIVET AND PLATE IN TOP OF CURB, SOUTHWEST  
 RETURN OF CHEYENNE AVENUE AND RAMPART BLVD.  
 ELEVATION = 2448.333'

Call before you Dig  
 1-800-227-8800

PROJECT NAME: MIRA VISTA UNIT 1  
 This project water plan complies with the Las Vegas Valley Water District's technical requirements. However, this water plan is NOT APPROVED FOR CONSTRUCTION at this time and this signature does not provide or imply a water commitment.

DATE: 4/25/94

"AS BUILT"  
 207V-4370-1

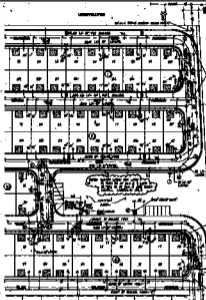

**GENERAL NOTES**

1. ALL WORK SHALL BE IN ACCORDANCE WITH THE LATEST EDITIONS OF THE BUREAU OF STANDARDS SPECIFICATIONS FOR CONSTRUCTION.

2. THE CONTRACTOR SHALL BE RESPONSIBLE FOR OBTAINING ALL NECESSARY PERMITS AND APPROVALS FROM THE LOCAL AUTHORITIES.

3. THE CONTRACTOR SHALL MAINTAIN ACCESS TO ALL ADJACENT PROPERTIES AT ALL TIMES.

4. ALL MATERIALS AND WORKMANSHIP SHALL BE SUBJECT TO INSPECTION AND APPROVAL BY THE ARCHITECT.

5. THE CONTRACTOR SHALL BE RESPONSIBLE FOR PROTECTING ALL EXISTING UTILITIES AND STRUCTURES.

6. ALL DIMENSIONS SHALL BE AS SHOWN UNLESS OTHERWISE NOTED.

7. THE CONTRACTOR SHALL MAINTAIN A NEAT AND ORDERLY WORK SITE AT ALL TIMES.

8. ALL WORK SHALL BE COMPLETED WITHIN THE SPECIFIED TIME FRAME.

9. THE CONTRACTOR SHALL BE RESPONSIBLE FOR OBTAINING ALL NECESSARY INSURANCE COVERAGE.

10. ALL COSTS OF PROTECTION AND RESTORATION SHALL BE THE RESPONSIBILITY OF THE CONTRACTOR.



**NOTES:**

1. ALL WORK SHALL BE IN ACCORDANCE WITH THE LATEST EDITIONS OF THE BUREAU OF STANDARDS SPECIFICATIONS FOR CONSTRUCTION.

2. THE CONTRACTOR SHALL BE RESPONSIBLE FOR OBTAINING ALL NECESSARY PERMITS AND APPROVALS FROM THE LOCAL AUTHORITIES.

**GENERAL NOTES**

1. ALL WORK SHALL BE IN ACCORDANCE WITH THE LATEST EDITIONS OF THE BUREAU OF STANDARDS SPECIFICATIONS FOR CONSTRUCTION.

2. THE CONTRACTOR SHALL BE RESPONSIBLE FOR OBTAINING ALL NECESSARY PERMITS AND APPROVALS FROM THE LOCAL AUTHORITIES.

**GENERAL NOTES**

1. ALL WORK SHALL BE IN ACCORDANCE WITH THE LATEST EDITIONS OF THE BUREAU OF STANDARDS SPECIFICATIONS FOR CONSTRUCTION.

2. THE CONTRACTOR SHALL BE RESPONSIBLE FOR OBTAINING ALL NECESSARY PERMITS AND APPROVALS FROM THE LOCAL AUTHORITIES.



**GENERAL NOTES**

1. ALL WORK SHALL BE IN ACCORDANCE WITH THE LATEST EDITIONS OF THE BUREAU OF STANDARDS SPECIFICATIONS FOR CONSTRUCTION.

2. THE CONTRACTOR SHALL BE RESPONSIBLE FOR OBTAINING ALL NECESSARY PERMITS AND APPROVALS FROM THE LOCAL AUTHORITIES.

**GENERAL NOTES**

1. ALL WORK SHALL BE IN ACCORDANCE WITH THE LATEST EDITIONS OF THE BUREAU OF STANDARDS SPECIFICATIONS FOR CONSTRUCTION.

2. THE CONTRACTOR SHALL BE RESPONSIBLE FOR OBTAINING ALL NECESSARY PERMITS AND APPROVALS FROM THE LOCAL AUTHORITIES.

**GENERAL NOTES**

1. ALL WORK SHALL BE IN ACCORDANCE WITH THE LATEST EDITIONS OF THE BUREAU OF STANDARDS SPECIFICATIONS FOR CONSTRUCTION.

2. THE CONTRACTOR SHALL BE RESPONSIBLE FOR OBTAINING ALL NECESSARY PERMITS AND APPROVALS FROM THE LOCAL AUTHORITIES.

**APPROVALS:**

Architect: \_\_\_\_\_

Contractor: \_\_\_\_\_

**DATE:** \_\_\_\_\_

**PROJECT:** \_\_\_\_\_

**LOCATION:** \_\_\_\_\_

**SCALE:** \_\_\_\_\_

**NO. OF SHEETS:** \_\_\_\_\_

**SHEET NO.:** \_\_\_\_\_

Call before you dig

800-4-A-DIG

1-800-4-A-DIG