

NOTES:
 1. FINAL A.C. PAVEMENT SURFACE SHALL BE 1/2" ABOVE LIP OF GUTTER.
 2. STRUCTURAL SECTION SHOWN IS BASED ON AN "R" VALUE OF 20. OTHER STRUCTURAL SECTIONS MAY BE APPROVED IF BASED ON ENGINEERING ANALYSIS BASED ON "R" OR "CBR" VALUES DETERMINED BY SOIL TESTING. IN NO CASE SHALL THE A.C. THICKNESS BE LESS THAN SHOWN.

TYPICAL SECTION LOOKING NORTH
N.T.S.

LEGEND

- FG FINISH GRADE
- ===== PROPOSED ASPHALT
- EXISTING CURB, GUTTER, SIDEWALK
- ===== PROPOSED ROLL TYPE CURB, GUTTER, & SIDEWALK
- CENTERLINE
- RADIUS LINES
- FLOW LINE

PAVING QUANTITY ESTIMATE

2" AC PAVEMENT	1180 S.Y.
24" ROLL CURB & GUTTER	584 L.F.
5" CONCRETE SIDEWALK	2925 S.F.
8" VALLEY GUTTER	664 S.F.
TYPE I AGGREGATE	300 C.Y.
TYPE II AGGREGATE	130 C.Y.

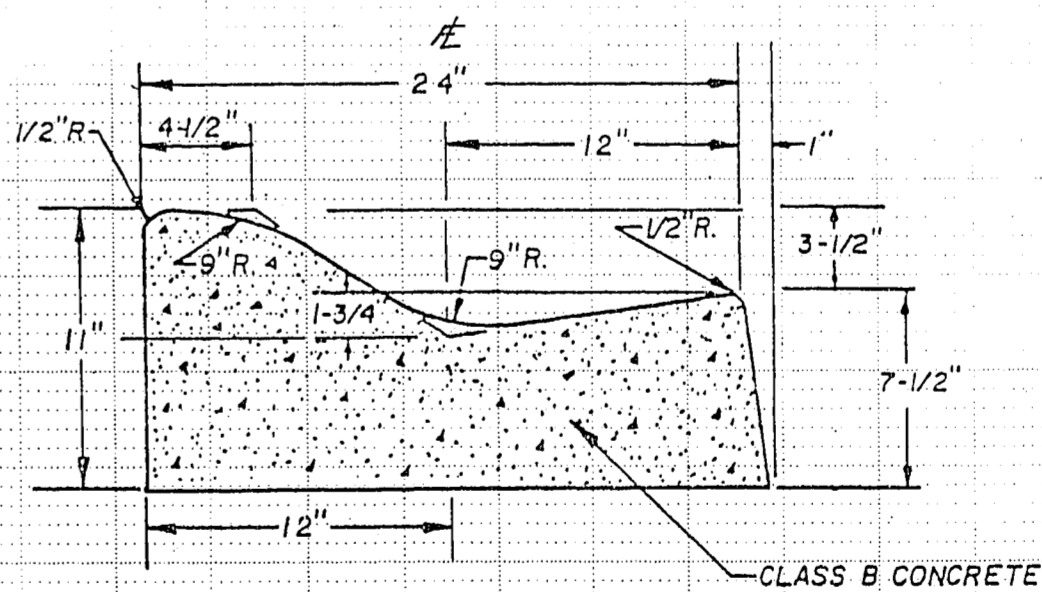

TYPICAL ROLL CURB & GUTTER

James N. Ward

OWNER & DEVELOPER
 EQUIGROUP, INC.
 5100 Wiley Post Way
 Salt Lake City, Utah 84116
 (801) 532-2520

JADE PARK UNIT NO. 7
TOUCHSTONE COURT
 STREET PLAN & PROFILE

J.N.Ward & Associates
 555 EAST SOUTH TEMPLE
 SALT LAKE CITY, UTAH 84102
 (801) 521-4000

Design: _____
 Drawn: R.P.E.
 Checked: _____
 Reviewed: _____

Rev.	By	Date	Remarks	Date	Proj. #	Sht	of
				JAN. 1989	1141	4	5

107-077 107-1861-7

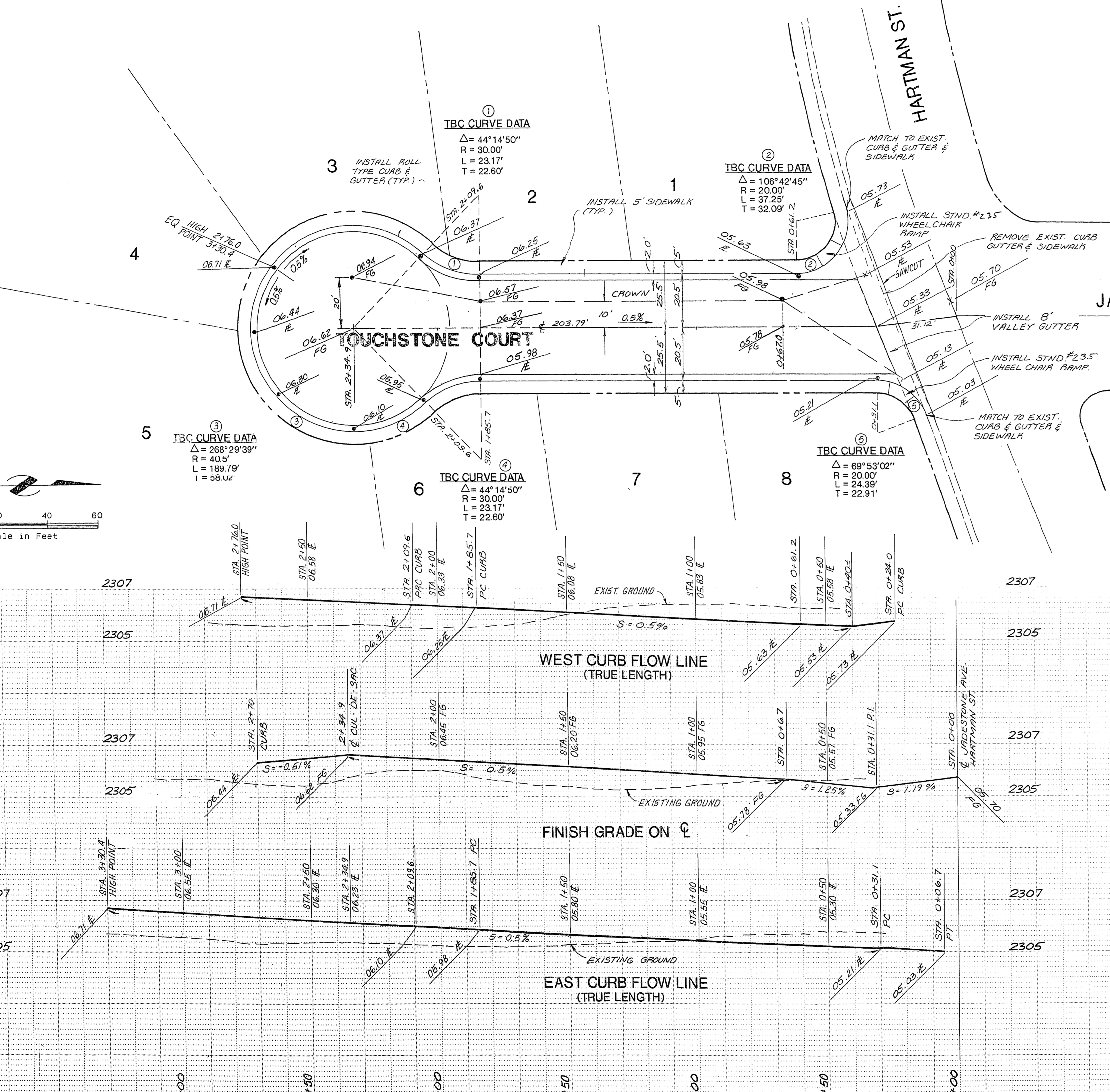

① TBC CURVE DATA
 $\Delta = 44^\circ 14' 50''$
 $R = 30.00'$
 $L = 23.17'$
 $T = 22.60'$

② TBC CURVE DATA
 $\Delta = 106^\circ 42' 45''$
 $R = 20.00'$
 $L = 37.25'$
 $T = 32.09'$

③ TBC CURVE DATA
 $\Delta = 268^\circ 29' 39''$
 $R = 40.5'$
 $L = 189.79'$
 $T = 58.02'$

④ TBC CURVE DATA
 $\Delta = 44^\circ 14' 50''$
 $R = 30.00'$
 $L = 23.17'$
 $T = 22.60'$

⑤ TBC CURVE DATA
 $\Delta = 69^\circ 53' 02''$
 $R = 20.00'$
 $L = 24.39'$
 $T = 22.91'$