

# LAKESIDE CONDOMINIUMS NO. 2

A RESIDENTIAL PLANNED DEVELOPMENT FOR CONDOMINIUM PURPOSES  
SITUATED IN THE SOUTHWEST QUARTER (SW1/4) OF SECTION 8, T 21 S, R 60 E  
M.D.M., CITY OF LAS VEGAS, CLARK COUNTY, NEVADA

BEING A SUBDIVISION OF A PORTION OF LOT 1 AS SHOWN BY MAP THEREOF ON FILE IN FILE 47, PAGE 79  
OF PARCEL MAPS IN THE OFFICE OF THE COUNTY RECORDER, CLARK COUNTY NEVADA.

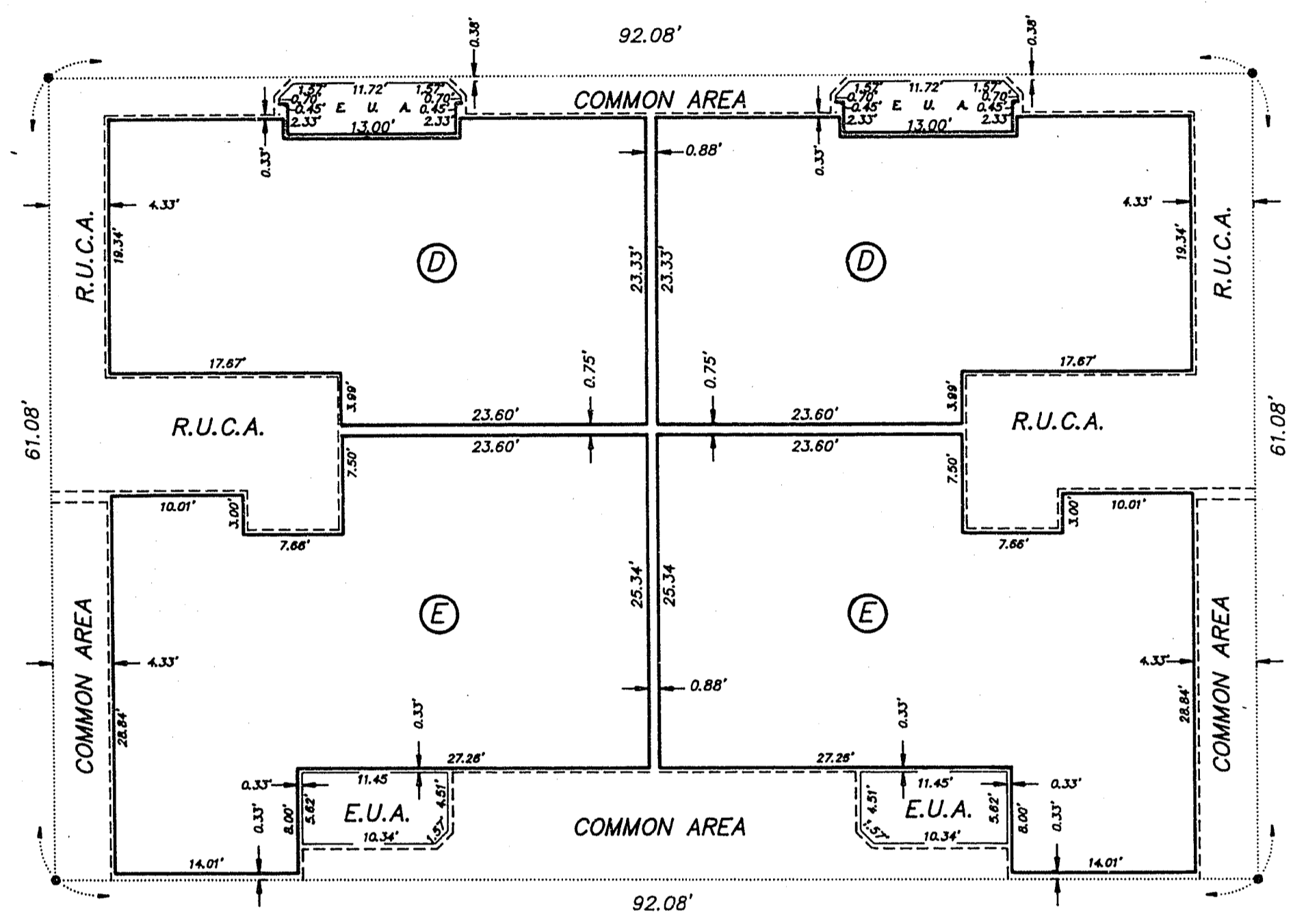

BUILDING TYPE III - SECOND FLOOR

SCALE: 1" = 10'

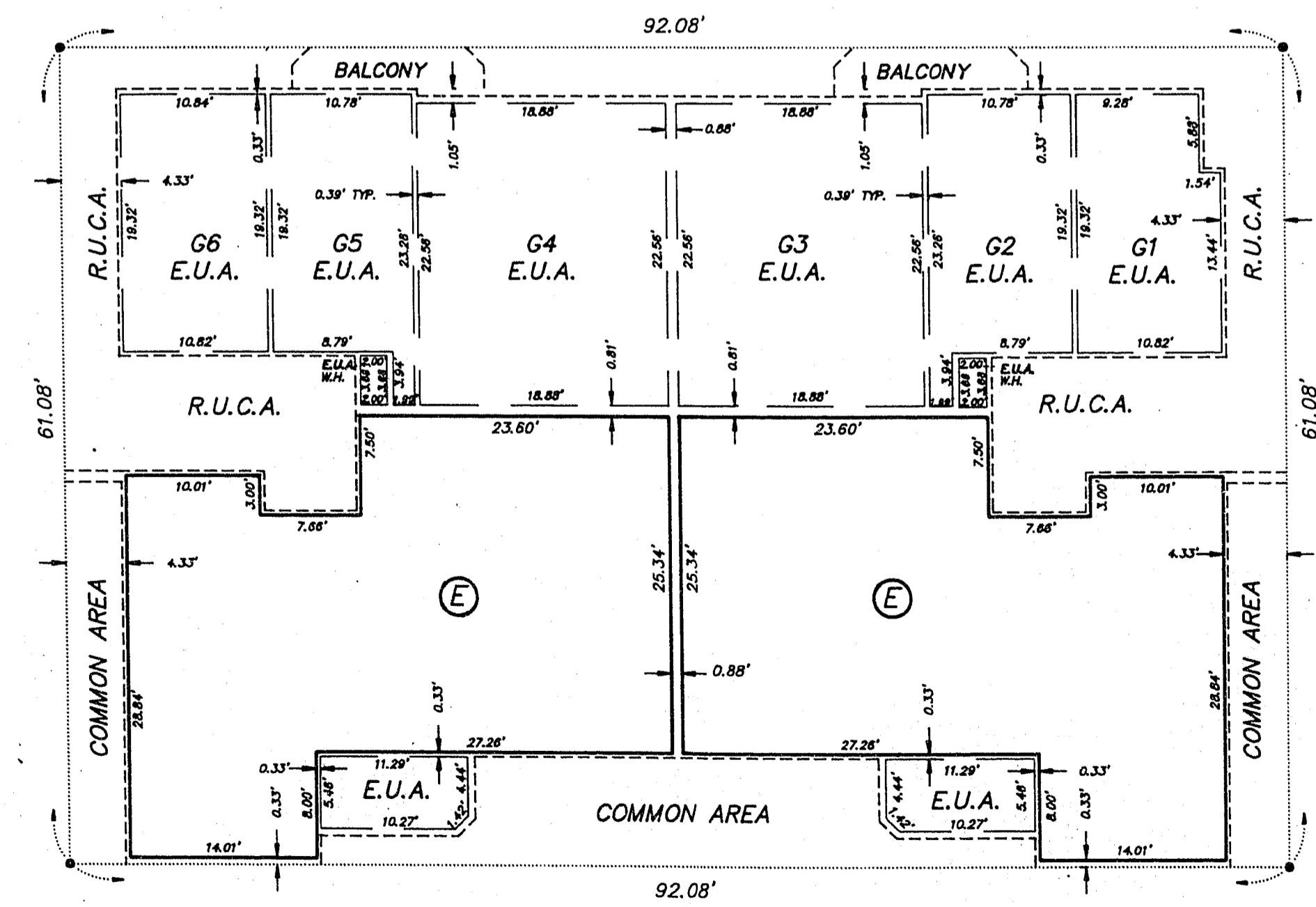

BUILDING TYPE III - FIRST FLOOR

SCALE: 1" = 10'

TYPICAL FOR BUILDINGS 30,32,36,41