

MONUMENT SIGN PLAN

1/4" = 1'-0"

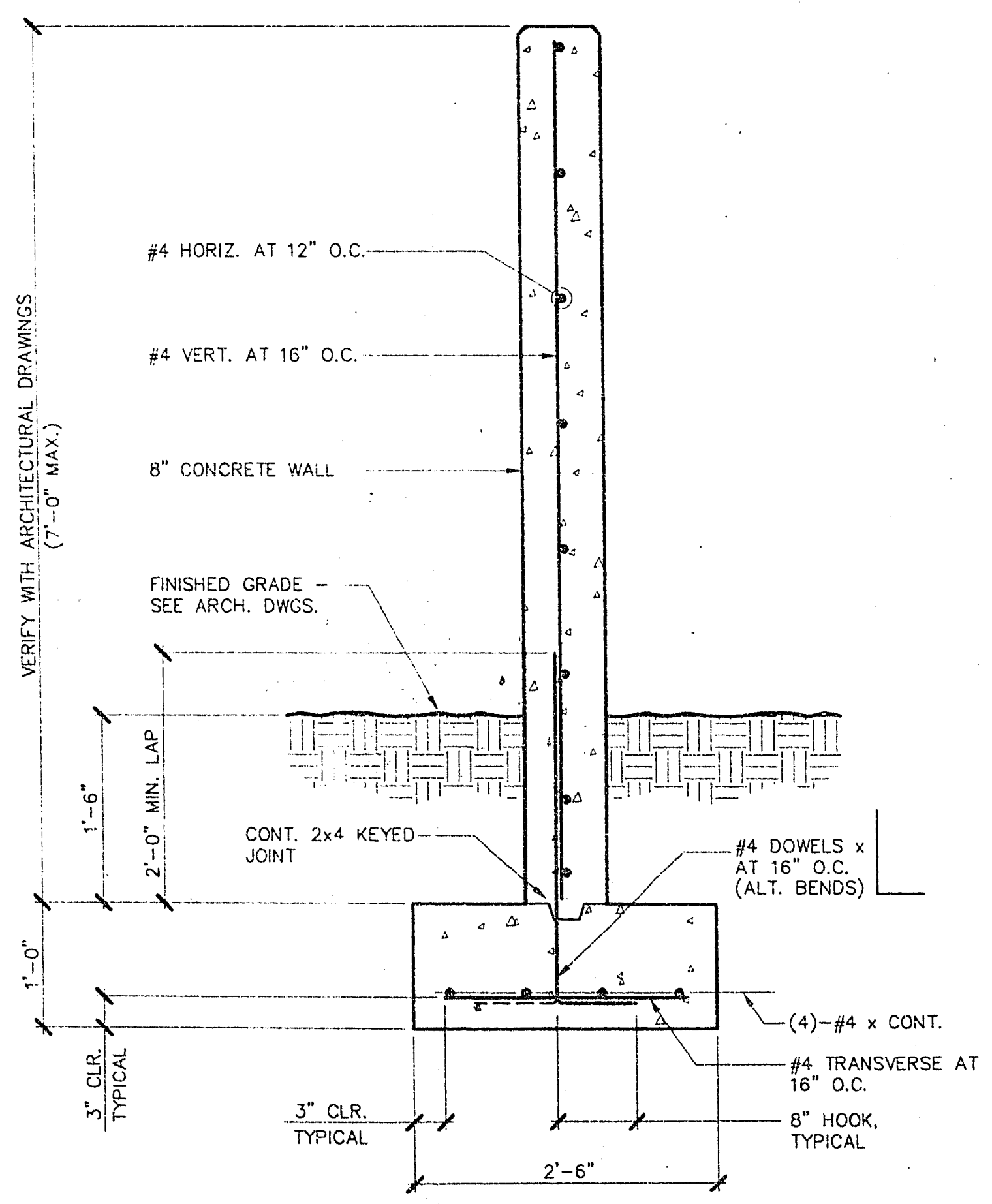

(B) WALL SECTION

1" = 1'-0"

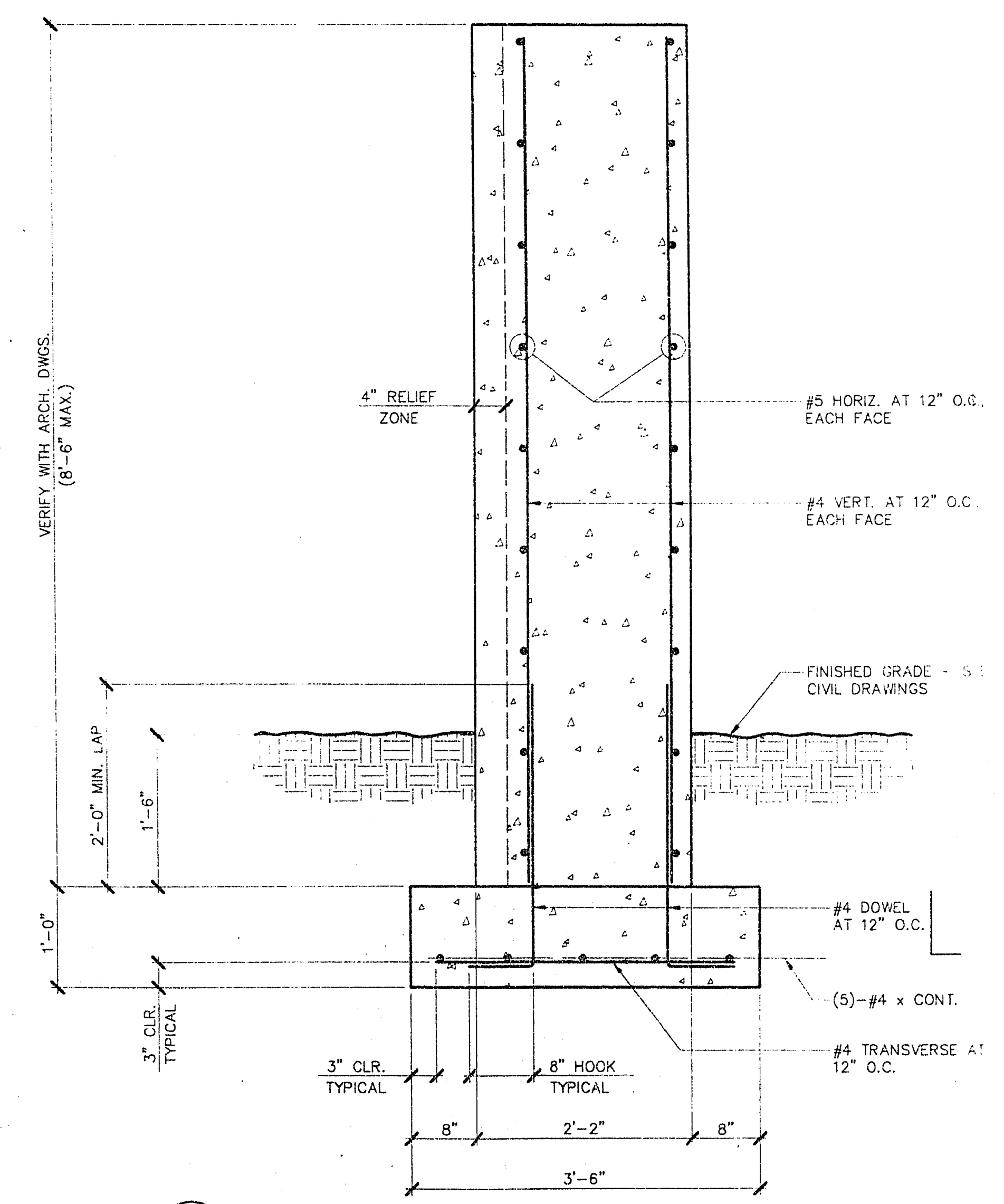

(A) WALL SECTION

1" = 1'-0"

REVISIONS			
REV	DESCRIPTION	DATE	BY

© DOMINGO CAMBEIRO CORPORATION 1994

**R. L. BALOGH**  
 CONSULTING ENGINEERS, INC.  
 8080 West Sahara Avenue, Suite B  
 Las Vegas, Nevada 89117  
 (702) 363-6104 FAX (702) 363-8905

DO NOT SCALE DRAWINGS

All designs, arrangements and plans indicated or presented by this drawing as instruments of service, are prepared by and the property of DOMINGO CAMBEIRO CORPORATION. The plans and specifications shall be restricted to the original site in which they were prepared and publication hereafter is expressly limited to such use. Reproduction, publication or re-use by any method in whole or in part, is prohibited. None of such designs, arrangements or plans shall be used, or disclosed to any person, firm, company or other entity without the written permission of DOMINGO CAMBEIRO CORPORATION. Visual contact with these plans and specifications shall constitute prima facie evidence of acceptance of these restrictions.

DRAWN BY	CPD
CHECKED BY	RLB
ISSUED DATE	FEBRUARY 1994

FOUNDATION PLAN FOR MONUMENT SIGN AND DETAILS

**LAS VEGAS TECHNOLOGY CENTER**  
 OPEN SPACES AND ENTRY FEATURES, PHASE II AND III

*Domingo Cambeiro Corporation*

ARCHITECTURE • ENGINEERING • PLANNING • INTERIORS

3555 PECOS-McLEOD IC. LAS VEGAS, NEVADA 89121-3805 (702) 732-0084

SHEET NO.	92.03
JOB NO.	93017-23
FILE NO.	93017

530-VU

"AS-BUILT"