

20-47

REVISIONS			
REV	DESCRIPTION	DATE	BY

© DOMINGO CAMBEIRO CORPORATION 1994

DO NOT SCALE DRAWINGS

All designs, arrangements and plans indicated or presented by this drawing, as instruments of service, are owned by and the property of DOMINGO CAMBEIRO CORPORATION. The plans and/or specifications shall be restricted to the original site for which they were prepared and publication therefore is expressly limited to such use. Reproduction, publication or re-use by any method in whole or in part, is prohibited. None of such designs, arrangements or plans shall be used by or disclosed to any person, firm, agency, or corporation without the written permission of DOMINGO CAMBEIRO CORPORATION. Visual contact with these plans and specifications shall constitute prima facie evidence of acceptance of these restrictions.

SEAL
DRAWN BY
CHECKED BY
ISSUED DATE FEBRUARY, 1994

ARCHITECTURAL
SITE PLAN
EAST

Domingo Cambeiro Corporation
ARCHITECTURE • ENGINEERING • PLANNING • INTERIORS
LAS VEGAS, NEVADA 89121-3805
3555 PECOS-McLEOD IC.

PROJECT
LAS VEGAS TECHNOLOGY CENTER
OPEN SPACES AND ENTRY FEATURES,
PHASES II AND III

SHEET NO. AS1.01
JOB NO. 93197 FILE NO. 9197AS01.DWG 530-VJW

AS-BUILT

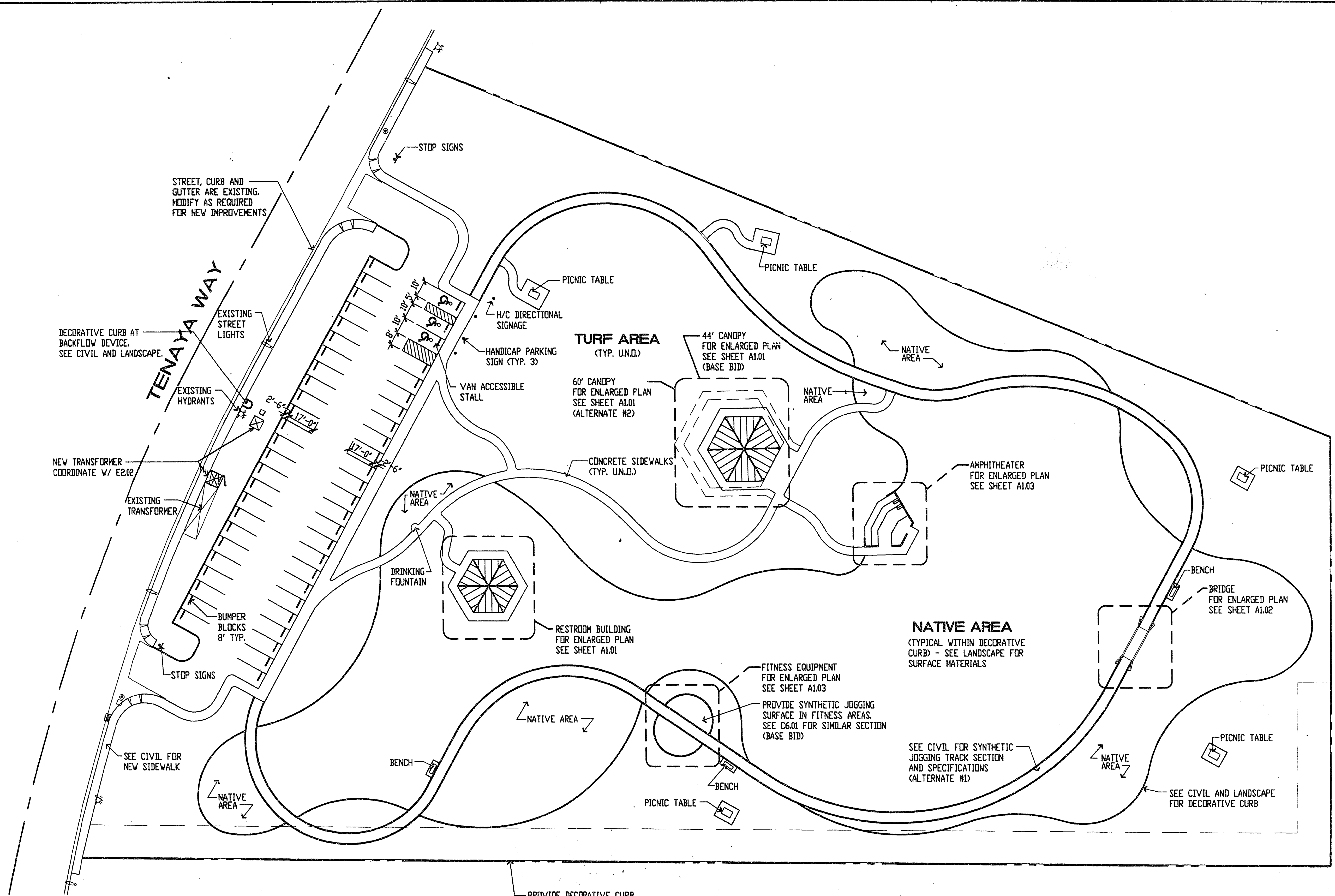

SITE PLAN (EAST)
SCALE: 1"=30'-0"



GENERAL NOTES

- FOR PARK BENCH, PICNIC TABLE, TRASH RECEPTACLES AND EXERCISE EQUIPMENT SEE SPECIFICATION SECTION 11000.
- ALL PARKING SPACES 10' WIDE BY 20' LONG. PROVIDE 5' WIDE AND 8' WIDE HANDICAP ACCESS AISLES AS SHOWN IN EACH PARKING LOT.
- PROVIDE HANDICAP PARKING SIGNS AT ALL HANDICAP STALLS. SIGNS SHALL CONFORM TO ANSI A117.1-86 AND CONTAIN TEXT AS REQUIRED UNDER STATE AND MUNICIPAL STATUTES. MOUNT BOTTOM OF SIGN AT 7'-2" ABOVE GRADE. PROVIDE "VAN ACCESSIBLE" SIGN AT DESIGNATED VAN ACCESSIBLE STALL.
- PROVIDE CONCRETE PARKING BUMPERS AS SHOWN. SEE CIVIL.

STREET, CURB AND GUTTER ARE EXISTING. MODIFY AS REQUIRED FOR NEW IMPROVEMENTS

DECORATIVE CURB AT BACKFLOW DEVICE. SEE CIVIL AND LANDSCAPE.

NEW TRANSFORMER COORDINATE W/ E2.02

SEE CIVIL FOR NEW SIDEWALK

PROVIDE DECORATIVE CURB @ PERIMETER - TYP. SEE CIVIL AND LANDSCAPE DRAWINGS

TURF AREA (TYP. UN.D.)

NATIVE AREA (TYPICAL WITHIN DECORATIVE CURB) - SEE LANDSCAPE FOR SURFACE MATERIALS

SEE CIVIL FOR SYNTHETIC JOGGING TRACK SECTION AND SPECIFICATIONS (ALTERNATE #1)

SEE CIVIL AND LANDSCAPE FOR DECORATIVE CURB