

**PAVING NOTE**

ONSITE PAVING SECTION TO BE AS FOLLOWS:  
 2" ASPHALT CONCRETE ON 6" TYPE II AGGREGATE  
 BASE ON 6" RECOMPACTED NATIVE. SEE SOILS REPORT

**ENGINEER'S CERTIFICATE**

I CERTIFY THAT THIS GRADING PLAN IS IN CONFORMANCE WITH THE APPROVED DRAINAGE STUDY ON FILE AT THE CITY OF LAS VEGAS

FOR THIS PROJECT, Edward F. Taney DATE 12-30-98  
 EDWARD F. TANEY, No. 9903

**GRAPHIC SCALE**

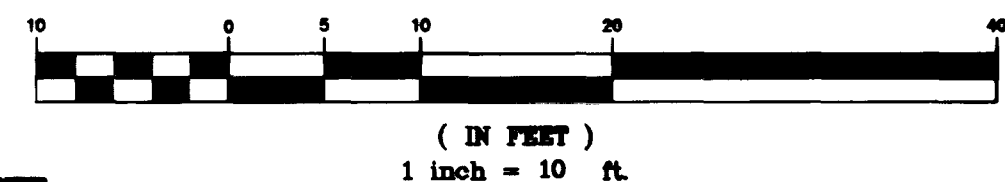

**BASIS OF BEARINGS**

THE NORTH LINE OF THE NE 1/4 OF THE SW 1/4 OF SECTION 22, T20S, R60E, M.D.M., AS SHOWN ON THE AMENDED PARCEL MAP RECORDED IN FILE 78, PAGE 12 OF PARCEL MAPS ON FILE IN THE CLARK COUNTY RECORDERS OFFICE, SAID BEARING BEING S89°19'53"E

**LEGAL DESCRIPTION**

BEING A PORTION OF THE NORTHEAST 1/4 OF THE NORTHEAST 1/4 OF THE SOUTHWEST 1/4 OF SECTION 22, TOWNSHIP 20 S, RANGE 60 EAST, MDM, CLARK COUNTY NEVADA

**BENCHMARK**

CITY OF LAS VEGAS VERTICLE CONTROL BENCHMARK NO. CLV0022E6 RIVET & PLATE IN TOP OF CURB ON LAKE MEAD BLVD. 400' WEST OF ROCK SPRINGS DRIVE, NORTH CURB LINE, ELEVATION 2368.48 (NORTH AMERICAN VERTICAL DATUM)

**VICINITY MAP**

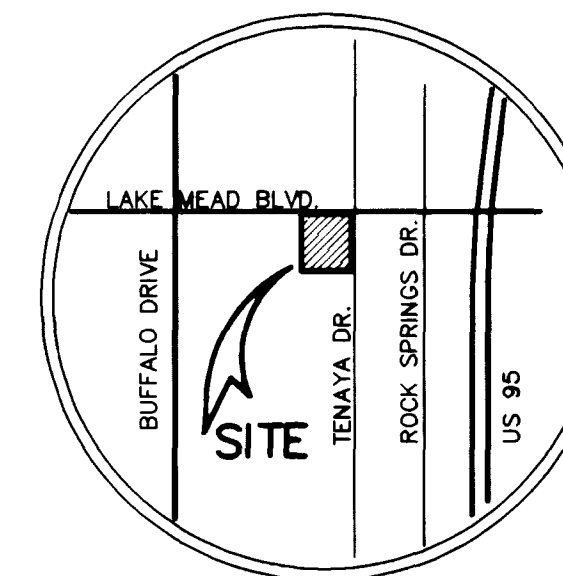

**LEGEND**

- RETAINING/SCREEN WALL
- EXIST. BLOCK WALL
- EXISTING IMPROVEMENTS
- INTERMEDIATE CONTOUR
- PROPOSED CONTOUR
- SCARP
- SWALE
- SETBACK LINE
- EDGE OF PAVEMENT
- FINISHED FLOOR
- FINISHED GRADE
- FLOW LINE
- TOP OF CURB
- TOP OF FOOTING
- TOP RETAINING WALL
- NOT INCORPORATED
- BEGIN CURB RETURN
- HC ACCESS ROUTE
- SLOPES NOT TO EXCEED 2% CROSS/5% LONGITUDE

**NOTE: DESTINATION SPA RESORT IS PART OF THE APPROVED COMMERCIAL SUBDIVISION "LAKE MEAD PAVILION" CLV #107-V2789**

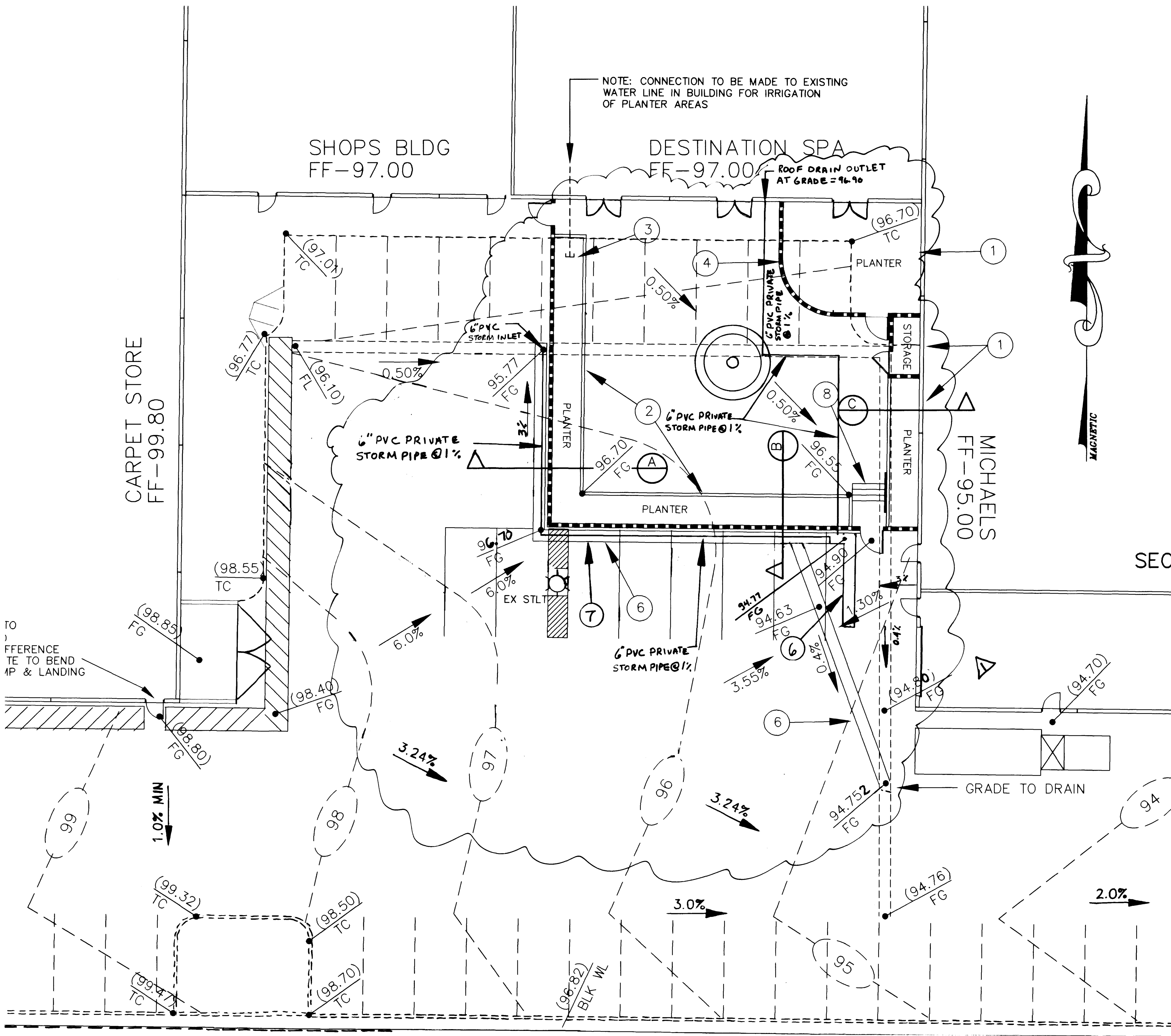

**CONSTRUCTION NOTES**

1. INSTALL PARASEAL HOPE/BENTONITE SHEET MEMBRANE AGAINST MICHAELS WALL FOR WATER PROOFING OF PROPOSED PLANTER AND STORAGE AREAS. NOTE: MICHAELS IS 2 FEET LOWER THAN PROPOSED PATIO.
2. INSTALL 6" WIDE CONCRETE EDGING
3. INSTALL ANTI-SIPHON VALVE FOR PATIO IRRIGATION
4. CONSTRUCT 8' CMU SCREEN WALL PER CLV STANDARDS
5. CONSTRUCT 10' CMU SCREEN WALL PER CLV STANDARDS
6. INSTALL "L" TYPE CURB & GUTTER
7. ASPHALT PAVING SAWCUT LINE
8. INSTALL CONG STEPS AND HANDRAIL

**GRADING NOTES**

1. ALL GRADES SHOWN ARE .3 FEET BELOW ROUGH GRADE TO ALLOW FOR LANDSCAPING; EXCEPT TC, FL, AND FG, WHICH ARE TO FINISH GRADE.
2. FINAL GRADES ADJACENT TO STRUCTURE AFTER LANDSCAPING SHALL BE 0.7 FEET BELOW FINISH FLOOR.
3. THE QUANTITIES SHOWN ARE ESTIMATES ONLY AND ARE NOT TO BE USED FOR BIDDING PURPOSES.
4. THE CONTRACTOR SHALL VERIFY ALL CONDITIONS AND DIMENSIONS AND REPORT ALL DISCREPANCIES TO THE ENGINEER BEFORE BEGINNING WORK.
5. PAD ELEVATION IS TO BE 0.80 FEET BELOW FINISH FLOOR.
6. ALL IMPROVEMENTS TO BE PROTECTED FROM EROSION.
7. ALL SLOPES ARE TO BE TWO FEET HORIZONTAL TO ONE FOOT VERTICAL UNLESS OTHERWISE NOTED.
8. SEE FINAL MAP FOR EXACT BEARINGS AND DISTANCES.
9. SEE PLAN AND PROFILE AND DETAIL SHEETS FOR STREET SECTIONS AND DETAILS.
10. ALL WORK PERFORMED OUTSIDE OF THE PROJECT BOUNDARY AND ON PRIVATE PROPERTY SHALL NOT BE PERFORMED UNTIL WRITTEN PERMISSION AND EASEMENT HAVE BEEN OBTAINED FROM THE OFFSITE OWNER.
11. ALL WORK PERFORMED WITHIN PUBLIC RIGHT OF WAY AND OUTSIDE OF THE PROJECT BOUNDARY SHALL BE PERFORMED UNDER A SEPARATE ENCROACHMENT PERMIT ISSUED BY THE CONTROLLING AUTHORITY.

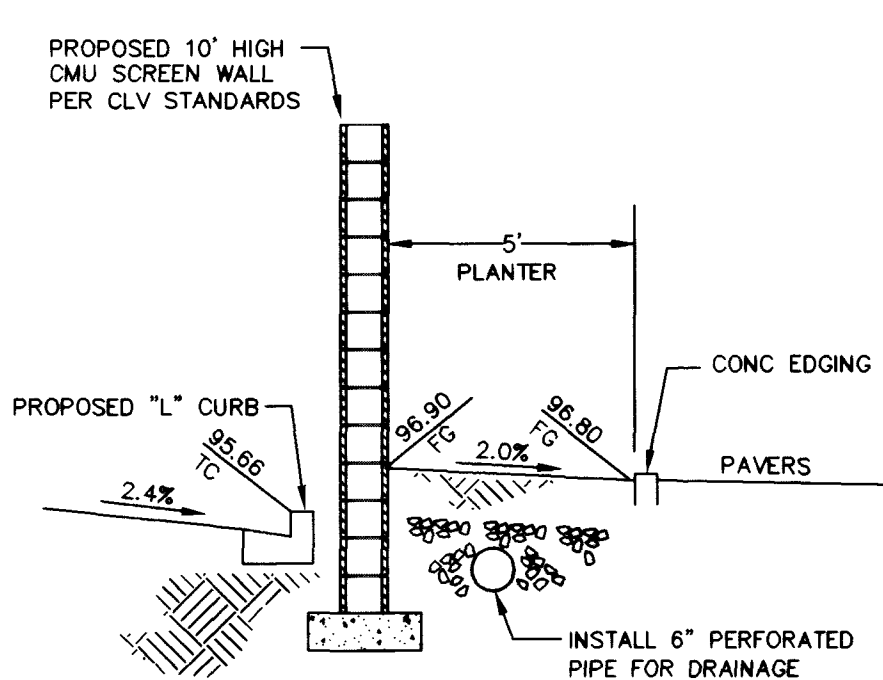

SECTION A CROSS SECTION

**CONSTRUCTION QUANTITIES**

EXISTING PAVEMENT TO BE REMOVED	7427 SF
2" ASPHALT CONCRETE PAVING (NEW)	4551 SF
10' HIGH CMU SCREEN WALL PER CLV STANDARDS	114 LF
8' HIGH CMU SCREEN WALL PER CLV STANDARDS	46 LF
4' WIDE WROUGHT IRON GATE	4 EA
PRECAST BLOCK PAVERS (PATIO AREA)	2391 SF
PLANTER AREA (AROUND PATIO)	900 SF
PRECAST WATER FOUNTAIN	1 EA
REMOVAL OF EXISTING SIDEWALK	416 SF
REMOVAL OF EXISTING VALLEY GUTTER	123 LF

**APPROVALS:**

*Charles Katkowski, Jr.* 12-31-98  
 CHARLES KATKOWSKI, JR.; PE # 4784 DATE  
 CITY PLANNING ENGINEER

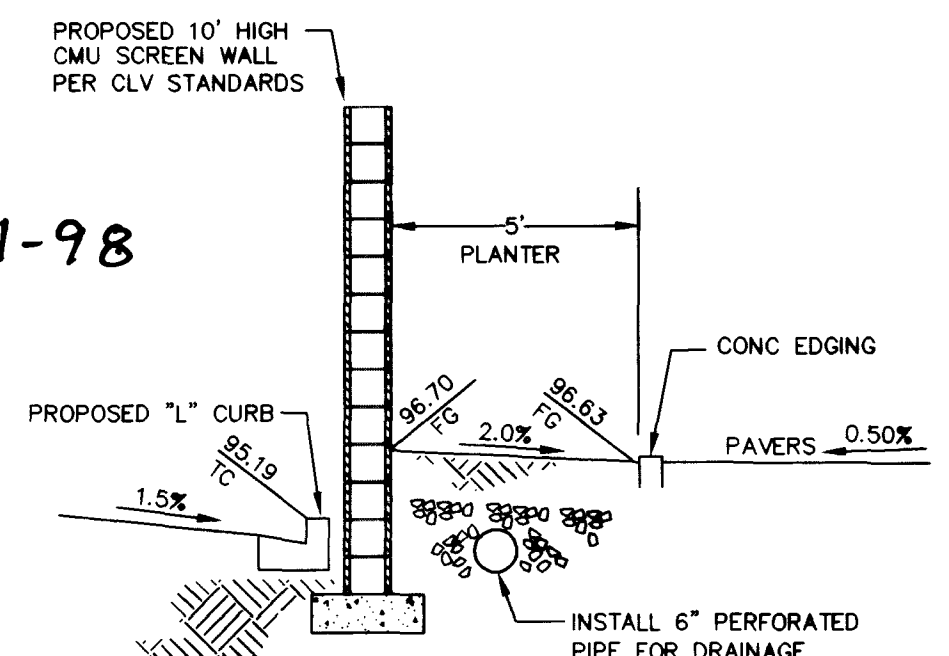

SECTION B CROSS SECTION

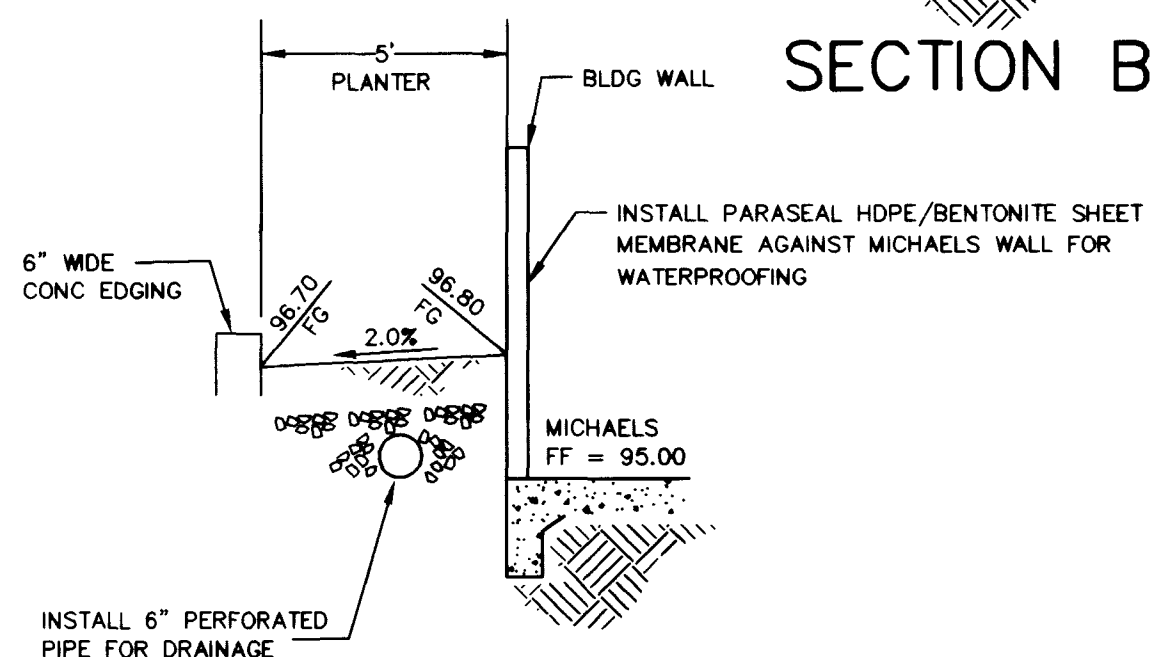

SECTION C CROSS SECTION

**NOTICE!**  
 EXISTING UTILITIES ARE SHOWN ON PLANS FOR THE CONVENIENCE OF THE CONTRACTOR ONLY. THE CONTRACTOR IS RESPONSIBLE FOR THE PROTECTION OF ALL UTILITIES. THE ENGINEER BEARS NO RESPONSIBILITY FOR UTILITIES NOT SHOWN OR SHOWN INCORRECTLY.

**Call Djs BEFORE YOU Dig!**  
 1-800-227-2600  
 (NEVADA STATE BOARD OF ENGINEERING)

**GREAT AMERICAN CAPITAL**  
 8687 W. SHARARA AVE., #201  
 LAS VEGAS, NEVADA 89117  
 (702) 253-5751

**ALPHA &**  
 ENGINEERING COMPANY  
 50 So. Jones #202, Las Vegas, NV, 89107  
 Telephone: (702) 877-1300

**PATIO ADDITION GRADING PLAN**

**DESTINATION SPA AT LAKE MEAD PAVILION**

SHEET 2A OF 5 SHEETS  
 DRAWING NO. 107-V2789

SCALE: 1" = 10'

DESIGNED BY: SFC  
 CHECKED BY: ET  
 PROJECT NO.: 710506

DATE: 12-16-98

DATE: 12-16-98

DATE: 12-16-98

c:\vgn\710506\DESTINAT Med Dec 30 14:34:11 1998 Plotted by STEVEC

12780 (S) 15707

**PAVING NOTE**

PAVING SPACES  
 SHALL BE PAVED WITH  
 4" CONC. ON 6" SAND

**GRAVITY SEWER**



**BASE OF FINISH**

THE TOP OF THE FINISH OF GRAVEL  
 SHALL BE THE SAME AS THE TOP OF THE  
 FINISH OF THE CONCRETE SLAB

**LEGAL DESCRIPTION**

PARCEL 171011-1000000  
 LOT 10, TRACT 1000000

**SEWER-BASED**

SEWER-BASED SYSTEMS  
 SHALL BE INSTALLED  
 AS SHOWN

**VISIBILITY MAP**



**LEGEND**

1" = 10'	1" = 10'
2" = 20'	2" = 20'
3" = 30'	3" = 30'
4" = 40'	4" = 40'
5" = 50'	5" = 50'
6" = 60'	6" = 60'
7" = 70'	7" = 70'
8" = 80'	8" = 80'
9" = 90'	9" = 90'
10" = 100'	10" = 100'
11" = 110'	11" = 110'
12" = 120'	12" = 120'
13" = 130'	13" = 130'
14" = 140'	14" = 140'
15" = 150'	15" = 150'
16" = 160'	16" = 160'
17" = 170'	17" = 170'
18" = 180'	18" = 180'
19" = 190'	19" = 190'
20" = 200'	20" = 200'

**PROPOSED CERTIFICATE**

THIS PLAN IS THE PROPERTY OF THE ENGINEER  
 AND IS NOT TO BE REPRODUCED OR COPIED  
 IN ANY MANNER WITHOUT HIS WRITTEN CONSENT

NOTE: DESTINATION SPA RESORT IS PART OF THE APPROVED  
 COMMERCIAL SUBDIVISION "LAKE MEAD PAVILION" CLV #107-10700

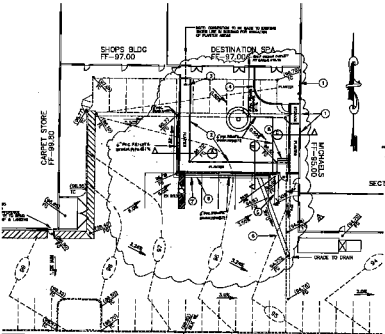

**CONSTRUCTION NOTES**

1. SEE GENERAL NOTES
2. SEE SPECIFICATIONS
3. SEE CITY ENGINEERING DEPARTMENT
4. SEE CITY ENGINEERING DEPARTMENT
5. SEE CITY ENGINEERING DEPARTMENT
6. SEE CITY ENGINEERING DEPARTMENT
7. SEE CITY ENGINEERING DEPARTMENT
8. SEE CITY ENGINEERING DEPARTMENT
9. SEE CITY ENGINEERING DEPARTMENT
10. SEE CITY ENGINEERING DEPARTMENT

**GRADING NOTES**

1. SEE GENERAL NOTES
2. SEE SPECIFICATIONS
3. SEE CITY ENGINEERING DEPARTMENT
4. SEE CITY ENGINEERING DEPARTMENT
5. SEE CITY ENGINEERING DEPARTMENT
6. SEE CITY ENGINEERING DEPARTMENT
7. SEE CITY ENGINEERING DEPARTMENT
8. SEE CITY ENGINEERING DEPARTMENT
9. SEE CITY ENGINEERING DEPARTMENT
10. SEE CITY ENGINEERING DEPARTMENT



SECTION A CROSS SECTION

**CONSTRUCTION QUANTITIES**

PAVING	100.00
GRAVEL	100.00
CONCRETE	100.00
SEWER	100.00
WATER	100.00
LANDSCAPE	100.00
UTILITIES	100.00
FOUNDATION	100.00
ROOFING	100.00
MECHANICAL	100.00
ELECTRICAL	100.00
PLUMBING	100.00
PAINT	100.00
FINISH	100.00
DEMOLITION	100.00
FOUNDATION	100.00
ROOFING	100.00
MECHANICAL	100.00
ELECTRICAL	100.00
PLUMBING	100.00
PAINT	100.00
FINISH	100.00
DEMOLITION	100.00

**APPROVALS:**

*[Signature]* 12-31-98  
 ENGINEER



SECTION B CROSS SECTION



SECTION C CROSS SECTION

PROJECT NO. 1000000  
 SHEET NO. 1000000  
 DATE 12-31-98  
 DRAWN BY [Name]  
 CHECKED BY [Name]  
 APPROVED BY [Name]

GREAT AMERICAN CAPITAL  
 OF THE WEST  
 ALPHA

DESIGN BY [Name]  
 1000000

1000000