

LAKE MEAD CONDOMINIUMS

A COMMON INTEREST CONDOMINIUM COMMUNITY

A PORTION OF THE WEST HALF OF 1/4 OF THE NORTHWEST QUARTER ONE 1/4 OF SECTION 22, TOWNSHIP 20 SOUTH, RANGE 80 WEST, 60M, CLARK COUNTY, ARIZONA.

PHASING PLAN

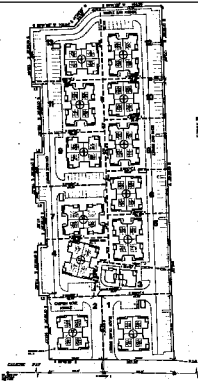

NOTES:
 1. ALL CONSTRUCTION SHALL BE IN ACCORDANCE WITH THE LATEST EDITIONS OF THE INTERNATIONAL BUILDING CODES AND THE LATEST EDITIONS OF THE INTERNATIONAL PLUMBING AND MECHANICAL CODES.
 2. ALL CONSTRUCTION SHALL BE IN ACCORDANCE WITH THE LATEST EDITIONS OF THE INTERNATIONAL FIRE AND SAFETY CODES AND THE LATEST EDITIONS OF THE INTERNATIONAL ELECTRICAL CODES.
 3. ALL CONSTRUCTION SHALL BE IN ACCORDANCE WITH THE LATEST EDITIONS OF THE INTERNATIONAL SCHEDULING CODES AND THE LATEST EDITIONS OF THE INTERNATIONAL CONSTRUCTION CODES.
 4. ALL CONSTRUCTION SHALL BE IN ACCORDANCE WITH THE LATEST EDITIONS OF THE INTERNATIONAL ENVIRONMENTAL CODES AND THE LATEST EDITIONS OF THE INTERNATIONAL HEALTH AND SAFETY CODES.
 5. ALL CONSTRUCTION SHALL BE IN ACCORDANCE WITH THE LATEST EDITIONS OF THE INTERNATIONAL ACCESSIBILITY CODES AND THE LATEST EDITIONS OF THE INTERNATIONAL TRANSPORTATION CODES.
 6. ALL CONSTRUCTION SHALL BE IN ACCORDANCE WITH THE LATEST EDITIONS OF THE INTERNATIONAL COMMUNICATIONS CODES AND THE LATEST EDITIONS OF THE INTERNATIONAL INFORMATION TECHNOLOGY CODES.
 7. ALL CONSTRUCTION SHALL BE IN ACCORDANCE WITH THE LATEST EDITIONS OF THE INTERNATIONAL ENERGY CODES AND THE LATEST EDITIONS OF THE INTERNATIONAL SUSTAINABLE DEVELOPMENT CODES.
 8. ALL CONSTRUCTION SHALL BE IN ACCORDANCE WITH THE LATEST EDITIONS OF THE INTERNATIONAL SECURITY CODES AND THE LATEST EDITIONS OF THE INTERNATIONAL DEFENSE CODES.
 9. ALL CONSTRUCTION SHALL BE IN ACCORDANCE WITH THE LATEST EDITIONS OF THE INTERNATIONAL SPACE CODES AND THE LATEST EDITIONS OF THE INTERNATIONAL AEROSPACE CODES.
 10. ALL CONSTRUCTION SHALL BE IN ACCORDANCE WITH THE LATEST EDITIONS OF THE INTERNATIONAL MARITIME CODES AND THE LATEST EDITIONS OF THE INTERNATIONAL AVIATION CODES.
 11. ALL CONSTRUCTION SHALL BE IN ACCORDANCE WITH THE LATEST EDITIONS OF THE INTERNATIONAL RAILROAD CODES AND THE LATEST EDITIONS OF THE INTERNATIONAL TRANSPORTATION CODES.
 12. ALL CONSTRUCTION SHALL BE IN ACCORDANCE WITH THE LATEST EDITIONS OF THE INTERNATIONAL PIPELINE CODES AND THE LATEST EDITIONS OF THE INTERNATIONAL TRANSPORTATION CODES.
 13. ALL CONSTRUCTION SHALL BE IN ACCORDANCE WITH THE LATEST EDITIONS OF THE INTERNATIONAL MARITIME CODES AND THE LATEST EDITIONS OF THE INTERNATIONAL AVIATION CODES.
 14. ALL CONSTRUCTION SHALL BE IN ACCORDANCE WITH THE LATEST EDITIONS OF THE INTERNATIONAL RAILROAD CODES AND THE LATEST EDITIONS OF THE INTERNATIONAL TRANSPORTATION CODES.
 15. ALL CONSTRUCTION SHALL BE IN ACCORDANCE WITH THE LATEST EDITIONS OF THE INTERNATIONAL PIPELINE CODES AND THE LATEST EDITIONS OF THE INTERNATIONAL TRANSPORTATION CODES.

- 1. [Symbol] CONDOMINIUM UNIT
- 2. [Symbol] COMMON AREA
- 3. [Symbol] PARKING SPACE
- 4. [Symbol] DRIVEWAY
- 5. [Symbol] WALKWAY
- 6. [Symbol] BIKEWAY
- 7. [Symbol] BIKEWAY
- 8. [Symbol] BIKEWAY
- 9. [Symbol] BIKEWAY
- 10. [Symbol] BIKEWAY
- 11. [Symbol] BIKEWAY
- 12. [Symbol] BIKEWAY
- 13. [Symbol] BIKEWAY
- 14. [Symbol] BIKEWAY
- 15. [Symbol] BIKEWAY
- 16. [Symbol] BIKEWAY
- 17. [Symbol] BIKEWAY
- 18. [Symbol] BIKEWAY
- 19. [Symbol] BIKEWAY
- 20. [Symbol] BIKEWAY
- 21. [Symbol] BIKEWAY
- 22. [Symbol] BIKEWAY
- 23. [Symbol] BIKEWAY
- 24. [Symbol] BIKEWAY
- 25. [Symbol] BIKEWAY
- 26. [Symbol] BIKEWAY
- 27. [Symbol] BIKEWAY
- 28. [Symbol] BIKEWAY
- 29. [Symbol] BIKEWAY
- 30. [Symbol] BIKEWAY
- 31. [Symbol] BIKEWAY
- 32. [Symbol] BIKEWAY
- 33. [Symbol] BIKEWAY
- 34. [Symbol] BIKEWAY
- 35. [Symbol] BIKEWAY
- 36. [Symbol] BIKEWAY
- 37. [Symbol] BIKEWAY
- 38. [Symbol] BIKEWAY
- 39. [Symbol] BIKEWAY
- 40. [Symbol] BIKEWAY
- 41. [Symbol] BIKEWAY
- 42. [Symbol] BIKEWAY
- 43. [Symbol] BIKEWAY
- 44. [Symbol] BIKEWAY
- 45. [Symbol] BIKEWAY
- 46. [Symbol] BIKEWAY
- 47. [Symbol] BIKEWAY
- 48. [Symbol] BIKEWAY
- 49. [Symbol] BIKEWAY
- 50. [Symbol] BIKEWAY
- 51. [Symbol] BIKEWAY
- 52. [Symbol] BIKEWAY
- 53. [Symbol] BIKEWAY
- 54. [Symbol] BIKEWAY
- 55. [Symbol] BIKEWAY
- 56. [Symbol] BIKEWAY
- 57. [Symbol] BIKEWAY
- 58. [Symbol] BIKEWAY
- 59. [Symbol] BIKEWAY
- 60. [Symbol] BIKEWAY
- 61. [Symbol] BIKEWAY
- 62. [Symbol] BIKEWAY
- 63. [Symbol] BIKEWAY
- 64. [Symbol] BIKEWAY
- 65. [Symbol] BIKEWAY
- 66. [Symbol] BIKEWAY
- 67. [Symbol] BIKEWAY
- 68. [Symbol] BIKEWAY
- 69. [Symbol] BIKEWAY
- 70. [Symbol] BIKEWAY
- 71. [Symbol] BIKEWAY
- 72. [Symbol] BIKEWAY
- 73. [Symbol] BIKEWAY
- 74. [Symbol] BIKEWAY
- 75. [Symbol] BIKEWAY
- 76. [Symbol] BIKEWAY
- 77. [Symbol] BIKEWAY
- 78. [Symbol] BIKEWAY
- 79. [Symbol] BIKEWAY
- 80. [Symbol] BIKEWAY
- 81. [Symbol] BIKEWAY
- 82. [Symbol] BIKEWAY
- 83. [Symbol] BIKEWAY
- 84. [Symbol] BIKEWAY
- 85. [Symbol] BIKEWAY
- 86. [Symbol] BIKEWAY
- 87. [Symbol] BIKEWAY
- 88. [Symbol] BIKEWAY
- 89. [Symbol] BIKEWAY
- 90. [Symbol] BIKEWAY
- 91. [Symbol] BIKEWAY
- 92. [Symbol] BIKEWAY
- 93. [Symbol] BIKEWAY
- 94. [Symbol] BIKEWAY
- 95. [Symbol] BIKEWAY
- 96. [Symbol] BIKEWAY
- 97. [Symbol] BIKEWAY
- 98. [Symbol] BIKEWAY
- 99. [Symbol] BIKEWAY
- 100. [Symbol] BIKEWAY

DATE: 10/15/2011
 DRAWN BY: [Name]
 CHECKED BY: [Name]
 PROJECT NO.: 2011-001