

JONATHAN'S GLEN

GLENVIEW DEVELOPMENT CORPORATION

LAS VEGAS, NEVADA

OWNER

GLENVIEW DEVELOPMENT CORPORATION
 1415 S. ARVILLE - SUITE B
 LAS VEGAS, NEVADA 89102
 (702) 878-1777

GENERAL NOTES

- 1) ALL CONSTRUCTION AND MATERIALS SHALL BE IN ACCORDANCE WITH "UNIFORM STANDARD SPECIFICATIONS FOR PUBLIC WORKS CONSTRUCTION, OFF-SITE IMPROVEMENTS, CLARK COUNTY AREA, NEVADA", LATEST ISSUE; THE "UNIFORM STANDARD DRAWINGS FOR PUBLIC WORKS CONSTRUCTION, CLARK COUNTY AREA, NEVADA", LATEST ISSUE; ANY OTHER APPLICABLE APPROVED STANDARDS ISSUED BY THE CONTROLLING AGENCY; THE UNIFORM BUILDING CODE; AND ALL LOCAL CITY CODES AND ORDINANCES APPLICABLE.
- 2) THE EXISTENCE AND LOCATION OF ANY UNDERGROUND UTILITY PIPES OR STRUCTURES SHOWN ON THESE PLANS ARE OBTAINED BY A SEARCH OF THE AVAILABLE RECORDS. THE CONTRACTOR IS REQUIRED TO TAKE PRECAUTIONARY MEASURES TO PROTECT THE UTILITY LINES SHOWN AND ANY OTHER LINES NOT OF RECORD OR NOT SHOWN ON THESE DRAWINGS. EXISTING UTILITIES ARE LOCATED ON PLANS ONLY FOR THE CONVENIENCE OF THE CONTRACTOR. EXISTING UTILITY SERVICE LATERALS ARE NOT SHOWN ON THE PLANS.
- 3) THE CONTRACTOR SHALL TAKE ALL PRECAUTIONARY MEASURES NECESSARY TO PROTECT EXISTING IMPROVEMENTS WHICH ARE TO REMAIN IN PLACE. FROM DAMAGE, AND ALL SUCH IMPROVEMENTS OR STRUCTURES DAMAGED BY THE CONTRACTOR'S OPERATIONS SHALL BE REPAIRED OR RECONSTRUCTED SATISFACTORY TO THE OWNER AT THE EXPENSE OF THE CONTRACTOR.
- 4) THE CONTRACTOR SHALL NOT BACKFILL ANY TRENCHES IN WHICH WATERLINES HAVE BEEN UNCOVERED UNTIL THE WATERLINES HAVE BEEN INSPECTED BY THE LAS VEGAS VALLEY WATER DISTRICT. THE WATER DISTRICT SHALL BE NOTIFIED 48 HOURS IN ADVANCE OF CONSTRUCTION IN THE VICINITY OF WATER LINES.
- 5) ALL CONSTRUCTION SHALL BE AS SHOWN ON THESE PLANS. ANY ALTERATION SHALL HAVE THE PRIOR WRITTEN APPROVAL OF THE OWNER.
- 6) TYPE V CEMENT SHALL BE USED IN ALL CONCRETE WORK. CONCRETE TO BE DESIGNED FOR A 5.5 SACK MIX WITH A MINIMUM WATER/CEMENT RATIO OF 0.45 (OR AS DESIGNATED BY THE SOILS ENGINEER). MIX DESIGN TO BE APPROVED BY THE QUALITY CONTROL DIVISION PRIOR TO USE ON THE PROJECT.
- 7) THE CONTRACTOR SHALL, AT HIS EXPENSE, LOCATE ALL OVERHEAD INTERFERENCES WHICH MAY AFFECT HIS OPERATION DURING CONSTRUCTION AND SHALL TAKE ALL NECESSARY PRECAUTIONS TO AVOID DAMAGE TO SAME. THE CONTRACTOR SHALL USE EXTREME CAUTION WHEN WORKING NEAR OVERHEAD OR UNDERGROUND POWER AND/OR TELEPHONE FACILITIES SO AS TO SAFELY PROTECT ALL PERSONNEL AND EQUIPMENT, AND SHALL BE RESPONSIBLE FOR ALL COSTS AND LIABILITY IN CONNECTION THEREWITH.
- 8) PERMITS ARE REQUIRED FOR ANY WORK IN THE PUBLIC RIGHT OF WAY. THE CONTRACTOR SHALL SECURE ALL PERMITS AND INSPECTIONS REQUIRED FOR THIS CONSTRUCTION.
- 9) EXPANSION JOINTS REQUIRED, MAXIMUM EVERY 200', IN EXTRUDED TYPE CURB.
- 10) A.C. PAVEMENT TO BE 1/2" ABOVE LIP OF ALL GUTTER AND VALLEY GUTTER AFTER COMPACTION.
- 11) APPLY FOG SEAL ONLY AFTER ALL CORRECTIONS AND ADJUSTMENTS HAVE BEEN MADE.
- 12) CURB & GUTTER WITH A GRADE OF LESS THAN FOUR TENTHS OF ONE PERCENT SHALL BE CONSTRUCTED BY FORMING. EACH JOINT SHALL BE CHECKED FOR GRADE PRIOR TO CONSTRUCTION AND WATER TESTED AS SOON AS POSSIBLE AFTER CONSTRUCTION.
- 13) WHEELCHAIR RAMPS SHALL BE CONSTRUCTED IN EACH QUADRANT OF AN INTERSECTION PER STANDARD DRAWING 235. EXACT LOCATION OF RAMPS MAY BE ADJUSTED IN THE FIELD BY A CITY INSPECTOR.
- 14) THE CONTRACTOR SHALL PROVIDE ALL NECESSARY HORIZONTAL AND VERTICAL TRANSITIONS BETWEEN NEW CONSTRUCTION AND EXISTING SURFACES TO PROVIDE FOR PROPER DRAINAGE, INGRESS, AND EGRESS TO SAID CONSTRUCTION. EXTENT OF TRANSITIONS TO BE AS SHOWN ON PLANS, OR AS DESIGNATED IN THE FIELD BY A CITY INSPECTOR.
- 15) ALL GRADING WORK SHALL CONFORM TO THE SOILS REPORT AS PREPARED BY THE SOILS ENGINEER AND APPROVED BY THE CITY.
- 16) THE EXACT LOCATION OF SANICUT LINES MAY BE DETERMINED IN THE FIELD BY A CITY OF LAS VEGAS INSPECTOR IF LOCATION ON PLANS IS NOT CLEARLY SHOWN, OR EXISTING PAVEMENT CONDITION REQUIRES RELOCATION.
- 17) THE CONTRACTOR SHALL TAKE ALL PRECAUTIONS NECESSARY TO PROTECT EXISTING PERMANENT SURVEY MONUMENTS. ANY MONUMENTS DISTURBED SHALL BE REPLACED AND ADJUSTED PER AVAILABLE RECORDS IN ACCORDANCE WITH N.R.S. STATUTE NO. 625.550.

VICINITY MAP

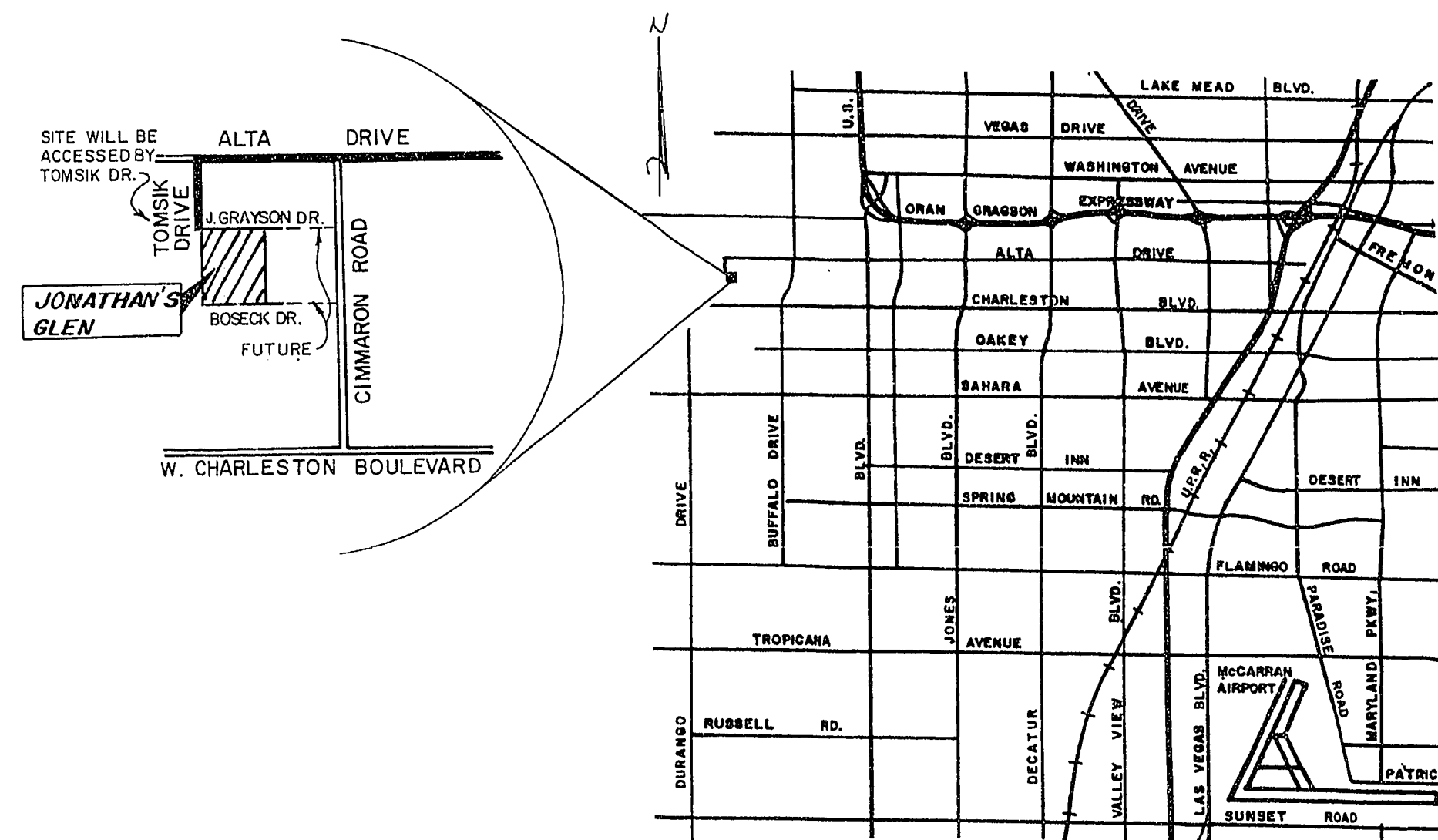

SITE PLAN

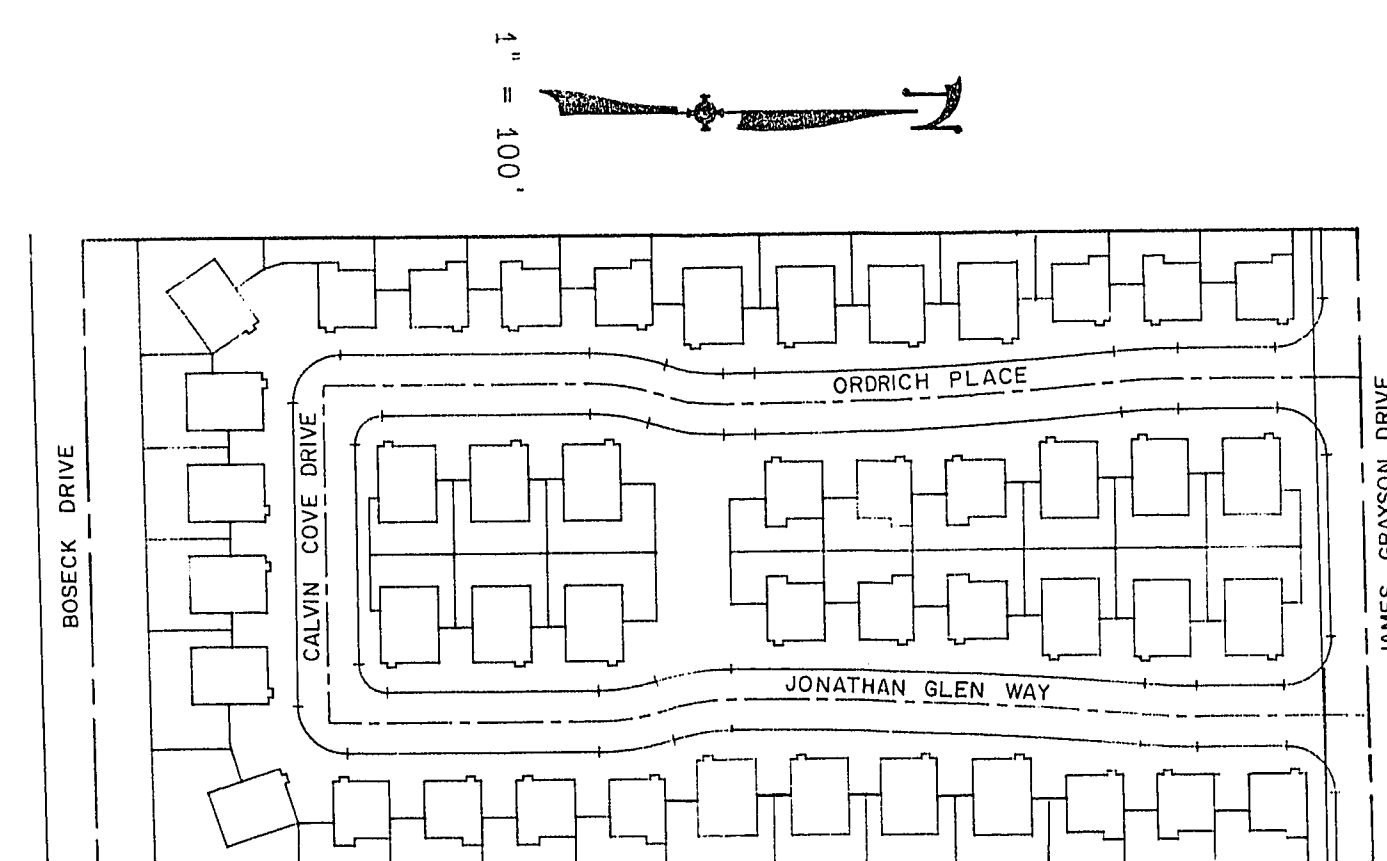

ENGINEER

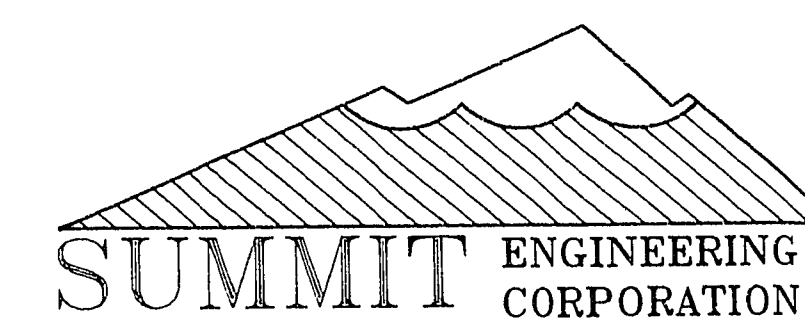

SHEET INDEX

1	TITLE SHEET
2	SITE PLAN
3	GRADING PLAN
4	UTILITY PLAN-MASTER WATER
5	UTILITY PLAN-MASTER SEWER
6	PLAN & PROFILE-OFF SITE IMPROVEMENTS
7	PLAN & PROFILE-OFF SITE IMPROVEMENTS
8	PLAN & PROFILE-OFF SITE IMPROVEMENTS
9	PLAN & PROFILE
10	PLAN & PROFILE
11	DETAIL SHEET

SPECIFICATIONS

ALL CONSTRUCTION SHALL CONFORM TO THE UNIFORM STANDARD SPECIFICATIONS AND DRAWINGS FOR PUBLIC WORKS CONSTRUCTION CITY OF LAS VEGAS, CLARK COUNTY, NEVADA (LATEST EDITION) AND THE RECOMMENDATIONS OF THE SOILS AND FOUNDATION INVESTIGATION BY SOUTHWEST GEOTECHNICAL CONSULTANTS DATED AUGUST, 1988.

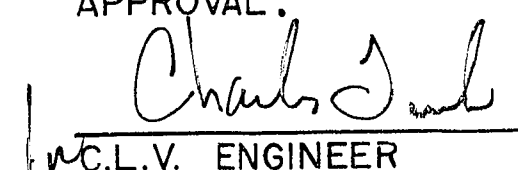
APPROVAL:

 C.J.L.V. ENGINEER
 DATE: 4/25/89

CALL BEFORE YOU DIG
1-800-227-2600

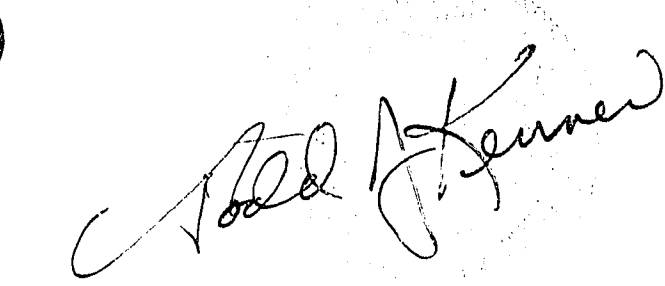
PROJECT BENCHMARK
 S.L.M. BRASS CAP AT INTERSECTION
 OF CHARLESTON & DURANGO.
 ELEVATION: 2863.94

 4/26/89