

CONSTRUCTION NOTES

- 1 CONSTRUCT 2" AC OVER 7" TYPE II AB OVER 6" TYPE I AB
- 2 CONSTRUCT 3" AC OVER 8" TYPE II AB OVER 9" TYPE I AB
- 3 CONSTRUCT CONCRETE SIDEWALK PER STD DWG 234
- 4 CONSTRUCT "L" TYPE CURB AND GUTTER PER STD DWG 216
- 5 CONSTRUCT 8" CROSS GUTTER PER STD DWG 228
- 6 CONSTRUCT SIDEWALK RAMP PER STD DWG 235 (TYPE PER PLAN)
- 7 CONSTRUCT SIDEWALK UNDER DRAIN PER STD DWG 236
- 8 CONSTRUCT 6" WIDE "U" CHANNEL PER DETAIL 9 ON SHEET 12
- 9 CONSTRUCT 6" WIDE x 32 TALL THRU WALL DRAIN PER DETAIL 8 ON SHEET 12
- 10 CONSTRUCT 6" LONG 0" - 6" CURB FACE TRANSITION
- 11 CONSTRUCT MODIFIED "A" TYPE ISLAND CURB WITH 6" CURB FACE PER DETAIL 16 ON SHEET 13
- 12 CONSTRUCT 3" WIDE VALLEY GUTTER PER DETAIL 7 ON SHEET 12
- 13 SAWCUT EXISTING CONCRETE CURB AND GUTTER, REMOVE AND DISPOSE OF CONCRETE DEBRIS OFFSITE
- 14 CONSTRUCT 12" CONCRETE OVER 12" TYPE II AB OVER 24" TYPE I AB W/ # 4 BARS 24" OC
- 15 CONSTRUCT 2" WIDE "U" CHANNEL PER DETAIL 9 ON SHEET 12
- 16 CONSTRUCT C. M. U. FENCE PER STD B-102 ACCESS EASEMENT THROUGH LANDSCAPE AREA DEDICATED PER SEPARATE DOCUMENT
- 17 CONSTRUCT RETAINING WALL W/ C. M. U. FENCE PER STD B-101
- 18 CONSTRUCT TRASH ENCLOSURE PER ARCHITECTURAL PLANS
- 19 CONSTRUCT 24" WIDE 0" CURB FACE OPENING
- 20 PROTECT IN PLACE
- 21 CONSTRUCT MODIFIED "A" TYPE ISLAND CURB WITH 12" CURB FACE PER STD DWG 219 AND DETAIL 15 ON SHEET 13
- 22 CONSTRUCT 10' LONG 6" - 12" CURB FACE TRANSITION
- 23 CONSTRUCT CASE III HANDICAP ACCESS RAMP PER CCSD NO. 235
- 24 CONSTRUCT PERIMETER SCREEN WALL PER ARCHITECTURAL PLANS
- 25 CONSTRUCT PERIMETER SCREEN WALL WITH EVERY OTHER BLOCK ALONG BOTTOM COURSE ROTATED 90 DEGREES FOR DRAINAGE PURPOSES

EASEMENT NOTES

- 1 24' PUBLIC DRAINAGE EASEMENT, TO BE PRIVATELY MAINTAINED.
- 2 SIGHT VISIBILITY EASEMENT
- 3 PUBLIC ACCESS EASEMENT

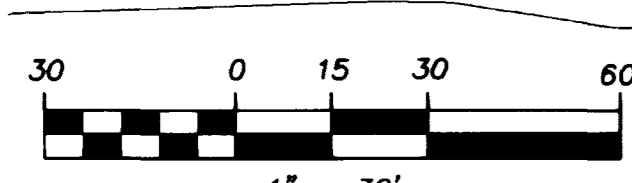

RAMP TRANSITION LENGTH TABLE
PER USDCCA DWG NO. 235 CASE III

RAMP NO.	GRADE (%) "B" TO "A"	"A" (FEET) MINIMUM	"B" (FEET) MINIMUM
HCR-1	-8.66%	4.5	21.5
HCR-2	+4.07%	15.0	4.5
HCR-3	-2.52%	4.5	9.5
HCR-4	0.00%	8.0	8.0
HCR-5	+3.53%	12.0	4.5
HCR-6	+0.00%	8.0	8.0
HCR-7	-0.80%	8.0	8.0
HCR-8	+0.00%	8.0	8.0

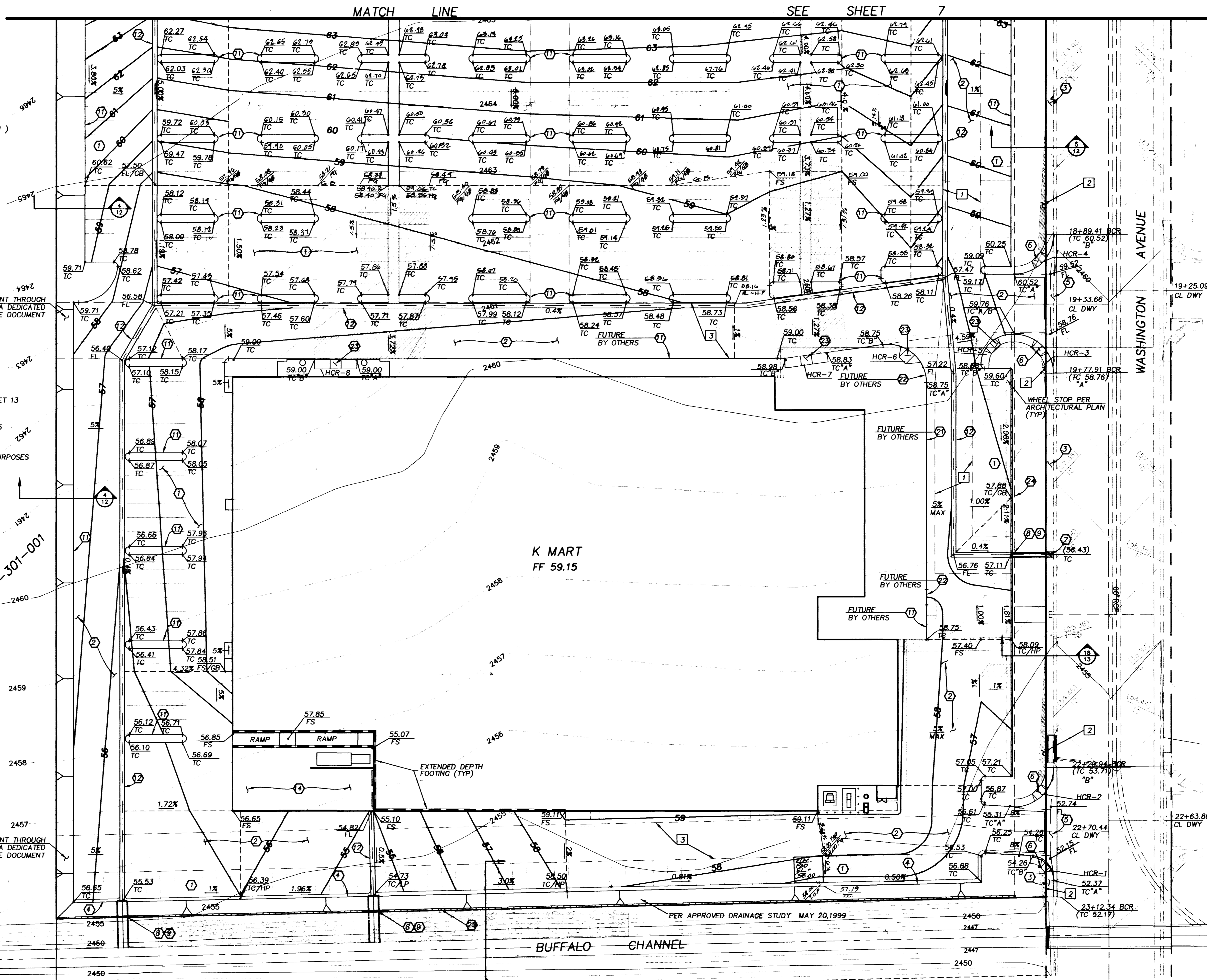

ACCESS EASEMENT THROUGH LANDSCAPE AREA DEDICATED PER SEPARATE DOCUMENT

PER APPROVED DRAINAGE STUDY MAY 20, 1999

Call before you Dig. It's a Law.
1-800-227-2600

AVOID HITTING OVERHEAD POWER LINES. IT'S COSTLY.
CALL BEFORE YOU DO OVERHEAD.
CALL 1-702-593-8111

DRAINAGE CERTIFICATION
I CERTIFY THAT THIS GRADING PLAN IS IN CONFORMANCE WITH THE APPROVED DRAINAGE STUDY ON FILE AT THE CITY OF LAS VEGAS FOR THIS PROJECT.

DATE: 6/2/1999
Signature: Kevin K. Elliott P.E. #12758

LAURICH PROPERTIES, INC. (K-MART #9389)
2500 WEST SARAH AVENUE, SUITE 211
LAS VEGAS, NV 89102
(702) 220-4500

AGRA Infrastructure, Inc.
ENGINEERING GLOBAL SOLUTIONS
CHARLESTON BOULEVARD, SUITE 180
LAS VEGAS, NEVADA 89102
PHONE: (702) 878-3617
FAX: (702) 878-3716

GRADING PLAN
K-MART #9389
7500 BLOCK OF WASHINGTON
300' EAST OF BUFFALO
CITY OF LAS VEGAS

SCALE: 1" = 30'

11 of 17 SHEETS
DRAWING NO. 107-V3110

J:\1998\100\98130\8130P602.dwg Thu Jun 10 09:16:55 1999

CONSTRUCTION NOTES

1. EXISTING 12" DIA. WATER MAIN TO BE REMOVED AT 100' TO 140'
2. EXISTING 12" DIA. WATER MAIN TO BE REMOVED AT 100' TO 140' AT 100' TO 140'
3. EXISTING 12" DIA. WATER MAIN TO BE REMOVED AT 100' TO 140'
4. EXISTING 12" DIA. WATER MAIN TO BE REMOVED AT 100' TO 140'
5. EXISTING 12" DIA. WATER MAIN TO BE REMOVED AT 100' TO 140'
6. EXISTING 12" DIA. WATER MAIN TO BE REMOVED AT 100' TO 140'
7. EXISTING 12" DIA. WATER MAIN TO BE REMOVED AT 100' TO 140'
8. EXISTING 12" DIA. WATER MAIN TO BE REMOVED AT 100' TO 140'
9. EXISTING 12" DIA. WATER MAIN TO BE REMOVED AT 100' TO 140'
10. EXISTING 12" DIA. WATER MAIN TO BE REMOVED AT 100' TO 140'
11. EXISTING 12" DIA. WATER MAIN TO BE REMOVED AT 100' TO 140'
12. EXISTING 12" DIA. WATER MAIN TO BE REMOVED AT 100' TO 140'
13. EXISTING 12" DIA. WATER MAIN TO BE REMOVED AT 100' TO 140'
14. EXISTING 12" DIA. WATER MAIN TO BE REMOVED AT 100' TO 140'
15. EXISTING 12" DIA. WATER MAIN TO BE REMOVED AT 100' TO 140'
16. EXISTING 12" DIA. WATER MAIN TO BE REMOVED AT 100' TO 140'
17. EXISTING 12" DIA. WATER MAIN TO BE REMOVED AT 100' TO 140'
18. EXISTING 12" DIA. WATER MAIN TO BE REMOVED AT 100' TO 140'
19. EXISTING 12" DIA. WATER MAIN TO BE REMOVED AT 100' TO 140'
20. EXISTING 12" DIA. WATER MAIN TO BE REMOVED AT 100' TO 140'
21. EXISTING 12" DIA. WATER MAIN TO BE REMOVED AT 100' TO 140'
22. EXISTING 12" DIA. WATER MAIN TO BE REMOVED AT 100' TO 140'
23. EXISTING 12" DIA. WATER MAIN TO BE REMOVED AT 100' TO 140'
24. EXISTING 12" DIA. WATER MAIN TO BE REMOVED AT 100' TO 140'
25. EXISTING 12" DIA. WATER MAIN TO BE REMOVED AT 100' TO 140'
26. EXISTING 12" DIA. WATER MAIN TO BE REMOVED AT 100' TO 140'
27. EXISTING 12" DIA. WATER MAIN TO BE REMOVED AT 100' TO 140'
28. EXISTING 12" DIA. WATER MAIN TO BE REMOVED AT 100' TO 140'
29. EXISTING 12" DIA. WATER MAIN TO BE REMOVED AT 100' TO 140'
30. EXISTING 12" DIA. WATER MAIN TO BE REMOVED AT 100' TO 140'
31. EXISTING 12" DIA. WATER MAIN TO BE REMOVED AT 100' TO 140'
32. EXISTING 12" DIA. WATER MAIN TO BE REMOVED AT 100' TO 140'
33. EXISTING 12" DIA. WATER MAIN TO BE REMOVED AT 100' TO 140'
34. EXISTING 12" DIA. WATER MAIN TO BE REMOVED AT 100' TO 140'
35. EXISTING 12" DIA. WATER MAIN TO BE REMOVED AT 100' TO 140'
36. EXISTING 12" DIA. WATER MAIN TO BE REMOVED AT 100' TO 140'
37. EXISTING 12" DIA. WATER MAIN TO BE REMOVED AT 100' TO 140'
38. EXISTING 12" DIA. WATER MAIN TO BE REMOVED AT 100' TO 140'
39. EXISTING 12" DIA. WATER MAIN TO BE REMOVED AT 100' TO 140'
40. EXISTING 12" DIA. WATER MAIN TO BE REMOVED AT 100' TO 140'
41. EXISTING 12" DIA. WATER MAIN TO BE REMOVED AT 100' TO 140'
42. EXISTING 12" DIA. WATER MAIN TO BE REMOVED AT 100' TO 140'
43. EXISTING 12" DIA. WATER MAIN TO BE REMOVED AT 100' TO 140'
44. EXISTING 12" DIA. WATER MAIN TO BE REMOVED AT 100' TO 140'
45. EXISTING 12" DIA. WATER MAIN TO BE REMOVED AT 100' TO 140'
46. EXISTING 12" DIA. WATER MAIN TO BE REMOVED AT 100' TO 140'
47. EXISTING 12" DIA. WATER MAIN TO BE REMOVED AT 100' TO 140'
48. EXISTING 12" DIA. WATER MAIN TO BE REMOVED AT 100' TO 140'
49. EXISTING 12" DIA. WATER MAIN TO BE REMOVED AT 100' TO 140'
50. EXISTING 12" DIA. WATER MAIN TO BE REMOVED AT 100' TO 140'

LEGEND NOTES

- 1. EXISTING 12" DIA. WATER MAIN TO BE REMOVED AT 100' TO 140'
- 2. EXISTING 12" DIA. WATER MAIN TO BE REMOVED AT 100' TO 140'
- 3. EXISTING 12" DIA. WATER MAIN TO BE REMOVED AT 100' TO 140'



NO.	DESCRIPTION	DATE	BY	CHKD.
1	ISSUED FOR PERMITS	10/1/58	J.M.	J.M.
2	ISSUED FOR CONSTRUCTION	10/1/58	J.M.	J.M.
3	ISSUED FOR RECORD	10/1/58	J.M.	J.M.
4	ISSUED FOR RECORD	10/1/58	J.M.	J.M.
5	ISSUED FOR RECORD	10/1/58	J.M.	J.M.
6	ISSUED FOR RECORD	10/1/58	J.M.	J.M.
7	ISSUED FOR RECORD	10/1/58	J.M.	J.M.
8	ISSUED FOR RECORD	10/1/58	J.M.	J.M.
9	ISSUED FOR RECORD	10/1/58	J.M.	J.M.
10	ISSUED FOR RECORD	10/1/58	J.M.	J.M.

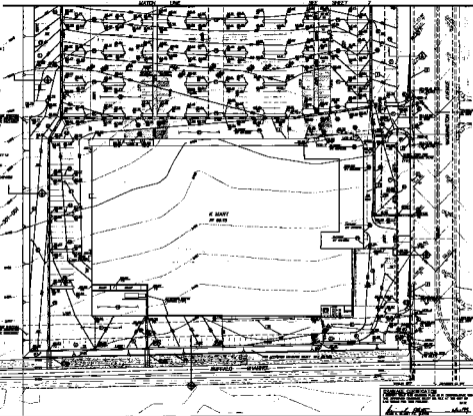

DRAWING NO. 100-100-100
 SHEET NO. 1 OF 1
 DATE: 10/1/58
 PROJECT: K NAVY
 DRAWN BY: J.M.
 CHECKED BY: J.M.
 APPROVED BY: J.M.

SAICNA ENGINEERING, INC. (A SAIC COMPANY)
 1100 W. 17th St., Suite 100
 Lincoln, Nebraska 68502
 PHONE: 338-1100
 TELETYPE: 338-1100
 SAICNA ENGINEERING, INC.
 A SAIC COMPANY
 1100 W. 17th St., Suite 100
 Lincoln, Nebraska 68502
 PHONE: 338-1100
 TELETYPE: 338-1100