

Book No. \_\_\_\_\_

Instrument No. \_\_\_\_\_

# HIGHGATE CONDOMINIUMS

A RESIDENTIAL PLANNED DEVELOPMENT FOR CONDOMINIUM PURPOSES

LYING WITHIN THE SOUTHEAST QUARTER (SE 1/4) OF THE SOUTHWEST QUARTER (SW 1/4)  
OF SECTION 27, TOWNSHIP 20 SOUTH, RANGE 60 EAST, M.D.M.,  
CITY OF LAS VEGAS, CLARK COUNTY, NEVADA

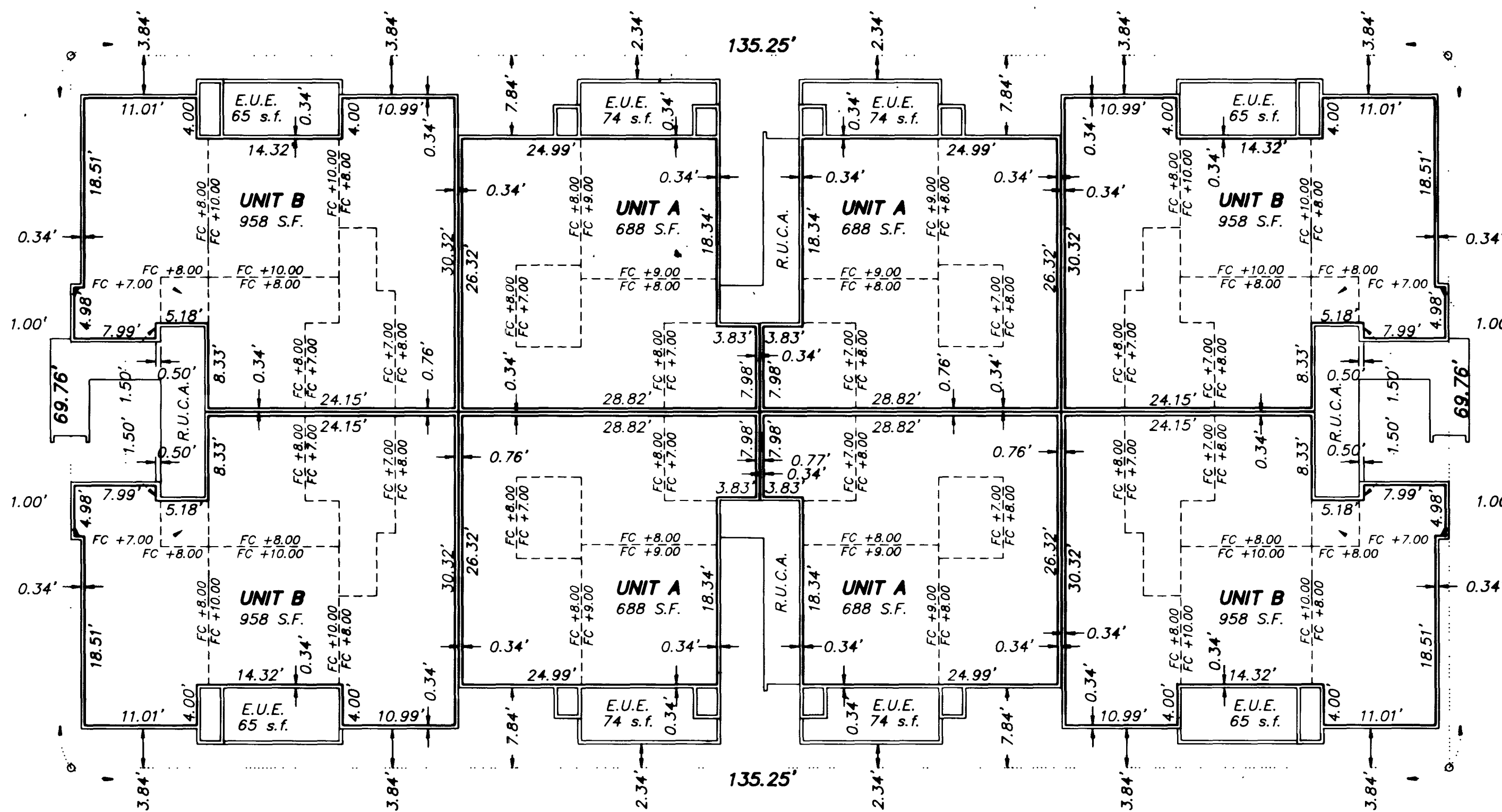

BUILDING TYPE I - SECOND FLOOR PLAN

SCALE: 1" = 10'

TYPICAL FOR BUILDINGS 15,16,18 AND 20

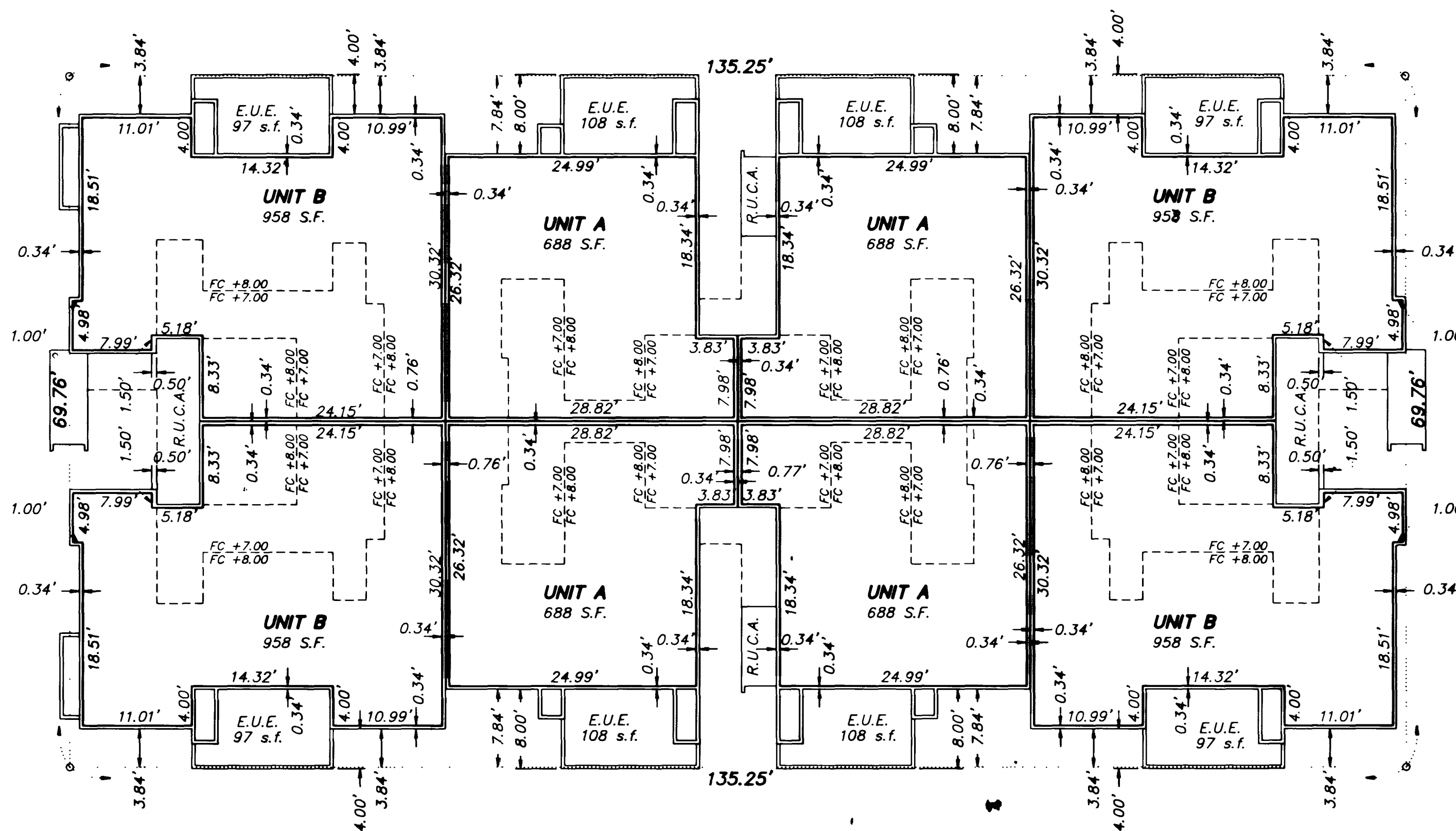

BUILDING TYPE I - FIRST FLOOR PLAN

SCALE: 1" = 10'

TYPICAL FOR BUILDINGS 15,16,18 AND 20

- LEGEND**
- REFERENCE POINT ONLY
  - E.U.E. EXCLUSIVE USE EASEMENT
  - R.U.C.A. RESTRICTED USE COMMON AREA

Sheet No. \_\_\_\_\_

Reference No. \_\_\_\_\_

# HIGHGATE CONDOMINIUMS

A RESIDENTIAL PLANNED DEVELOPMENT FOR CONDOMINIUM PURPOSES

LINDA WOOD THE SOUTHEAST QUARTER (SE 1/4) OF THE SOUTHWEST QUARTER (SW 1/4)  
OF SECTION 27, TOWNSHIP 20 SOUTH, RANGE 03 EAST, MAHA,  
CITY OF LAS VEGAS, CLARK COUNTY, NEVADA

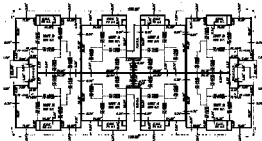

SECOND FLOOR PLAN  
TYPE FOR RECORD PLATS ON B

TYPE FOR RECORD PLATS ON B

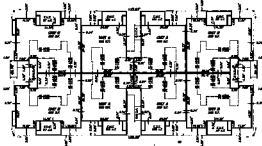

THIRD FLOOR PLAN  
TYPE FOR RECORD PLATS ON B

TYPE FOR RECORD PLATS ON B

**LEGEND**

- 1. INTERIOR FINISH ONLY
- 2. EXTERIOR FINISH ONLY
- 3. FINISH TO BE DETERMINED