

GENERAL NOTES

- CONTRACTOR SHALL PROVIDE ALL NECESSARY HORIZONTAL AND VERTICAL TRANSITION BETWEEN NEW CONSTRUCTION AND EXISTING SURFACES TO PROVIDE FOR PROPER DRAINAGE AND OF INGRESS AND EGRESS TO SAID CONSTRUCTION. EXTENT OF TRANSITIONS TO BE DETERMINED BY THE CITY ENGINEER.
- EXISTING UTILITIES ARE LOCATED ON PLANS FOR THE CONVENIENCE OF THE CONTRACTOR ONLY. THE CONTRACTOR SHALL BEAR FULL RESPONSIBILITY FOR THE PROTECTION OF THE UTILITIES AND THE ENGINEER BEARS NO RESPONSIBILITY FOR UTILITIES NOT SHOWN ON PLANS OR NOT IN THE LOCATION SHOWN ON THE PLANS (CALL BEFORE YOU DIG-800-227-2600) CONSTRUCTION TO BE PER "UNIFORM STANDARD SPECIFICATIONS AND DRAWINGS"; THE CITY OF LAS VEGAS, NEVADA. (LATEST EDITION)
- CONSTRUCTION SURVEY: GRADES ARE GIVEN FROM TOP OF STAKES OR NAILS. THE CONTRACTORS ARE CAUTIONED TO OBSERVE THE FOLLOWING RULES IN USING THE GRADE STAKES GIVEN BY THIS OFFICE. THREE (3) CONSECUTIVE POINTS THAT ARE SHOWN TO BE ON THE SAME RATE OF SLOPE MUST BE USED IN COMMON IN ORDER THAT ANY VARIATION OUT OF A PERFECT STRAIGHT GRADE MAY BE DETECTED IN CASE ANY SUCH DISCREPANCY IS FOUND, THE SAME MUST BE REPORTED, OTHERWISE THIS OFFICE WILL NOT BE RESPONSIBLE FOR ANY ERROR IN THE GRADE OF THE FINISHED WORK.
- WHEEL CHAIR RAMPS SHALL BE CONSTRUCTED AT ALL STREET INTERSECTIONS PER STANDARD DRAWING D22A. EXACT LOCATION OF RAMPS TO BE DETERMINED IN THE FIELD BY A CITY OF LAS VEGAS INSPECTOR.
- STANDARD STREET SECTIONS PER STANDARD DRAWINGS UNLESS OTHERWISE NOTED.
- CURB AND GUTTER WITH A GRADE OF LESS THAN FOUR TENTHS OF ONE PERCENT SHALL BE CONSTRUCTED BY FORMING. EACH JOINT SHALL BE CHECKED FOR GRADE PRIOR TO CONSTRUCTION AND WATER TESTED AS SOON AS POSSIBLE AFTER CONSTRUCTION.
- EXACT LOCATIONS OF ALL SAWCUTS TO BE DETERMINED BY A CITY OF LAS VEGAS INSPECTOR IN THE FIELD.
- USE TYPE "V" CONCRETE IN ALL OFF-SITE CONCRETE WORK.
- CHISEL "S" FOR SEWER AND "G" FOR GAS WHERE THESE LINES PASS UNDER THE CURB.

SEWER NOTES

- HOUSING SERVICES SHALL COMPLY WITH THE WESTERN PLUMBING CODE AS TO SEPARATION DISTANCE.
- ALL HOUSES TO BE SERVED INDIVIDUALLY AS PER SECTION 313 OF THE UNIFORM PLUMBING CODE.
- CONCRETE COLLARS REQUIRED AROUND WATER VALVES AND MANHOLE COVERS AT SURFACE OF PAVED AREAS ON MAJOR STREETS, ASPHALT COLLARS ON MINOR STREETS.

STREET LIGHTING NOTE

ALL STREET LIGHTING INSTALLATIONS SHALL CONFORM TO THE LATEST ISSUE OF THE STANDARD DETAILS AND SPECIFICATIONS OF THE CITY OF LAS VEGAS, AND SHALL ALSO CONFORM TO THE "UNIFORM STANDARD SPECIFICATIONS FOR PUBLIC WORKS CONSTRUCTION OF OFF-SITE IMPROVEMENTS", CLARK COUNTY, NEVADA AREA, UNLESS OTHERWISE NOTED.

STREET NOTES

- A.C. PAVEMENT TO BE 1/2" ABOVE LIP OF GUTTER AFTER COMPACTION.
- SUBGRADE FOR TYPE 1 UNDER CURB AND GUTTER AND UNDER A.C. TO BE CONTINUOUS.
- FOG SEAL TO BE APPLIED AFTER FINAL CORRECTIONS AND ADJUSTMENTS HAVE BEEN MADE.
- THE MAXIMUM GRADE BREAK OCCURRING IN THE CROSS SECTION SHALL BE 2% AND SHALL FALL BETWEEN A DRIVING LANE AND A PARKING LANE.
- NATIVE MATERIAL MAY BE USED IN LIEU OF TYPE 1 WHEN PROCESSED FOR APPROVAL IN ACCORDANCE WITH CITY OF LAS VEGAS STATEMENT OF POLICY DATED 07/25/85.

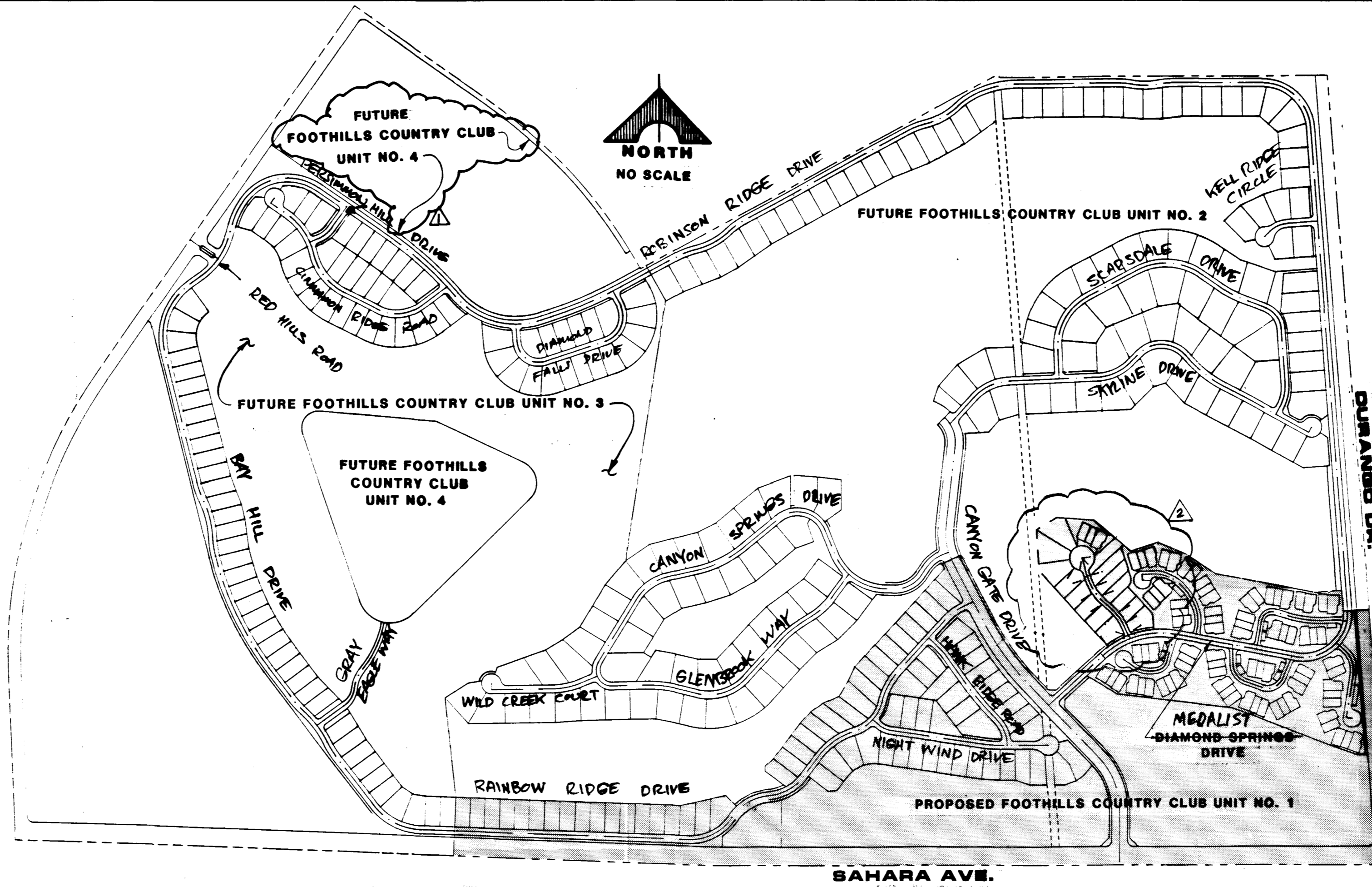

SITE PLAN

ESTIMATE OF QUANTITIES

STREETS	PRIVATE	PUBLIC	TOTAL
2" AC PVMT. W/4" TYPE 2 BASE	30,220 SY		30,220 SY
3-3/4" AC PVMT. W/4" TYPE 2 BASE		34,480 SY	34,480 SY
"A" TYPE CURB	2,615 LF	4,920 LF	7,535 LF
"L" TYPE CURB & GUTTER	2,660 LF	5,215 LF	7,875 LF
ROLL TYPE CURB & GUTTER	15,485 LF		15,485 LF
5" CONCRETE SIDEWALK		34,300 SF	34,300 SF
CONCRETE VALLEY GUTTER	2,320 SF	756 SF	3,076 SF

STREET LIGHTS	PRIVATE	PUBLIC	TOTAL
-- RELOCATE 250 W. HPS STREET LIGHT		11 EA	11 EA
-- INSTALL 250 W. HPS STREET LIGHT (DUAL 8' ARMS)		17 EA	17 EA
-- INSTALL NEW 250 W. HPS STREET LIGHT		21 EA	21 EA

STORM DRAIN	PRIVATE	PUBLIC	TOTAL
18" RCP	1060 LF	55 LF	1115 LF
24" RCP	315 LF	140 LF	455 LF
36" RCP		260 LF	260 LF
48" RCP		310 LF	310 LF
48" TYPE 1 ECCENTRIC MANHOLE	1 EA	1 EA	2 EA
60" TYPE 1 ECCENTRIC MANHOLE		1 EA	1 EA
SPECIAL MANHOLE	1 EA		1 EA
TYPE 2 DROP INLET, "A"-2'-0"	4 EA		4 EA
TYPE 2 DROP INLET, "A"-3'-0"	1 EA		1 EA
TYPE 3 DROP INLET, "A"-2'-6"		1 EA	1 EA
TYPE 3 DROP INLET, "A"-6'-0"		1 EA	1 EA
TYPE A DROP INLET, "A"-3'-6"	3 EA		3 EA
BUBBLER STRUCTURE		1 EA	1 EA

SEWER	PRIVATE	PUBLIC	TOTAL
48" MANHOLE		57 EA	57 EA
8" PVC OR VCP		8955 LF	8955 LF
10" PVC OR VCP		200 LF	200 LF
18" PVC OR VCP		60 LF	60 LF
4" SEWER LATERALS		3000 LF	3000 LF

Call before you Dig.
1-800-227-2608
UNDERGROUND SERVICE USA

BENCHMARK
C105M04 - MAIL IN WEST SIDE OF POWER POLE NO. 17 AT NORTHWEST QUMD. OF DURANGO DRIVE AND SAHARA AVENUE. CLARK COUNTY DATUM ELEV. = 2661.99.

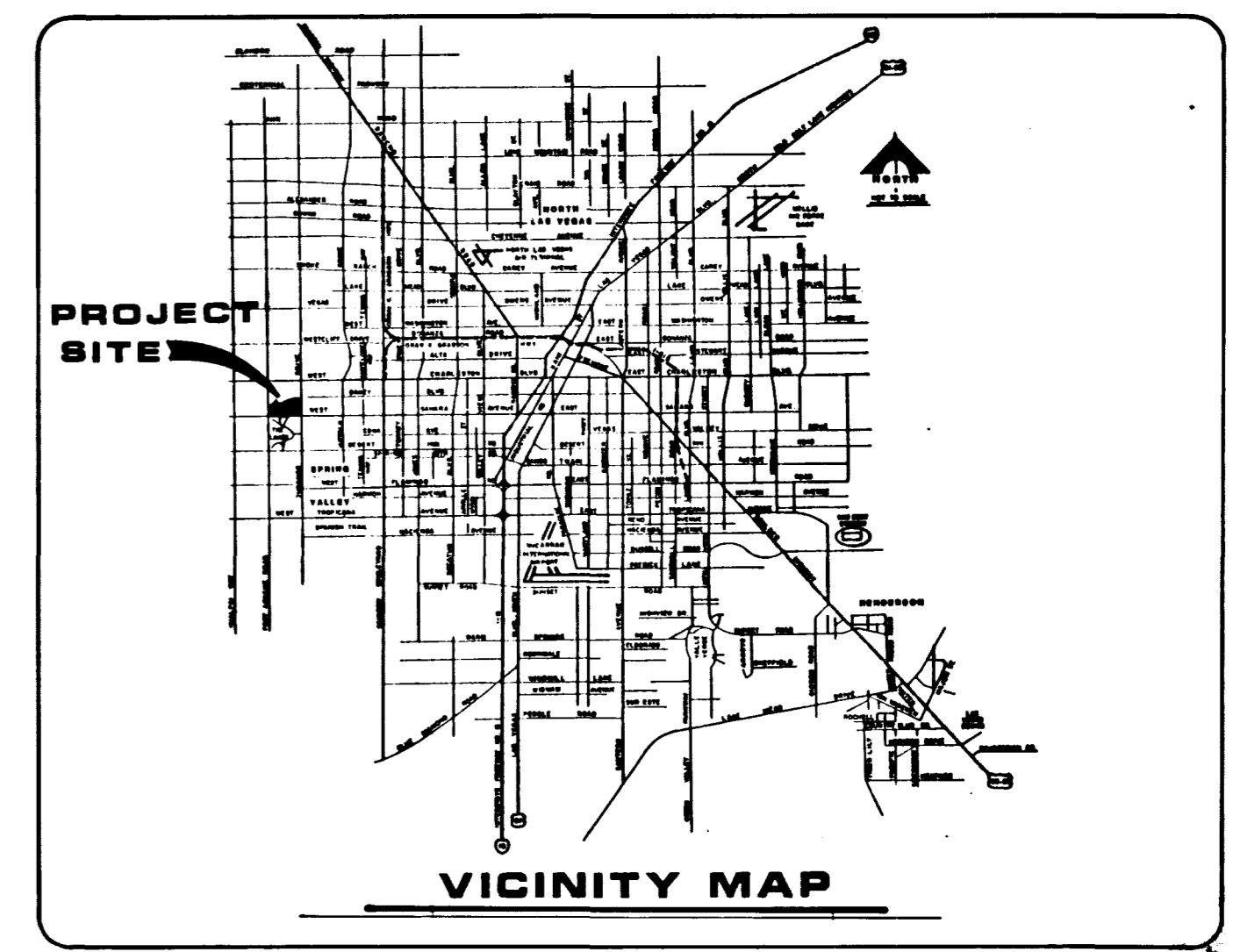

INDEX OF DRAWINGS

NO.	TITLE
1	COVER SHEET
2	GENERAL NOTES, QUANTITIES & MISCELLANEOUS
3 THRU 8	PLAT MAP - UNIT NO. 1 (1 THRU 6)
9 THRU 17	PLAT MAP - UNIT NO. 1 LOTS A AND B (1 THRU 9)
18	GRADING NOTES & MISCELLANEOUS
19 THRU 22	GRADING PLANS - UNIT NO. 1
23 THRU 27	GRADING PLANS - UNIT NO. 1, LOTS A AND B
28	ONSITE STORM DRAIN PROFILES
29	UTILITY PLAN NOTES & MISCELLANEOUS
30 THRU 34	UTILITY PLAN - UNIT NO. 1
35 THRU 39	UTILITY PLAN - UNIT NO. 1 LOTS A AND B
40	SANITARY SEWER PROFILES "A", "B", "J", "K" & "L"
41	SANITARY SEWER PROFILES "C" & "D"
42	SANITARY SEWER PROFILES "E", "F", "G", "H" & "I"
43	SAHARA AVENUE - STA. 0 + 00.00 TO 9 + 00.00
44	SAHARA AVENUE - STA. 9 + 00.00 TO 21 + 00.00
45	SAHARA AVENUE - STA. 21 + 00.00 TO 33 + 00.00
46	SAHARA AVENUE - STA. 33 + 00.00 TO 36 + 72.54
47	DURANGO DRIVE - STA. 2 + 00.00 TO 13 + 00.00
48	DURANGO DRIVE - STA. 13 + 00.00 TO 24 + 00.00
49	DURANGO DRIVE - STA. 24 + 00.00 TO 33 + 89.92
50	MISCELLANEOUS DETAILS
51	DURANGO/SAHARA - STORM DRAIN DETAILS
52	STORM DRAIN PROFILES & MISCELLANEOUS DETAILS

APPROVALS

[Signature] CLV ENGINEER 5-27-87 DATE

[Signature] CLV QUALITY CONTROL ENGINEER DATE

[Signature] CLV FIRE MARSHALL 5-8-87 DATE

[Signature] CLV SANITATION ENGINEER 5-15-87 DATE

[Signature] CLV ELECTRICAL SUPERVISOR (MASS 43 THRU 46) 6-8-87 DATE

[Signature] CLV ELECTRICAL COORDINATOR (EXCEPT PAGES 47 THRU 48) 6/1/87 DATE

[Signature] CLV TRAFFIC ENGINEER 6/9/87 DATE

[Signature] CLV CHIEF LAND DEVELOPMENT 5-27-87 DATE

FOOTHILLS COUNTRY CLUB UNIT NO. 1 AT PECCOLE RANCH
GENERAL NOTES, QUANTITIES & MISCELLANEOUS

DESCRIPTION
ADD UNIT NO. 1
REVISE ST. L. QUANT. AS SHOWN
REV. QUANTITIES & SITE PLAN
DATE
7/3/87
R.E. NO. 1131

1555 SOUTH RAINBOW BLVD. LAS VEGAS, NEVADA 89102
G.C. WALLACE, INC.
Engineering/Architecture

FOOTHILLS COUNTRY CLUB UNIT NO. 1
SHEET
2
OF 52 SHEETS

