

SEWER CONTRIBUTION
 AVERAGE FLOW = 17,840 GAL/DAY (178,400 SF @ 0.10 GAL/DAY/S.F.)
 PEAK FLOW = 58,872 GAL/DAY (3.3 PEAK FACTOR)

LAS VEGAS FIRE DEPARTMENT
 FIRE FLOW IS: 3,125 GPM AT 20 PSI RESIDUAL PRESSURE

BASED ON: LARGEST BLDG.
 SQUARE FOOTAGE: 51,970 SQ. FT.
 AREA BETWEEN 4-HR AREA SEPARATION WALLS: N/R
 BUILDING HEIGHT: 35'
 NUMBER OF STORIES: 1
 OCCUPANCY: V-N
 FULL AUTOMATIC FIRE SYSTEM: YES

- NOTES:**
- ALL DIMENSIONS TO UTILITIES ARE TO CENTERLINE OF PIPE, BACK OF CURB, PROPERTY LINE, CENTERLINE, & BUILDING LINE, UNLESS NOTED OTHERWISE.
 - CONTRACTOR SHALL VERIFY HORIZONTAL AND VERTICAL ALIGNMENT OF EXISTING UTILITIES AND NOTIFY THE DESIGN ENGINEER IMMEDIATELY OF ANY DISCREPANCIES PRIOR TO CONSTRUCTION.
 - ALL SEWER AND WATER LATERALS ARE TO BE INSTALLED PER UPC STANDARDS FROM MAIN TO 5' FROM BUILDING.
 - ALL EXISTING UTILITY STRUCTURES WITHIN CONSTRUCTION AREA SHALL BE ADJUSTED TO MATCH FINISH GRADE (LE, WV, BOX, WWH, ANNOUCE BOX, FH, TEL BOX, ETC.)
 - FOR EXACT BUILDING LATERAL CONNECTION POINTS, SEE PLUMBING PLANS.

- CONSTRUCTION NOTES**
- INSTALL 8\"/>

APPROVALS

[Signature] 10/27/98
 CITY ENGINEER MARSHALL DATE

[Signature] 1st Approval 1-28-99
 LAS VEGAS VALLEY WATER DISTRICT DATE

PROJECT NAME: **FLYNN GALLAGHER CORP CENTER P.C.A., C.F.C.C.**
 This project water plan complies with the Las Vegas Valley Water District's technical requirements. However, this water plan is **NOT APPROVED FOR CONSTRUCTION** at this time and this signature does not provide or imply a water commitment.

[Signature] 10-27-98
 DATE

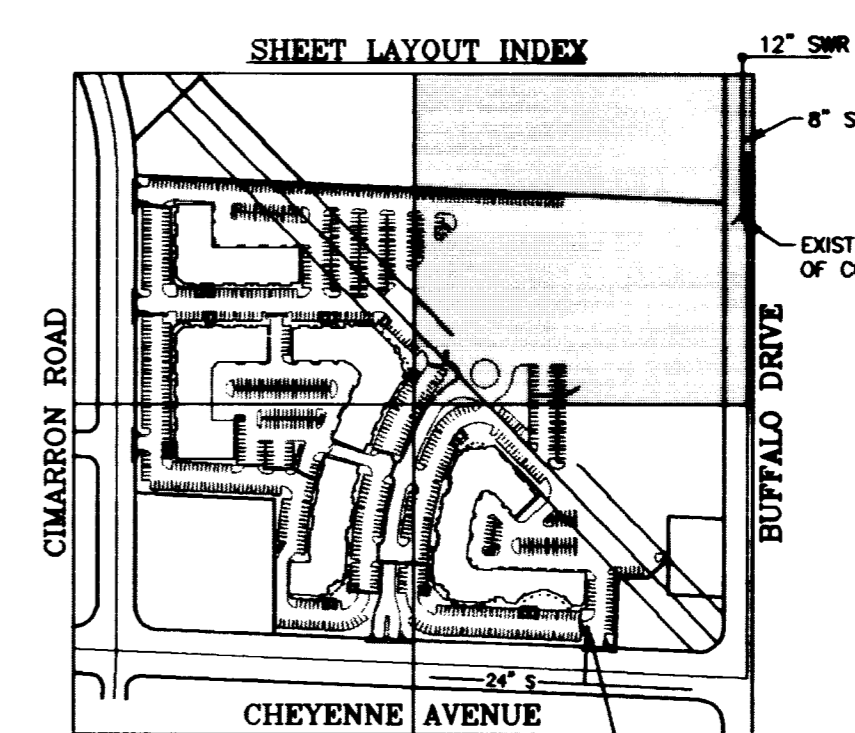

Call before you Dig. It's a Law.
1-800-227-2600

AVOID HITTING OVERHEAD POWER LINES. IT'S COSTLY!

CALL BEFORE YOU DO OVERHEAD

CALL 1-702-593-6111

UTILITY PLAN

NORTHWEST PROPERTIES, L.L.C.
 6900 WESTCLIFF DRIVE, #505
 LAS VEGAS, NEVADA 89128
 (702)256-3781

AGRA Infrastructure, Inc.
 ENGINEERING GLOBAL SOLUTIONS
 3016 W. CHARLESTON BOULEVARD, SUITE 180
 LAS VEGAS, NEVADA 89102
 PHONE: (702) 878-3617 FAX: (702) 878-3716

FLYNN GALLAGHER CORP. CENTER
 NWC OF CHEYENNE AND BUFFALO
 APN 138-09-801-018 & 019
 CITY OF LAS VEGAS

DRAWN BY: PAC AUG98
 DESIGNED BY: J.C.G./A.S.P.A.K. AUG98
 CHECKED BY: MC AUG98
 PROJECT NO: 02-1988-087
 SCALE: 1" = 30'

C4
 4 OF 15 SHEETS
 DRAWING NO. 107-V2965

13121 5 13413 2 15969 2

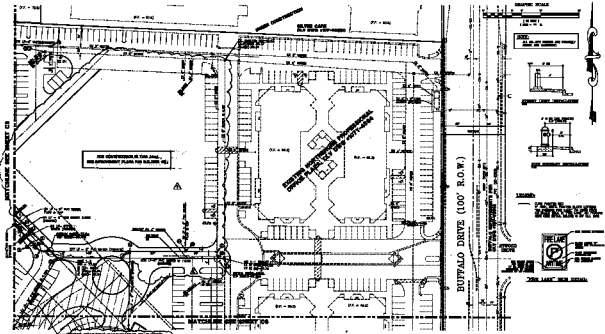

SEE CONDITIONS IN THE ANNEX
AND SPECIFICATION PLANS FOR ALL OTHERS.

SEE SPECIFICATION PLANS FOR ALL OTHERS

BUFFALO DRIVE (100' R.O.W.)

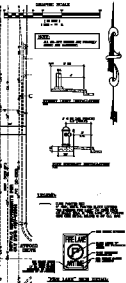

EXISTING CONDITIONS
 1. EXISTING UTILITIES
 2. EXISTING DRIVEWAYS
 3. EXISTING DRIVEWAYS
 4. EXISTING DRIVEWAYS
 5. EXISTING DRIVEWAYS
 6. EXISTING DRIVEWAYS
 7. EXISTING DRIVEWAYS
 8. EXISTING DRIVEWAYS
 9. EXISTING DRIVEWAYS
 10. EXISTING DRIVEWAYS

- PROPOSED IMPROVEMENTS**
1. IMPROVE DRIVEWAYS
 2. IMPROVE DRIVEWAYS
 3. IMPROVE DRIVEWAYS
 4. IMPROVE DRIVEWAYS
 5. IMPROVE DRIVEWAYS
 6. IMPROVE DRIVEWAYS
 7. IMPROVE DRIVEWAYS
 8. IMPROVE DRIVEWAYS
 9. IMPROVE DRIVEWAYS
 10. IMPROVE DRIVEWAYS

- PROPOSED UTILITIES**
- 1. WATER
 - 2. SEWER
 - 3. GAS
 - 4. ELECTRIC
 - 5. TELEPHONE
 - 6. CABLE
 - 7. FIBER OPTIC
 - 8. RAINWATER
 - 9. SWAMP
 - 10. OTHER

APPROVALS

DATE: 10/10/17

BY: [Signature]

ALVIN BALLARD
 CIVIL ENGINEER
 1000 10th Street, N.W.
 Atlanta, Georgia 30309
 404-525-1111



1-800-327-2800

UTILITY PLAN
 ALVIN BALLARD CORP. CENTER
 1000 10th Street, N.W.
 Atlanta, Georgia 30309
 404-525-1111

DATE: 10/10/17
 BY: [Signature]

1-800-327-2800