

CONDUCTOR SCHEDULE									
CONDUCTOR TYPE	FUNCTION	1	2	3	4	5	6	7	8
#10 AWG	PHOTOELECTRIC CONTROL UNIT		3			6	3	3	
#8 AWG	OUTLET SERVICE (WHT & BLU)	2					2	6	
#8 AWG	NEUTRAL (GREEN)	1	1	1		2	1	3	1
#4 AWG	ELECTRICAL SERVICE	2	2	2		4	2	6	2
#3/0 AWG	ELECTRICAL SERVICE POINT CONNECTION				3				
PULLROPE	SPARE								1
	CONDUIT SIZE	2"	2"	1 1/4"	2"	2"	2"	2"	2"

STREETLIGHT CONDUIT SHALL BE PLACED MIN. 5' BEHIND CURB. SEE SLEEVE DETAIL, SHEET E-1.

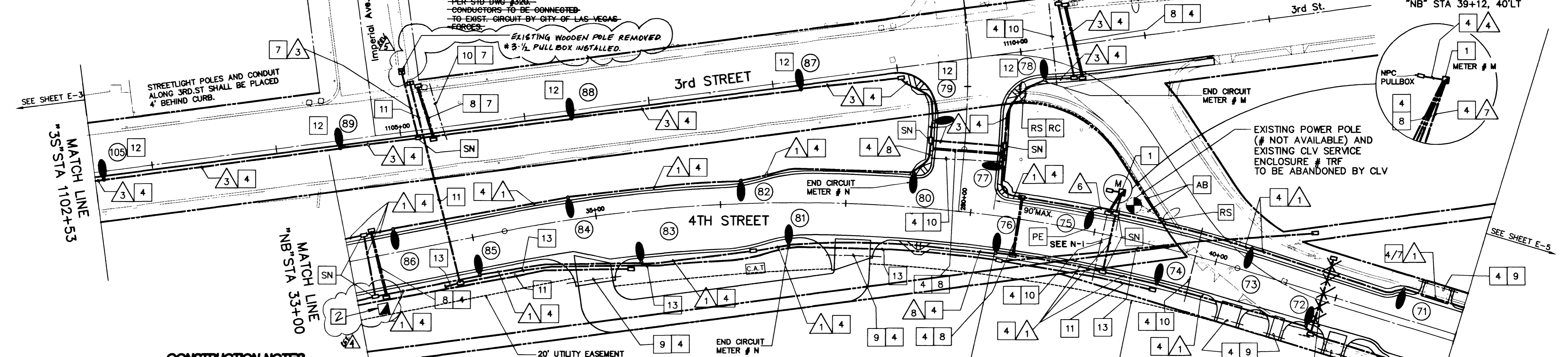

**CONSTRUCTION NOTES**

- 1 CIRCUIT # M  
INSTALL 120V/240V, SINGLE PHASE, THREE WIRE, SINGLE METERED SERVICE WITH A 200A, 240V, 2P MAIN CB IN A PAD MOUNTED NEMA TYPE 3R ENCLOSURE (REFER TO UNIFORM STD. DWG. #328). PROVIDE THE FOLLOWING:
  - ONE 60A, 240V, 2P BRANCH CB FOR STREET LIGHTING.
  - ONE 15A, 120V, 1P BRANCH CB FOR EACH LIGHTING TEST SWITCH.(ONE TEST SWITCH PER CONTACTOR)
  - TWO 60A, 240V, 2P BRANCH CB FOR TREE PIT LIGHTING.
  - ONE 60A, 2P CONTACTOR FOR STREET LIGHTING.
  - TWO 60A, 2P CONTACTORS FOR TREE PIT LIGHTING CONTACTORS.
 LIGHTING CONTACTORS FOR BOTH STREET LIGHTING AND TREE PIT LIGHTING SHALL BE TIED INTO NEW STREET LIGHTING PEU AT POLE (75).  
 CONTRACTOR SHALL PROVIDE ALL LABOR AND EQUIPMENT NECESSARY FOR SERVICE CONNECTION INCLUDING CONDUIT AND CONDUCTORS UP TO TRANSFORMER. PROVIDE ADDITIONAL 2" CONDUIT STUB FROM CONTROLLER FOR FUTURE USE.
- 4 TRENCH CONDUIT IN SOIL.
- 6 INSTALL 1 1/4" C AND CONNECT TO EXISTING STREET LIGHT STUB SOUTH OF OAKLEY BLVD. INSTALLED BY OTHERS.
- 7 TRENCH CONDUIT IN EXISTING PAVEMENT OR SIDEWALK.
- 8 INSTALL 2-2" & 1 1/4" PVC (SCH 40) CONDUIT WITH PULL ROPE AND # 3 1/2" PULLBOX AT EACH END. PLUG ENDS TO THE SATISFACTION OF THE ENGINEER.
- 9 INSTALL 2-4" PVC (SCH 40) IRRIGATION SLEEVES AND 1-2" & 1-1 1/4" PVC (SCH 40) ELECTRICAL SLEEVES WITH PULL ROPE. EXTEND SLEEVES MIN. 3' BEHIND CURB OR AS DIRECTED BY THE ENGINEER. TAPE ENDS AND STAKE LOCATION.
- 10 INSTALL 2-4" PVC (SCH 40) IRRIGATION SLEEVES AND 2-2" PVC (SCH 40) ELECTRICAL SLEEVES WITH PULL ROPE. EXTEND SLEEVES MIN. 3' BEHIND CURB OR AS DIRECTED BY THE ENGINEER. TAPE ENDS AND STAKE LOCATION.
- 11 INSTALL 4" NEVADA POWER CONDUIT WITH PULL ROPE AND PULLBOXES PER NEVADA POWER SPECIFICATIONS. REFERENCE SHEET N-1
- 12 INSTALL STREETLIGHT STANDARD AND FOUNDATION PER STD. DWG. #S 309 AND 317 WITH LIGHTING FIXTURE AS SHOWN IN POLE SCHEDULE, SHEET E-6.
- 13 INSTALL 2-6" & 1-4" NEVADA POWER CONDUITS WITH PULL ROPE AND PULLBOXES PER NEVADA POWER SPECIFICATIONS. REFERENCE SHEET N-1
- 14 INSTALL 2-6" NEVADA POWER CONDUITS WITH PULL ROPE AND PULLBOXES PER NEVADA POWER SPECIFICATIONS.

SERVICE ENCLOSURE # M (PROPOSED)  
120/240V, SINGLE PHASE, THREE WIRE, SINGLE METER SERVICE  
200A, 240V, 2P MAIN CIRCUIT BREAKER

BRANCH CIRCUIT BREAKER				ADDITIONAL COMPONENTS				STREET LIGHT LOAD (VA)	TREE PIT LIGHT LOAD (VA)	NEW ELEMENTS CONNECTED TO CIRCUIT
POSITION	CURRENT	VOLTAGE	# OF POLES	FUNCTION	CURRENT	# OF POLES	STATUS			
1	60A	240V	2	STREET LIGHTING	60A	2	NORMALLY OPEN	CONTACTOR	7800	61, 62, 63, 64, 65, 66, 67, 68, 69, 70, 71, 72
2	-	-	-	STREET LIGHTING	-	-	-	-	-	73, 74, 75, 76, 77, 78, 79, 87, 88, 89, 100, 101, 105
3	15A	120V	1	LIGHTING TEST SWITCH	-	-	-	-	-	ACTIVATES CONTACTORS FOR STREET LIGHTS & TREE PITS
4	60A	240V	2	TREE PIT LIGHTING	60A	2	NORMALLY OPEN	CONTACTOR	5616	FUTURE TREE PITS ON WEST SIDE OF 4TH ST
5	-	-	-	TREE PIT LIGHTING	-	-	-	-	-	-
6	60A	240V	2	TREE PIT LIGHTING	60A	2	NORMALLY OPEN	CONTACTOR	9072	FUTURE TREE PITS ON EAST SIDE OF 4TH ST
7	-	-	-	TREE PIT LIGHTING	-	-	-	-	-	-
8	20A	120V	1	OUTLET	20A	1	-	-	-	MAX LOAD PER OUTLET = 0.47 A (GIVEN #8 AWG CONDUCTORS)

**ELECTRIC LOAD TABLE**

- AB ABANDON SYSTEM
- BC INSTALL TYPE 3 1/2" PB IN EXISTING CONDUIT RUN. SPLICE AND COIL EXISTING CONDUCTORS PER UNIFORM STANDARD SPECIFICATION 623G.03.07.
- CB INSTALL PROPOSED CONDUIT INTO EXISTING PULL BOX.
- PE INSTALL NEW FIXTURE WITH PEU.
- RC EXISTING LIGHT POLE FOUNDATION TO BE CUT A MINIMUM OF 18" BELOW GRADE AND THE ANCHOR BOLTS BURNED OFF AT THE SAME 18" DEPTH.
- RS REMOVE AND SALVAGE LIGHT POLE, MAST ARM, FIXTURE AND EXISTING CONDUCTORS TO CLV ELECTRIC YARD.
- SN SPLICE NEW CONDUCTORS.
- ST STUB AND CAP CONDUIT.
- TS TRAFFIC SIGNAL LUMINAIRE; NOT A PART OF STREET LIGHT CIRCUITS.

Avoid cutting underground utility lines. It's costly.  
**Call before you Dig.**  
1-800-227-2600  
UNDERGROUND SERVICE ALERT (USA)

NO.	REVISIONS	DATE	BY
1	CHANGED NOTES 11 & 13, DELETED NOTE 14.	9-23-96	CLV
2	SERVICE (PADMOUNT 200A) RELOCATED PER AS-BUILT. REFERENCE SHEET E-3.	7-28-97	CLV
3	REMOVED EX. LIGHT POLE (WOOD) AND INSTALLED #3 1/2" PULL BOX IN PLACE.	7-28-97	CLV

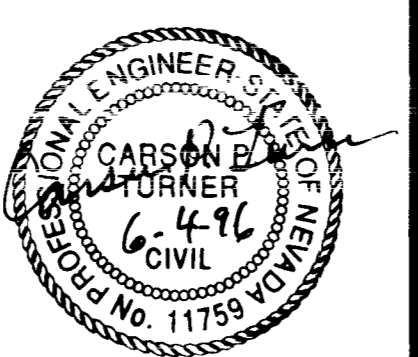

**Kimley-Horn and Associates, Inc.**  
Las Vegas, Nevada © 1996

DESIGNED BY RKS  
DRAWN BY CDR  
CHECKED BY [Signature]  
NOTE BOOK NO.



**DOWNTOWN CORRIDOR IMPROVEMENTS**  
CITY OF LAS VEGAS DEPT. OF PUBLIC WORKS  
LAS VEGAS, NEVADA  
CONTRACT 2 - 4TH STREET  
OAKLEY BLVD. TO CHARLESTON BLVD.

DATE 6/96  
SCALE 1"=40'

**LIGHTING PLAN**  
STA.33+00 TO STA.42+00

DWG. NO. 107-V-2288B  
FILE NO. 9903.02  
SHEET 44 OF 46  
**E-4**

