

CONDUCTOR SCHEDULE										
CONDUCTOR TYPE	FUNCTION	1	2	3	4	5	6	7	8	9
#10 AWG	PHOTOELECTRIC CONTROL UNIT		3			6	3	3		6
#8 AWG	OUTLET SERVICE (WHT & BLU)	2				2	6			2
#8 AWG	NEUTRAL (GREEN)	1	1	1		2	1	3	1	1
#4 AWG	ELECTRICAL SERVICE	2	2	2		4	2	6	2	4
#3/0 AWG	ELECTRICAL SERVICE POINT CONNECTION				3					
PULLROPE	SPARE									
	CONDUIT SIZE	2"	2"	1 1/4"	2"	2"	2"	2"	2"	2"

STREETLIGHT CONDUIT ALONG 4TH STREET SHALL BE PLACED 5' MIN. BEHIND CURB. SEE SLEEVE DETAIL, SHEET E-1.

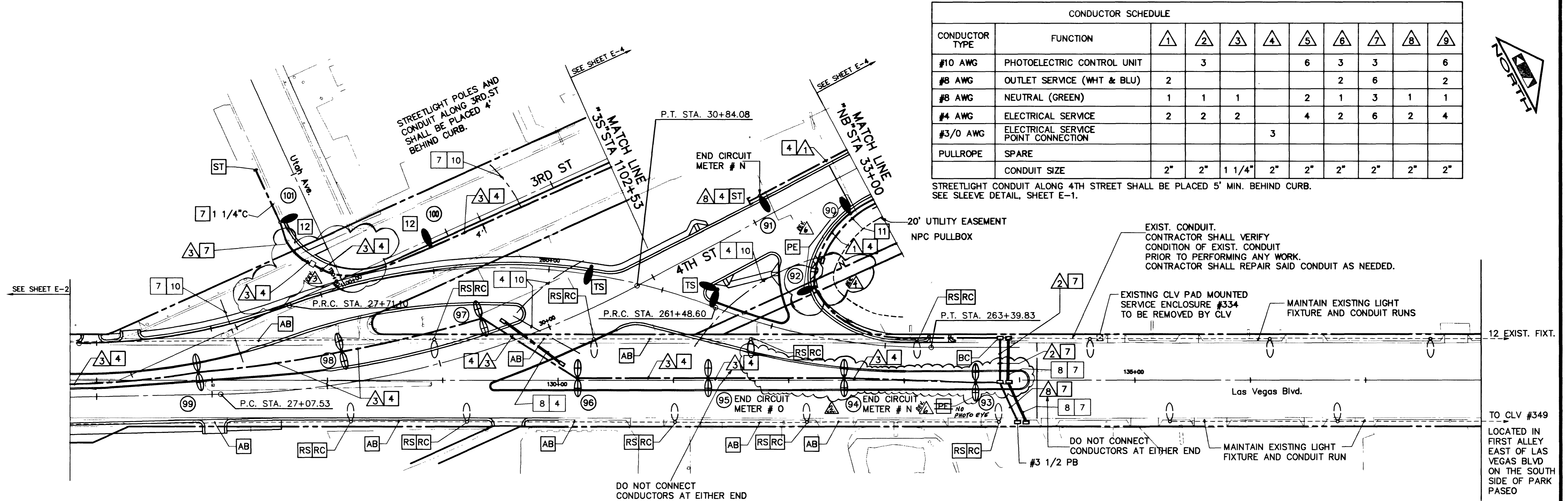
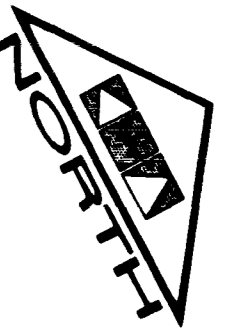

- AB ABANDON SYSTEM
- BC INSTALL TYPE 3 1/2 PB IN EXISTING CONDUIT RUN. SPLICE AND COIL EXISTING CONDUCTORS PER UNIFORM STANDARD SPECIFICATION 623G.03.07.
- CB INSTALL PROPOSED CONDUIT INTO EXISTING PULL BOX.
- PE INSTALL NEW FIXTURE WITH PEU.
- RC EXISTING LIGHT POLE FOUNDATION TO BE CUT A MINIMUM OF 18" BELOW GRADE, AND THE ANCHOR BOLTS BURNED OFF AT THE SAME 18" DEPTH.
- RS REMOVE AND SALVAGE LIGHT POLE, MAST ARM, FIXTURE AND EXISTING CONDUCTORS TO CLV ELECTRIC YARD.
- SN SPLICE NEW CONDUCTORS.
- ST STUB AND CAP CONDUIT.
- TS TRAFFIC SIGNAL LUMINAIRE; NOT A PART OF STREET LIGHT CIRCUITS.

**CONSTRUCTION NOTES**

- 2 CIRCUIT #N  
INSTALL 120V/240V, SINGLE PHASE, THREE WIRE, SINGLE METERED SERVICE WITH A 200A, 240V, 2P MAIN CB IN A PAD MOUNTED NEMA TYPE 3R ENCLOSURE (REFER TO UNIFORM STD. DWG. #328). PROVIDE THE FOLLOWING:
  - TWO 60A, 240V, 2P BRANCH CB FOR STREET LIGHTING.
  - ONE 15A, 120V, 1P BRANCH CB FOR EACH LIGHTING TEST SWITCH.(ONE TEST SWITCH PER CONTACTOR)
  - TWO 60A, 2P CONTACTORS FOR STREET LIGHTING.
  - ONE 60A, 120V, 1P BRANCH CB FOR TRAFFIC.
  - ONE 30A, 120V, 1P BRANCH CB FOR TRAFFIC.
 LIGHTING CONTACTORS FOR STREET LIGHTING SHALL BE TIED INTO NEW STREET LIGHTING PEU AT POLE (92) AND (93).  
 CONTRACTOR SHALL PROVIDE ALL LABOR AND EQUIPMENT NECESSARY FOR SERVICE CONNECTION INCLUDING CONDUIT AND CONDUCTORS UP TO TRANSFORMER. PROVIDE ADDITIONAL 2" CONDUIT STUB FROM CONTROLLER FOR FUTURE USE.
- 4 TRENCH CONDUIT IN SOIL.
- 6 INSTALL 1 1/4"C AND CONNECT TO EXISTING STREET LIGHT STUB SOUTH OF OAKLEY BLVD. INSTALLED BY OTHERS.
- 7 TRENCH CONDUIT IN EXISTING PAVEMENT OR SIDEWALK.
- 8 INSTALL 2-2" & 1 1/4" PVC (SCH 40) CONDUIT WITH PULL ROPE AND # 3 1/2 PULLBOX AT EACH END. PLUG ENDS TO THE SATISFACTION OF THE ENGINEER.
- 10 INSTALL 2-4" PVC (SCH 40) IRRIGATION SLEEVES AND 2-2" PVC (SCH 40) ELECTRICAL SLEEVES WITH PULL ROPE. EXTEND SLEEVES MIN. 3' BEHIND CURB OR AS DIRECTED BY THE ENGINEER. TAPE ENDS AND MARK LOCATION ON CURB
- 11 ~~INSTALL 2-4" NEVADA POWER CONDUITS WITH PULL ROPE AND PULLBOXES PER NEVADA POWER SPECIFICATIONS. REFERENCE SHEET N-1~~
- 12 INSTALL STREETLIGHT STANDARD AND FOUNDATION PER STD. DWG. #S 309 AND 317 & 318 WITH LIGHTING FIXTURE AS SHOWN IN POLE SCHEDULE, SHEET E-6. INSTALL POLES 4' BEHIND CURB.

SERVICE ENCLOSURE # N (PROPOSED)  
120/240V, SINGLE PHASE, THREE WIRE, SINGLE METER SERVICE  
200A, 240V, 2P MAIN CIRCUIT BREAKER

BRANCH CIRCUIT BREAKER				ADDITIONAL COMPONENTS				STREET LIGHT		TREE PIT LIGHT		NEW ELEMENTS CONNECTED TO CIRCUIT	
POSITION	CURRENT	VOLTAGE	# OF POLES	FUNCTION	CURRENT	# OF POLES	STATUS	FUNCTION	LOAD (VA)	LOAD (VA)			
1	60A	240V	2	STREET LIGHTING	60A	2	NORMALLY OPEN	CONTACTOR	6000			93, 94, AND 12 EX. LIGHTS ON WEST SIDE OF LAS VEGAS BLVD	
2				STREET LIGHTING									
3	15A	120V	1	LIGHTING TEST SWITCH								ACTIVATES CONTACTORS FOR STREET LIGHTS.	
4	60A	240V	2	STREET LIGHTING	60A	2	NORMALLY OPEN	CONTACTOR	6240			80, 81, 82, 83, 84, 85, 86, 90, 91, 92	
5				STREET LIGHTING									
6	60A	120V	1	TO BE DETERMINED								FOR OTHER APPLICATIONS AS REQUESTED BY CLV	
7	30A	120V	1	TO BE DETERMINED								FOR OTHER APPLICATIONS AS REQUESTED BY CLV	
8	20A	120V	1	OUTLET	20A	1						MAX LOAD PER OUTLET = 0.47 A (GIVEN #8 AWG CONDUCTORS)	

**ELECTRIC LOAD TABLE**



NO.	REVISIONS	DATE	BY
1	CHANGED NOTE 11.	9-23-96	CLV
2	MEDIAN ISLAND GEOMETRICS REVISED	12-27-96	CLV
3	REVISED PULLBOX AND STREETLIGHT CONDUIT TO REFLECT AS-BUILTS	7-28-97	CLV
4	SERVICE (PADMOUNT 200A) RELOCATED PER AS-BUILT. SEE SHEET E-1 FOR NEW LOC.	7-28-97	CLV
5	REVISED LOCATIONS OF PHOTO-ELECTRIC EYES.	7-28-97	CLV

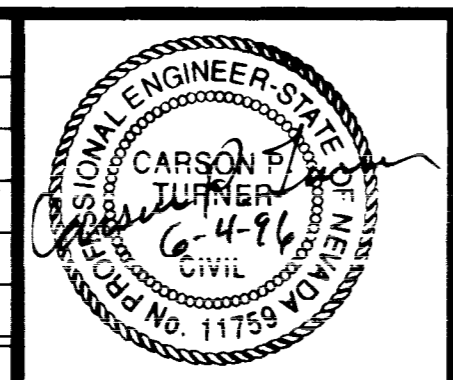

**Kimley-Horn and Associates, Inc.**  
Las Vegas, Nevada © 1996

DESIGNED BY RKS  
DRAWN BY CPT/PPG  
CHECKED BY [Signature]  
NOTE BOOK NO.



**DOWNTOWN CORRIDOR IMPROVEMENTS**  
CITY OF LAS VEGAS DEPT. OF PUBLIC WORKS  
LAS VEGAS, NEVADA  
CONTRACT 2 - 4TH STREET  
OAKLEY BLVD. TO CHARLESTON BLVD.

DATE 6/96  
SCALE 1"=40'

**LIGHTING PLAN**  
STA.25+77 TO STA.33+00

DWG. NO. 107-V-2288B  
FILE NO. 9903.02  
SHEET 43 OF 46  
**E-3**

