

ALMOND TREE LANE

BACK OF CURB CURVE DATA

No.	RADIUS	DELTA	LENGTH	TANGENT
C1	25.00'	55°57'11"	24.41'	13.28'
C2	15.00'	80°24'21"	21.05'	12.68'

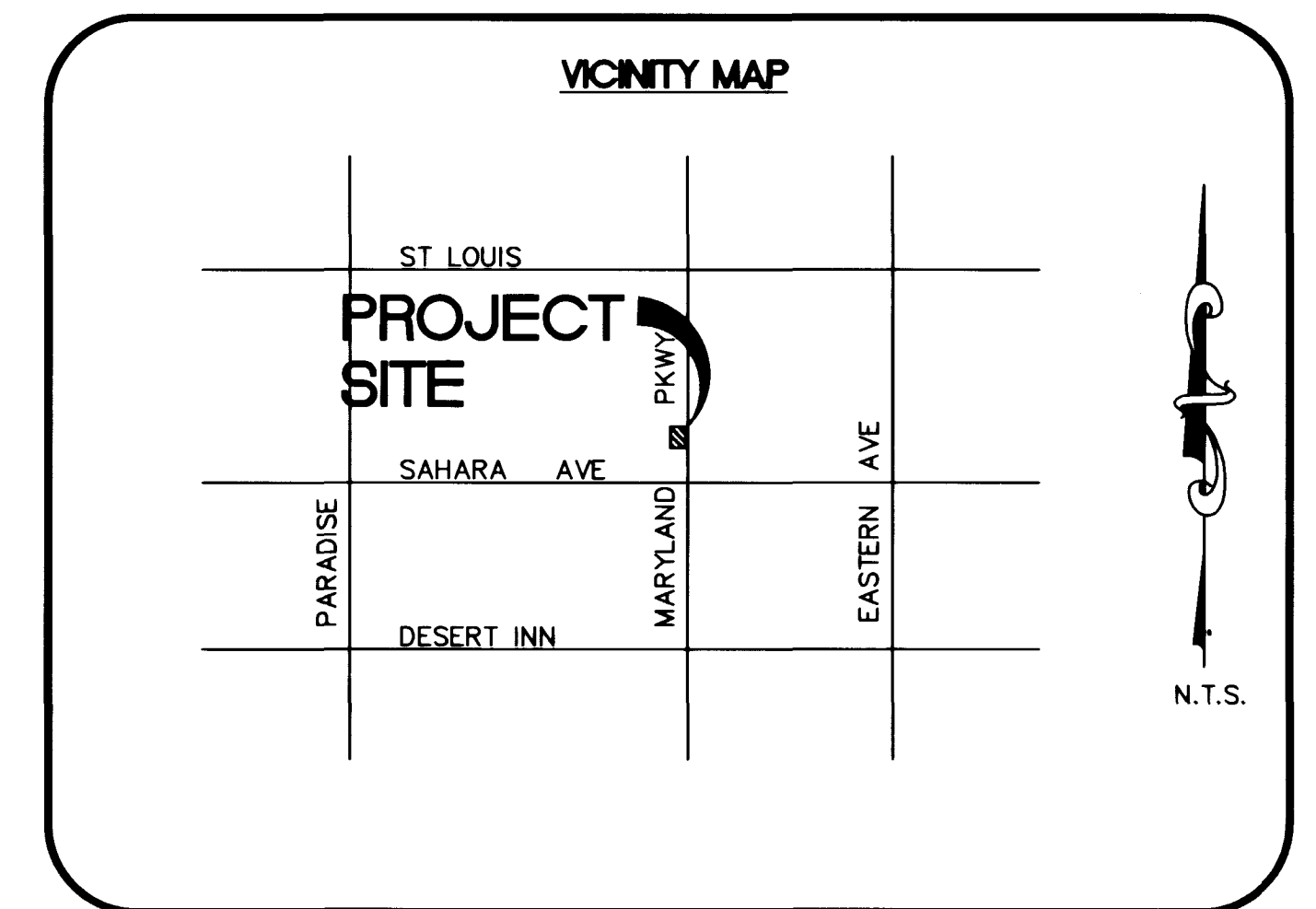
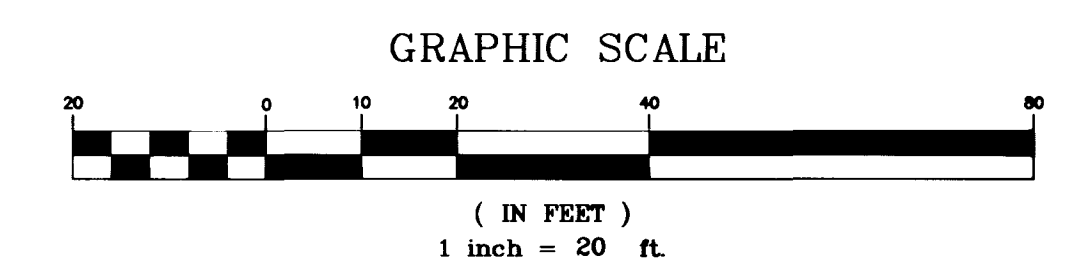

LEGEND

EXISTING [0.00] FL	PROPOSED [0.00] FL	FLOW LINE ELEVATION
[0.00] FG	[0.00] FG	FUTURE GRADE ELEVATION
[0.00] TC	[0.00] TC	FINISH GRADE ELEVATION
[0.00] C	[0.00] C	TOP OF CURB ELEVATION
F.F.=(0.00)	F.F.=0.00	FINISH FLOOR ELEVATION
(-50)	—○—	CONTOUR LINE
	→ 1.0% MIN.	DIRECTION OF FLOW WITH SLOPE AMOUNT
	[+ + +]	PUBLIC DRAINAGE EASEMENT
	[//]	SITE VISIBILITY RESTRICTION EASEMENT

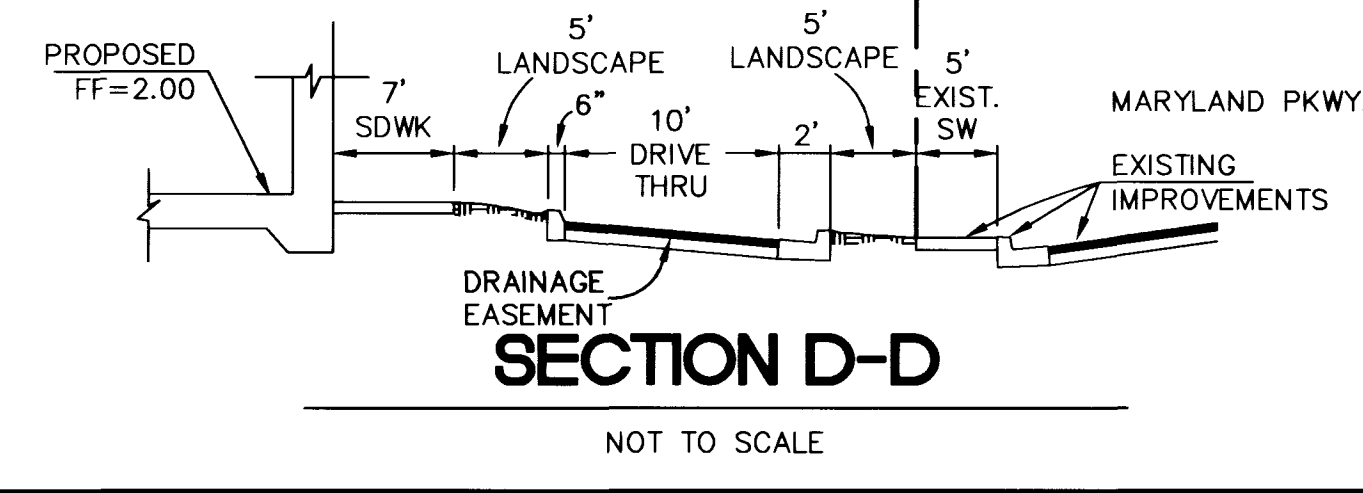
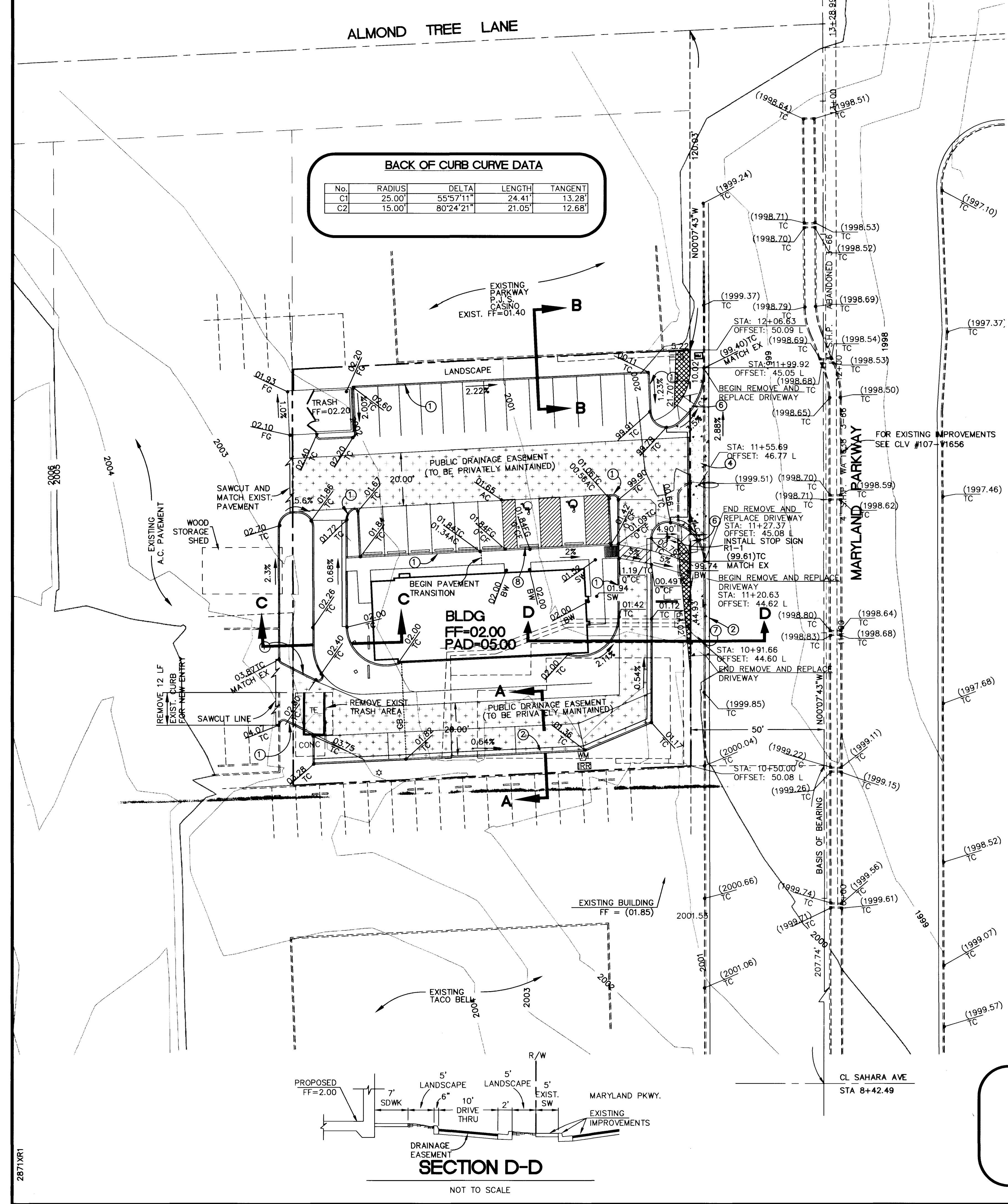
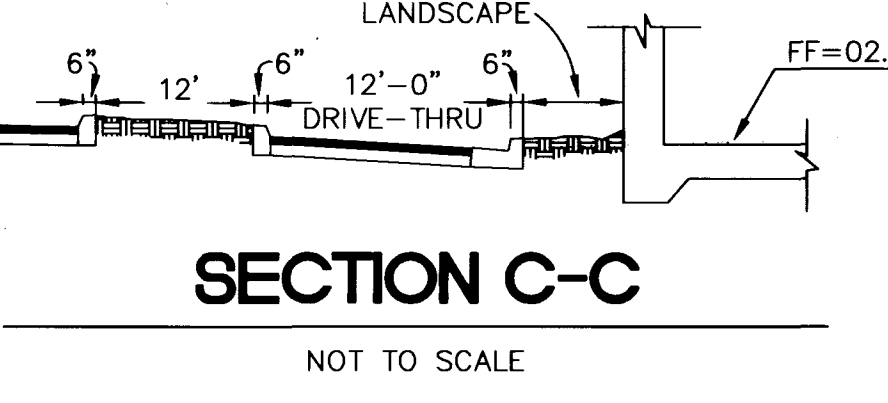
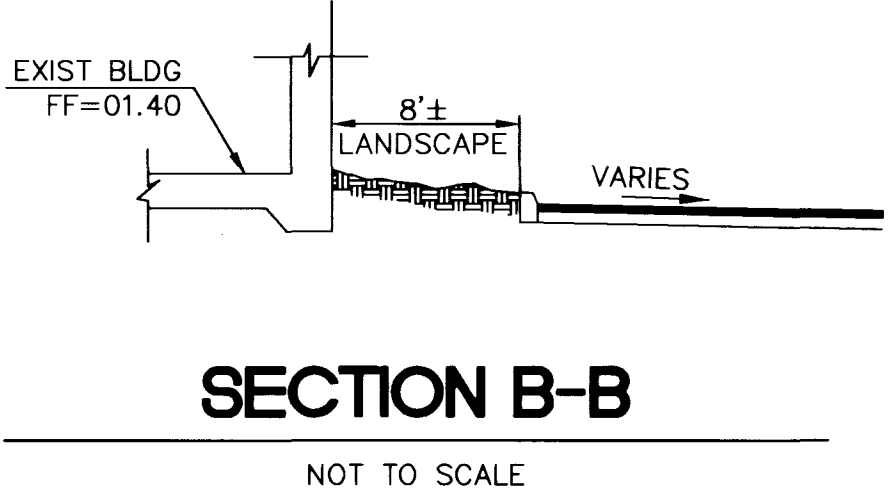
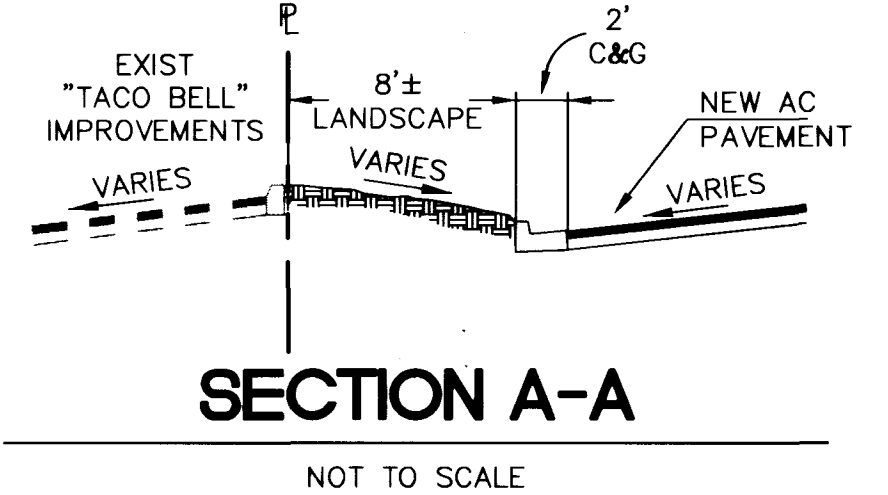

Call before you Overhead
1-702-593-6111
NEVADA POWER ENVIRONMENT AND SAFETY SERVICES DEPARTMENT

Call before you Dig
1-800-227-2600

- CONSTRUCTION NOTES
- CONSTRUCT "A" CURB PER DETAIL ON SHEET C6
 - CONSTRUCT "L" TYPE CURB & GUTTER PER C.C.A.S.D. #216
 - CONSTRUCT HANDICAP RAMP PER DETAIL SHEET C6
 - CONSTRUCT 8' WIDE CONCRETE VALLEY GUTTER PER C.C.A.S.D.#228
 - INSTALL 0" CURB FACE
 - CONSTRUCT HANDICAP RAMP PER C.C.A.S.D.#235 (CASE 1) A=4.5', B=9.5'
 - CONSTRUCT 4" CONCRETE SIDEWALK PER C.C.A.S.D.#234
 - CONSTRUCT PRECAST BUMPER PER ARCHITECTURAL DRAWINGS

CLARK COUNTY BENCHMARK

6C11 2SWS ELEVATION = 609.638 METERS (2000.12 FEET)
RIVET AND SQUARE ALUMINUM PLATE IN TOP OF CURB AT THE NORTHEAST CORNER OF SAHARA AVENUE AND MARYLAND PARKWAY, NEAR THE PC OF SAHARA AVENUE.

I CERTIFY THAT THE GRADING PLAN CONFORMS TO THE DRAINAGE STUDY, ON FILE WITH THE CITY OF LAS VEGAS, FOR THIS PROJECT. DRAINAGE STUDY WAS APPROVED IN OCTOBER, 1998.

DAVID D. WILSON, P.E. NO.8441
25 Jan 99 DATE



TRICON
5767 MOCKINGBIRD LANE
PARADISE VALLEY, ARIZONA
(602) 609-8745

CRS
CONSULTING ENGINEERS OF NEVADA, INC.
6700 S. PARADISE RD., # A-1
LAS VEGAS, NEVADA 89119
PHONE (702) 897-2825
FAX (702) 897-2826

GRADING PLAN
KFC AT MARYLAND/SAHARA

SHEET
9-98
DESIGNED BY:
KS/JHB
9-98
CHECKED BY:
RJM/DDW
10-98
PROJECT NO.:
20-22871
SCALE: 1" = 20' H&V
1" = 2" V&H

DATE
25 Jan 99

SHEET
C4
04 OF 06 SHEETS
DRAWING NO.
107-V3013

ALONG THE LANE

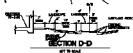
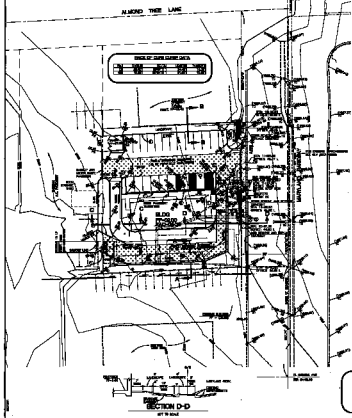
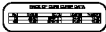

ALL DIMENSIONS ARE IN FEET AND INCHES UNLESS OTHERWISE NOTED.

FOR MORE INFORMATION, CALL OR VISIT OUR WEBSITE.
Call 1-800-888-8888
Overhead 1-800-888-8888
Low 1-800-888-8888
High 1-800-888-8888

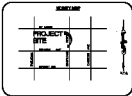

LEGEND

1/2" = 10'	1/4" = 10'	1/8" = 10'	1/16" = 10'
1/32" = 10'	1/64" = 10'	1/128" = 10'	1/256" = 10'
1/512" = 10'	1/1024" = 10'	1/2048" = 10'	1/4096" = 10'
1/8192" = 10'	1/16384" = 10'	1/32768" = 10'	1/65536" = 10'
1/131072" = 10'	1/262144" = 10'	1/524288" = 10'	1/1048576" = 10'
1/2097152" = 10'	1/4194304" = 10'	1/8388608" = 10'	1/16777216" = 10'
1/33554432" = 10'	1/67108864" = 10'	1/134217728" = 10'	1/268435456" = 10'
1/536870912" = 10'	1/1073741824" = 10'	1/2147483648" = 10'	1/4294967296" = 10'
1/8589934592" = 10'	1/17179869184" = 10'	1/34359738368" = 10'	1/68719476736" = 10'
1/137438953472" = 10'	1/274877906944" = 10'	1/549755813888" = 10'	1/1099511627776" = 10'
1/2199023255552" = 10'	1/4398046511104" = 10'	1/8796093022208" = 10'	1/17592186044416" = 10'
1/35184372088832" = 10'	1/70368744177664" = 10'	1/140737488355328" = 10'	1/281474976710656" = 10'
1/562949953421312" = 10'	1/1125899906842624" = 10'	1/2251799813685248" = 10'	1/4503599627370496" = 10'
1/9007199254740992" = 10'	1/18014398509481984" = 10'	1/36028797018963968" = 10'	1/72057594037927936" = 10'
1/144115188075855872" = 10'	1/288230376151711744" = 10'	1/576460752303423488" = 10'	1/1152921504606846976" = 10'
1/2305843009213693952" = 10'	1/4611686018427387904" = 10'	1/9223372036854775808" = 10'	1/18446744073709551616" = 10'
1/36893488147419103232" = 10'	1/73786976294838206464" = 10'	1/147573952589676412928" = 10'	1/295147905179352825856" = 10'
1/590295810358705651712" = 10'	1/1180591620717411303424" = 10'	1/2361183241434822606848" = 10'	1/4722366482869645213696" = 10'
1/9444732965739290427392" = 10'	1/18889465931478580854784" = 10'	1/37778931862957161709568" = 10'	1/75557863725914323419136" = 10'
1/151115727451828646838272" = 10'	1/302231454903657293676544" = 10'	1/604462909807314587353088" = 10'	1/1208925819614629174706176" = 10'
1/2417851639229258349412352" = 10'	1/4835703278458516698824704" = 10'	1/9671406556917033397649408" = 10'	1/19342813113834066795298816" = 10'
1/38685626227668133590597632" = 10'	1/77371252455336267181195264" = 10'	1/154742504910672534362390528" = 10'	1/309485009821345068724781056" = 10'
1/618970019642690137449562112" = 10'	1/1237940039285380274899124224" = 10'	1/2475880078570760549798248448" = 10'	1/4951760157141521099596488896" = 10'
1/9903520314283042199193977792" = 10'	1/19807040628566084398387955584" = 10'	1/39614081257132168796775911168" = 10'	1/79228162514264337593551822336" = 10'
1/158456325028528675187103644672" = 10'	1/316912650057057350374207289344" = 10'	1/633825300114114700748414578688" = 10'	1/1267650600228229401496829157376" = 10'
1/2535301200456458802993658314752" = 10'	1/5070602400912917605987316629504" = 10'	1/10141204801825835211974633259008" = 10'	1/20282409603651670423949266518016" = 10'
1/40564819207303340847898533036032" = 10'	1/81129638414606681695797066072064" = 10'	1/162259276829213363391594132144128" = 10'	1/324518553658426726783188264288256" = 10'
1/649037107316853453566376528576512" = 10'	1/1298074214633706907132753171151024" = 10'	1/2596148429267413814265506342302048" = 10'	1/5192296858534827628531012684604096" = 10'
1/10384593717069655257062025369208192" = 10'	1/20769187434139310514124050738416384" = 10'	1/41538374868278621028248101476832768" = 10'	1/83076749736557242056496202953665536" = 10'
1/166153499473114484112992405907331104" = 10'	1/332306998946228968225984811814662208" = 10'	1/664613997892457936451969623629324416" = 10'	1/1329227995784915872903939247258648832" = 10'
1/2658455991569831745807878494517297664" = 10'	1/5316911983139663491615756989034595328" = 10'	1/10633823966279326983231513978069190656" = 10'	1/21267647932558653966463027956138381312" = 10'
1/42535295865117307932926055912276762624" = 10'	1/85070591730234615865852111824553525248" = 10'	1/170141183460469231731704223649107050496" = 10'	1/340282366920938463463408447298214100992" = 10'
1/680564733841876926926816894596428201984" = 10'	1/1361129467683753853853633789192856403968" = 10'	1/2722258935367507707707267578385712807936" = 10'	1/5444517870735015415414535156771425615168" = 10'
1/1088903574147003083082907031354285123136" = 10'	1/2177807148294006166165814062708570246272" = 10'	1/4355614296588012332331628125417140492544" = 10'	1/8711228593176024664663256250834280985088" = 10'
1/17422457182352049329326512501668561970176" = 10'	1/34844914364704098658653025003337123940352" = 10'	1/69689828729408197317306050006674247880704" = 10'	1/139379657458816394634612100013348495761408" = 10'
1/278759314917632789269224200026696991522816" = 10'	1/557518629835265578538448400053393983045632" = 10'	1/1115037259670531157076896800106787966091264" = 10'	1/2230074519341062314153793600213575932182528" = 10'
1/4460149038682124628307587200427151844365056" = 10'	1/8920298077364249256615174400854303688730112" = 10'	1/17840596154728498513230348801708607377460224" = 10'	1/35681192309456997026460697603417214754920448" = 10'
1/71362384618913994052921395206834429509840896" = 10'	1/142724769237827988105842790413668859019681792" = 10'	1/285449538475655976211685580827337718039363584" = 10'	1/570899076951311952423371161654675460778767168" = 10'
1/1141798153902623904846742323309350921557534336" = 10'	1/2283596307805247809693484646618701843115068672" = 10'	1/4567192615610495619386969293237403686230137344" = 10'	1/91343852312209912387739385