

PAVEMENTS - ON-SITE		
TYPE OF TRAFFIC	ASPHALT (INCHES)	BASE COURSE (INCHES)
(A) AUTOMOBILE AND PICK-UP TRUCKS	2	6
(B) MAIN CORRIDORS AND TRUCK ACCESS	3	6

I CERTIFY THIS GRADING PLAN IS IN CONFORMANCE WITH THE APPROVED DRAINAGE STUDY ON FILE AT THE CITY OF LAS VEGAS FOR THIS PROJECT.

DATE \_\_\_\_\_

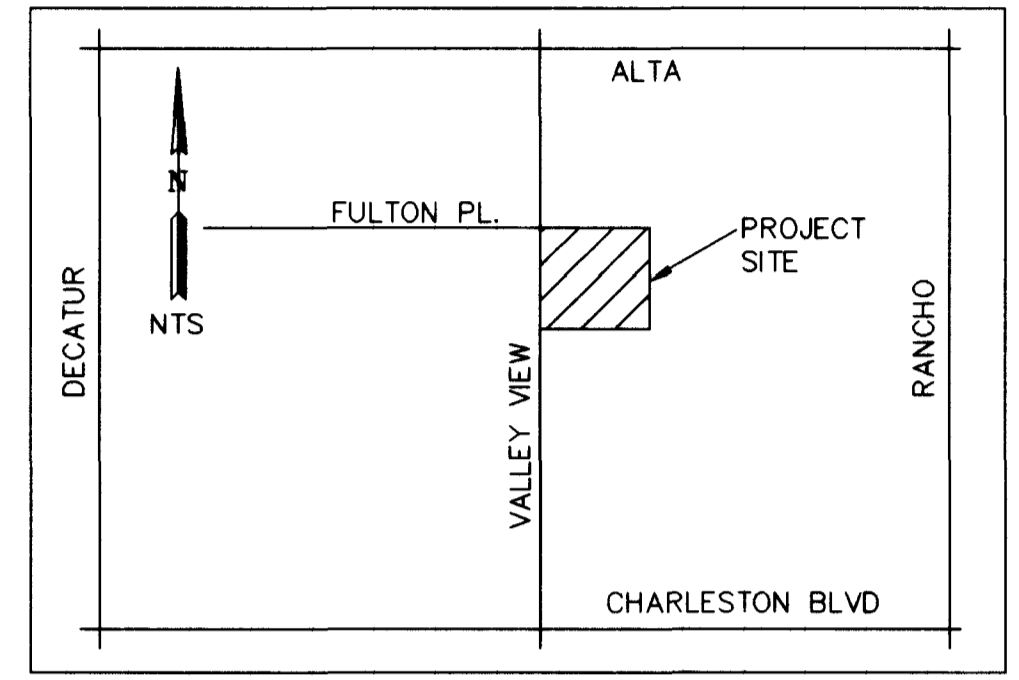

EXISTING PROPOSED		EXISTING PROPOSED	
---	RIGHT-OF-WAY	---	SCREEN / RETAINING WALL
---	CENTERLINE	---	WIRE OR CHAIN LINK FENCE
---	WATER LINE	---	TRASH ENCLOSURE
---	SANITARY SEWER LINE	---	GRADE BREAK
---	GAS LINE	---	FF=0.00 FINISH FLOOR
---	STORM DRAIN	---	CLEANOUT INVERT ELEVATION
---	POWER LINE / POWER POLE	---	FLOW LINE
---	TELEPHONE LINE	---	FINISH GRADE
●	FIRE HYDRANT	---	BACK OF SIDEWALK
○	WATER VALVE	---	B.S.W.
○	METERS / PULL BOXES	---	TOP OF CURB
○	REDUCER	---	TOP OF WALL
○	MANHOLE	---	TYPE "L" CURB & GUTTER
○	CLEANOUT	---	TYPE "A" CURB
○	STREET LIGHT	---	R.D. ROOF DRAIN
---	CONTOUR	---	END RETAINING WALL
---	A.C. PAVING	---	ROOF DRAIN
---	GRAVEL	---	

**BENCHMARK**  
 2LV01 3166 BEING A RIVET & PLATE IN TOP OF CURB, NW RETURN ALTA DRIVE AND VALLEY VIEW BLVD.  
 ELEVATION = 2140.46. CITY OF LAS VEGAS BM.  
 ELEVATION = 652.4143 (M) CITY OF LAS VEGAS BM.  
 NORTH AMERICAN DATUM OF 1988.  
**BASIS OF BEARINGS**  
 N 00°00'00" E BEING THE CENTERLINE OF VALLEY VIEW BOULEVARD BETWEEN CHARLESTON & ALTA.

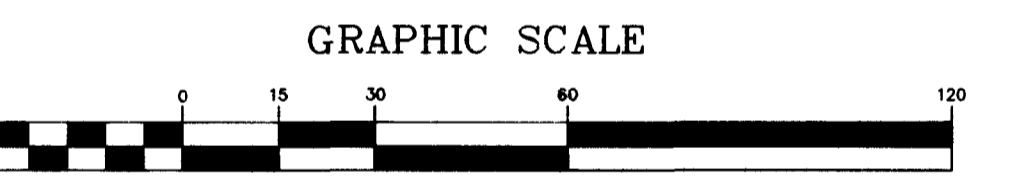

- CONSTRUCTION NOTES**
- (A) INSTALL TYPE "A" PAVEMENT
  - (B) INSTALL TYPE "B" PAVEMENT
  - (C) INSTALL 8" WIDE VALLEY GUTTER PER CLARK COUNTY AREA STANDARD DRAWING NO. 228
  - (D) INSTALL SW PER (4) (C4.00)
  - (E) TURN DOWN CURB PER (10) (C4.00)
  - (F) INSTALL "L" TYPE CURB PER (2) (C4.00)
  - (G) INSTALL "A" TYPE CURB PER (2) (C4.00)

- GRADING NOTES**
1. SLOPES 4:1 OR STEEPER AND FINE-GRAINED MATERIALS THAT HAVE BEEN DISTURBED (SANDY AND SILTY MATERIALS) SHOULD BE PROTECTED WITH BURLAP OR OTHER EROSION CONTROL FABRIC/MATERIAL, UNLESS OTHERWISE SPECIFIED BY LANDSCAPE DRAWINGS AND SPECIFICATIONS OR THE SOILS REPORT.
  2. CONTRACTOR SHALL DETERMINE HIS OWN FOOTING OR BASEMENT EXCAVATION QUANTITIES, EVEN THOUGH SHOWN ON ROUGH GRADING PLANS. ADDITIONALLY, STRUCTURE BACKFILL COSTS SHOULD BE INCLUDED IN THE COST OF THE STRUCTURE, UNLESS OTHERWISE SPECIFIED IN THE CONTRACT DOCUMENTS.
  3. CONTRACTOR SHALL NOTIFY MARTIN & MARTIN, INC. WITHIN 24 HOURS OF OMISSIONS AND ERRORS DISCOVERED ON PLANS. MARTIN & MARTIN, INC. WILL NOT BE RESPONSIBLE FOR ANY "CORRECTIVE" WORK DONE BY OTHERS.
  4. CONTRACTOR TO ENSURE POSITIVE DRAINAGE. NO PONDING ALLOWED.
  5. REFERENCE GEOTECHNICAL REPORT

MARTIN & MARTIN ASSUMES NO RESPONSIBILITY FOR EXISTING UTILITY LOCATIONS. THE UTILITIES SHOWN ON THIS DRAWING HAVE BEEN PLOTTED FROM THE BEST AVAILABLE INFORMATION. IT IS, HOWEVER, THE CONTRACTOR'S RESPONSIBILITY TO FIELD VERIFY THE LOCATION OF ALL UTILITIES PRIOR TO THE COMMENCEMENT OF ANY CONSTRUCTION. CONTRACTOR TO FIELD VERIFY ALL EXISTING SITE CONDITIONS PRIOR TO CONSTRUCTION. IF A CONFLICT EXISTS BETWEEN WHAT IS SHOWN ON THESE DRAWINGS AND WHAT EXISTS IN THE FIELD, CONTRACTOR IS TO NOTIFY THE ARCHITECT OR ENGINEER IMMEDIATELY.

h:\cod\1569\opscetr 4-16-98 7:18:49 am PST



**JMA ARCHITECTS, INC.**  
 Architecture  
 Research and Planning  
 Interior and Graphic Design  
 Landscape Architecture  
 4292 S. Maryland Parkway  
 Las Vegas, Nevada 89109  
 (702) 731-2033

**MARTIN & MARTIN**  
 MARTIN & MARTIN CIVIL ENGINEERS  
 1909 S. JONES BLVD.  
 SUITE B  
 LAS VEGAS, NV 89102  
 PHONE (702) 248-8000

The Contractor shall check and verify all dimensions and report all errors and omissions to this office prior to commencing work. These drawings are not to be scaled.

Copyright 1992 JMA Architects & Engineers ©

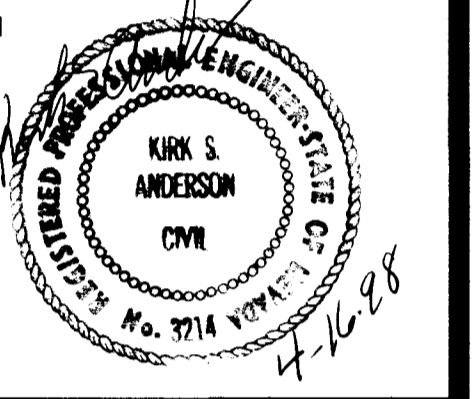

Revisions

No.	Date	Description

Date 4-20-98  
 Drawn R. YOUNG  
 Checked  
 Project No. 1569  
 Project  
**LAS VEGAS VALLEY WATER DISTRICT OPERATIONS CENTER**

**GRADING PLAN**

Drawing No.

**C2.00**

