

APN: 125-22-403-008

APN: 125-22-410-011

APN: 125-22-410-012

APN: 125-22-410-013

APN: 125-22-410-014

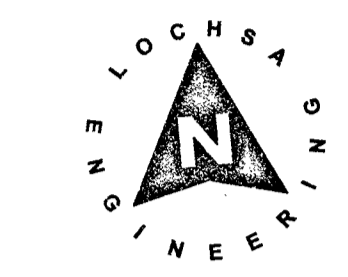
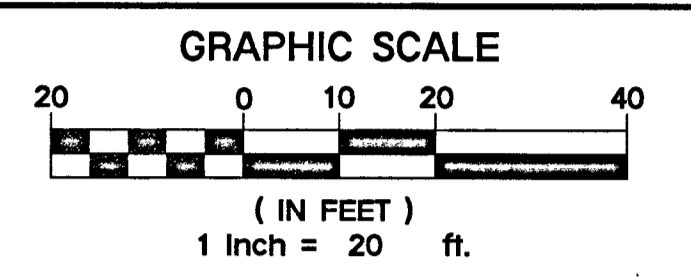
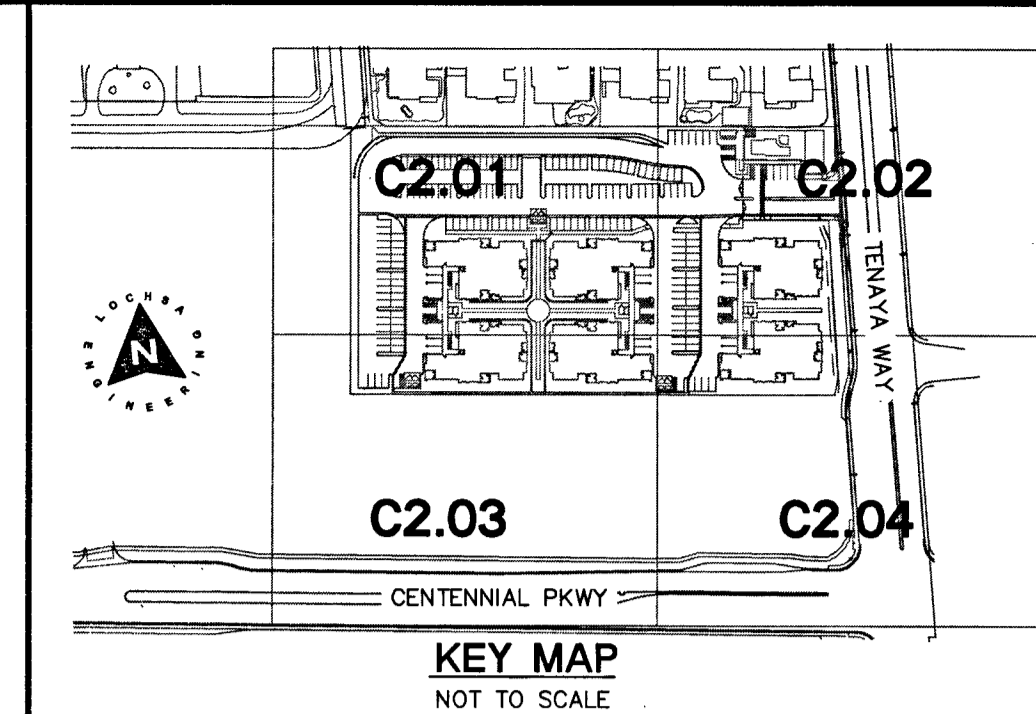

**STRIPING NOTES:**

1. INSTALL 36" R1-1 STOP SIGN.
2. INSTALL 30" R1-1 STOP SIGN.
3. INSTALL 9' X 18' PARKING WITH 4" WHITE PAINTED LINES. (TYPICAL)
4. INSTALL BLUE AND WHITE PAINTED HANDICAP PAVEMENT MARKINGS PER DETAIL 5 ON C6.01
5. INSTALL 4" WHITE PAINTED HATCH LINES 3' O.C. @ 45°.
6. INSTALL R7-8 "MINIMUM \$250 FINE FOR USE BY OTHERS" NRS 484.408 SIGN (12" X 18") PER DETAIL 6 ON C6.01
7. INSTALL R7-8 "MINIMUM \$250 FINE FOR USE BY OTHERS" NRS 484.408 SIGN "VAN ACCESSIBLE" (12" X 18") PER DETAIL 6 ON C6.01.
8. GATE AND FENCING, BY OTHERS.
9. REMOVE EXIST STREETLIGHT FOUNDATION AND RELOCATE EXIST STREETLIGHT STANDARD WITH R2-1 (35 MPH) SIGN. INTERCEPT EXIST CONDUIT AND INSTALL EXIST STREETLIGHT FOUNDATION PER CCAUSD 320 & 321. RE-PULL CONDUCTORS
10. INTERCEPT EXIST STREETLIGHT CONDUIT. INSTALL LED LUMINAIRE ON STREETLIGHT STANDARD PER CCAUSD 314 AND STREETLIGHT FOUNDATION PER CCAUSD 320 & 321. RE-PULL CONDUCTORS OR INSTALL NEW IF NEEDED.
11. INSTALL 8' X 18' COMPACT PARKING WITH 4" WHITE PAINTED LINES.
12. INSTALL PARKING BUMPER OR CURB PER DETAIL 7 ON C6.01.
13. TRASH ENCLOSURE PER ARCHITECTURAL PLANS.

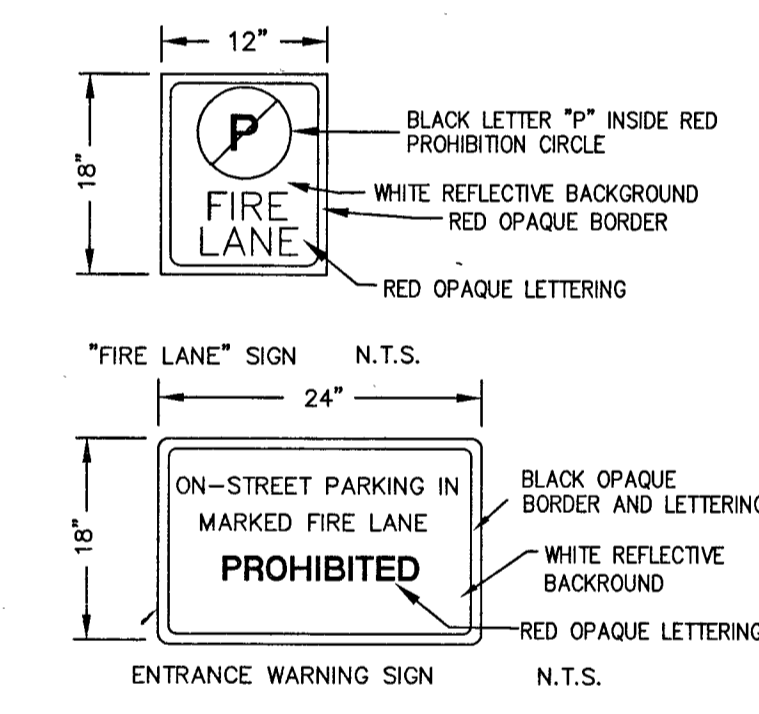

**CITY OF LAS VEGAS  
FIRE DEPARTMENT APPROVAL**

BY: *[Signature]* DATE: 4-6-15

APPROVAL OF THESE PLANS SHALL NOT BE CONSTRUED TO BE A PERMIT FOR, OR AN APPROVAL OF, ANY VIOLATION OF ANY OF THE PROVISIONS OF THE STATE OR COUNTY LAWS. FIRE FLOW 3250 GPM AT 20 P.S.I. RESIDUAL.

**NOTE:**  
LOCHSA ENGINEERING ASSUMES NO RESPONSIBILITY FOR EXISTING UTILITY LOCATIONS AND ELEVATIONS. THE UTILITIES SHOWN ON THIS PLAN ARE FROM THE BEST AVAILABLE INFORMATION. IT IS THE CONTRACTOR'S RESPONSIBILITY TO FIELD VERIFY THE LOCATION AND ELEVATION OF ALL UTILITIES, INCLUDING BUT NOT LIMITED TO, THE WATER, FIRE, SANITARY SEWER, STORM SEWER, TELEPHONE, POWER, GAS, AND IRRIGATION LINES PRIOR TO THE COMMENCEMENT OF CONSTRUCTION. IF CONFLICT EXISTS IN THE FIELD, THE CONTRACTOR IS TO NOTIFY THE PROJECT ARCHITECT, OWNER'S REPRESENTATIVE AND THE PROJECT ENGINEER IMMEDIATELY.

**SAFETY ALERT**  
Call before you dig  
Call Before You Overhead  
Call Before You UnderGround

1-702-227-2929  
1-702-432-5300  
FOLLOW THE UTILITY SYMBOLS BY DETAILING 1-800-227-2800

SHIRON DEVELOPMENT LLC  
1422 LEGACY BLVD SUITE 80032  
CONTACT: JAMES LIMERICK 702-251-0789

**Lochsa**  
engineering

6345 South Jones Blvd  
Suite 100  
Las Vegas, NV 89118  
Phone (702) 365-8312  
Fax (702) 365-8317  
www.lochsa.com

HORIZONTAL CONTROL PLANS  
SHEET 1 OF 4

PAXTON WALK  
CITY OF LAS VEGAS  
LAS VEGAS, NEVADA

SHEET No. 131054  
DATE: 03/23/2015  
SCALE: 1"=20'  
DRAWN BY: JNC  
DESIGNED BY: JNC  
CHECKED BY: GMM

03/23/2015  
SHEET No. C2.01  
# 57524  
10746425

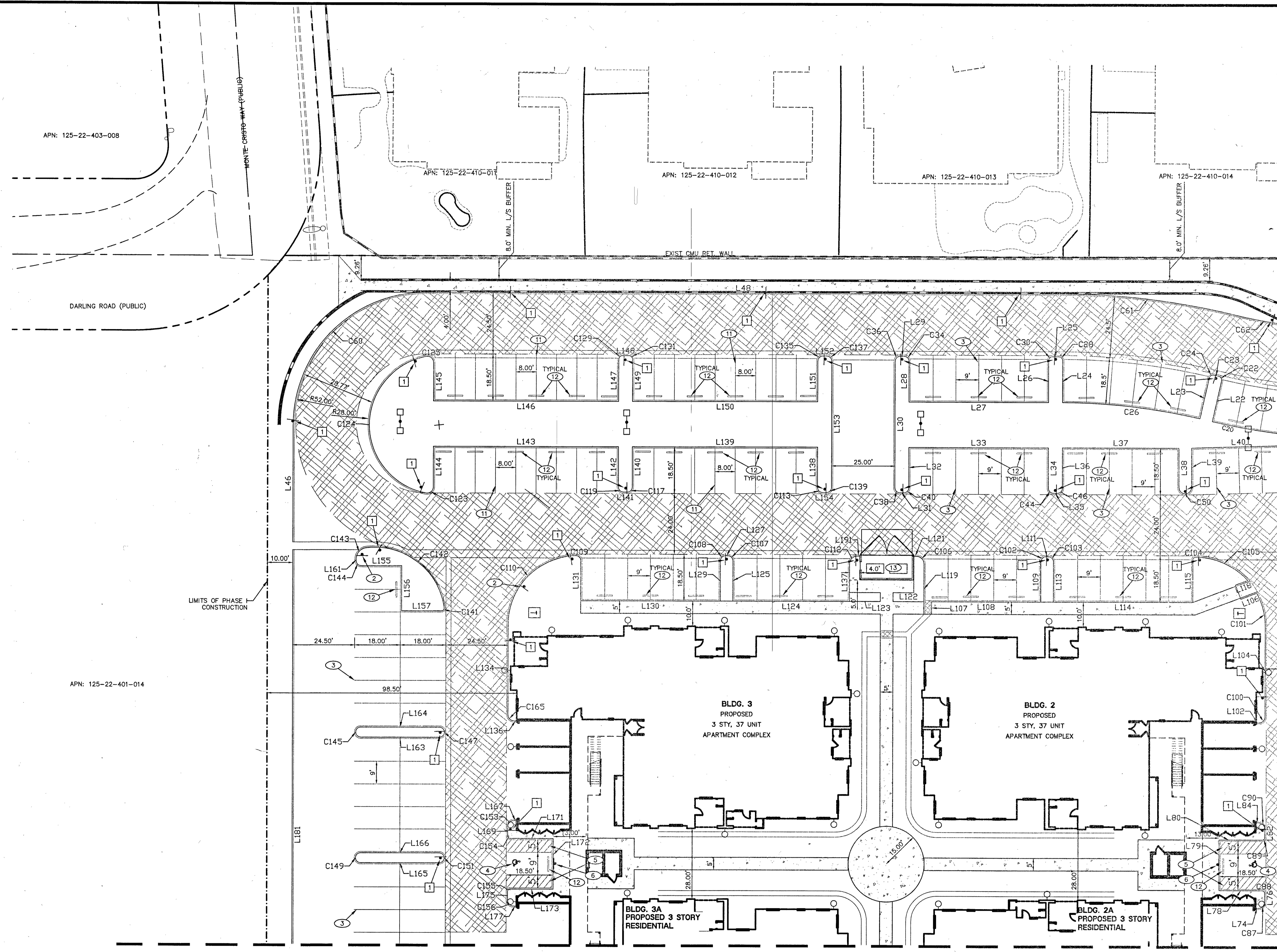

MATCH LINE - SEE SHEET C2.03

MATCH LINE - SEE SHEET C2.02

**SIGHT VISIBILITY ZONE**  
SIGHT VISIBILITY ZONE AREA

**NOTE:**  
NO WALLS, FENCES, SHRUBS, UTILITY APPURTENANCES OR ANY OTHER OBJECT, OTHER THAN TRAFFIC CONTROL DEVICES, FIRE HYDRANTS, TREES AND STREET LIGHT POOLS, MAY BE CONSTRUCTED OR INSTALLED WITHIN THE SIGHT VISIBILITY ZONE UNLESS SAID OBJECT IS MAINTAINED AT LESS THAN 24" IN HEIGHT MEASURED FROM TOP OF CURB OR WHERE NO CURB EXISTS, A HEIGHT OF 7' MEASURED FROM THE TOP OF ADJACENT ASPHALT, GRAVEL OR PAVEMENT STREET SURFACE. THIS RESTRICTION EXTENDS ALONG THE SIGHT VISIBILITY LINE THROUGH LANDSCAPED MEDIANS.

**FIRE ACCESS NOTES/ LEGEND:**

1. INSTALL FIRE LANE SIGN AT A MAXIMUM DISTANCE OF EVERY 100' ALONG THE FIRE LANE PER FIRE LANE DETAIL SHEET C2.01
2. INSTALL FIRE LANE ENTRANCE WARNING SIGN PER DETAIL ON SHEET C2.01.

NOTE: CURB SHALL BE PAINTED ADJACENT TO DESIGNATED FIRE TRUCK ROUTE

24' WIDE FIRE TRUCK ACCESSIBLE ROUTE TURNING RADIUS OF 28' & 52' MIN.

**A.P.N.:**  
125-22-401-014

**BASIS OF BEARINGS:**  
SOUTH 84°08'56" EAST, BEING THE BEARING OF THE SOUTH LINE OF THE SOUTHWEST QUARTER (SW 1/4) OF SECTION 22, TOWNSHIP 19 SOUTH, RANGE 60 EAST, M.D.M., CLARK COUNTY NEVADA AS SHOWN IN FILE 89 OF SURVEY MAPS, PAGE 3, OFFICIAL RECORDS OF CLARK COUNTY, NEVADA.

**BENCHMARK:**  
CITY OF LAS VEGAS BENCHMARK NO. BLV90 22144 BEING A RIVET AND PLATE IN TOP OF CURB @ NORTHEAST CORNER OF BUFFALO DRIVE AND DEER SPRINGS. NAVD 88 ELEVATION = 7235.04 METERS ELEVATION = 2390.10 FEET (NAVD 88 DATUM)

CL OR SURVEY LINE	EASEMENT LINE	DESCRIPTION:	CONTOUR LINES	EDGE OF PAVEMENT	"A" TYPE CURBS	"L" TYPE CURBS	WALLS	FENCES	AC PAVEMENT	CONCRETE	SPOT ELEVATIONS	SIGNS	MANHOLE W/ DESCRIPTION	MANHOLE DESCRIPTIONS	FIRE HYDRANTS	GATE VALVES	REDUCERS	CLEAN OUTS	UTILITY BOX OR VAULT	BACKWATER VALVES	100W HPS STREETLIGHTS	150W HPS STREETLIGHTS	200W HPS STREETLIGHTS	250W HPS STREETLIGHTS	
---	---	EXISTING:	---	---	---	---	---	---	---	---	---	---	---	---	---	---	---	---	---	---	---	---	---	---	---
---	---	PROPOSED:	(2122)	---	---	---	---	---	---	---	(12.33) BC	---	---	---	---	---	---	---	---	(BWV)	---	---	---	---	