

NDOT CONSTRUCTION NOTE
NO CONSTRUCTION WITHIN NDOT RIGHT OF WAY UNTIL APPROVAL OF NDOT ENCROACHMENT PERMIT

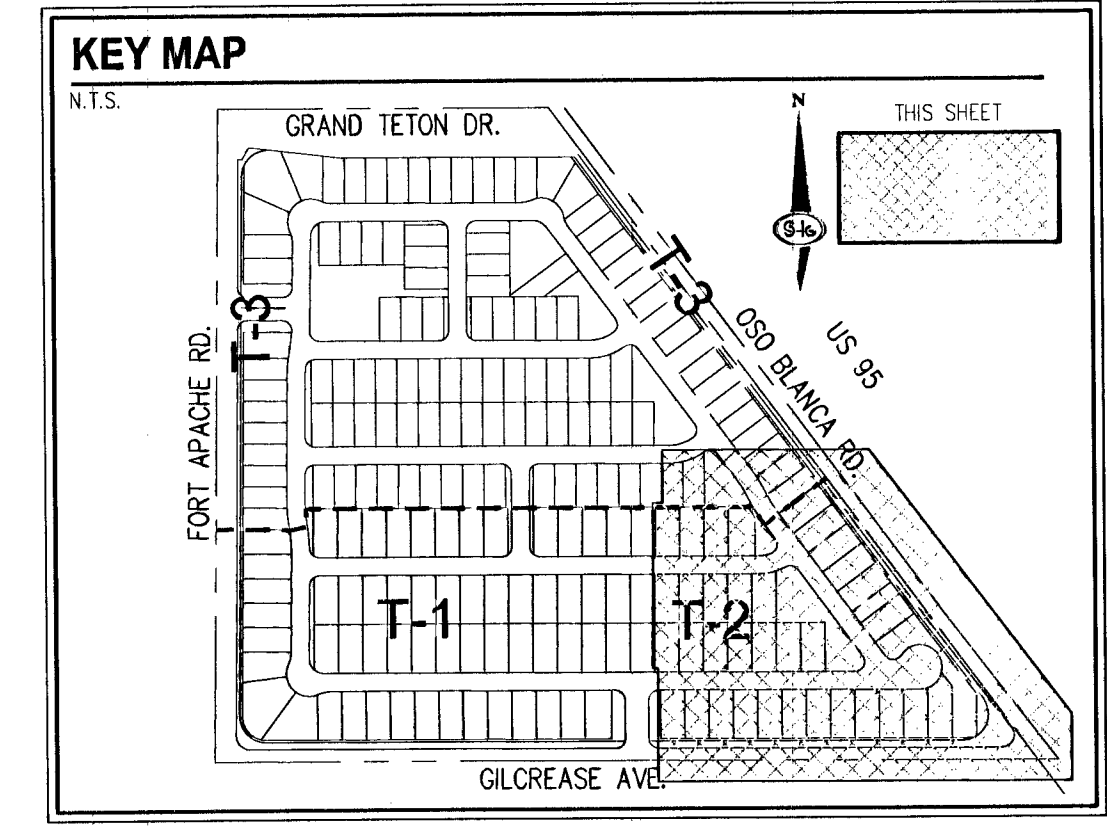

- ### LEGEND
- STREET NAME SIGN (D-3, 2 PER POLE)
 - STOP SIGN W/POST (R1-1)
 - NO PARKING ANYTIME SIGN (R7-1APR)
 - NO PARKING FIRE LANE SIGN (R7-1M0D)
 - OM-3R SIGN
 - TRAFFIC LANE SHIFT SIGN (W4-2R)
 - CA22-3-160 LA-NW-UNV-BLP
 - CA22-3-160 LA-NW-UNV-BLP
 - EX 150 WATT ST. LIGHT LUMINAIRE
 - ERS200XBV5574GRAVEL
 - EX 250 WATT ST. LIGHT LUMINAIRE
 -
 -
 - STREETLIGHT PULL BOX
 - POWER SERVICE PEDESTAL
 - TRAFFIC SIGN (AS INDICATED)
 - EXISTING TRAFFIC SIGN (AS INDICATED)
 - REFLECTIVE RAISED PAVEMENT MARKERS
 - SIGHT VISIBILITY ZONE
 - EXISTING STRIPING TO BE OBLITERATED
 - PROPOSED STRIPING
- SEE SHEET C-2 FOR ABBREVIATIONS & QUANTITIES

- ### TRAFFIC NOTES
- 1 INSTALL 250 WATT STREETLIGHT LUMINAIRE PER CAUSAID NO. 314, 350 & 351.
 - 2 INSTALL LED FIXTURE CA22-3-160 LA-NW-UNV-BLP PER TOWN CENTER STANDARDS.
 - 3 INSTALL LED FIXTURE CA22-3-160 LA-NW-UNV-BLP PER TOWN CENTER STANDARDS.
 - 4 INSTALL 2\"/>
 - 5 INSTALL 1-1/4\"/>
 - 6 INSTALL NO. 3-1/2 THW CUB PER CAUSAID NO. 325
 - 7 STUB & CAP CONDUIT 5' PAST PHASE LINE
 - 8 4\"/>
 - 9 INSTALL P-30 PULL BOX PER CAUSAID NO. 761 WITH FIBER OPTIC ON THE LID
 - 10 INSTALL #7 PULL BOX PER CAUSAID NO. 236 & 707 WITH "TRAFFIC SIGNAL" ON THE LID
 - 11 INSTALL BLUE REFLECTIVE RAISED PAVEMENT MARKERS PER 2009 IFC APPENDIX C, SECT C107.1
 - 12 PAINT CURB RED 15' EACH SIDE OF FIRE HYDRANT FOR A TOTAL OF 30' OR AS SHOWN ON PLAN (CURB LENGTH PERMITTING)
 - 13 INSTALL "NO PARKING ANYTIME" SIGN (R7-1A)
 - 14 INSTALL 30\"/>
 - 15 INSTALL "NO PARKING" SIGN (R7-1APR)
 - 16 INSTALL 9\"/>
 - 17 INSTALL 12\"/>
 - 18 INSTALL OM-3R SIGN
 - 19 INSTALL "LANE SHIFT" SIGN (W4-2R)
 - 20 INSTALL TYPE I CENTERLINE PER CAUSAID NO. 244
 - 21 INSTALL TYPE 4 LANE LINE PER CAUSAID NO. 244
 - 22 INSTALL 2\"/>
 - 23 OBLITERATE EX. STRIPING
 - 24 INSTALL 4\"/>
 - 25 INSTALL MEDIAN NOSE MARKINGS PER CAUSAID NO. 245
 - 26 INSTALL CHEVRONS PER CAUSAID NO. 245
 - 27 CONNECT TO EX. CONDUIT, SIZE AND TYPE PER PLAN
 - 28 INSTALL TURN - LANE USE ARROW
 - 29 INSTALL 3\"/>
 - 30 INSTALL 2\"/>
 - 31 INSTALL BARRICADE AND END OF ROAD MARKERS
 - 32 EXISTING STRIPING TO REMAIN
 - 33 EXISTING SIGN TO BE RELOCATED PER PLAN

BENCHMARK
BENCHMARK NUMBER: 6L160 17NWS
RIVET AND PLATE IN TOP OF CURB AT SW CORNER GILCREASE AVENUE AND OSO BLANCA ROAD (W FRONTAGE ROAD)
ELEVATION = 2531.88 FEET, 802.1998 METERS, N.A.V.D., 88 DATUM

BASIS OF BEARINGS
SOUTH 89°53'28\"/>

Call before you Dig
1-702-455-6000
CLARK COUNTY TRAFFIC OPERATIONS
1-702-432-5300
FREeway AND ARTERIAL SYSTEM OF TRANSPORTATION

Call before you Dig
Call 811
1-800-227-2600
CLARK COUNTY TRAFFIC OPERATIONS
1-702-455-6000

Call before you Dig
1-702-227-2929

SLATER HANIFAN GROUP
S-I-G
CONSULTING ENGINEERS & PLANNERS
5740 S. ARVILLE STREET #216, LAS VEGAS, NV 89118
PHONE (702) 284-5300 FAX (702) 284-5389

DATE: 09/04/2014
DRAFTER: JDA
DESIGNER: JDA
CHECKED: DJP
PROJECT NO. DRH1225-001

D.R. HORTON
OSO BLANCA & GRAND TETON PHASE I
TRAFFIC PLAN II

T-2
SHEET 32 OF 33
H# 50765
CLV# 107Y4833-1