

Call before you Dig.
 1-800-227-2600
 UNDERGROUND SERVICE (USA)

CALL BEFORE YOU DO OVERHEAD
 1-702-593-6111

- NOTES:**
- CONTRACTOR SHALL PROTECT IN PLACE ALL EXISTING FEATURES SUCH AS POWER POLES, ELECTRICAL BOXES, AREA LIGHTS, WALLS, FENCES AND GATES. ANY EXISTING FEATURES DAMAGED SHALL BE REPLACED AT CONTRACTOR'S EXPENSE.
 - RESTORE EXISTING GRADING IN-KIND TO ITS PRE-CONSTRUCTION CONDITION.
 - CONTRACTOR MAY TRIM OVER HANGING TREES ONLY AS NECESSARY TO PERFORM THE WORK. MAXIMUM LIMIT OF TRIMMING SHALL BE TO DRAINAGE EASEMENT LIMITS. ALL TRIMMING SHALL BE PERFORMED WITH SAWS, PROVIDING A CLEAN CUT. ALL BROKEN BRANCHES SHALL BE CUT CLEAN. WORK SHALL BE DONE BY A PROFESSIONAL ARBORIST.
 - SEE R- SHEETS FOR STREET IMPROVEMENTS AND REMOVALS

PEAK DRIVE
 1"=20' HORIZ 1"=4' VERT

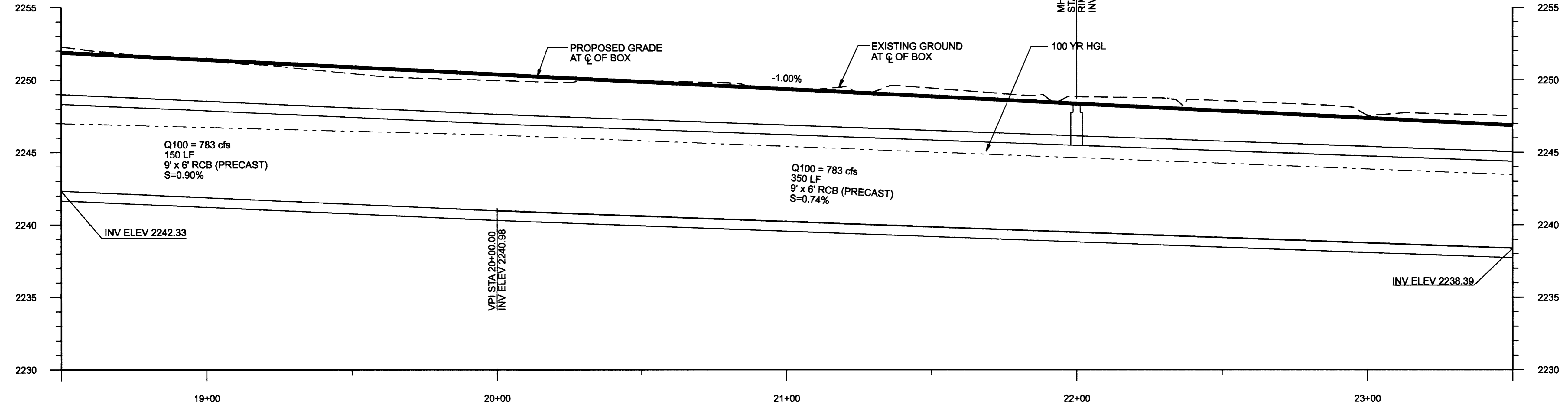

NO.	DATE	DESCRIPTION	APP'D

DEPARTMENT OF PUBLIC WORKS
ENGINEERING DESIGN SECTION
 CITY ENGINEER: JORGE A. CERVANTES P.E., P.T.O.E.
 PROJECT MANAGER: JOEL L. CHRISTENSEN, P.E.
 DESIGNED BY: B. SANCHEZ HORIZONTAL SCALE: 1" = 20'
 DRAWN BY: T. UY VERTICAL SCALE: 1" = 4'
 CHECKED BY: G. THOMPSON DATE: 17-OCTOBER-2006

TITLE: PEAK DRIVE STORM DRAIN
FROM JONES BLVD. TO MICHAEL WAY
SHEET: BOX CULVERT PLAN AND PROFILE
STA 18+50.00 - STA 23+50.00

ENGINEER
 GREGG V. THOMPSON
 No. 17534
 CIVIL
 8-21-01 8:10 6-30-08

Sheet **P-6**
 12 of 33
 DRAWING NO. 327-V271