

BENCHMARK PER NGVD29
 BENCH MARK: [2405.269] CITY OF LAS VEGAS DATUM.
 STATION 0LV00 16N4, RIVET AND PLATE IN TOP OF CURB,
 SW RETURN OF CHEYENNE AVENUE AND SOARING GULLS DRIVE.

BASIS OF BEARINGS
 SOUTH 88°04'25" EAST BEING THE NORTH LINE OF THE
 NE 1/4 OF THE SW 1/4 OF SECTION 9, TOWNSHIP 20 SOUTH,
 RANGE 60 EAST, MDM, CLARK COUNTY, NEVADA
 NOTE: LOT BREAKOUT PER FILE 69, PAGE 72 OF SURVEYS.

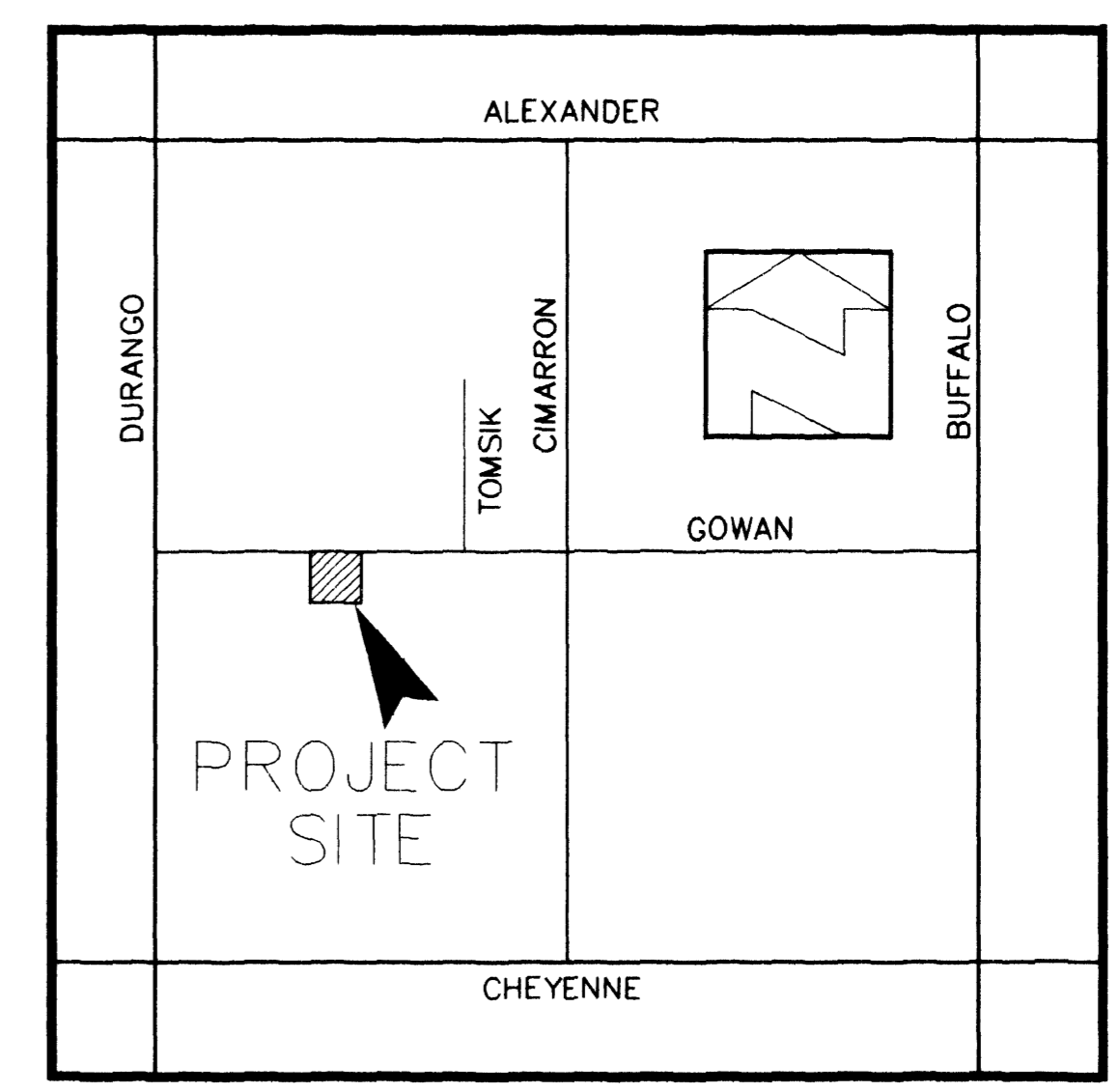

LOCATION
 SCALE: NONE

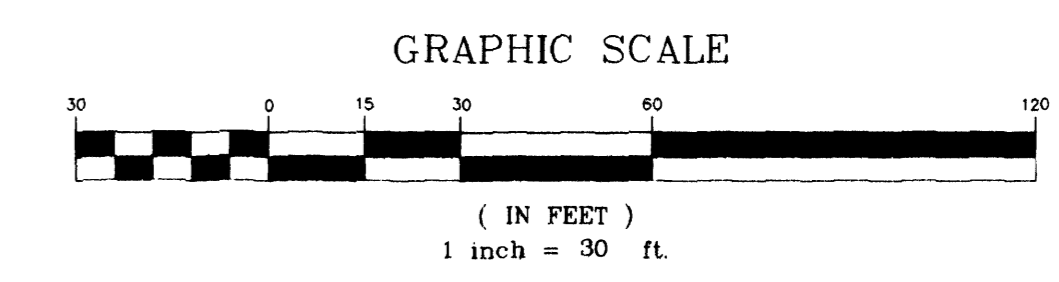

SIDEWALK RAMP DATA

NO.	A	B
1	8'	8'
2	4.5'	12'

REFER TO UNIFORM STANDARD DRAWINGS
 CLARK COUNTY AREA DWG. NO. 235 - CASE III

2 working days
Call before you Dig
 1-800-227-2600

- CONSTRUCTION NOTES**
- ① 5' SIDEWALK
 - ② 2' CURB & GUTTER
 - ③ 8' WIDE VALLEY GUTTER PER STD. DWG. #228

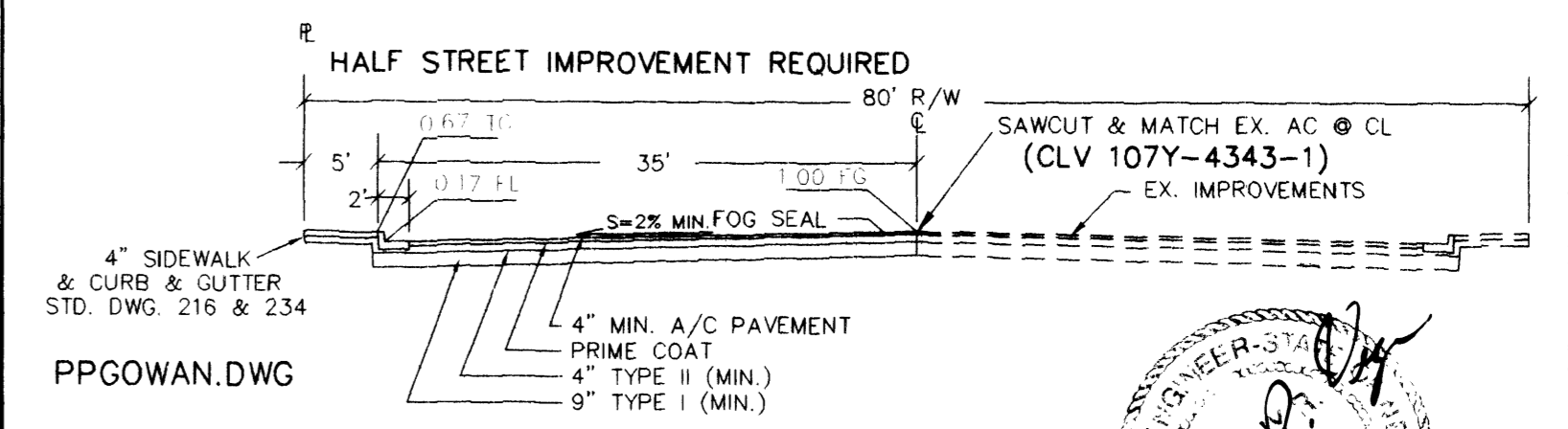

GOWAN ROAD
 NO SCALE
 CLV STD. DWG #205

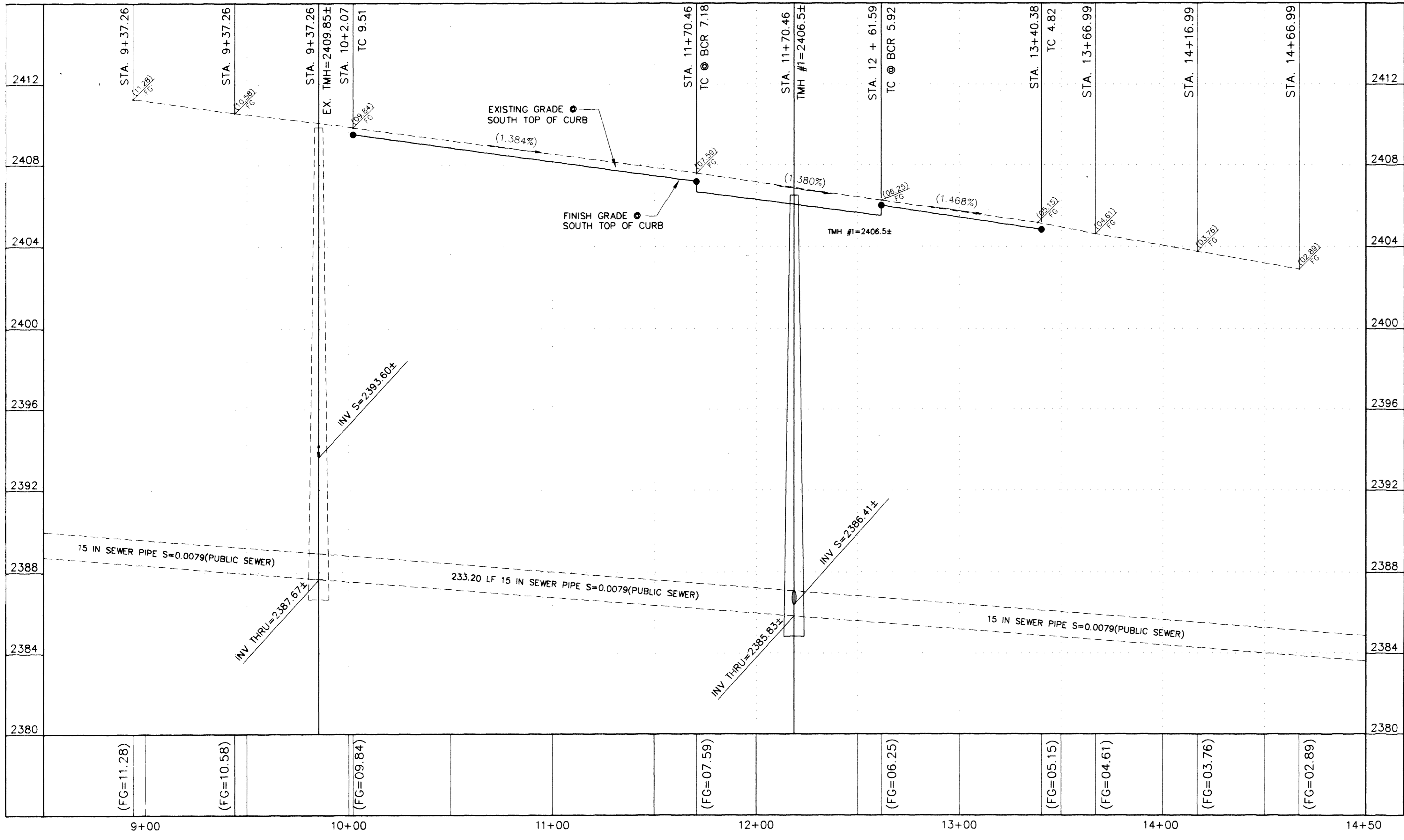

<p>HEARTHSTONE HOMEBUILDERS, INC. 1220 W. LEGACIE BLVD. SUITE 89120 LAS VEGAS, NEVADA 89120 PH: (702) 632-3248 FAX: (702) 651-8218</p>	<p>JOHNNY R. VEGA 4817 W. GILMORE AVE. SUITE 89130 LAS VEGAS, NEVADA 89130 PH: (702) 645-9216 FAX: 645-9460</p>
<p>GOWAN ROAD PLAN & PROFILE</p>	<p>PINE COVE SUBDIVISION</p>
<p>DATE: 7/23/02 DRAWN BY: J. VEGA CHECKED BY: J. VEGA APPROVED BY: J. VEGA</p>	<p>DATE: 7/23/02 DRAWN BY: J. VEGA CHECKED BY: J. VEGA APPROVED BY: J. VEGA</p>
<p>SEAL CIVIL ENGINEER STATE OF NEVADA NO. 5967</p>	<p>SEAL CIVIL ENGINEER STATE OF NEVADA NO. 5967</p>
<p>SHEET C6 6 OF 7 SHEETS</p>	<p>DRAWING NO. 307Y-4714-1</p>

44440