

AVOID HITTING UNDERGROUND TRAFFIC SIGNAL SYSTEMS AND STREET LIGHT SYSTEMS CONDUITS 72" OR DEEPER.

Call before you Dig
1-702-455-7511
CLARK COUNTY TRAFFIC OPERATIONS AND 1-702-229-6611
LAS VEGAS AREA COMPUTERIZED TRAFFIC SYSTEM

Avoid cutting underground utility lines. It's costly.

Call before you Dig
1-800-227-2600

Avoid overhead power line contact. It's costly.

Call before you Overhead
1-702-227-2929

BASIS OF BEARINGS
THE BASIS OF BEARINGS FOR THIS PROJECT IS NORTH 00°08'16" EAST BEING THE EAST LINE OF THE NORTHWEST QUARTER (NE 1/4) OF THE SECTION 24, TOWNSHIP 19 SOUTH, RANGE 98 EAST, M.D.M., CLARK COUNTY, NEVADA, AS SHOWN ON A RECORD OF SURVEY ON FILE IN THE CLARK COUNTY, NEVADA, RECORDER'S OFFICE IN FILE 123 AT PAGE 32.

PROJECT BENCHMARK
PROJECT DATUM: NORTH AMERICAN VERTICAL DATUM OF 1988 (NAVD88)

CLARK COUNTY VERTICAL CONTROL: 1C00-6N6
NAVD88 ELEVATION: 787.794 METERS (2584.62 FEET)

RIVET AND SQUARE ALUMINUM PLATE IN A CONCRETE CYLINDER, LOCATED 25' SOUTH & 50' EAST OF GRAND CANYON DRIVE AND RED COACH AVENUE, 1' WEST OF ELECTRICAL VAULT.

CITY OF LAS VEGAS BENCHMARK
DATUM: NORTH AMERICAN VERTICAL DATUM OF 1988 (NAVD88)

CITY OF LAS VEGAS BENCHMARK: 8LV99-13SES
NAVD88 ELEVATION: 869.606 METERS (2853.03 FEET)

RIVET AND PLATE IN CONCRETE CYLINDER NW CORNER OF HUALAPAI AND ELKHORN

NOTE: ADD 0.34' TO ABOVE CITY OF LAS VEGAS BENCHMARK 8LV99-13SES TO MATCH ORIGINAL PROJECT BENCHMARK, CLARK COUNTY BENCHMARK 1C00-6N6 (2584.62 FEET) AS SHOWN ON RECORD OF SURVEY FILE 124 PAGE 34.

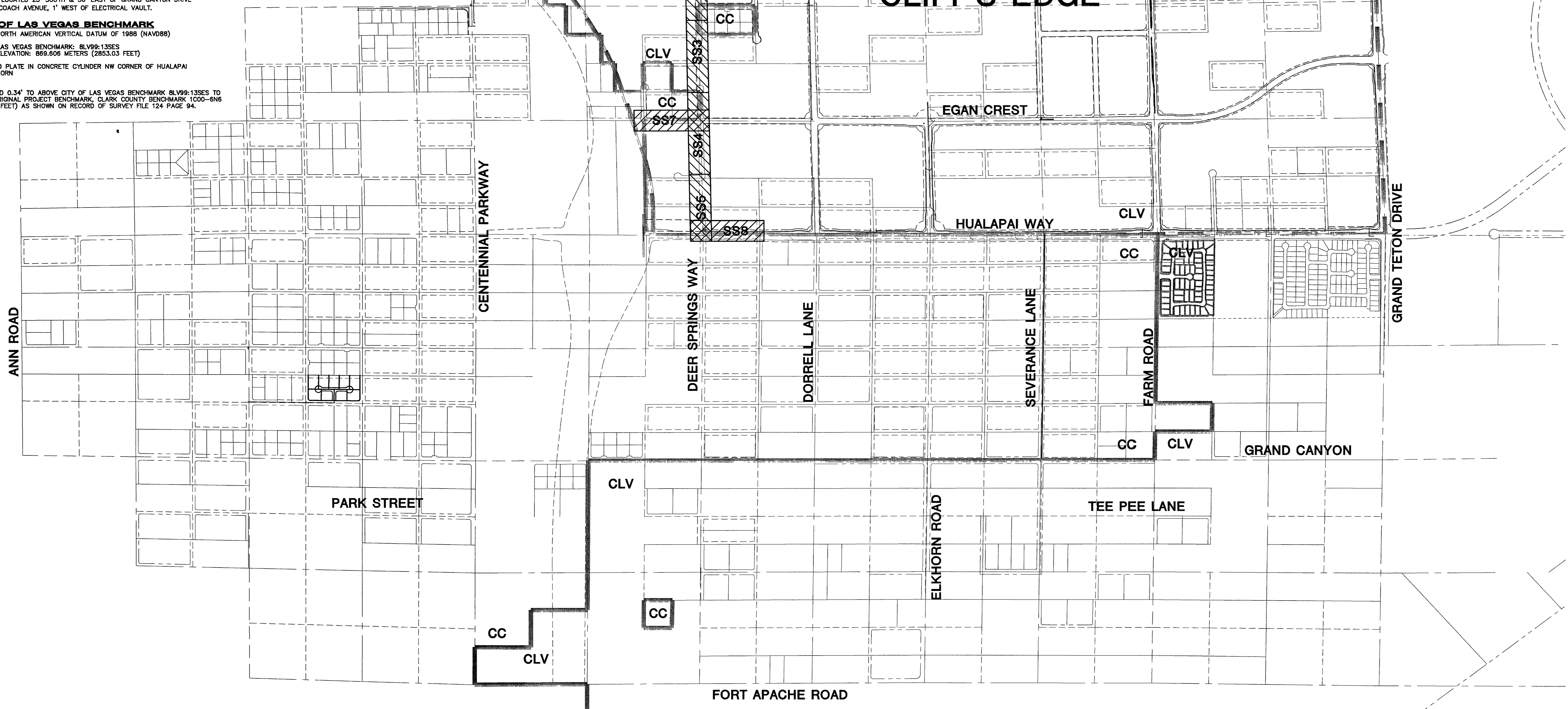

PUBLIC SEWER QUANTITY ESTIMATE

- | | |
|---------------------|-----------|
| 1. STD 4' DIA. M.H. | 17 EA. |
| 2. DEEP M.H. | 1 EA. |
| 3. 8" PVC | 6,183 LF. |
| 4. 10" PVC | 1,340 LF. |

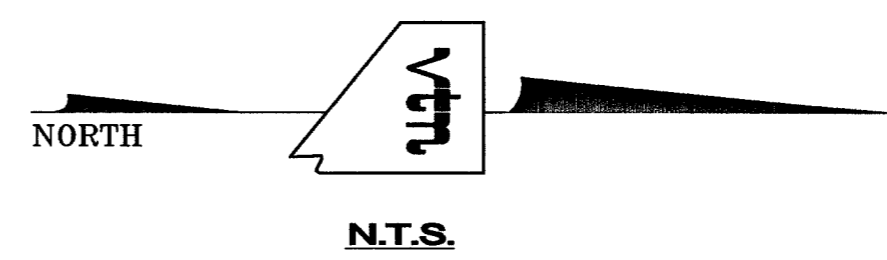

70359

7	6	5	4	3	2	1	REV	DATE	BY

CLIFFS EDGE, LLC.
3455 CLIFF SHADOWS PARKWAY SUITE 290
LAS VEGAS, NV 89129
(702) 777-1221

CITY OF LAS VEGAS, NEVADA

PROVIDENCE / CLIFFS EDGE DEER SPRINGS SEWER IMPROVEMENTS

KEY MAP AND QUANTITIES

DRAWN BY: _____ APRIL '04

DESIGNED BY: _____ FEB. '04

CHECKED BY: _____ APRIL '04

PROJECT NO: 599B SCALE: NA HORIZ. NA VERT.

EXPIRES 06-30-05

PROFESSIONAL ENGINEER STATE OF NEVADA
DANIEL HIGDON
LICENSE NO. 12811
SHEET C2
2 OF 11 SHEETS
DRAWING NO. 1044-446-05-9
599B DEER SPRINGS SEWER 599BSS-C2.DWG