

Call before you Dig
1-800-227-2600

BENCHMARK
OLVOD 18NES
RIVET IN PLATE IN TOP OF CURB.
SW RETURN CHEYENNE AVENUE
AND BUFFALO DRIVE
ELEVATION = 2366.703

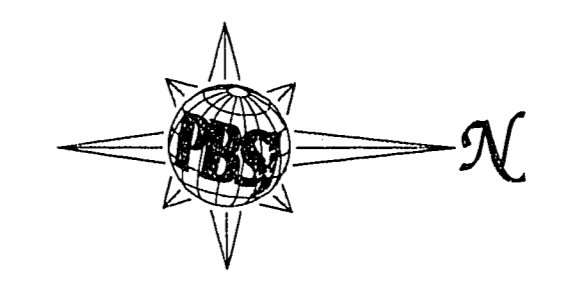

CIMARRON ROAD - PLAN VIEW
HORIZONTAL SCALE: 1" = 40'

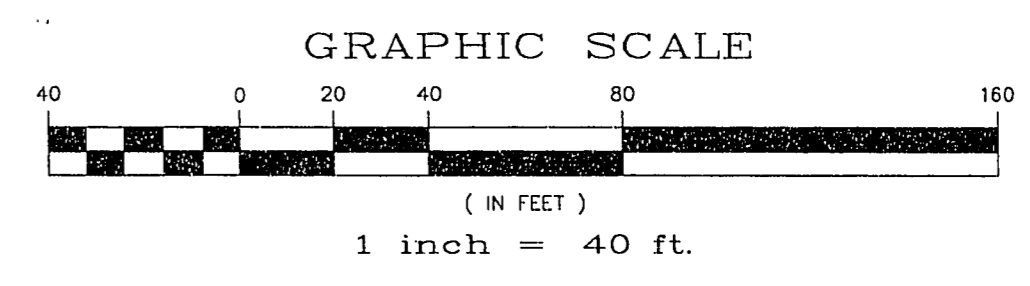
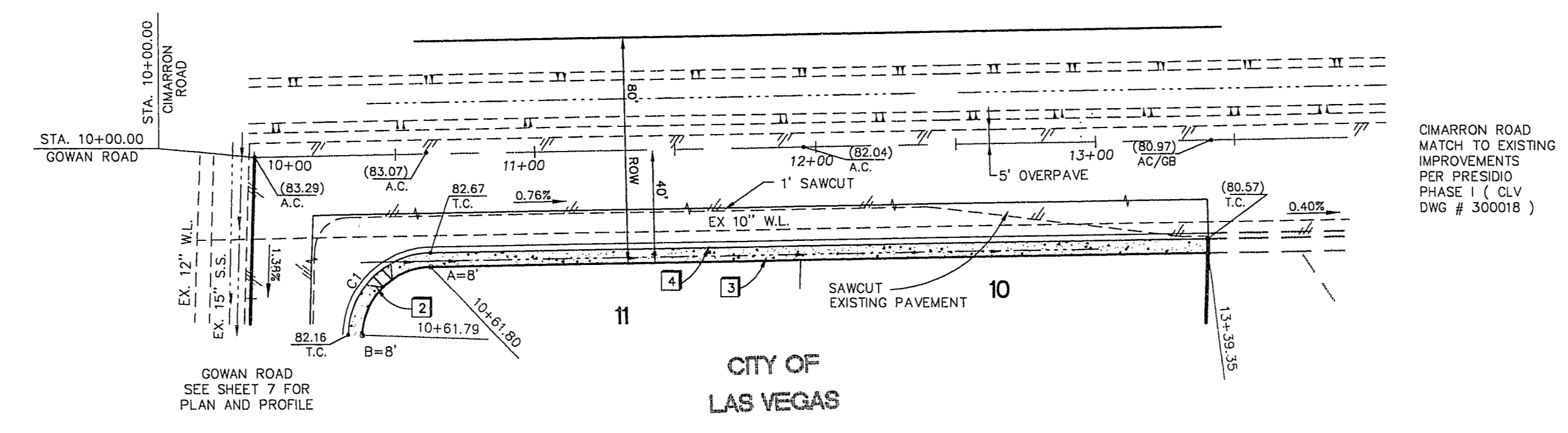
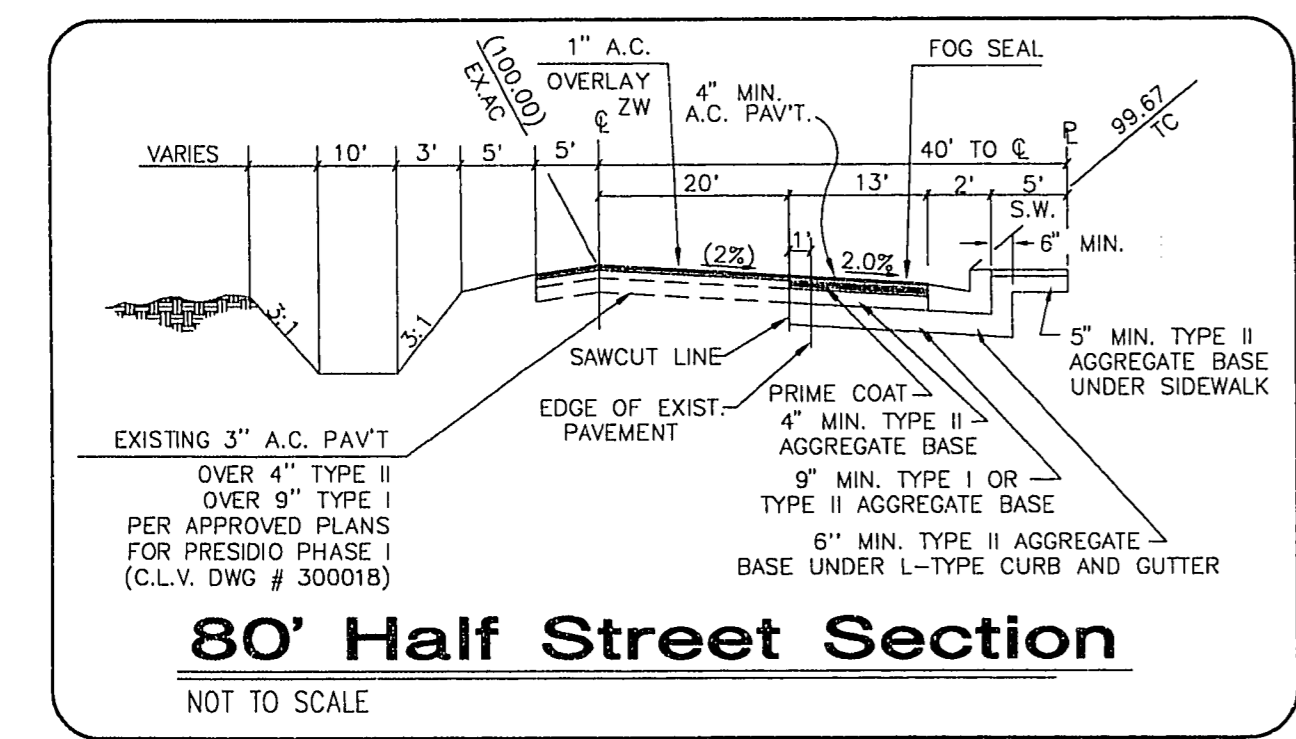

BACK OF CURB CURVE DATA TABLE

No.	RADIUS	DELTA	LENGTH	TANGENT
C1	30.00	87°08'20"	45.61	28.52

- GENERAL NOTES**
1. ADD 2300' TO PLAN VIEW ELEVATIONS.
 2. ALL STATIONING IS CENTERLINE STATIONING UNLESS OTHERWISE NOTED.
 3. SEWER LENGTHS ARE FROM CENTER OF MANHOLE TO CENTER OF MANHOLE.

- CONSTRUCTION NOTES**
- 2 SIDEWALK RAMP (CASE 1) PER STANDARD DWG. NO. 235. (TRANSITION LENGTHS A & B SHOWN ON PLAN, Z=3.5')
 - 3 CONCRETE SIDEWALK PER STANDARD DWG. NO. 119.
 - 4 "L" TYPE CURB & GUTTER PER STANDARD DWG. NO. 120.

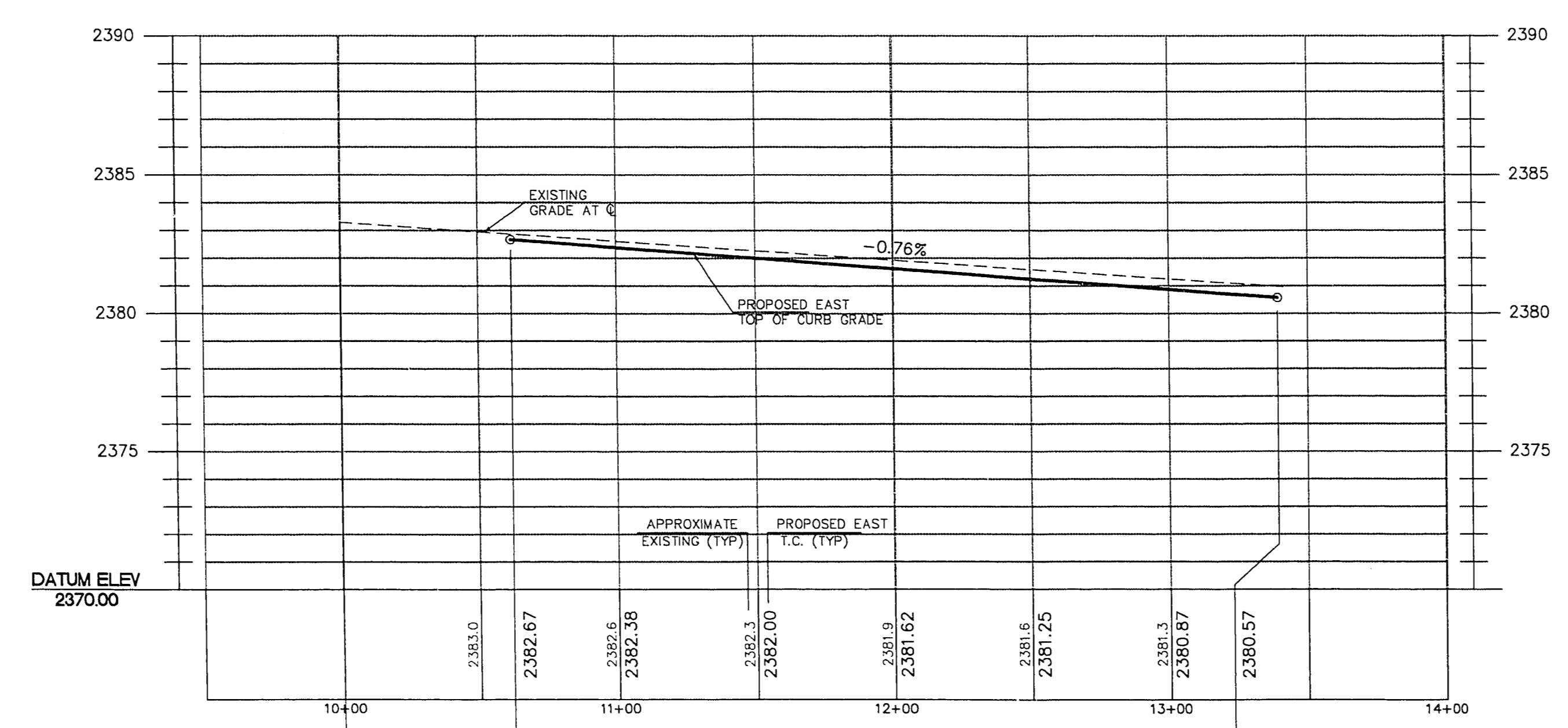

CIMARRON ROAD - PROFILE
HORIZONTAL SCALE: 1" = 40'
VERTICAL SCALE: 1" = 4'

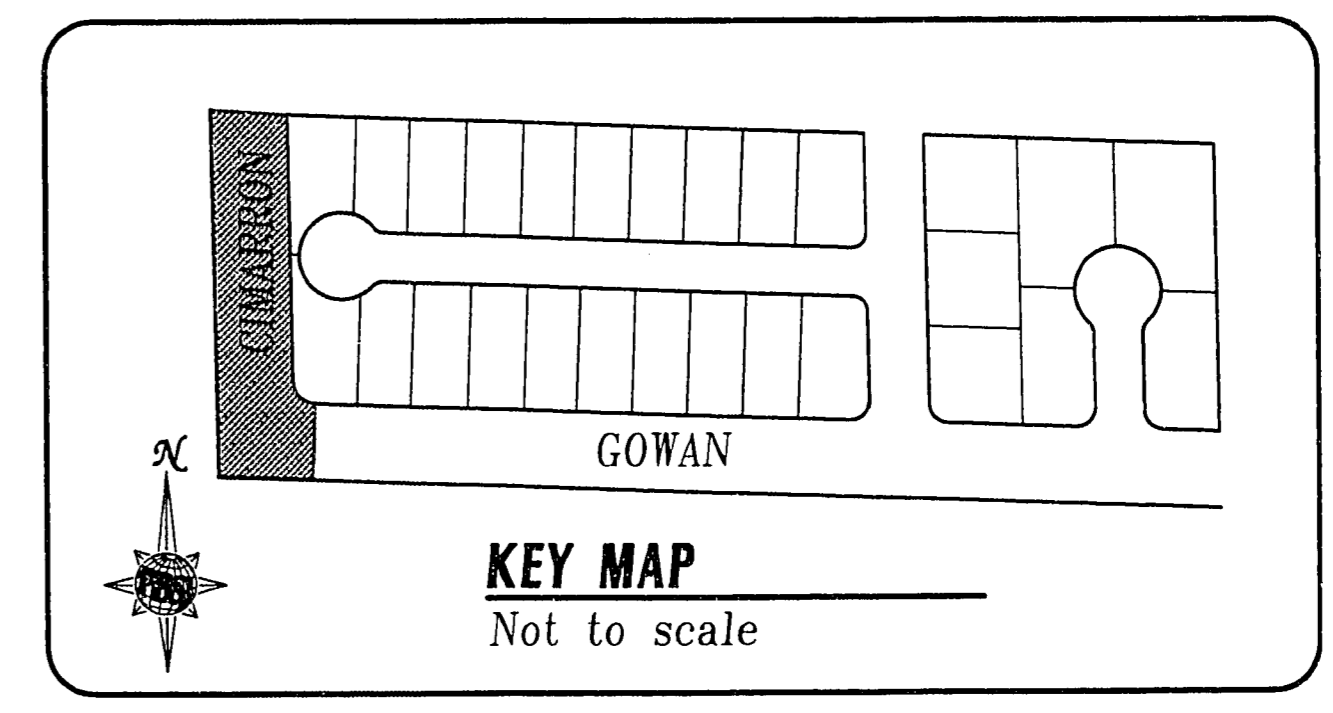

CLARK COUNTY DEPT. OF PUBLIC WORKS
ENGINEERING DIVISION
ACCEPTANCE OF PLANS FOR FILING BY:

ACCEPTANCE OF THESE PLANS FOR FILING SHALL NOT BE CONSTRUED AS A PERMIT FOR, OR AN APPROVAL OF, ANY VIOLATION OF ANY OF THESE PROVISIONS OF THE STATE OR COUNTY LAWS AND/OR SPECIFICATIONS. CLARK COUNTY SHALL BE HELD FREE FROM DAMAGES WHICH MAY RESULT FROM CONSTRUCTION OF THE IMPROVEMENTS FROM THE ENGINEERING DESIGN DEPICTED HEREIN.

NOTE: POWER POLES AND/OR OTHER EXISTING FACILITIES NOT PROPERLY LOCATED BASED ON PROPOSED IMPROVEMENTS SHOWN HEREON WILL BE RELOCATED AT NO EXPENSE TO CLARK COUNTY.

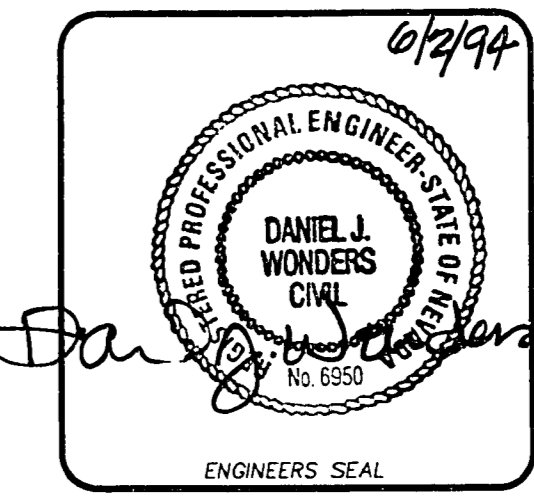

6600 West Charleston Blvd. Las Vegas, Nevada 89002 Post, Schlich & Jernigan Tel: 792.6767 Fax: 792.6728	REVISIONS	Date
POST, SCHLICH & JERNIGAN ENGINEERING, PLANNING, SURVEYING, CONSTRUCTION SERVICES	No.	Appr.
Rhodes Homes		
CIMARRON ROAD PLAN AND PROFILE		
Drawn by WSS Checked by MDP Date MAY 31, 1994	Scale 1" = 40'	File No. 620IMP
Job Number 7167.620	Sheet Number 8 OF 9	

C:\DWS\120\1201\1201-05 1201 May 31 11:34:21 1994 POST, BUCKLEY, SCOUR, & JERNIGAN, INC. - SCOTT

11-15-90 1074-4334