

- NOTES:**
1. FENCING SHALL BE CHAIN LINK AND SHALL CONSIST OF GALVANIZED CHAIN LINK FABRIC ON STEEL POSTS.
 - (A) ALL POST TOPS SHALL BE FITTED WITH SUITABLE FINIALS.
 - (B) BRACES SHALL BE SPACED APPROXIMATELY 12" BELOW TOP OF TERMINAL POSTS AND SHALL EXTEND FROM END, GATE, OR CORNER POSTS TO FIRST ADJACENT LINE POST.
 - (C) ALL FITTINGS SHALL BE HOT DIPPED GALVANIZED MALLEABLE, CAST IRON, OR PRESSED STEEL.
 - (D) TOP AND BOTTOM SELVAGES OF THE FENCE SHALL HAVE A TWISTED AND BARBED FINISH.
 2. BARBED WIRE, EXTENSION ARMS, AND TOP HORIZONTAL RAILS SHALL BE INSTALLED ONLY WHEN SHOWN ON THE PLANS AND/OR CALLED FOR IN THE SPECIAL PROVISIONS.

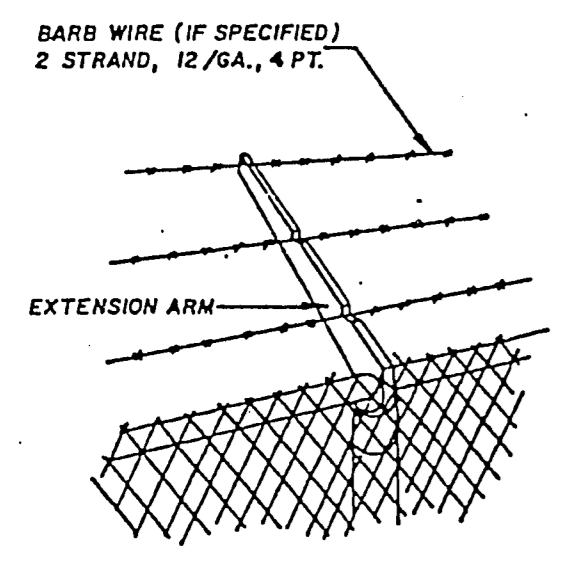
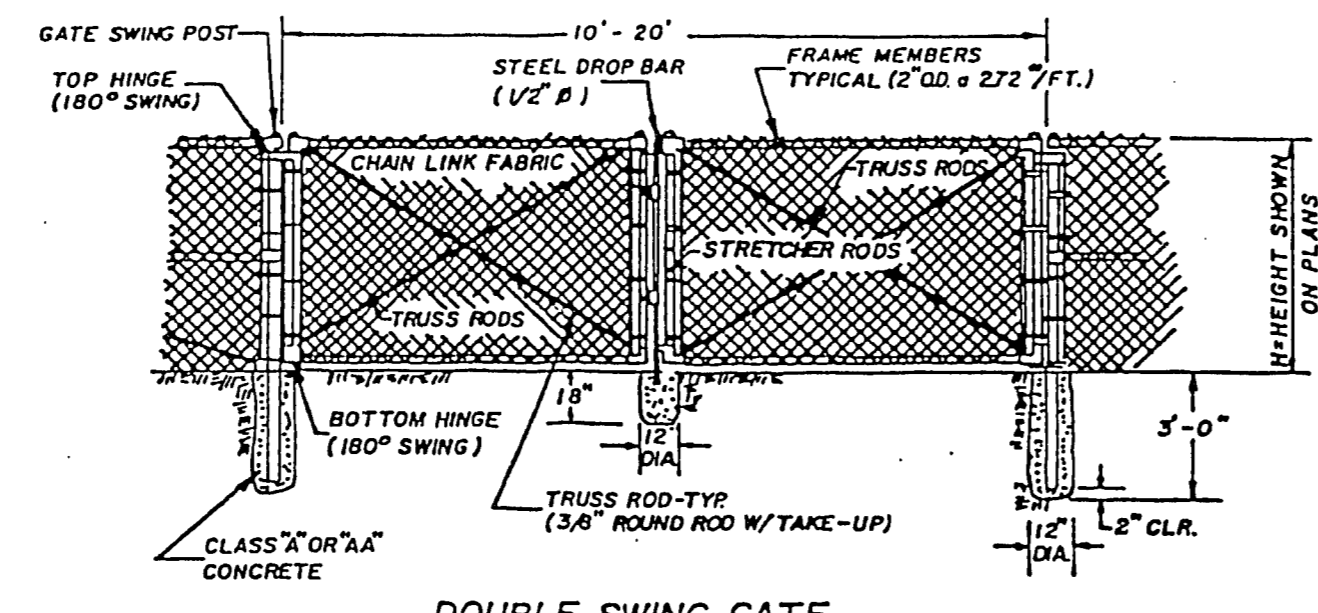

TABLE I
FOR CHAIN LINK FENCE 72" AND LESS

LOCATION	MIN. SIZE	MIN. WEIGHT
END, CORNER & PULL	2.351 O.D.	3.10
LINE	2.00 O.D.	2.72
BRACES	1.630 O.D.	2.27
TOP RAIL	1.630 O.D.	2.27

A CHAIN LINK FENCE



DOUBLE SWING GATE

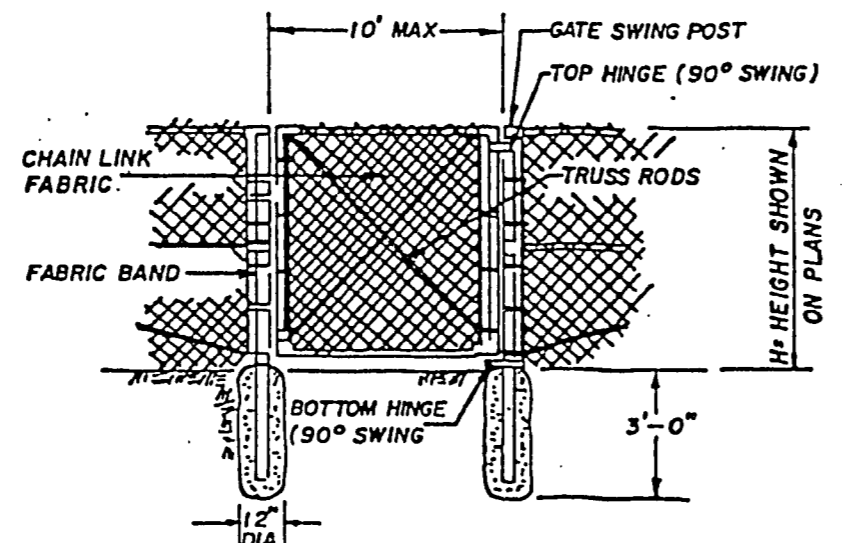

SINGLE GATE

GATE SWING POST DIA.

GATE SIZE	PIPE DIA.
6' AND LESS	3" O.D. - 5.79 LBS./FT.
6'-10'	4" O.D. - 9.10 LBS./FT.

B CHAIN LINK GATES

1987 CLARK COUNTY ROAD IMPROVEMENT BONDS
OWENS AVENUE
(MONTH), (YEAR) - (MONTH), (YEAR)
ADMINISTERED BY: (C.L.V.)
CONTRACTOR: ()
ENGINEER: (C.L.V.)
FOR INFO: (C.L.V.)
XXX - XXXX

ADDITIONAL FUNDING BY:
REGIONAL TRANSPORTATION COMMISSION
SPECIAL IMPROVEMENT DISTRICTS

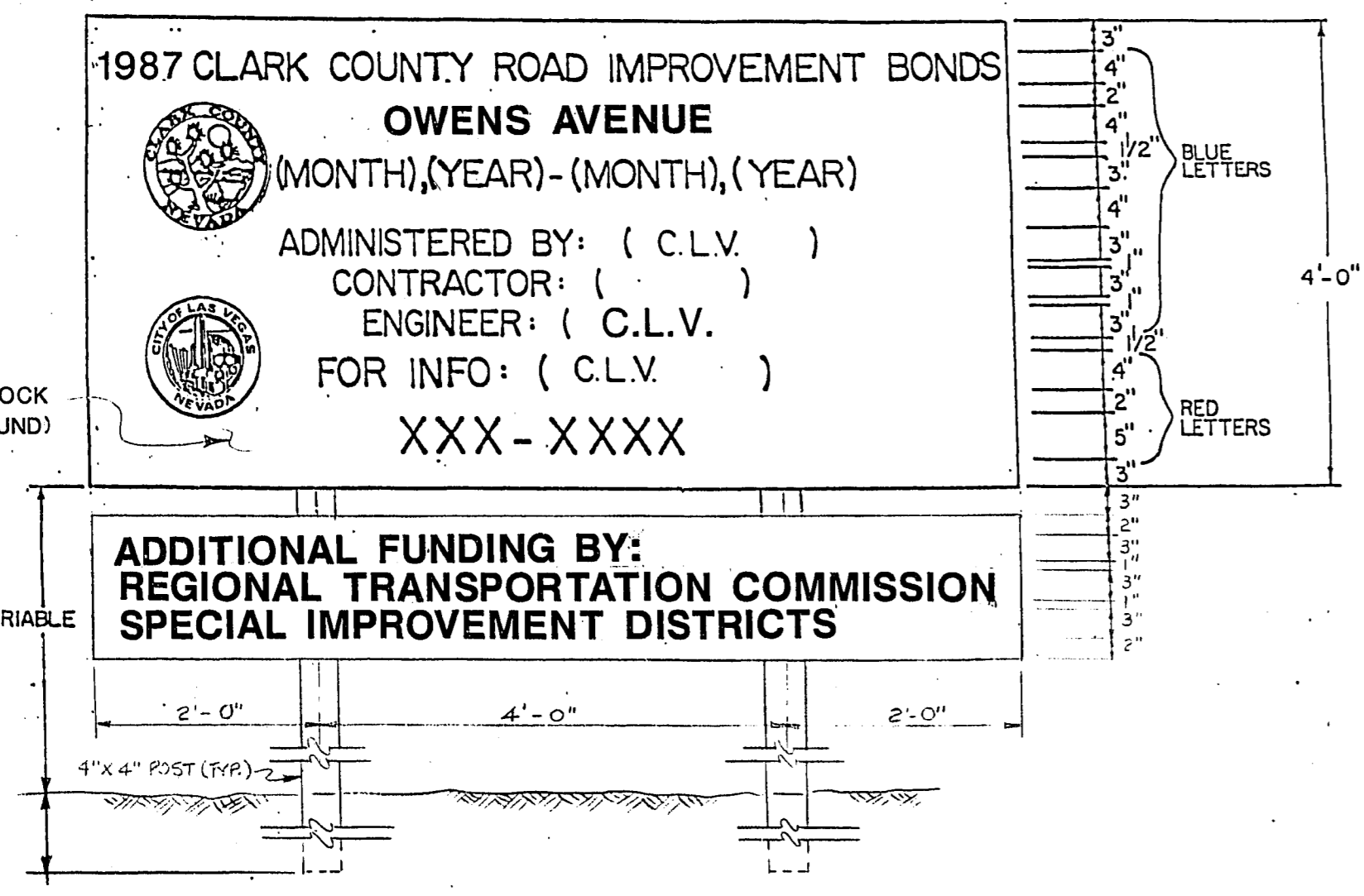

PROJECT SIGN
(2 - REQ.)

- NOTES:**
1. SIGN SHALL BE PLACED SO AS NOT TO OBSTRUCT SAFE STOPPING SIGHT DISTANCE & SHALL NOT OBSTRUCT ANY PEDESTRIAN WAY.
 2. IF PLACED OUTSIDE OF R/W, EASEMENT OR LETTER OF PERMISSION FROM PROPERTY OWNER MUST BE SECURED BY CONTRACTOR & A COPY PROVIDED TO (AGENCY) PRIOR TO ERECTION OF SIGN.
 3. POST/SIGN CONNECTION SHALL BE BOLT UP TYPE.

SCALE: 3/4" = 1'-0"

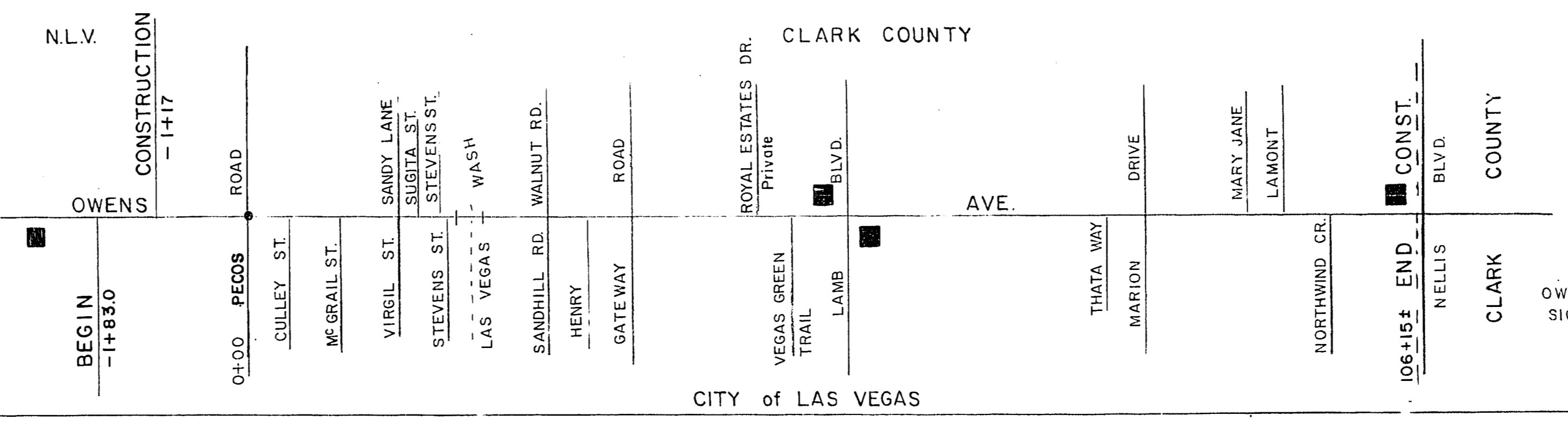

Department of Public Works Engineering Design Division
OWENS AVENUE
PECOS ROAD TO NELLIS BLVD.

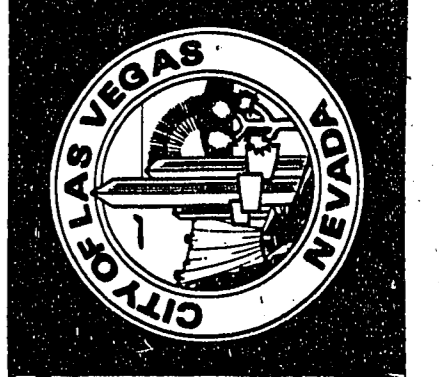

Drawing no. 107-V 858 MD1

Scale (1/4")	Scale (1/2")	Scale (3/4")	Scale (1")	Scale (1 1/2")	Scale (2")
Fid. bk. no.	W.A. W.L.L.6410	Date DEC. 1988	Drawn by NORMA GOMEZ	Approved by CITY ENGINEER	Date
Design by D.A.D.					Date
Approved by					Date
Revisions					Date

Handwritten signature
12-8-88

MISCELLANEOUS DETAILS
CONSTRUCTION SIGN LOCATION