

KEYNOTES - FIRE

- 1 8" PVC FIRE LINE (SCHEDULE 40)
- 2 6" PVC FIRE LINE (SCHEDULE 40)
- 3 FIRE HYDRANT ASSEMBLY
- 4 GATE VALVE

KEYNOTES - SEWER

- 5 8" PVC SEWER MIN SLOPE = 1%
- 6 SEWER CLEAN OUT
- 7 CONNECT TO EXISTING SEWER (CONFIRM ELEVATION PRIOR TO CONSTRUCTION)
- 8 REMOVE AND REPLACE AC PAVING PER USDOCA # 504
- 9 48" SEWER MANHOLE (SD-1)
- 10 PROVIDE 12" CONCRETE SLURRY FOR COVER LESS THAN 36" (TYPICAL)

KEYNOTES - WATER

- 11 8" x 6" REDUCER
- 12 6" PVC WATER LINE (SCH 40)
- 13 3" PVC WATER LINE (SCH 40)
- 14 8" 90° ELL W/ THRUST BLOCK
- 15 8" x 8" TEE
- 16 1" PVC WATER LINE (SCH 40)
- 17 6" 45° BEND
- 18 6" 22.5° BEND
- 19 6" 11.25° BEND
- 20 6" x 6" x 3" TEE
- 21 3" 45° BEND
- 22 3" 11.25° BEND
- 23 3" x 3" x 1" TEE
- 24 1" 22.5° BEND
- 25 1" 90° BEND
- 26 1" 11.25° BEND
- 27 2" TO 6" INCREASER
- 28 WATER FOUNTAIN-DRY WELL (SEE DETAIL "D" SHEET C19)
- 29 6"x6"x1" TEE
- 30 1" LINE TO BUILDING

KEYNOTES - STORM DRAIN

- 31 NEENAH AREA DRAIN - MODEL NO. R-4040-8 OR APPROVED EQUAL
- 32 6" PVC (SDR 35) DRAIN LINE (S= .01.00) CONNECT TO EXISTING DROP INLET
- 33 NEENAH AREA DRAIN - MODEL NO. R-4040-12 OR APPROVED EQUAL
- 34 TYPE "C" DROP INLET PER USDOCA DWG. NO. 413 OR APPROVED EQUAL
- 35 JENSEN PRECAST DROP INLET - MODEL NO. 2424 HDI OR APPROVED EQUAL
- 36 18" RCP STORM DRAIN PIPE
- 37 CONNECT DRAIN TO DRAIN LINE
- 38 5' WIDE CHANNEL TO CONNECT TO EXISTING UNDER SIDEWALK DRAIN SEE DETAIL B-C20

WATER - NOTE

CONSTRUCTED WITH THRUST BLOCKS PER LVWD STANDARDS. ALL WATER LINE ANGLE POINTS (BENDS) 3" OR GREATER ARE TO BE

BASIS OF BEARING

BASIS OF BEARING NORTH 011°34'51" WEST BEING THE EAST LINE OF THE SOUTHEAST QUARTER (SE 1/4) OF THE SOUTHWEST QUARTER (SE 1/4) OF SECTION 8, TOWNSHIP 20 SOUTH, RANGE 60 EAST, M.D.M. AS SHOWN PER FILE 92 OF SURVEYS, PAGE 50 OF OFFICIAL RECORDS.

BENCHMARK

BENCHMARK 752.4415 METERS 2468.63 FEET CITY OF LAS VEGAS VERTICAL CONTROL NAVD83 DATUM. STATION OLVD0 17NE6, A RIVET AND PLATE IN TOP OF CURB, RAMPAKT BLVD. AND LAZZERETTE DRIVE, WEST CURB LINE.

AVOID CUTTING UNDERGROUND UTILITY LINES. IT'S COSTLY. CALL BEFORE YOU DIG - 1-800-227-2600 UNDERGROUND SERVICE ALERT (U.S.A.)	AVOID OVERHEAD POWER LINE CONTACT CALL BEFORE YOU OVERHEAD - 1-702-593-6111 NEVADA POWER ENVIRONMENT AND SAFETY SERVICES DEPARTMENT
--	--

CAUTION:

EXISTING UTILITIES ARE LOCATED ON THE PLANS FROM A SEARCH OF AVAILABLE RECORDS. CONTRACTOR TO VERIFY LOCATIONS AND DEPTHS PRIOR TO CONSTRUCTION.

GREAT WEST ENGINEERING
CONSULTING LAND PLANNING CIVIL ENGINEERING
PHONE: (702) 387-0000 FAX: (702) 742-8341

North West Family Golf Course and Park
CLUBHOUSE & PARK UTILITY

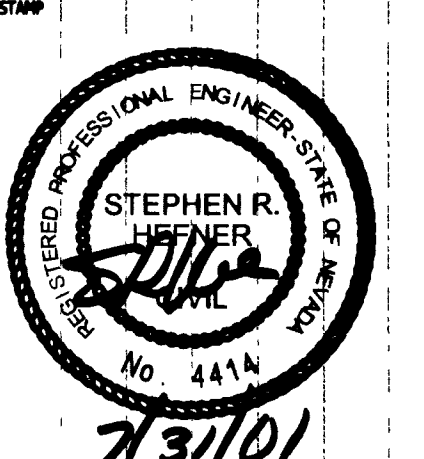

OWNER: CITY OF LAS VEGAS
DEPARTMENT OF PUBLIC WORKS
ARCHITECTURAL SERVICES

DATE	DMW
DATE	7/31/01
SCALE	1"=30'
PROJECT NO.	01150120
CHECKED	65066

11.05.21 C10

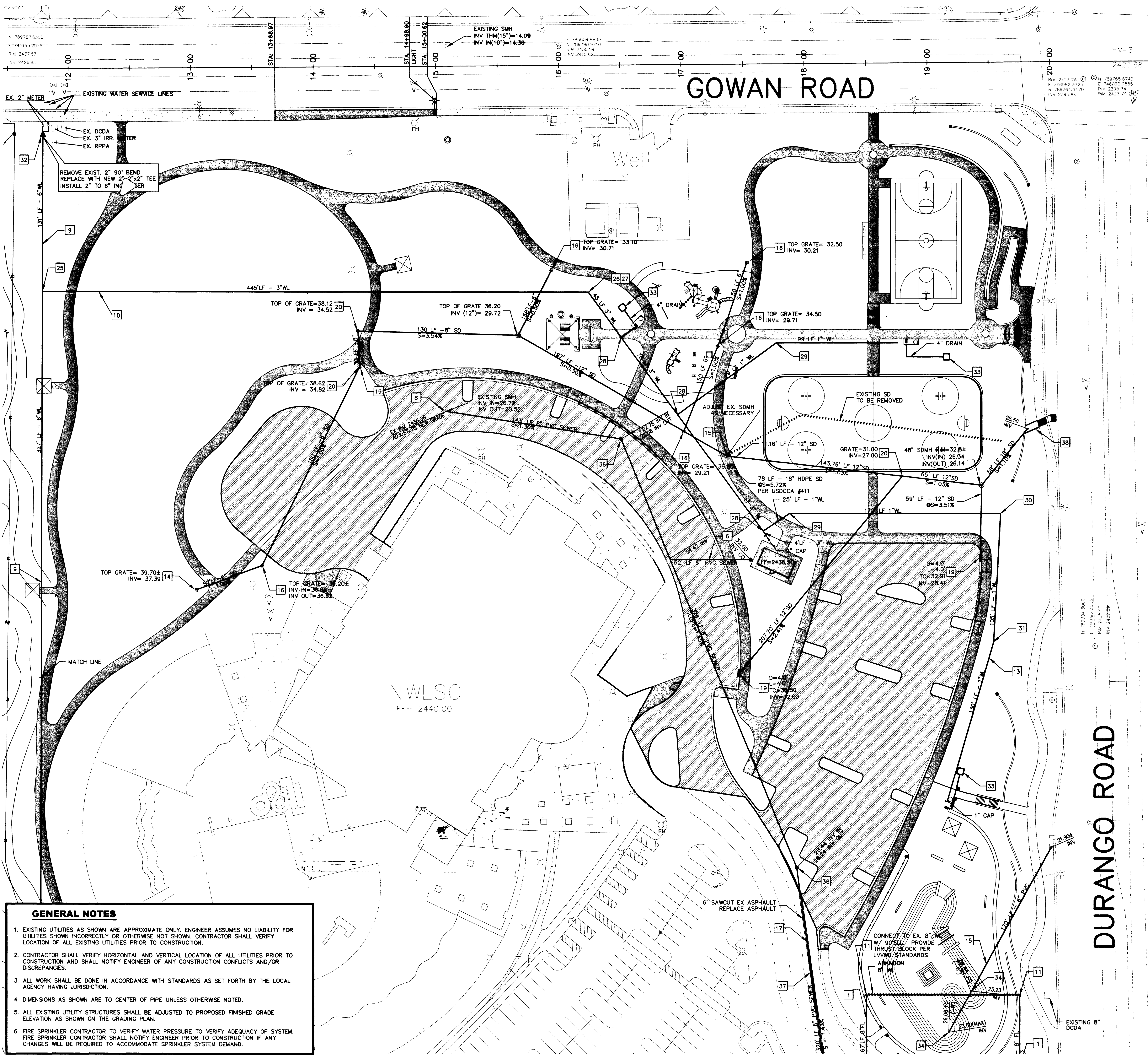

- GENERAL NOTES**
- EXISTING UTILITIES AS SHOWN ARE APPROXIMATE ONLY. ENGINEER ASSUMES NO LIABILITY FOR UTILITIES SHOWN INCORRECTLY OR OTHERWISE NOT SHOWN. CONTRACTOR SHALL VERIFY LOCATION OF ALL EXISTING UTILITIES PRIOR TO CONSTRUCTION.
 - CONTRACTOR SHALL VERIFY HORIZONTAL AND VERTICAL LOCATION OF ALL UTILITIES PRIOR TO CONSTRUCTION AND SHALL NOTIFY ENGINEER OF ANY CONSTRUCTION CONFLICTS AND/OR DISCREPANCIES.
 - ALL WORK SHALL BE DONE IN ACCORDANCE WITH STANDARDS AS SET FORTH BY THE LOCAL AGENCY HAVING JURISDICTION.
 - DIMENSIONS AS SHOWN ARE TO CENTER OF PIPE UNLESS OTHERWISE NOTED.
 - ALL EXISTING UTILITY STRUCTURES SHALL BE ADJUSTED TO PROPOSED FINISHED GRADE ELEVATION AS SHOWN ON THE GRADING PLAN.
 - FIRE SPRINKLER CONTRACTOR TO VERIFY WATER PRESSURE TO VERIFY ADEQUACY OF SYSTEM. FIRE SPRINKLER CONTRACTOR SHALL NOTIFY ENGINEER PRIOR TO CONSTRUCTION IF ANY CHANGES WILL BE REQUIRED TO ACCOMMODATE SPRINKLER SYSTEM DEMAND.

P:\City West\020702\DWG\020702.DWG\020702.DWG 01:58:37 PM, 04/18/01 DWG: 020702.DWG (EAD) 1/1