



**POGGE MEYER
DESIGN GROUP**

6960 Smoke Ranch Suite 110
Las Vegas, Nevada 89128
P 702.255.8100
F 702.255.8376
www.poggemeyer.com

NO.	DATE	REVISION

ANY INFORMATION OR DATA ON THIS DRAWING IS NOT INTENDED TO BE SUITABLE FOR REUSE FOR ANY OTHER PROJECT. ANY REUSE WITHOUT WRITTEN PERMISSION AND ADAPTATION BY THE ENGINEER FOR THE SPECIFIC PURPOSE INTENDED, WILL BE AT THE USER'S SOLE RISK AND WITHOUT LIABILITY OR LEGAL EXPOSURE TO THE ENGINEER.

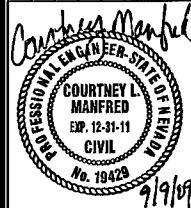

SITE PLAN - BASEMENT - NORTH
NEW CITY HALL
CITY OF LAS VEGAS
CLARK COUNTY, NEVADA

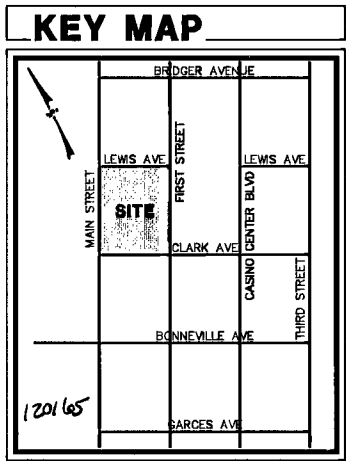
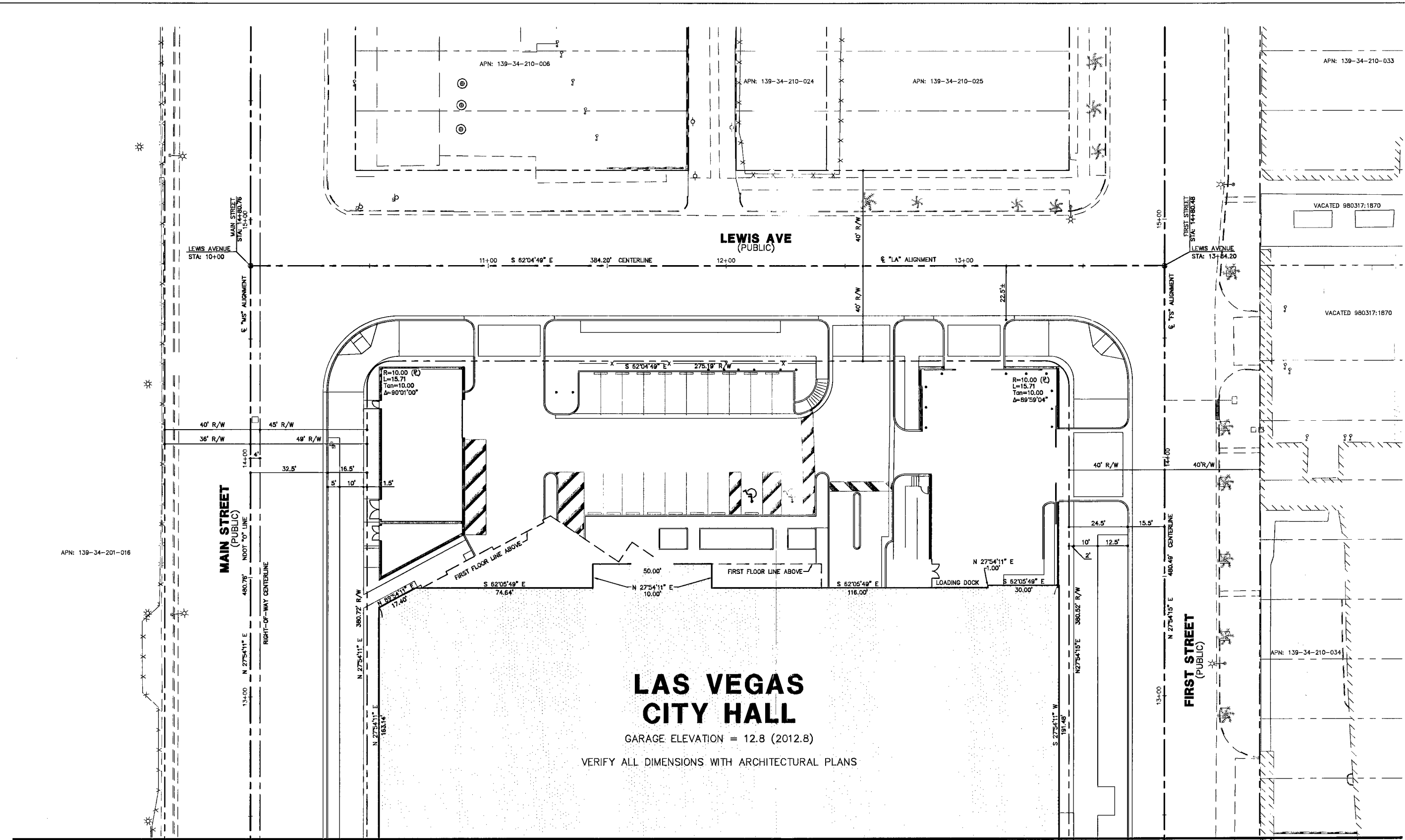

BASIS OF BEARING

SOUTH 27°54'30" WEST BEING THE CENTERLINE OF CASINO CENTER BOULEVARD BETWEEN STEWART AVENUE AND COOLIDGE AVENUE AS SHOWN BY MAP THEREOF IN FILE 67, PAGE 79 OF SURVEYS IN THE CLARK COUNTY RECORDER'S OFFICE.

BENCHMARK

CITY OF LAS VEGAS BENCHMARK No. 8001 34SWB
Rivet & Plate in top of curb on east side of main between BONNEVILLE & GARCES @ LIGHT POLE.

NAV8088 DATUM, PUBLISHED DECEMBER 2, 2002.
ELEVATION = 617.8544 METERS
2027.08 FEET

LEGEND

	RIGHT-OF-WAY LINE
	PARCEL LOT LINE
	ROAD CENTERLINE
	ASSESSORS PARCEL NUMBER
	EXISTING BUILDING
	EXISTING FENCE
	EXISTING CURB AND GUTTER
	EXISTING SIGN
	EXISTING POWER POLE
	EXISTING STREET LIGHT
	PROPOSED CURB AND GUTTER

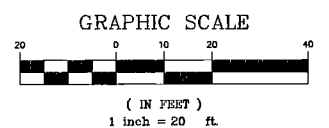
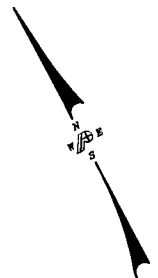

Call before you dig
Call before you dig
Underground Overhead

FOR MORE INFORMATION VISIT www.callbeforeyoudig.com
1-702-455-7511
1-702-432-5000
1-702-432-5000

ALSO VISITING OVERHEAD CALL BEFORE YOU DIG
POWER LINES, ITS COUNTY AND CITY
1-702-227-0928
1-702-227-0928
1-800-227-2600

CLARK COUNTY PUBLIC WORKS DEPARTMENT
SAFETY SERVICES DIVISION
1-702-455-7544

HANSEN NO. 34842 CLV DWG. NO. 521-298

JOB NUMBER	08077C
DESIGNED BY	SCD/CLM
DRAWN BY	BAM
CHECKED BY	SCD
DATE	8/31/09
SHEET NUMBER	C3.01 8 of 40