

FIXTURE SCHEDULE								
FIXT. TYPE	MANUFACTURER NAME	CAT. NO.	WATTAGE	MTG.	MTG. HT.	LAMP TYPE	REMARKS	VOLTAGE
A	COLUMBIA	FR5-14CR5-CP-9202-A	50	SURFACE		F40T12CW/RS	WITH HPF/ETL BALLAST	120
B	COLUMBIA	FR5-140CK-M4	50	SURFACE		F40T12CW/RS	WITH HPF/ETL BALLAST	120
C	PRESCOLITE	WB-7	100	WALL	8'-3" ABOVE LANDING	A-19 I.F.		120
D	LIGHTOLIER	15598	400	SURFACE		8-F40T12CW/RS	WITH HPF/ETL BALLAST	120
E	BRYANT	5728	100	SURFACE		A-19 I.F.	PORCELAIN KEYLESS	120
F	STONCO	GD8801	1000	WRJ-BOX		Q1000T3CL	WITH ANODIZED ALUM. GLARE SHIELD	240
G	STONCO	GD8501	500	WRJ-BOX		Q500T3CL		120
H	STONCO	9715-CW-3"	1600	POLE		4-E-37H400C33-1	CONSTANT WATTAGE BALLAST PACIFIC UNION METAL POLE #6000835	120
J	LIGHTOLIER	10637	100	SURFACE		2-F40T12CW/RS	WITH HPF/ETL BALLAST	120
K	PRESCOLITE	7810	100	SURFACE		2-50W.A-19 I.F.		120
L	LIGHTOLIER	10153	50	WALL	ABOVE MIRROR	F40T12CW/RS	WITH HPF/ETL BALLAST	120
M	PRESCOLITE	1310-6117	100	RECESS		A-19 I.F.	WP.	120
N	STONCO	P6700LE	150	WRJ-BOX		PAR 38/FL		120
P	STONCO	P2100-32	75	WRJ-BOX		A-19 I.F.	WITH WL-70 IN EARTH SPIKE BOX	120
Q	PRESCOLITE	5-51	50	WALL		1@ 25 W.	WITH ADDITIONAL DOLLAR SAVER #5	120
R	PRESCOLITE	5-51-R	50	WALL		1@ 25 W.		120
S	PRESCOLITE	5-51-L	50	WALL		1@ 25 W.		120

SYMBOL LIST

- INDICATES NO. OF NOTE OR SHEET NO. & NOTE NO.
- FLUORESCENT FIXTURE
- INCANDESCENT FIXTURE - WALL MTD.
- INCANDESCENT FIXTURE - CEIL. MTD.
- ⊙ FLOODLIGHT
- ⊙ SINGLE POLE SWITCH @ +5' UNLESS NOTED
- ⊙ MOMENTARY CONTACT SWITCH WITH RED PILOT LIGHT
- ⊙ HORSE-POWER RATED SINGLE POLE SWITCH
- ⊙ TELEPHONE OUTLET @ +12" UNLESS NOTED
- ⊙ PUBLIC TELEPHONE OUTLET
- ⊙ JUNCTION BOX - WALL MOUNTED
- ⊙ JUNCTION BOX
- ⊙ MOTOR OUTLET
- ⊙ NON-FUSED DISCONNECT SWITCH
- CONDUIT UP IN WALL - SEE FLOOR ABOVE
- CONDUIT DOWN IN WALL - SEE FLOOR BELOW
- ⊙ DUPLEX RECEPTACLE @ +12" UNLESS NOTED
- WR WEATHERPROOF
- CONDUIT RUN IN FLOOR OR BELOW GRADE
- CONDUIT RUN IN WALL OR ABOVE CEILING
- 1/2" - 2 # 12 UNLESS NOTED
- 1/2" - 3 # 12
- 3/4" - 4 # 12
- 3/4" - 5 # 12
- 1" - 6 # 12
- 5/5 4 1/16" SQUARE X 2 1/8" DEEP OUTLET BOX
- ⊙ SHUNT TRIP BREAK GLASS STATION @ +6'-0"
- UP INDICATES FLOW OF TRAFFIC & PITCH OF RAMP
- DOWN INDICATES FLOW OF TRAFFIC & PITCH OF RAMP
- A SEE THESE MATCH LINES FOR CONTINUOUS RAMP UP
- Z SEE THESE MATCH LINES FOR CONTINUOUS RAMP DOWN
- ⊙ THERMOSTAT OUTLET @ +5'-0"
- ⊙ FLUSH IN FLOOR JUNCTION BOX
- EXIST. POWER CO. POLE
- EXIST. CITY STREET LIGHTING FIXTURE
- ⊙ EXIT LIGHT ABOVE DOOR OR ON SIDE OF BEAM
- ⊙ EXIT LIGHT ON BOOTH WALL AS DIRECTED BY BOOTH EQUIP. CONTRACTOR

GENERAL NOTES

- ALL CONDUITS IN WHICH CIRCUITS A-8, 9, 10, 19, 20, 21, 22, 23, 24, 25 & 26 OCCUR SHALL BE 1". ALL FIXTURES & RECEPTACLES FED FROM A FOREMENTIONED CIRCUITS SHALL HAVE 5/5 OUTLET BOXES.
- ALL DUPLEX RECEPTACLES IN PARKING AREAS SHALL BE WEATHERPROOF, MOUNT @ +5'-0" ABOVE FLOOR.
- ALL CONNECTIONS TO VIBRATING OR ROTATING EQUIP. SHALL BE MADE WITH FLEXIBLE METAL CONDUIT
- ALL RELAY CABINETS SHALL HAVE LOCKABLE, HINGED COVERS.

ALTERNATE CONDUIT & WIRE SCHEDULE FOR FEEDERS DESIGNATED BY ○

FEEDER NO.	CONDUIT & WIRE SIZE	COPPER	ALUMINUM
①	2-2-3#3/0	2-2 1/2-3-250MCM	
②	2-3-3-350MCM	2-3-3-500MCM	
③	2-3#2/0	2 1/4-3#4/0	
④	3"-3-350MCM	3"-3-500MCM	
⑤	2 1/2-3#4/0	2 1/2-3-300MCM	
⑥	2-3#3/0	2 1/2-3-250MCM	
⑦	2-3#1/0	2-3#3/0	
⑧	1 1/4-3#2	2-3#1/0	

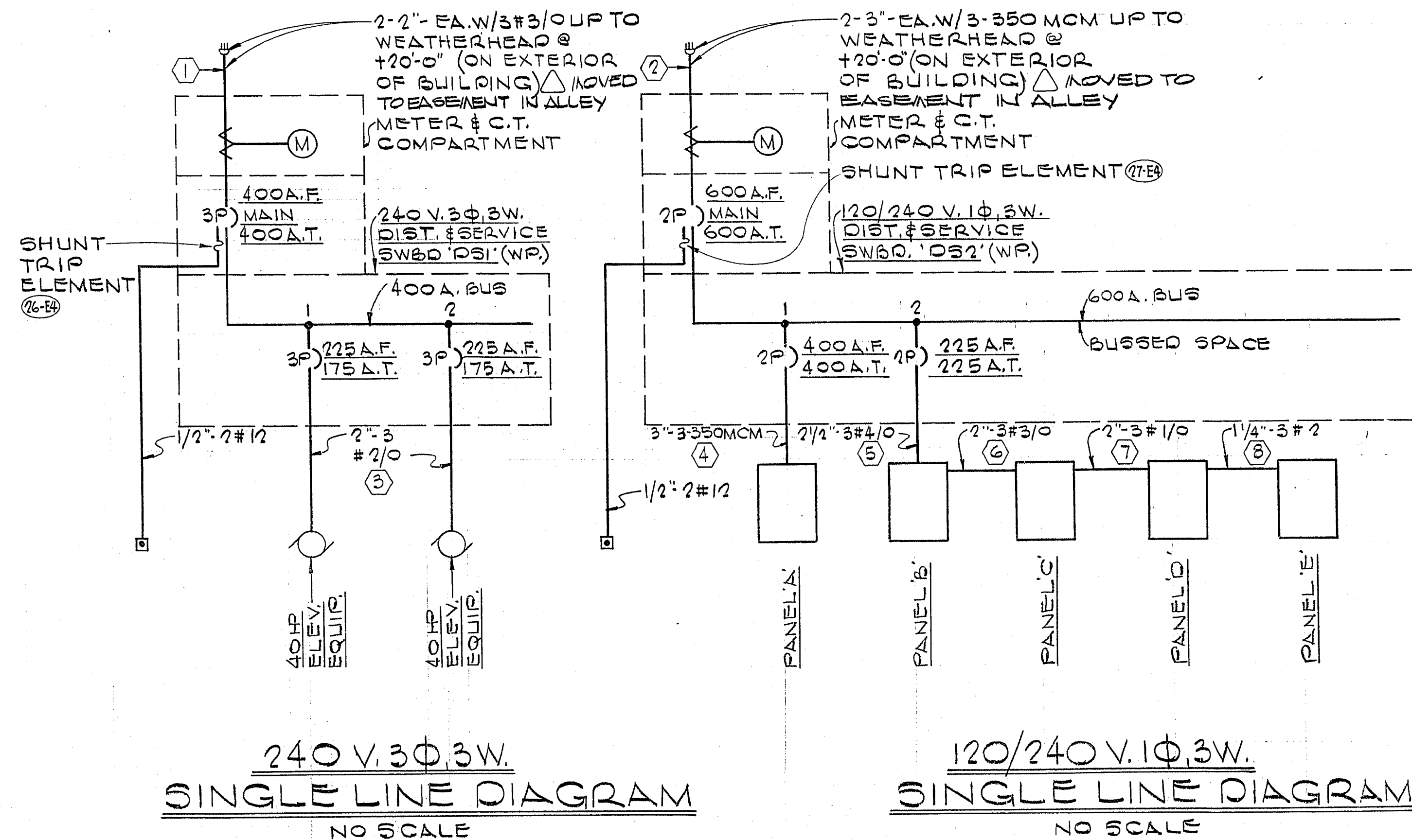
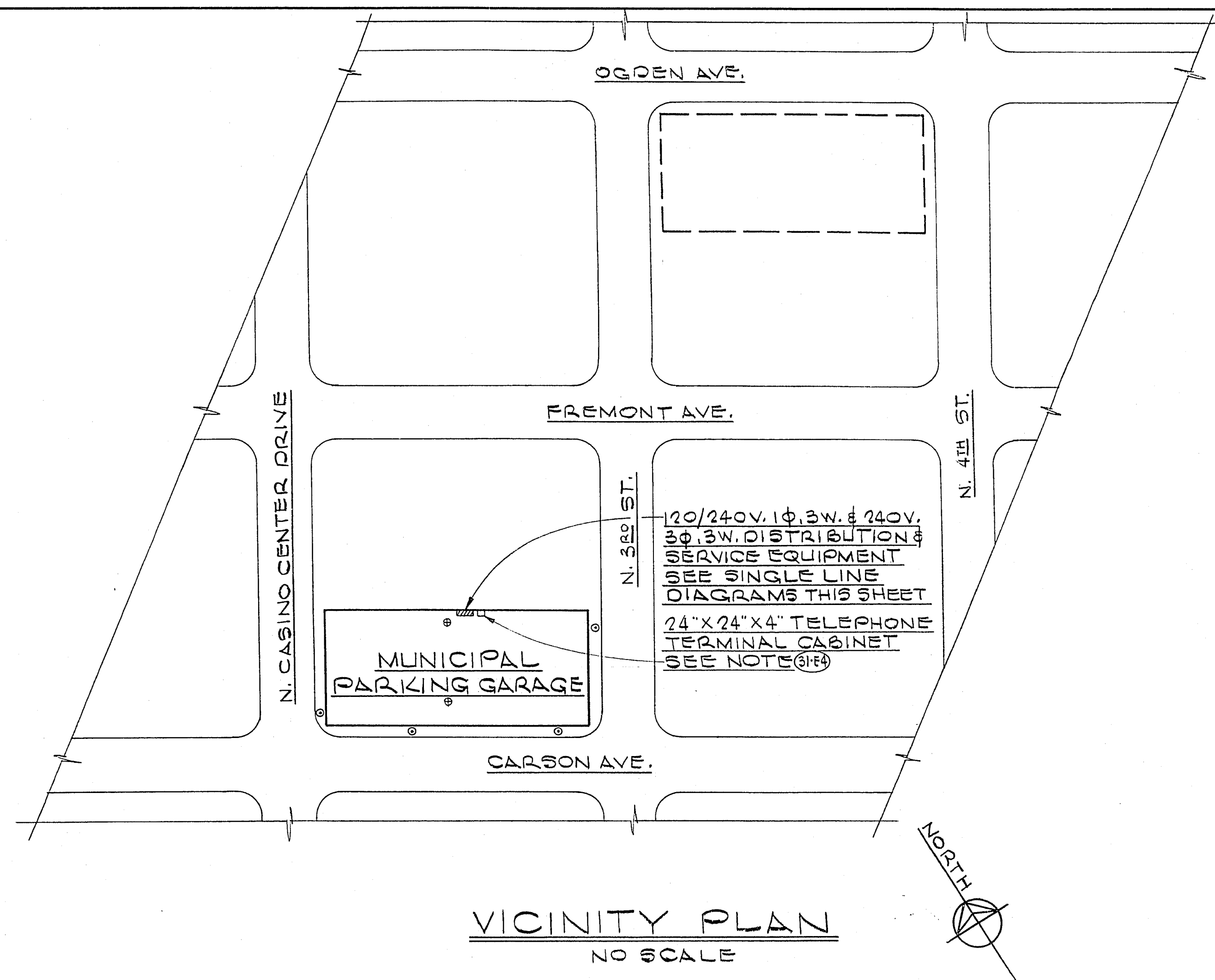

THE DESIGNS AND IDEAS INDICATED BY THESE DRAWINGS WERE CREATED FOR USE ON THIS PROJECT ONLY AND ARE THE PROPERTY OF EDWARD B. HENDRICKS ASSOC. THEY MAY NOT BE USED FOR ANY OTHER PURPOSE WHATSOEVER WITHOUT THE WRITTEN PERMISSION OF THE OFFICE OF EDWARD B. HENDRICKS ASSOCIATES.

JOHNSON, JOECKEL, BARTLEY AND ASSOCIATES
MECHANICAL AND ELECTRICAL ENGINEERS
522 E. TWAIN AVE. • LAS VEGAS, NEV. 89109
734-1312

EDWARD B. HENDRICKS ASSOCIATES
ARCHITECTURE • PLANNING • ENGINEERING
E. B. HENDRICKS A.I.A.
FRED L. KENNEDY
G. L. JACOBSON

537 E. SAHARA AVE.
LAS VEGAS, NEVADA
PHONE • 735-0902

MUNICIPAL PARKING GARAGES
CITY OF LAS VEGAS
NEVADA
CARSON SITE

VICINITY PLAN
SCHEDULES & SYMBOLS

DATE 9-8-66
JOB NO.
DRAWN BY G.V.

SHEET OF 4
28

JAC AS BUILT REVISION
DATE BY REVISIONS

1-26 5-12-67