

**SECTION B**  
1/8" = 1'-0" S-3

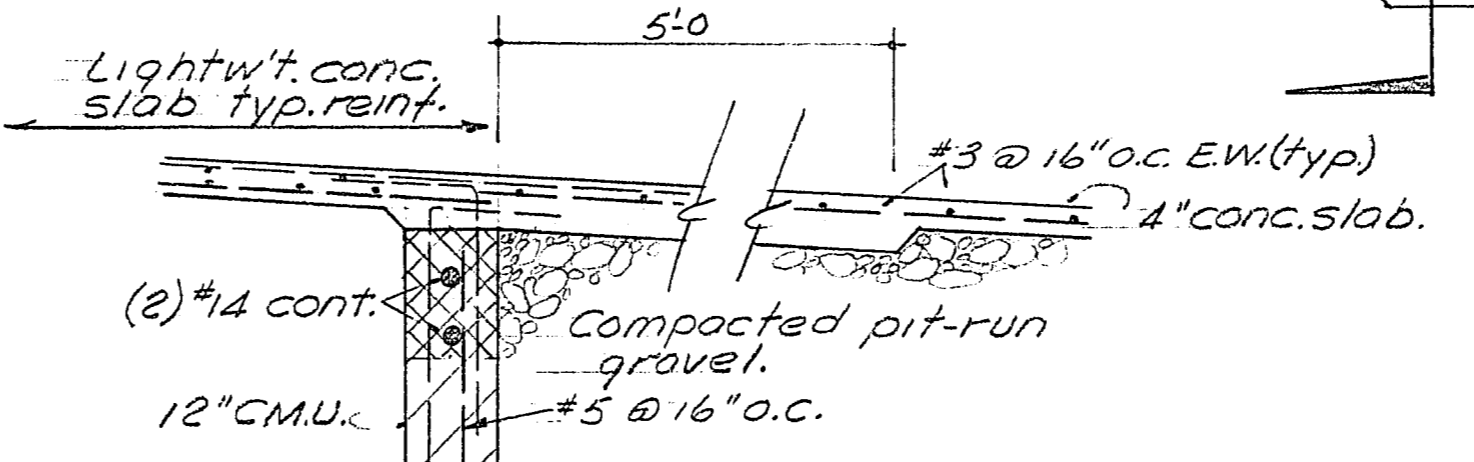

**DET'L 1**  
1/2" = 1'-0" S-3

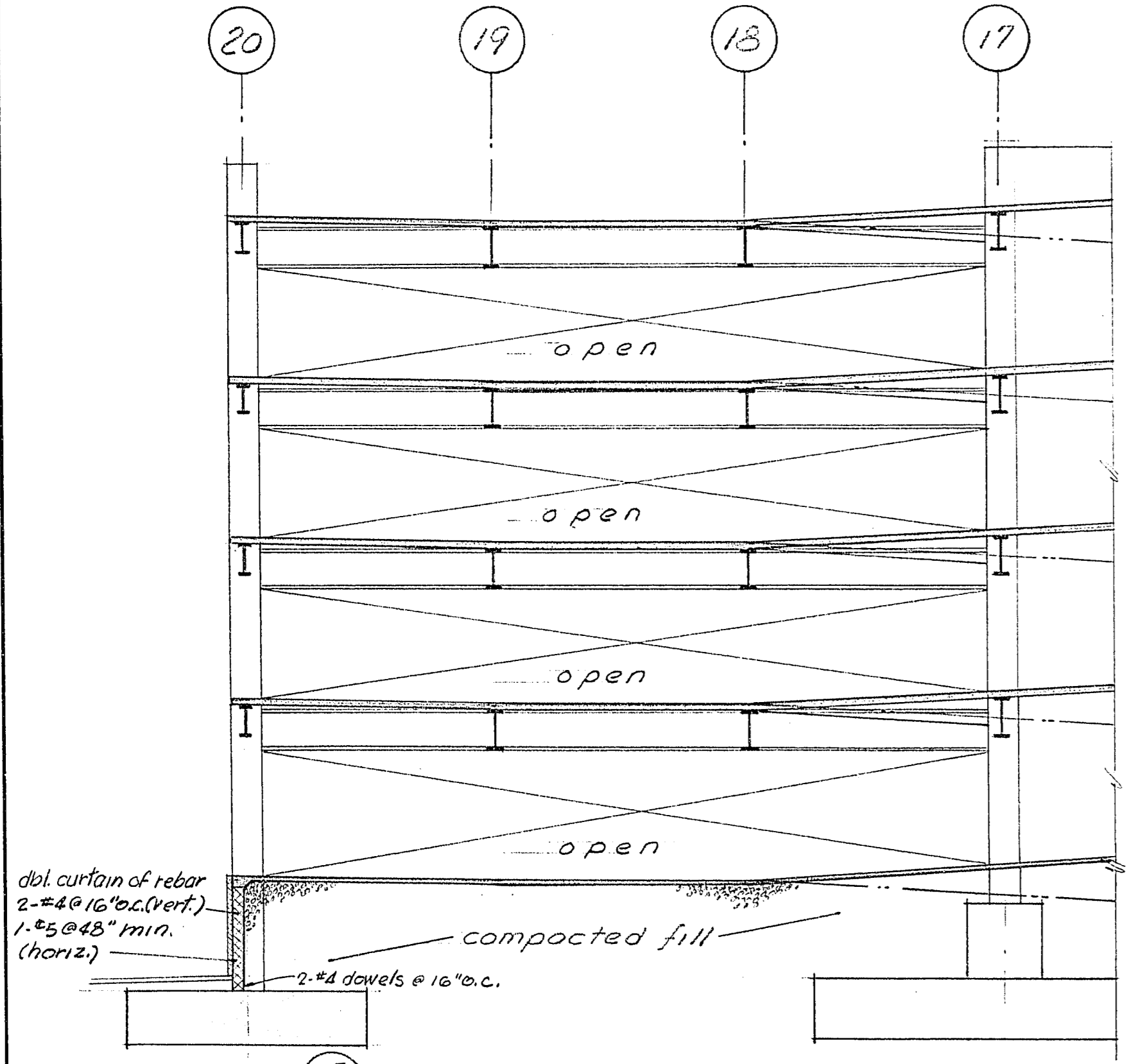

SEC. 5 S-4

**SECTION B**  
1/8" = 1'-0" S-3 cont.

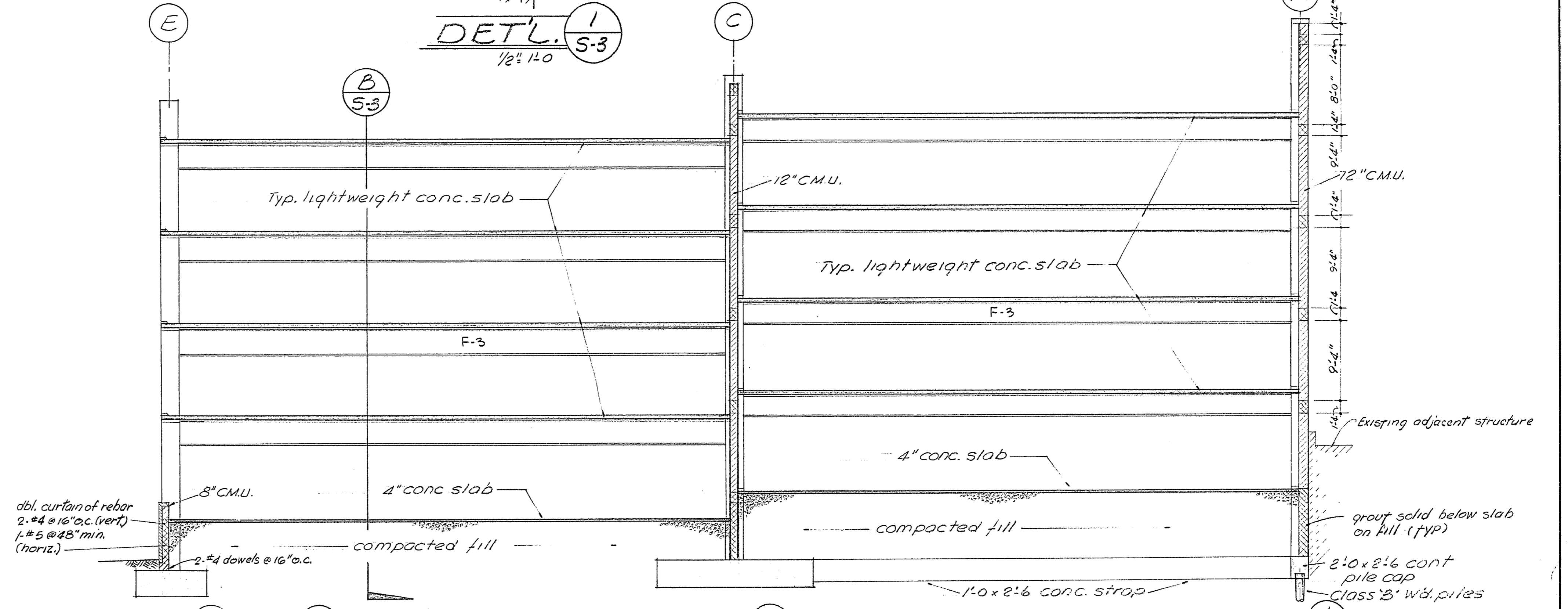

SEC. 3 S-4

SEC. 1 S-4 AT COLUMN

**SECTION 3**  
1/8" = 1'-0" S-3

SEC. 2 S-4 AT COLUMN

SEC. 4 S-4

VOID SEE SA SERIES DRAWINGS

THE DESIGNS AND IDEAS INDICATED BY THESE DRAWINGS WERE CREATED FOR USE ON THIS PROJECT ONLY AND ARE THE PROPERTY OF EDWARD B. HENDRICKS ASSOC. THEY MAY NOT BE USED FOR ANY OTHER PURPOSE WHATSOEVER WITHOUT THE WRITTEN PERMISSION OF THE OFFICE OF EDWARD B. HENDRICKS ASSOCIATES.

**DANIEL M. CASHOAN**  
STRUCTURAL ENGINEER  
537 EAST SAHARA AVE. LAS VEGAS, NEVADA

**EDWARD B. HENDRICKS ASSOCIATES**  
ARCHITECTURE PLANNING ENGINEERING

E. B. HENDRICKS A.I.A.  
FRED L. KENNEDY  
G. L. JACOBSON

537 E. SAHARA AVE.  
LAS VEGAS, NEVADA  
PHONE • 735-0902

**MUNICIPAL PARKING GARAGES SECTIONS**  
CITY OF LAS VEGAS NEVADA

CARSON SITE

*E. B. Hendricks*  
DIRECTOR OF PUBLIC WORKS

DATE	9-8-66	SHEET	9	OF	9
JOB NO.		I.D.	5		
DRAWN BY	E.H.				
DATE		BY		REVISIONS	