

STORM DRAIN & DRAINAGE QUANTITIES:

	(PUBLIC)	
1	36" RCP STORM DRAIN PIPE	58 LF
2	18" RCP STORM DRAIN PIPE	55 LF
3	24" RCP STORM DRAIN PIPE	314 LF
4	2.5' MODIFIED TYPE "CM" DROP INLET	1 EA
5	14.5' MODIFIED TYPE "CM" DROP INLET	1 EA
6	11.5' MODIFIED TYPE "CM" DROP INLET	1 EA
7	48" TYPE III STORM DRAIN MANHOLE	3 EA
8	FLOOD WALL	413 LF

BASIS OF BEARINGS

NORTH 89°45'05" EAST BEING THE SOUTH LINE OF THE SOUTHWEST QUARTER (SW 1/4) OF SECTION 35, TOWNSHIP 20 SOUTH, RANGE 59 EAST, M.D.M., AS SHOWN BY MAP ON FILE IN FILE 91, PAGE 28 OF PARCEL MAPS IN THE CLARK COUNTY RECORDER'S OFFICE, CLARK COUNTY, NEVADA

BENCHMARK

BM #	DESC.	NAVD 88 DATUM	NAVD 88 DATUM
0LV09-34SS69	NDOT BRASS CAP, 50 FEET NORTH OF STATION 787+19.42 OF CHARLESTON BOULEVARD.	3209.81 (FEET)	978.351 (METERS)

APPROVED FOR CONSTRUCTION

1/30/13

LAS VEGAS VALLEY WATER DISTRICT

DATE

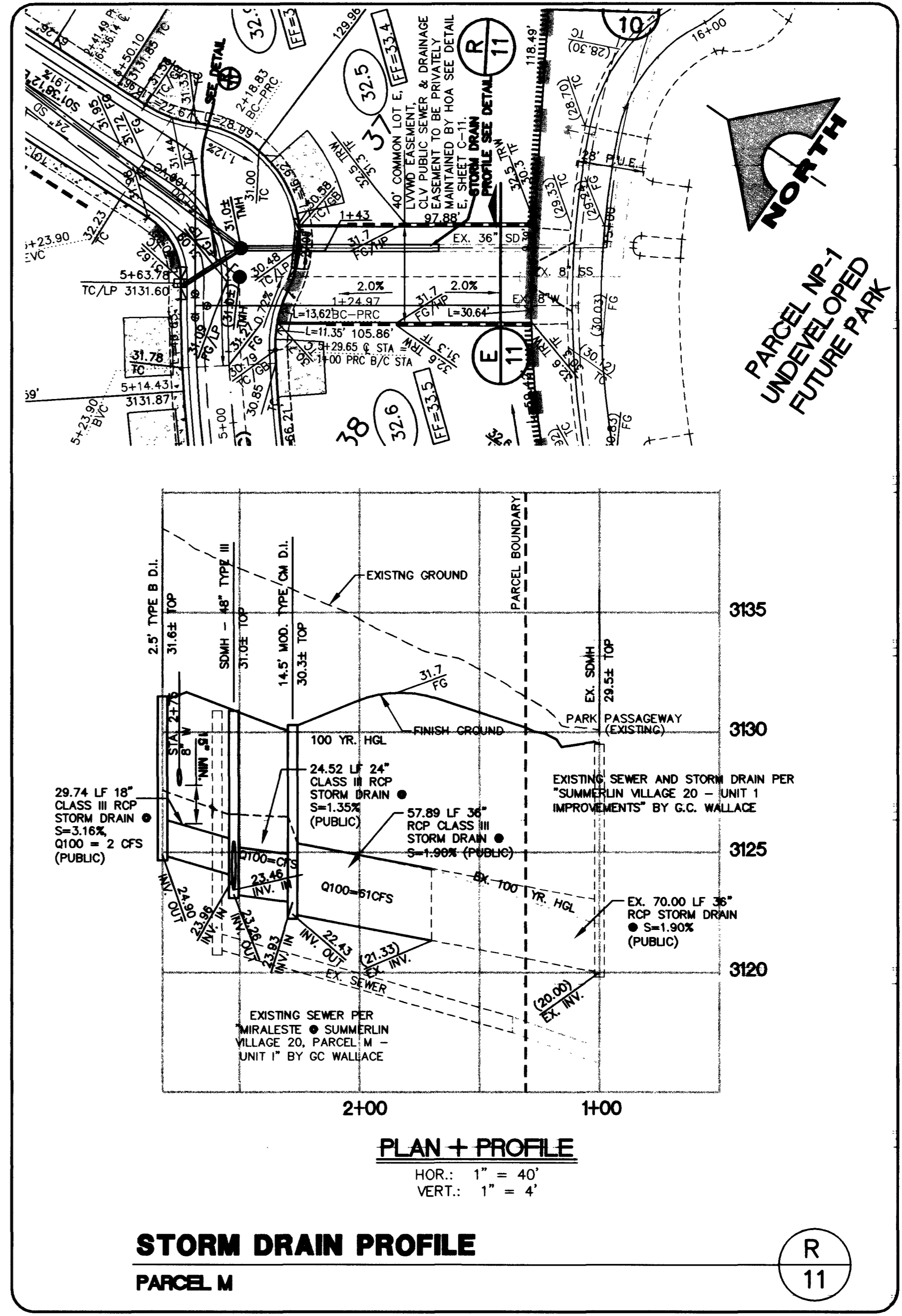

Call before you Dig.

1-800-227-2600

UNDERGROUND SERVICE (USM)

CALL BEFORE YOU DO OVERHEAD

1-702-593-6111

49249

STATE OF NEVADA
CLARK COUNTY
ENGINEER
G. WALLACE
12/21/2004
No. 15224

DESIGN: DRAWN: CHECK: ISSUE DATE: 01-09-03
ISSUE DATE: 01-09-03
PLOT DATE: 01-09-03
PLOT TIME: 15:05:28

7 COMPLETE

ISSUE DATE

G. C. WALLACE, INC.
Engineers/Planners/Surveyors
1555 SOUTH RAINBOW BLVD./LAS VEGAS, NEVADA 89146
TELEPHONE: (702) 804-2000 • FAX: (702) 804-2299
F: \371-005\img\mproj\UNIT2\grad-est-102.dwg (Plot)

WILLIAM LYON HOMES

MIRALESTE AT SUMMERLIN VILLAGE 20, PARCEL M - UNIT I

GRADING PLAN DETAILS I

SHEET C-11

11 OF 12 SHEETS