

EXISTING DEVELOPMENT

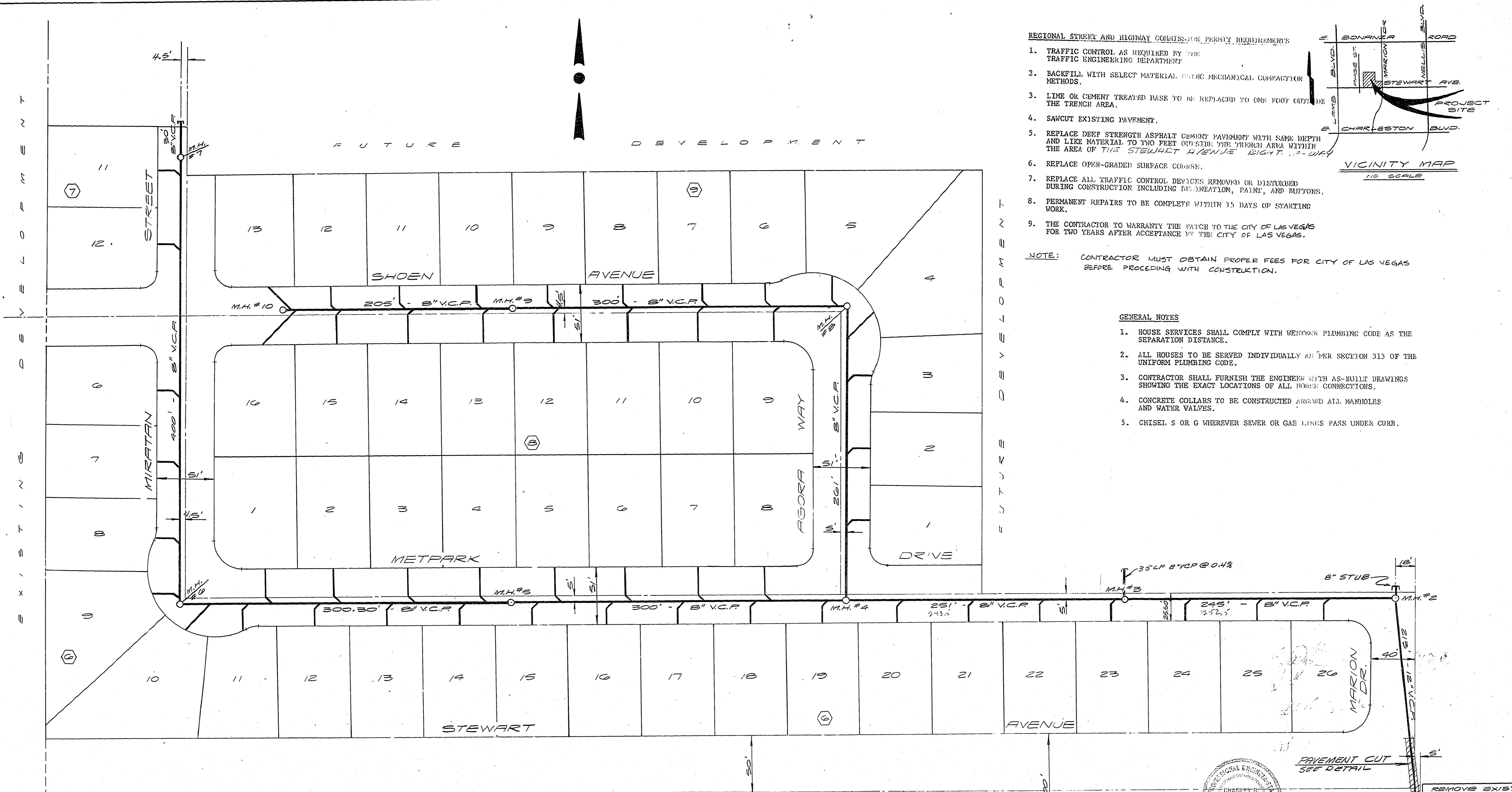

REGIONAL STREET AND HIGHWAY COMMISSION PERMIT REQUIREMENTS

1. TRAFFIC CONTROL AS REQUIRED BY THE TRAFFIC ENGINEERING DEPARTMENT.
2. BACKFILL WITH SELECT MATERIAL USING MECHANICAL COMPACTION METHODS.
3. LIME OR CEMENT TREATED BASE TO BE REPLACED TO ONE FOOT OUTSIDE THE TRENCH AREA.
4. SAWCUT EXISTING PAVEMENT.
5. REPLACE DEEP STRENGTH ASPHALT CEMENT PAVEMENT WITH SAME DEPTH AND LIKE MATERIAL TO TWO FEET OUTSIDE THE TRENCH AREA WITHIN THE AREA OF THE STEWART AVENUE RIGHT-OF-WAY.
6. REPLACE OPEN-GRADED SURFACE COURSE.
7. REPLACE ALL TRAFFIC CONTROL DEVICES REMOVED OR DISTURBED DURING CONSTRUCTION INCLUDING REGULATION, PAINT, AND BUTTONS.
8. PERMANENT REPAIRS TO BE COMPLETE WITHIN 15 DAYS OF STARTING WORK.
9. THE CONTRACTOR TO WARRANT THE PATCH TO THE CITY OF LAS VEGAS FOR TWO YEARS AFTER ACCEPTANCE BY THE CITY OF LAS VEGAS.

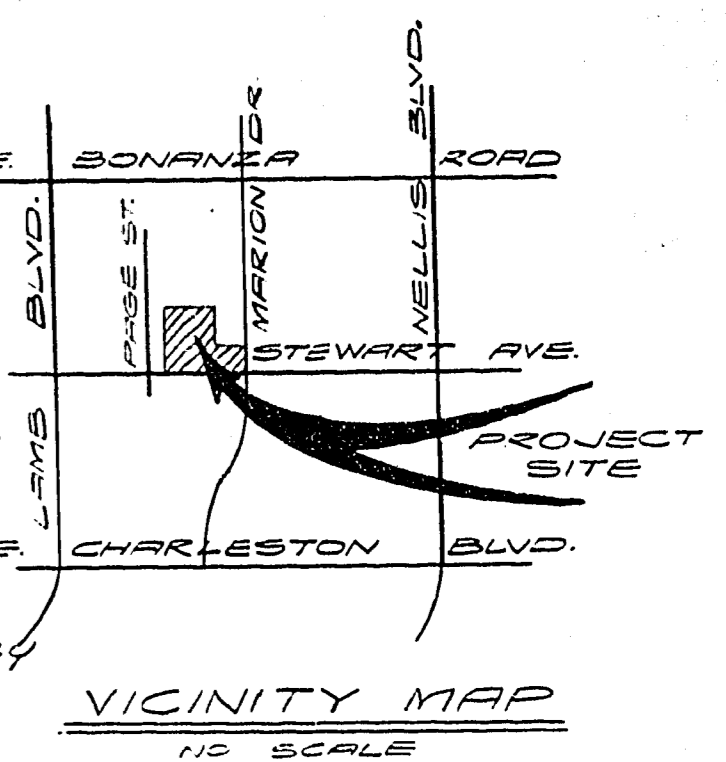

NOTE: CONTRACTOR MUST OBTAIN PROPER FEES FOR CITY OF LAS VEGAS BEFORE PROCEEDING WITH CONSTRUCTION.

GENERAL NOTES

1. HOUSE SERVICES SHALL COMPLY WITH WENTON PLUMBING CODE AS THE SEPARATION DISTANCE.
2. ALL HOUSES TO BE SERVED INDIVIDUALLY AS PER SECTION 313 OF THE UNIFORM PLUMBING CODE.
3. CONTRACTOR SHALL FURNISH THE ENGINEER WITH AS-BUILT DRAWINGS SHOWING THE EXACT LOCATIONS OF ALL HOUSE CONNECTIONS.
4. CONCRETE COLLARS TO BE CONSTRUCTED AROUND ALL MANHOLES AND WATER VALVES.
5. CHISEL S OR G WHENEVER SEWER OR GAS LINES PASS UNDER CURB.

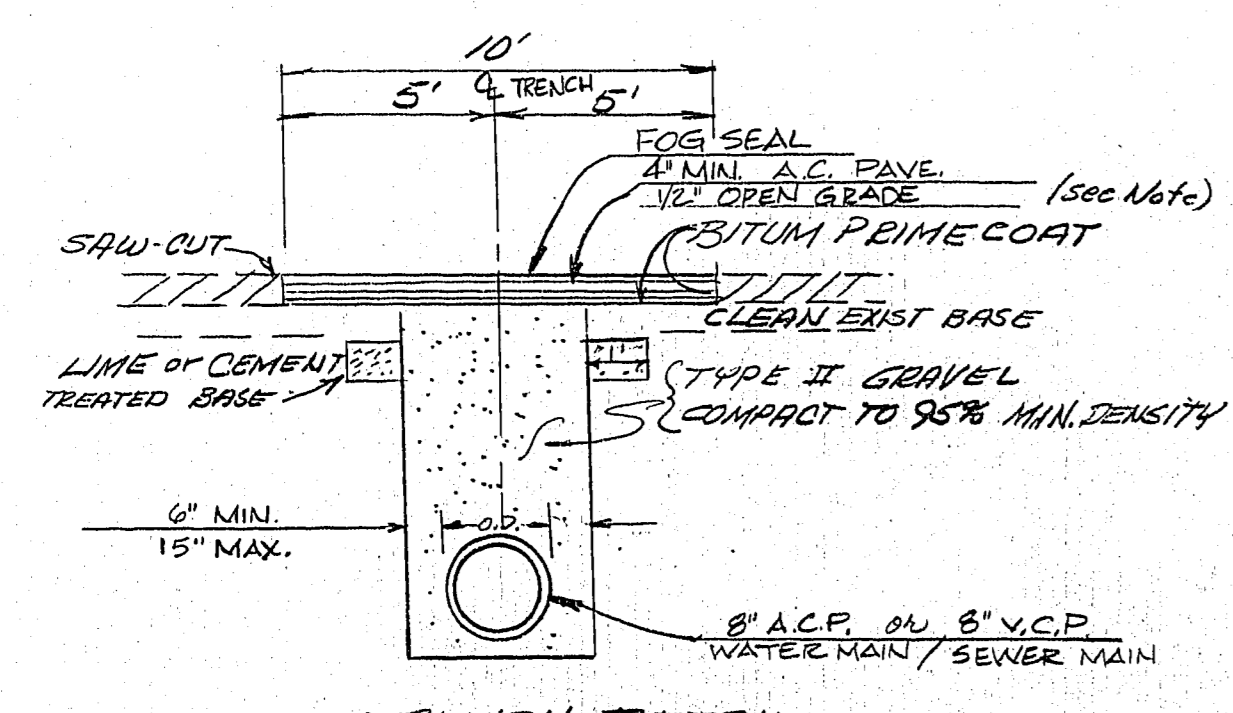

QUANTITY ESTIMATE

12" V.C.P. MAIN	213	L.F.
8" V.C.P. MAIN	2327	L.F.
4" V.C.P. LATERALS	1280	L.F.
STANDARD MANHOLES	10	EA.

APPROVAL

OP Breda 9-13-78
REGIONAL STREET & HIGHWAY ENGINEER DATE

Jay 9/20/78
CITY ENGINEER DATE

Charles A. Johnson 9-18-78
CIVIL ENGINEER NO. 3005 DATE

Colt Seibel 9-27-78
CIVIL FIELD OPERATIONS ENGINEER DATE

Ed Wilber 9-26-78
CIVIL QUALITY CONTROL ENGINEER DATE

STEWART PLACE - UNIT NO. 4

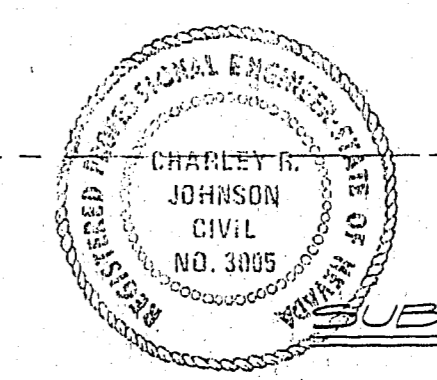

SUBMITTED BY: *Charles A. Johnson* 6/16/78
CHARLEY A. JOHNSON, R.P.E. DATE
NEVADA CERT. NO. 3005

CONSULTING ENGINEERS • PLANNERS

VCM

METROPOLITAN PARK - UNIT NO. 19

MASTER SEWER PLAN

SCALE: 1" = 40'	WO. NO. 2923-19	DATE: 6/16/78	SHEET: 6	OF: 10
HORIZ: DES. CAS	REV. CAS	REV.		
VERT: CHK	REV.			

OWNER - DEVELOPER:
METROPOLITAN NEVADA CORP.
8447 WILSHIRE BLVD.
BEVERLY HILLS, CA. 90211