

TEMPORARY BENCHMARK  
 CITY OF LAS VEGAS BM 1LV00  
 12N4. RIVET & PLATE IN WATER  
 METER PAD, 5401 W. ALEXANDER  
 RD AT BRADLEY RD.  
 EL 2236.44

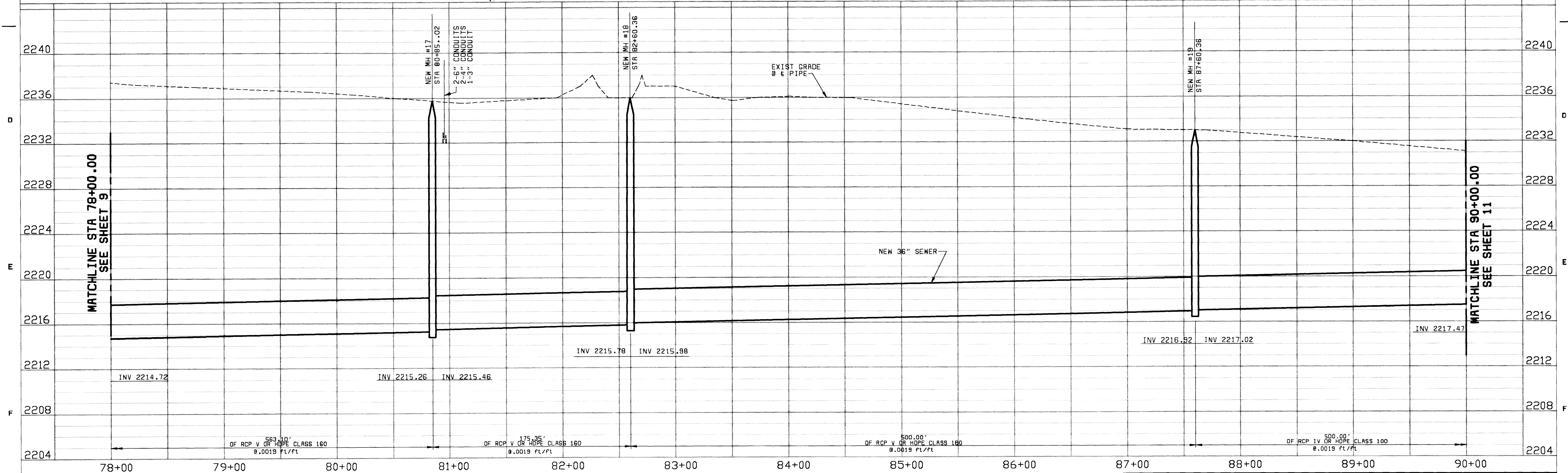

59_1073 F03000000	10/13/97 CONFORMS TO CONSTRUCTION RECORD	ACC/BMC	DESIGNED: PAT DETAILED: PAT CHECKED: PJR/JBW APPROVED: DATE:	Las Vegas, Nevada	CITY OF LAS VEGAS DEPARTMENT OF PUBLIC WORKS MONTE CRISTO/CHEYENNE SEWER INTERCEPTOR PLAN AND PROFILE STA 78+00.00 TO STA 90+00.00	RECORD DRAWING THESE RECORD DRAWINGS HAVE BEEN PREPARED BASED ON INFORMATION PROVIDED BY OTHERS. THE ENGINEER HAS NOT VERIFIED THE ACCURACY OF SUCH INFORMATION AND SHALL NOT BE RESPONSIBLE FOR ANY ERRORS OR OMISSIONS WHICH MAY BE INCORPORATED HEREIN AS A RESULT OF THE DOCUMENTS WERE SEALED ON 10/16/95 BY PATRICK A. ROMAN UNDER LICENSE NO. 11545	DRAWING NO. <b>307-V739</b> SHEET 10 OF 26
	DATE REVISIONS AND RECORD OF ISSUE	NO. BY CK APP	2016	CCG - DWG. NO: P008			

